

Mounts & Brackets

Domes

Moog Videolarm offers an array of diverse mounts and brackets to complement our dome camera housings. These mounts and brackets allow the dome enclosures to fit a variety of applications.





- APC3 3" thick straps

Wall mount for SM7 and SM75 housings



- Durable powder coat finish
- All aluminum construction
- Threaded bolt inserts to make installation easier and quicker
- 75 Lbs. load rating
- ACA2W (white)

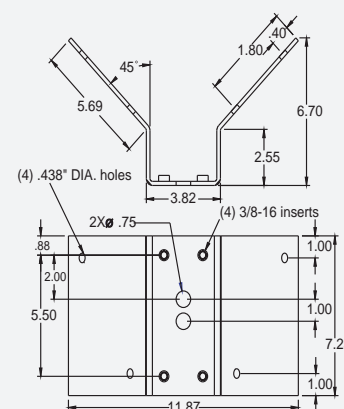

Dimensions are in inches



Ceiling mount adapter, with
junction box, includes 1½" NPT



Wall mount bracket for IR illuminators and ACH13 or ACH8 IR lights not included



- Mounts to poles 3" - 6" dia. with included pole straps (2)
- Conduit holes on sides with (2) knockouts on the back
- Threaded bolt inserts to make installation quicker and easier
- Durable powder coat finish
- Sealed junction box for terminating wires
- 25 Lbs. load rating

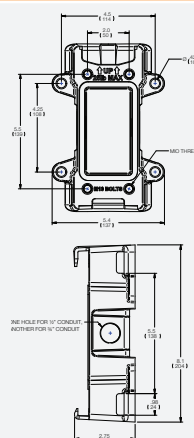

Dimensions are in inches

- Durable powder coat finish
- All aluminum construction
- 1½" pipe thread on end for quick and easy dome mounting
- 50 Lbs. load rating



Heavy-duty aluminum parapet
mount bracket with 20" extension,
includes 1½" NPT



- Durable powder coat finish
- All aluminum construction
- 1½" pipe thread on end for quick and easy dome mounting
- 60 Lbs. load rating

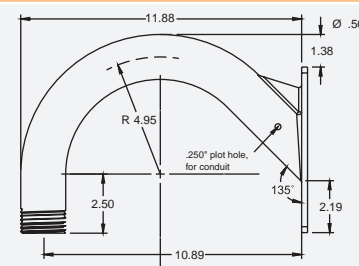

Dimensions are in inches

