

Security toilet tissue roll holder:

☐ Model SA10

Product Materials

TISSUE HOLDER: heavy gauge seamless stainless steel tubing in architectural satin finish. Stainless steel end cap is welded and ground smooth to a matching architectural satin finish.

WALL ANCHOR PLATE: welded to the tubing. Unit is supplied with 1/4" - 20 x 1-1/2" stainless steel flush mounting torx-head screws for installation to wall anchors (not included).

WARNING: Unit can be used as a suicide device and is not recommended for penal institution or mental health applications.

ADA Compliant

- ☒ Consult local and national accessibility codes for proper installation guidelines.
- ☒ Conformity and compliance to local and national codes is the responsibility of the installer.

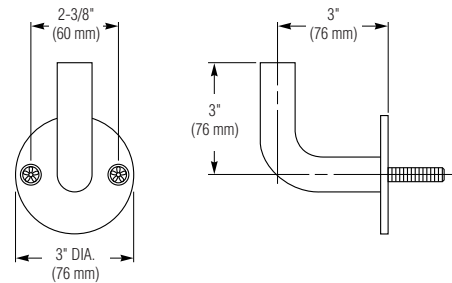

Washroom Accessories
Document No. 9195