

| PART NO. | DESCRIPTION | MATERIAL | "L" |
|----------|--|---------------------|--------|
| SD31 | LOCK-SHAFT 5/16" SQ X 4 5/8" ZINC PLATED | C12L14 STEEL | 4 5/8" |
| SD31SS | LOCK-SHAFT 5/16" SQ X 4 5/8" 304SS | 304 STAINLESS STEEL | 4 5/8" |
| SD31-1 | LOCK-SHAFT 5/16" SQ X 5 5/8" ZINC PLATED | C12L14 STEEL | 5 5/8" |
| SD31-1SS | LOCK-SHAFT 5/16" SQ X 5 5/8" 304SS | 304 STAINLESS STEEL | 5 5/8" |

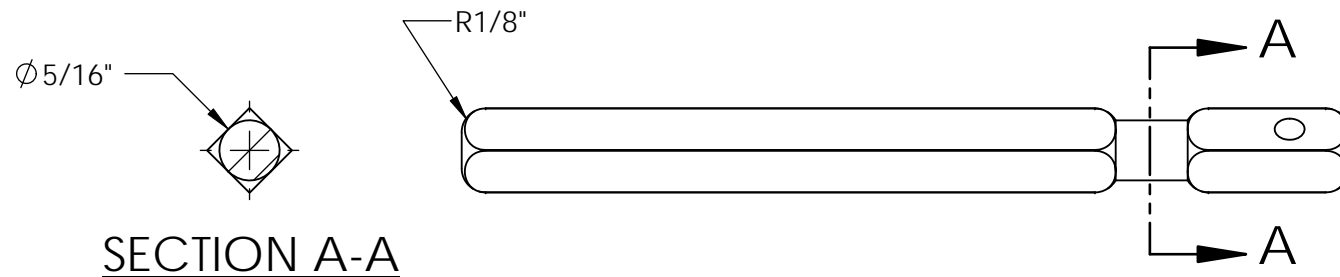
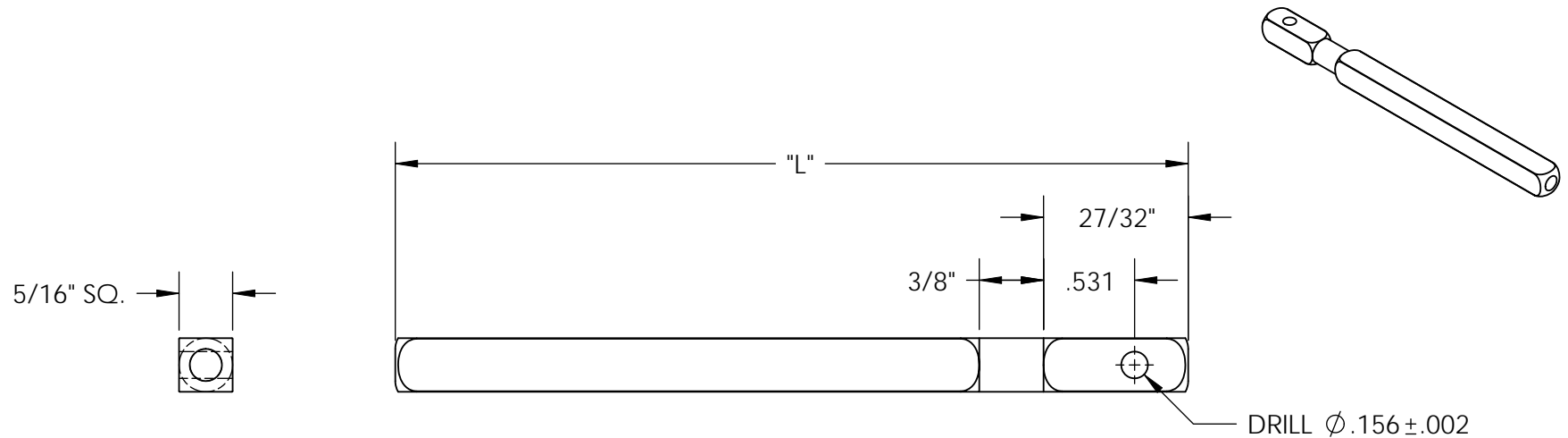

**RELEASED TO
MANUFACTURING**
DATE: 12/01/2011
APPROVED BY: D.J.C.

| | | | | |
|------|-------------------------------------|-------|-----|----------|
| F | CHANGED ALLOY TO C12L14 | 30064 | ATR | 12/01/11 |
| E | ADDED MATERIAL COLUMN & SECTION A-A | 28607 | ATR | 09/02/10 |
| D | ADDED .156 DRILL HOLE | 24842 | ATR | 06/17/08 |
| C | RECREATED IN SOLIDWORKS | 19171 | PRC | 03/17/05 |
| B | CONSOLODATED (TABULATED) DRAWING | 10370 | TJ | 09/13/01 |
| A | 27/32" WAS 25/32" | 2389 | JLL | 01/26/94 |
| REV. | DESCRIPTION | ECR | BY | DATE |

THIS DRAWING IS THE PROPERTY OF THE BILCO COMPANY AND INCORPORATES PROPRIETARY INFORMATION. PUBLICATION AND/OR PUBLIC DISTRIBUTION IN WHOLE OR IN PART IS EXPRESSLY PROHIBITED WITHOUT THE PRIOR WRITTEN CONSENT OF THE BILCO COMPANY. THE INFORMATION CONTAINED HEREIN REMAINS THE PROPERTY OF THE BILCO COMPANY. ALL RIGHTS RESERVED.

| | | | | | |
|--------------------------------------|--------|----------|---|--------------|--------------|
| UNLESS OTHERWISE SPECIFIED: | NAME/# | DATE | Bilco Manufacturers of Doors for Special Services THE BILCO COMPANY New Haven, Connecticut 06505 | | |
| DRAWN | PRC | 03/16/05 | | | |
| ORG. AUTHOR | TFH | | | | |
| ORG. ECR | | 03/23/90 | | | |
| INTERPRET GEOMETRIC TOLERANCING PER: | Q.A. | | TITLE: LOCK-SHAFT 5/16" SQ_ | | |
| MATERIAL | | | | | |
| FINISH | | | 3RD-ANGLE PROJECTION | | |
| DO NOT SCALE DRAWING | | | | | |
| | | | SIZE | DWG. NO. | REV |
| | | | A | SD31_ | F |
| | | | SCALE: 1:1 | WEIGHT: | SHEET 1 OF 1 |