

The Alarm Initiating Switch Kit (Part No. 428311) consists of:

- Alarm Initiating Switch Assembly – Rated 50 mA 28VDC (or 0.1A, 125VAC)
- Switch Cover
- Mounting Screw with Nut (4)
- Self-Tapping Screws (2)
- Trip Lever Pin
- Hex Nut for Trip Lever Pin
- Instruction Sheet

The Alarm Initiating Switch is installed in the AUTOMAN Release on the upper tab of the switch mounting bracket.

1. Install round trip lever pin with hex nut provided.
2. Install the alarm initiating switch into the switch cover for the upper tab of the switch mounting bracket. To install the alarm initiating switch in the switch cover, slide the switch into the large opening of the switch cover, oriented with the switch lever on the bottom side of the switch. See Figure 1.

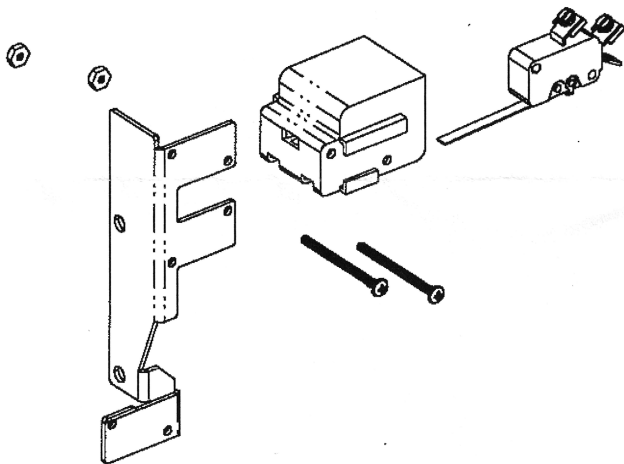

FIGURE 1
009137

NOTICE

The alarm initiating switch must always be installed on the upper tab of the switch mounting bracket.

3. Slide switch cover onto the upper tab of the switch mounting bracket, ensuring that the tab slides into the channels on the back side of the switch cover, until the screw holes line up.
4. Install two switch mounting screws and nuts, ensuring that the screws pass through the holes in the cover, through the mounting holes in each of the switches, and through the holes in the mounting bracket tab. Tighten screws securely.

Note: To meet UL requirements the screws and nuts must be installed. The switch cover is not intended to secure the switches to the bracket.

See NFPA 72, "National Fire Alarm Code," Initiating Devices section, for the correct method of wiring connection to the fire alarm panel.

NOTICE

All connections to fire alarm control panels must be made by trained and qualified personnel in accordance with fire alarm control panel manufacturer's recommendations.

Note: Where applicable on older systems, install according to Figure 2.

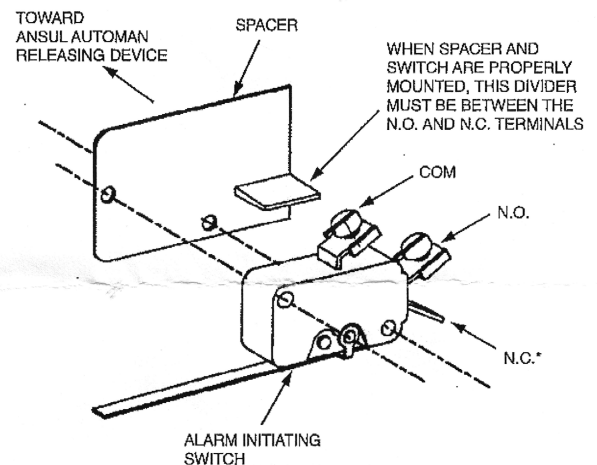

FIGURE 2
004890

After the switch is properly mounted, follow the steps listed in the installation section of the Design, Installation, Recharge, and Maintenance Manual for correct positioning of the switch lever on the AUTOMAN cam surface.

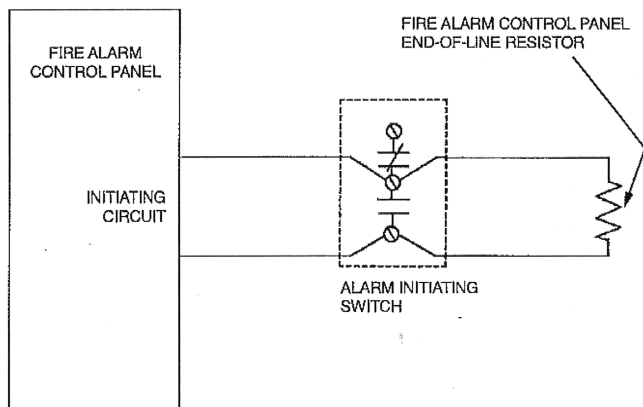
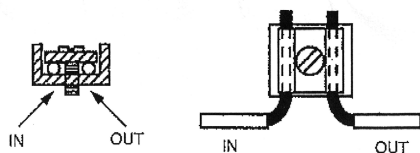
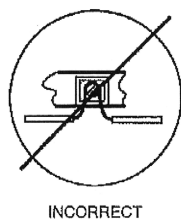

FIGURE 3
004891



CORRECT – SEPARATE INCOMING AND OUTGOING CONDUCTORS

FIGURE 4
004905

WHEN INSTALLING SWITCH, APPLY THIS LABEL TO INSIDE SURFACE
 OF CABINET IN A VISIBLE LOCATION

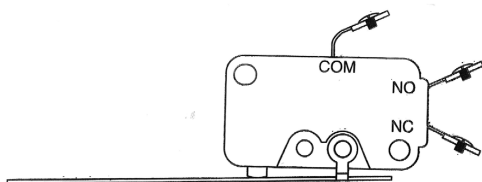

REFER TO INSTALLATION INSTRUCTIONS IN MANUAL

UL ELECTRICAL RATINGS
 28 VDC, 0.05 A

⚠ WARNING
 DO NOT CONNECT TO
 HIGH POWER LOADS! FOR
 CONNECTION TO APPROVED
 FIRE PROTECTION PANEL
 ONLY!

LABEL NO. 436816-01