

[illegible]

øüut áð vòüü üáæôàá øáöuüü

Technical drawing of a vertical assembly, likely a door or window frame, showing a cross-section. The drawing includes a vertical rod or handle with a central locking mechanism. Labels in Greek are present:

- Top label: ΠΕΡΙΣΤΡΟΦΗ ΚΑΙ ΚΛΕΙΣΜΑ (Rotation and Locking)
- Bottom label: ΠΕΡΙΣΤΡΟΦΗ ΚΑΙ ΚΛΕΙΣΜΑ (Rotation and Locking)
- Left label: ΑΝΤΙΣΤΗΝΤΑΣΙΑ (Resistance)
- Right label: ΚΑΤΕΛΕΞΕΤΕ ΤΟΝ ΚΑΤΕΡΓΑΣΤΗΝ (Consult the Manufacturer)

[illegible]

**Adams
Rite**

ASSA ABLOY

OU'43: 2"K UVCNNCVKQP "K UVTWEVKQP
:2/23:2/485 Tgx0 E

Tgx0 E

GEP <335; 5

F cvg<

K UVCNNC VKQP "K UVTWE VKQP U

Rci g'"3'qh 4

 $\text{Cr rxf} <$

F cvg<

VỎ P VỎ P

CÓI CẮT

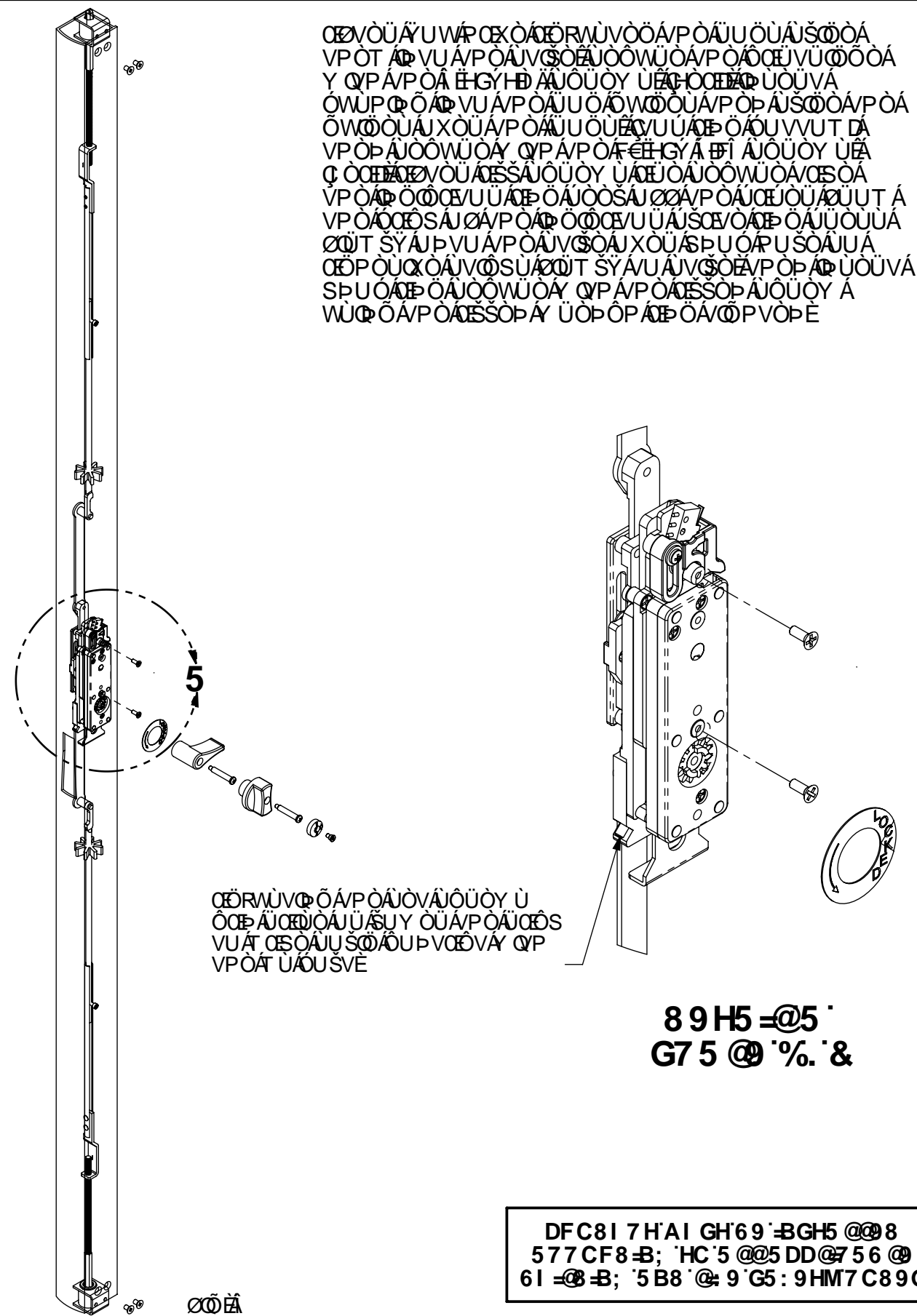
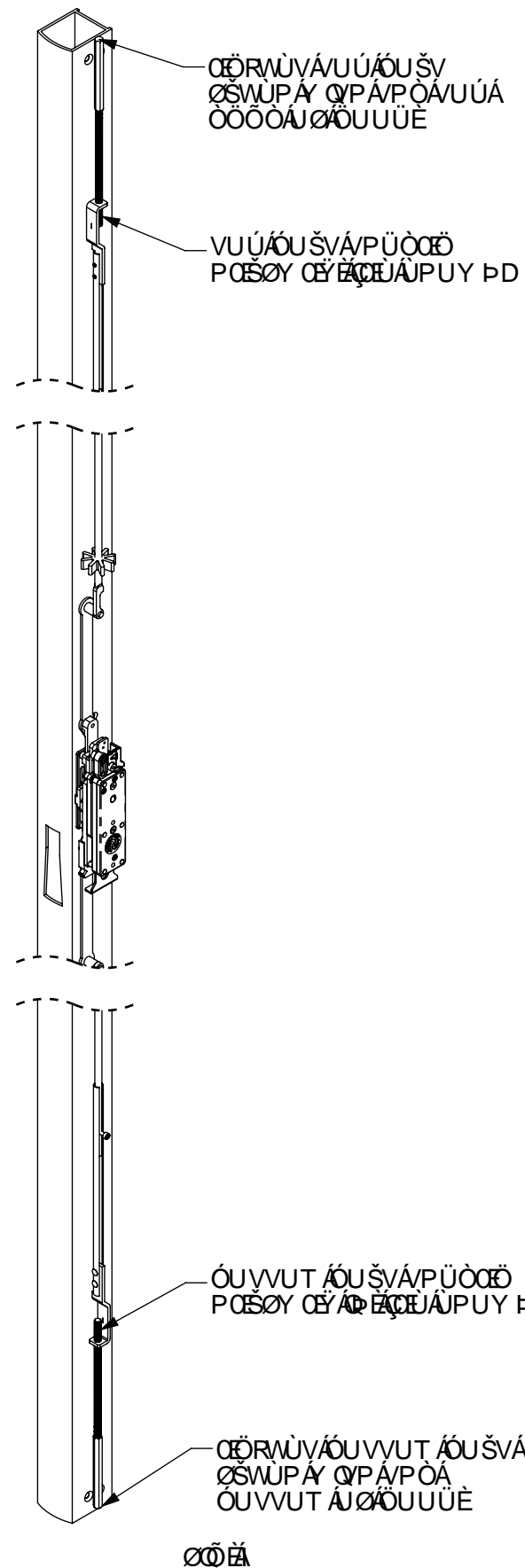

75FHf=8; 9'5B8'FC8'5GG9A6 @M