



FLAT TOW KIT

Installation Instructions

www.mopar.com

1. Disconnect and isolate the negative battery cable. If equipped with an Intelligent Battery Sensor (IBS), disconnect the IBS connector first before disconnecting the negative battery cable.
2. Remove Shifter Knob by lowering the upper shifter boot collar & removing (2) set screws..
3. Using trim stick [C-4755](#) or equivalent, pry up on bezel (1) and remove along with the shifter boot.

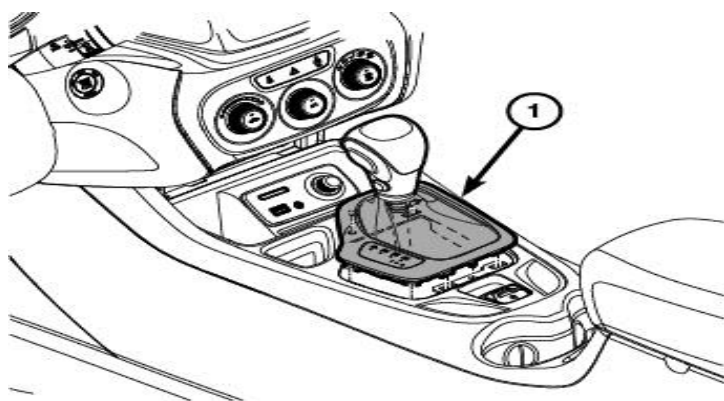

2316004757

4. Using a trim stick or equivalent, remove the front trim (3) covering the console fasteners.

5. Accessing from the front of the floor console (1) and using a trim stick, disengage the retaining tabs for the front gap hidens (2) and remove the gap hidens (4).

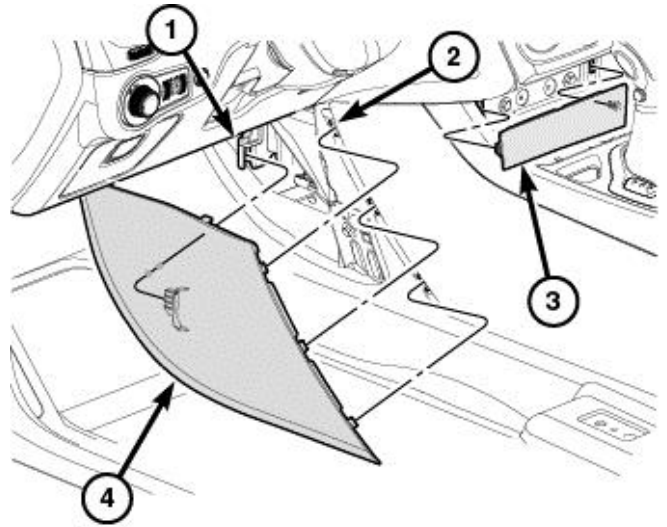

2316004759

6. Using a [Trim Stick C-4755](#) or equivalent, separate the console bezel (1) and disconnect the electrical connector(s) for the body harness & 2 media hub ports (4).

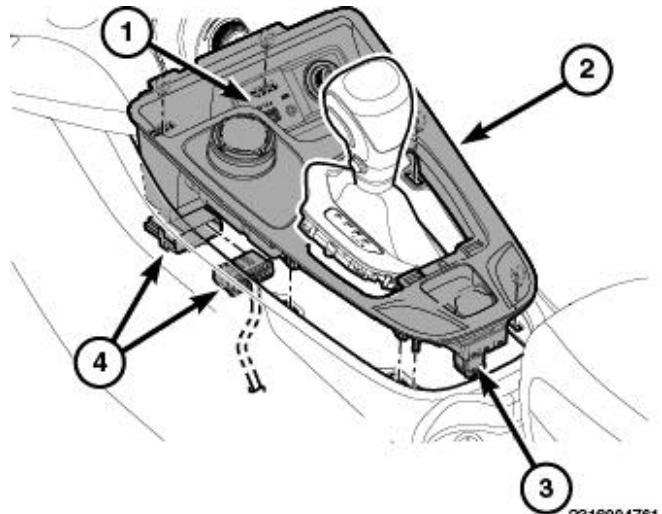

2316004761

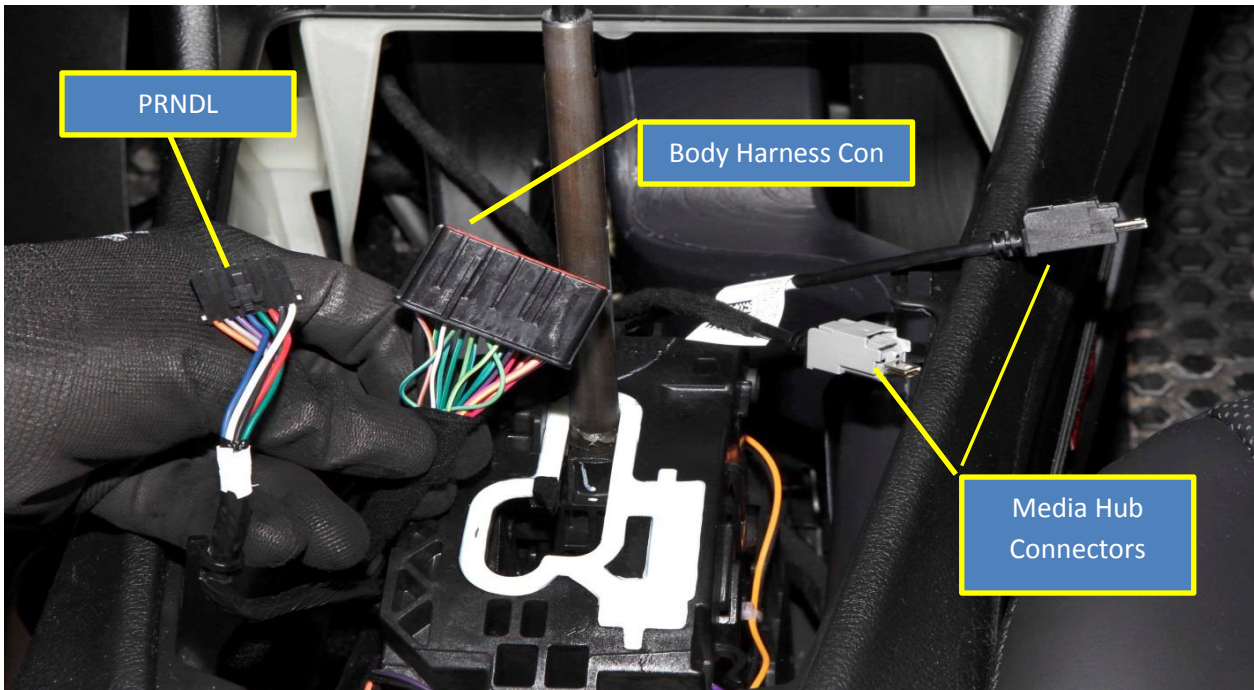

7. Re- Connect the battery & Position the seat fully forward.
8. Dis-Connect the battery negative.
9. Using a small pick/pry tool or equivalent, remove the fastener covers (2) located near the lower rear of the console. Remove the fasteners (3) behind the covers.
10. Using a small pick/pry tool or equivalent, disengage the retaining tabs/clips securing the switch pod (2) to the instrument panel.

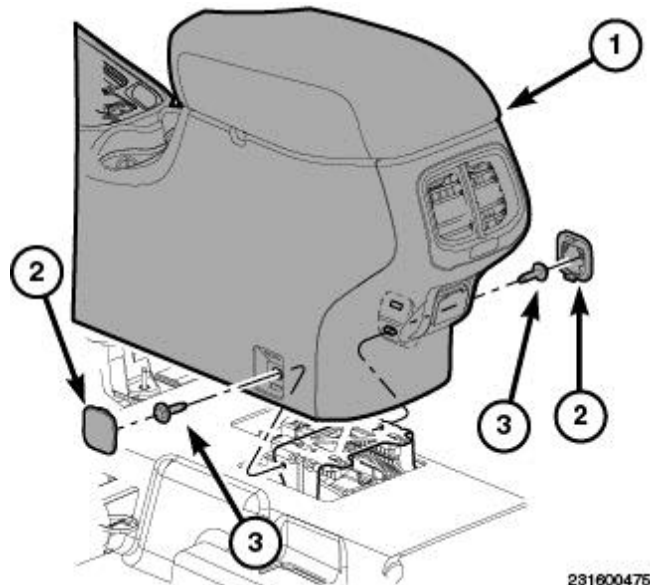

2316004754

11. Remove the two fasteners (2) from the floor console (1).

12. Disconnect the electrical connectors (3).

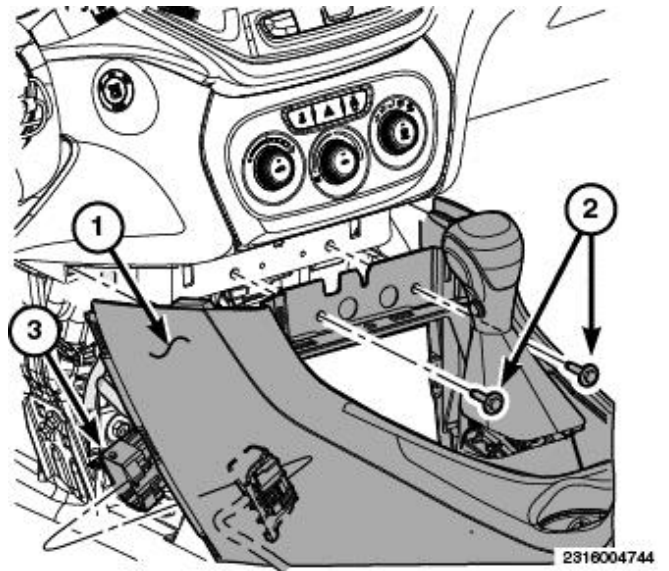

13. Lift the console up at the rear and remove from the vehicle.



14. Mark Location for switch in center console by using Red Switch Cover.



15. Drill 15/32" hole in center console storage compartment.





16. Mount switch and switch cover into the center console.



17. Make sure the wire leads from the switch are on the Passenger side of the air duct in the console.



18. Position the console into the vehicle while making sure not to trap or pinch any wire harness bundles and connect the electrical connectors (1).

19. Connect the electrical connector (3).

20. Install the two fasteners (2) into the floor console (1) and tighten securely.

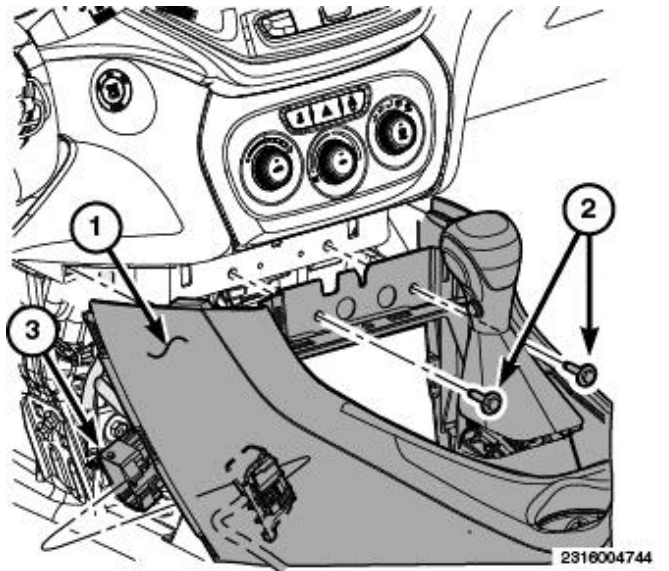

21. Install the rear fasteners (3) securing the console. Tighten the fastener securely. Repeat on the opposite side.

22. Install the fastener cover (2) located near the lower rear of the console. Repeat on the other side.

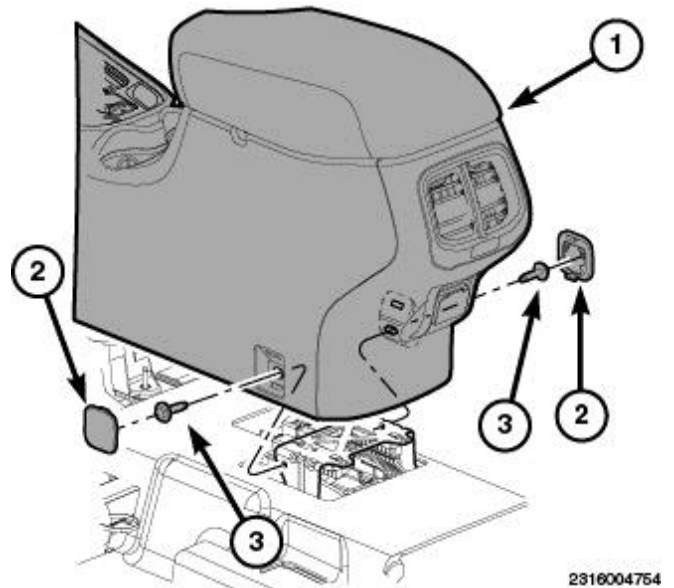

23. Connect the electrical connectors (1, 3, 4) and seat the console bezel (2) fully.

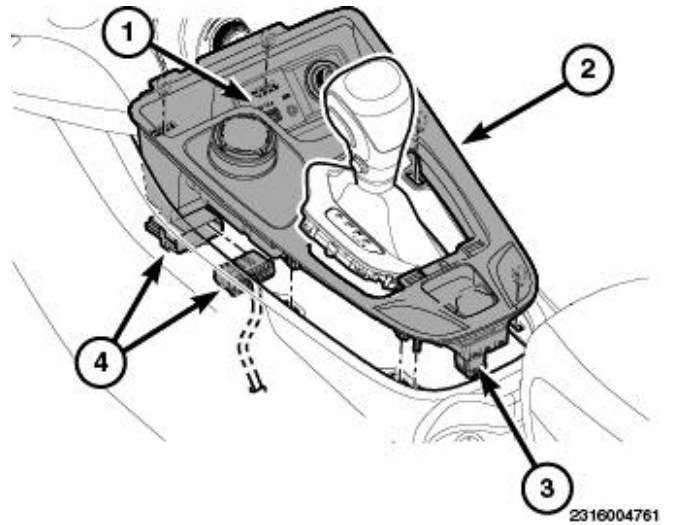

24. Position the trim panel (3) back into place over the front console fasteners and seat the clips fully.

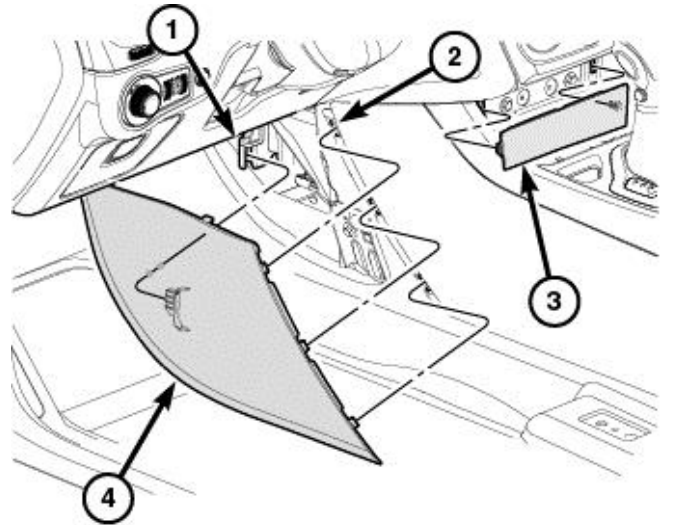

25. Accessing from the front of the floor console (1), align and position the gap hidens (2).
26. Hand tap to engage the retaining tabs securing the front gap hidens (4).

27. Position the shifter bezel (1) back in place and seat fully.
28. Install Shifter Knob

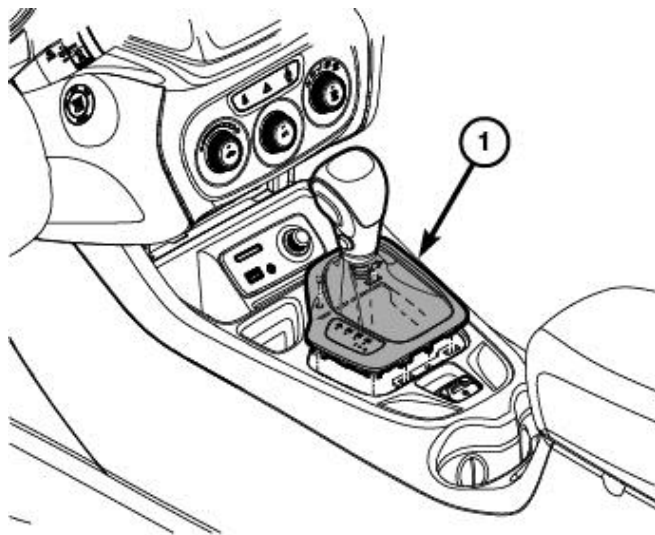

2316004757

29. Remove Rear of Center Console Trim Cover.



30. Plug the CAN block provided into one of the connectors on the switch.
31. Locate the Green CAN block under the Center Console and remove the EPS connector from the block. The EPS connector has one Yellow wire & one Yellow w/Brown tracer wire.

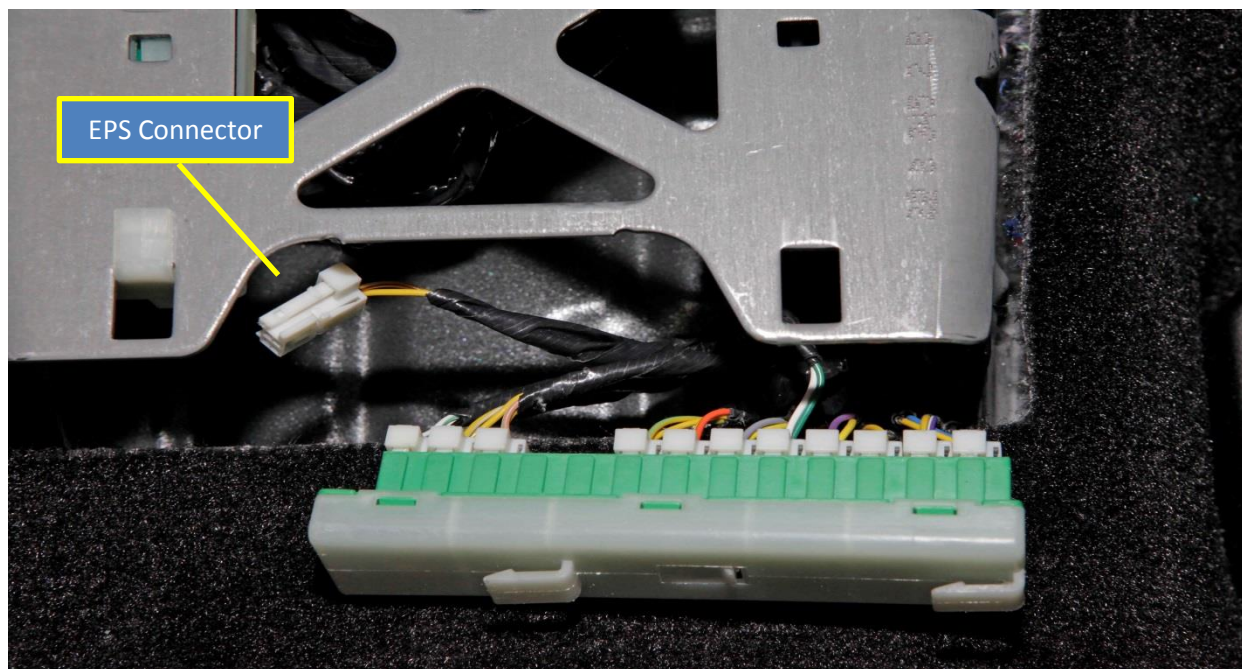

32. Plug this connector into the New CAN block with the switch.
33. Plug the remaining connector from the switch into the vehicle CAN block.
34. Mount Vehicle CAN back in original location and New CAN block as shown, stowing wiring from the switch underneath the bracket.

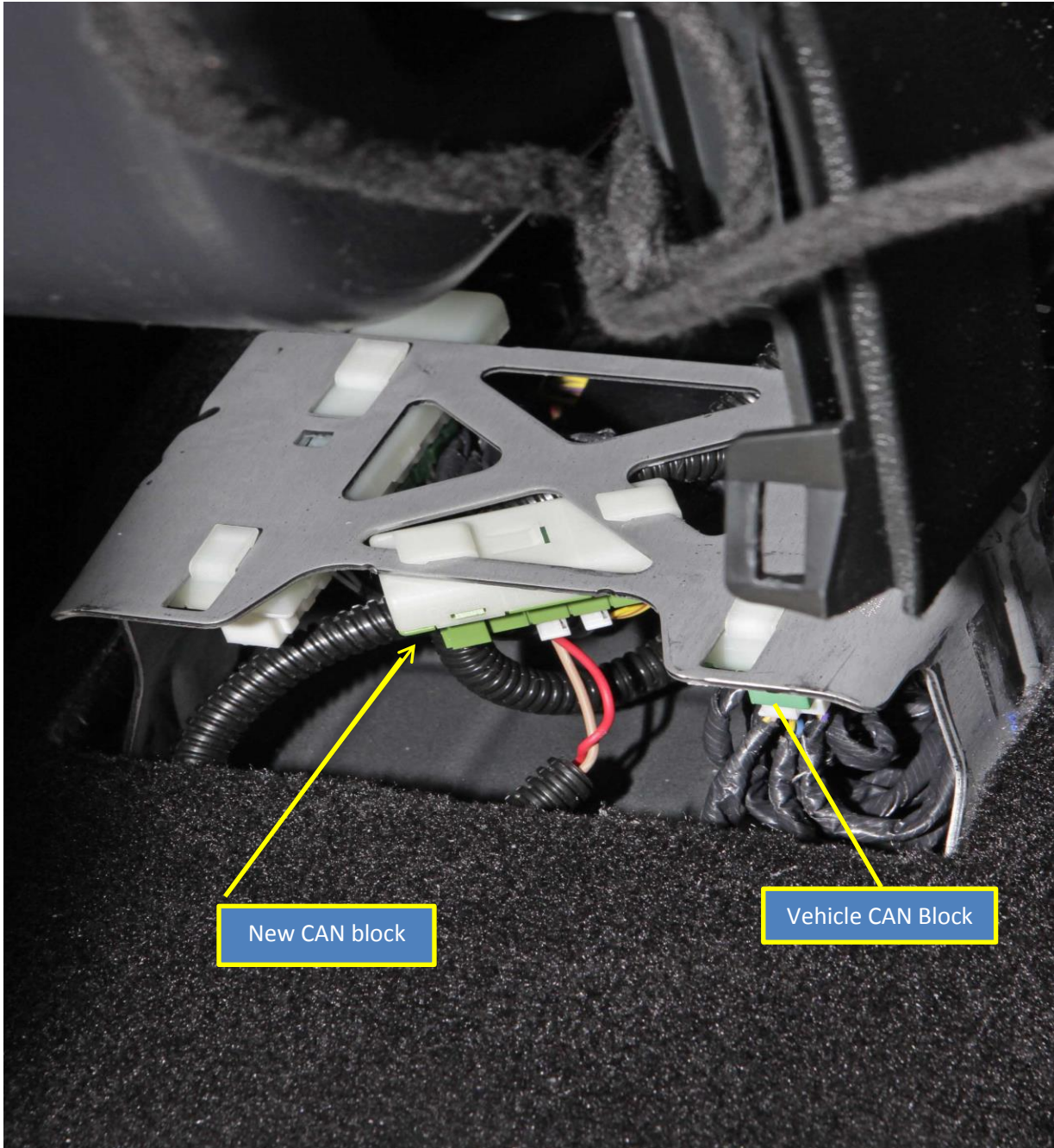

35. Replace Rear Center Console Trim Cover.

36. Remove PDC cover in Engine Compartment.



37. Disconnect Connector from PDC

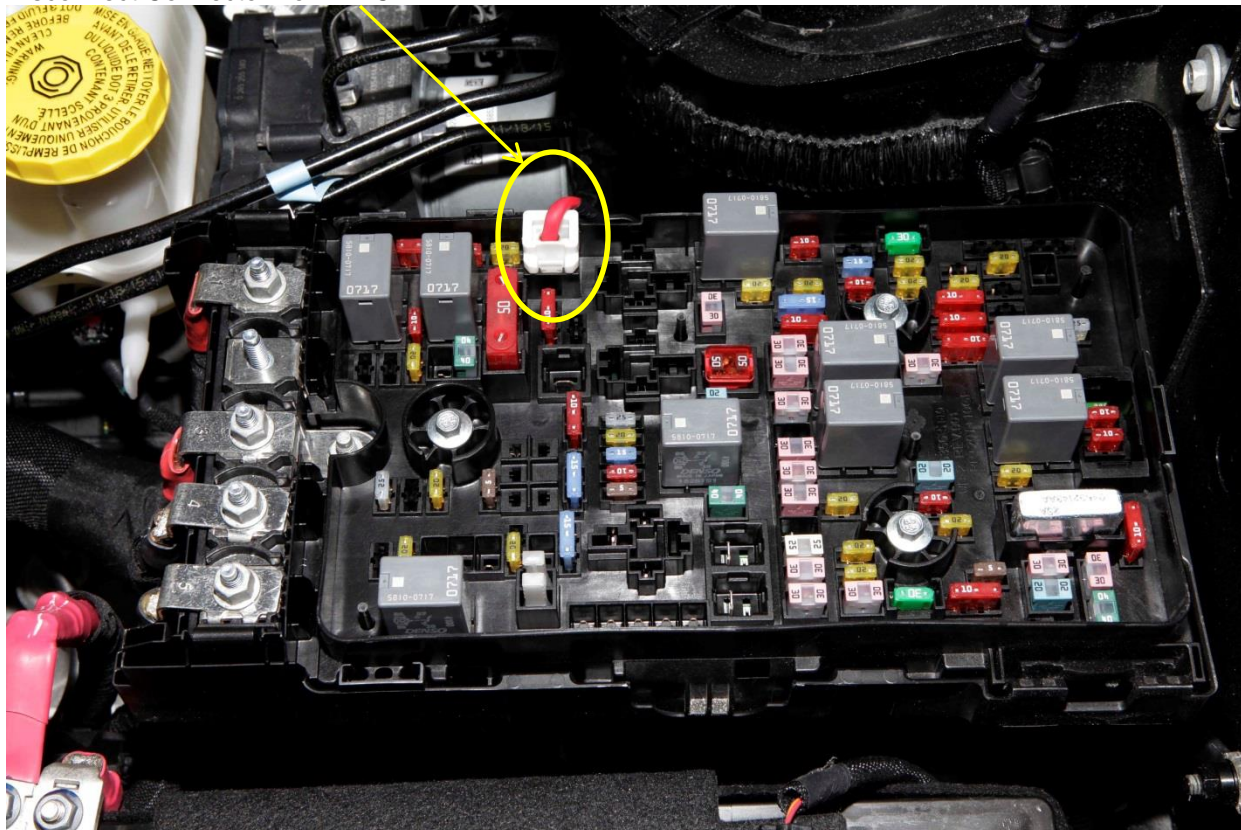

38. Remove the PDC Z-Case Fuse Array by removing nut (1) & releasing retaining tabs (3).

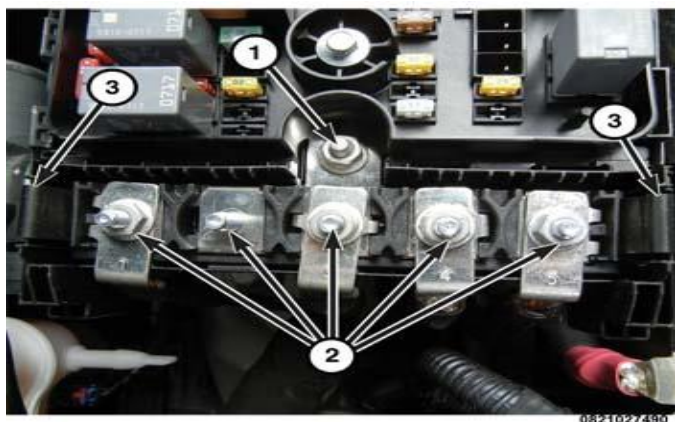

39. Loosen the three screws (2) that secure upper tray of the PDC. These screws are captured and cannot be completely

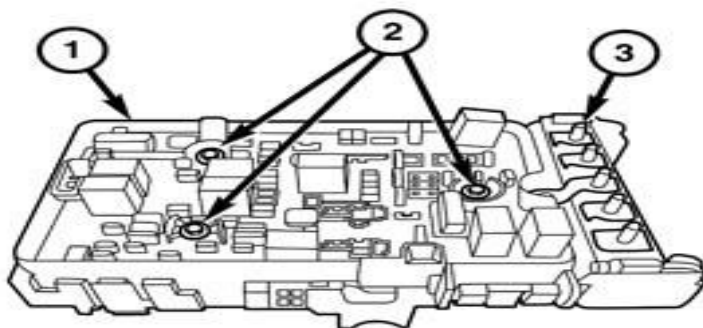

removed .

0822008650

40. Release the plastic clips that secure the PDC to the tray.
41. The PDC upper tray will now lift upward. Carefully lift tray and disconnect the three bulkhead connectors (2) from the bottom.

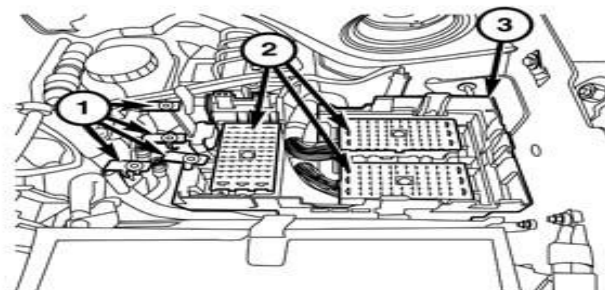

42. Remove tie strap and back cover from C4 PDC Connector.

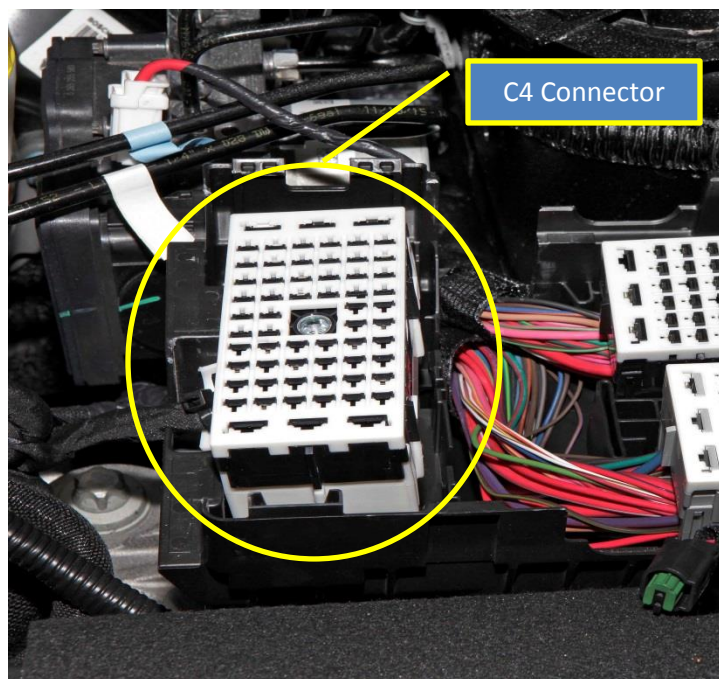
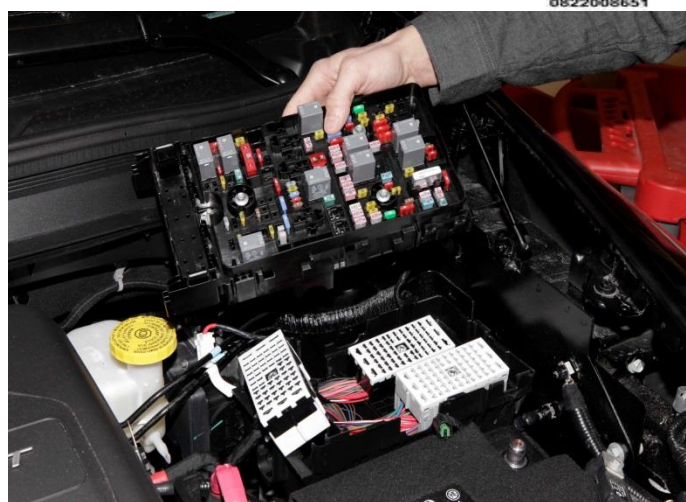

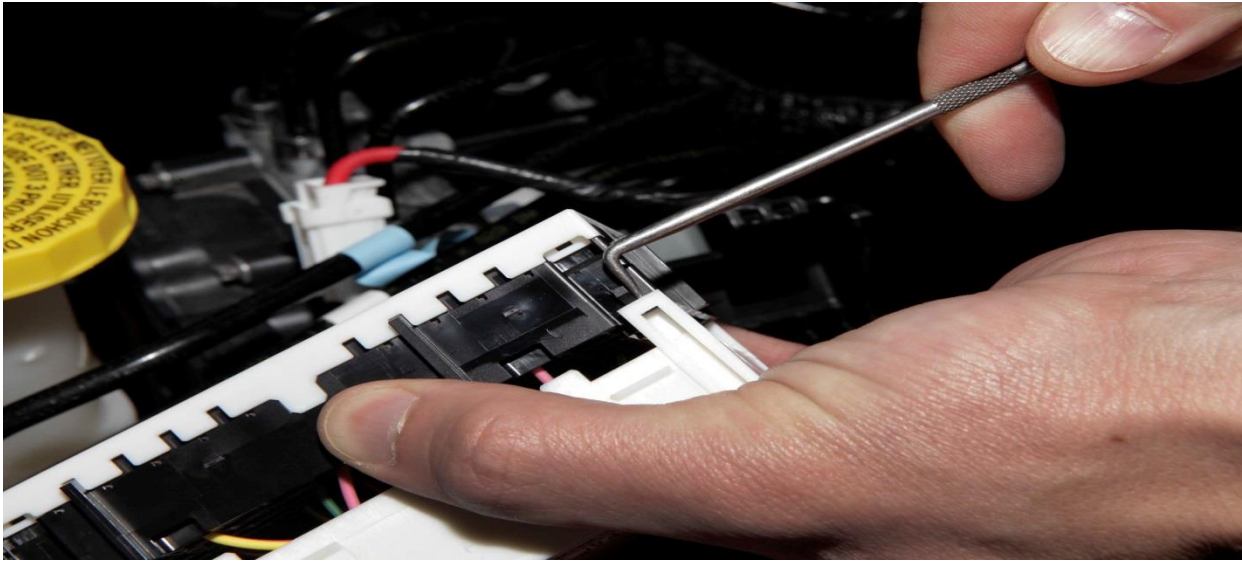

43. Locate pin 53 PK/LG on the C4 connector and cut the circuit 70mm behind the connector, remove tape as required.

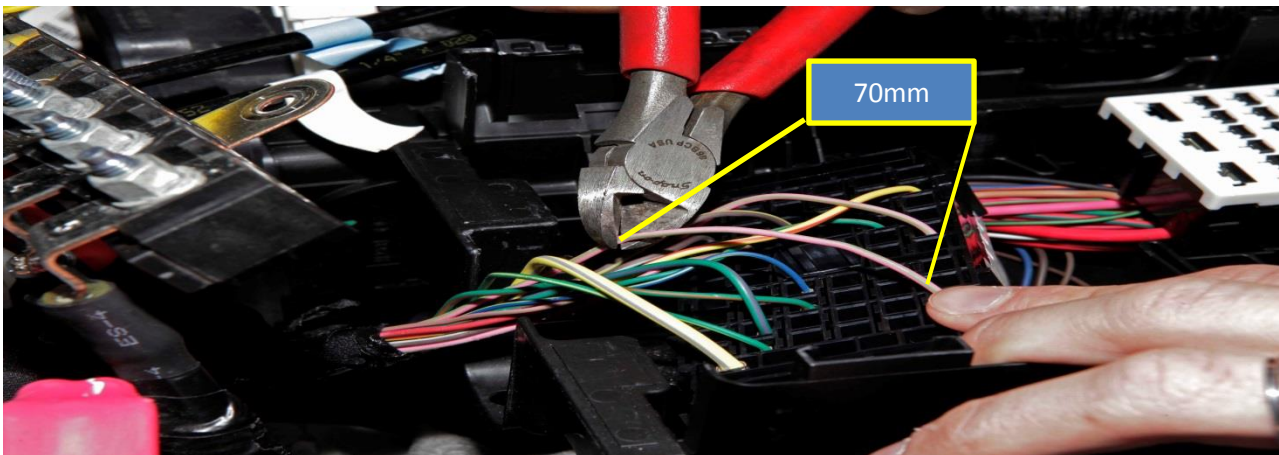
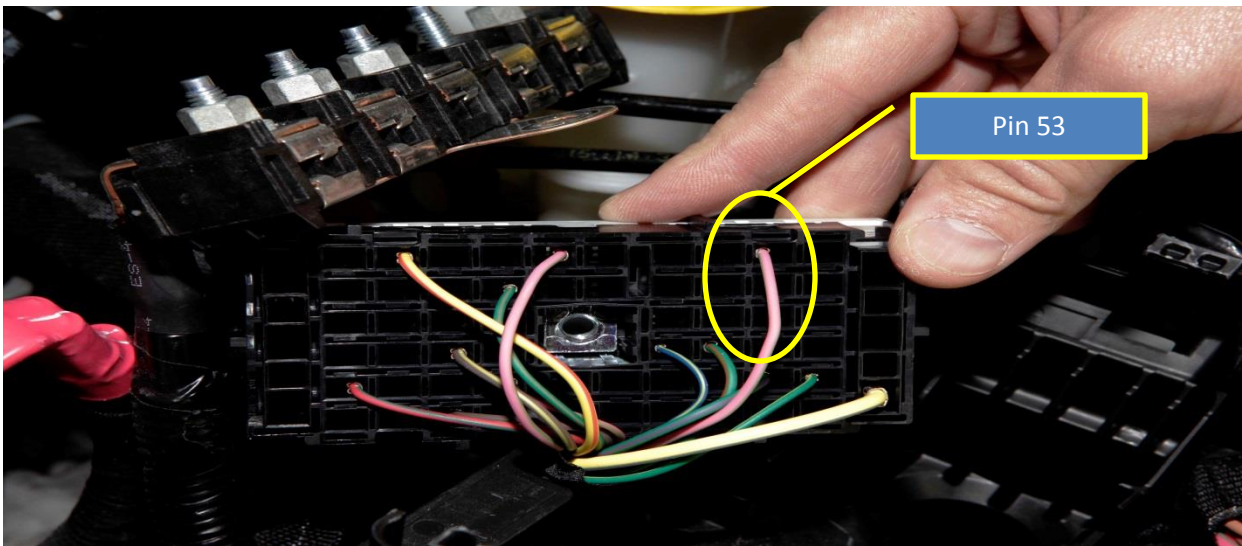

44. Slide Heat Shrink Tube over wires on the jumper harness.
45. Splice the PK wire from the jumper to pin 53 of the C4 connector using solder and splice band.

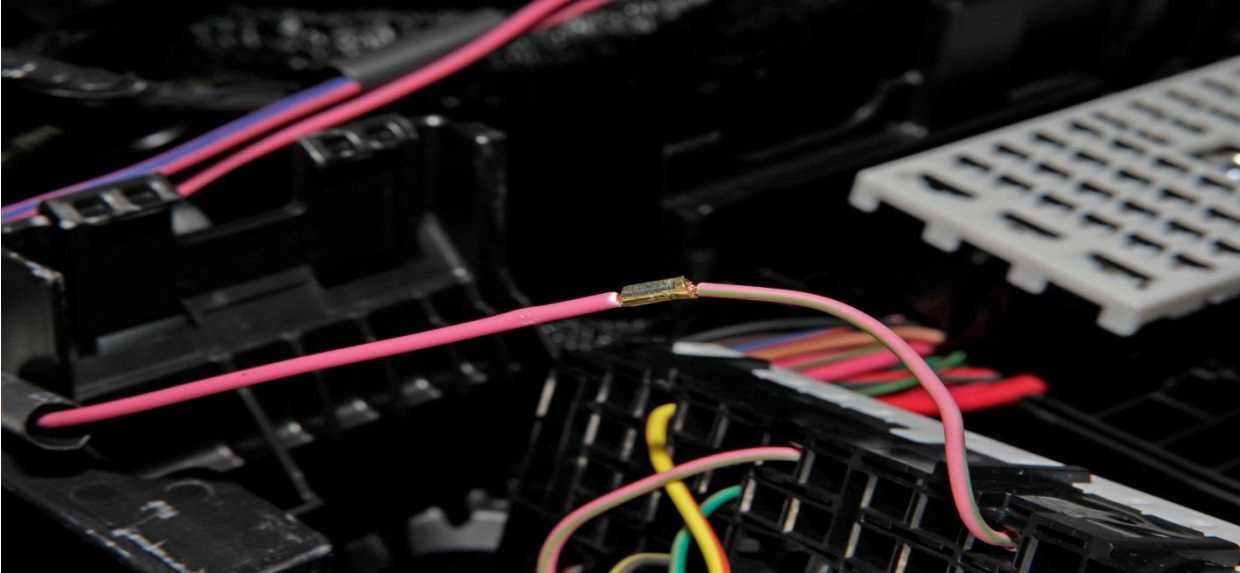

46. Splice the PK/DB wire from the jumper to the PK/LG wire from the harness bundle using solder and splice band.

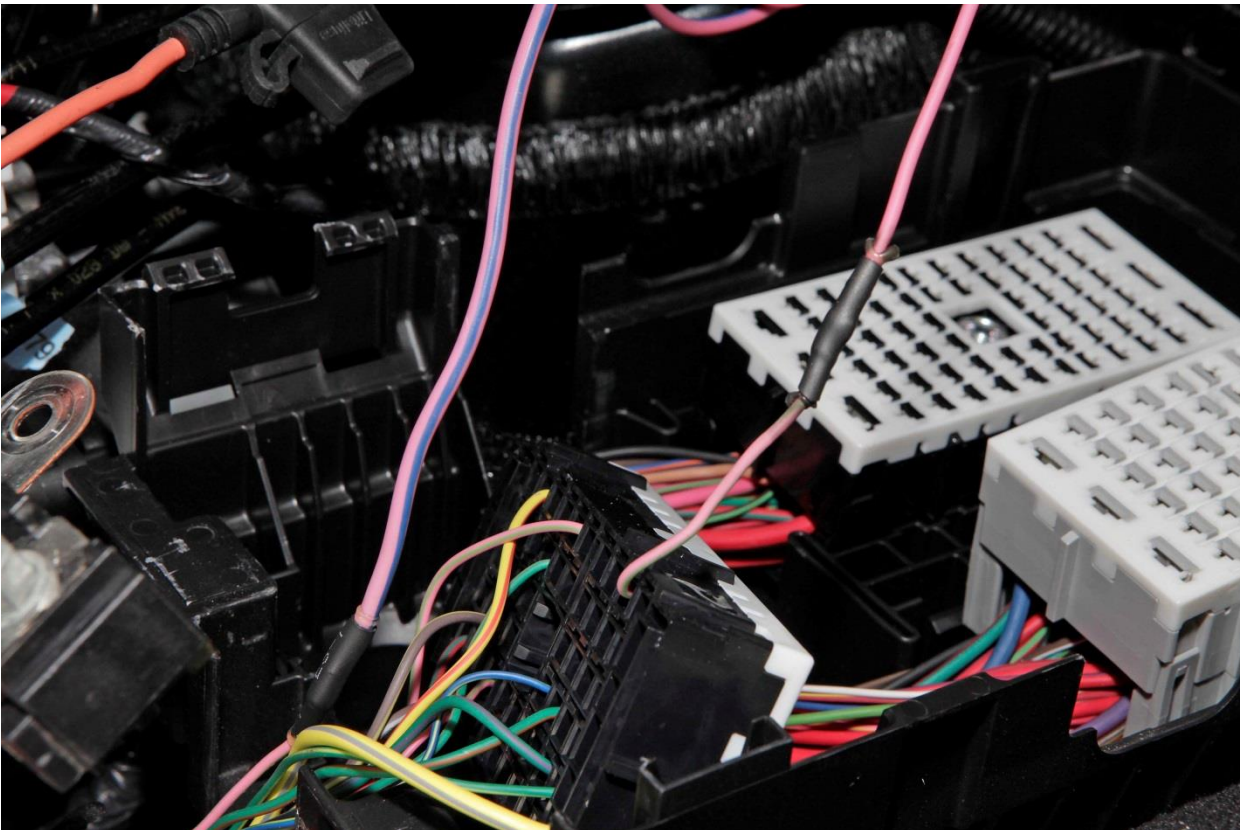

47. Slide Heat Shrink tube over the splice bands and use Heat Gun to shrink the tube around the wire until the glue protrudes from both sides to seal the splice.
48. Add Cover back on to the C4 connector and place Tie-Strap to hold wire bundle to the cover.

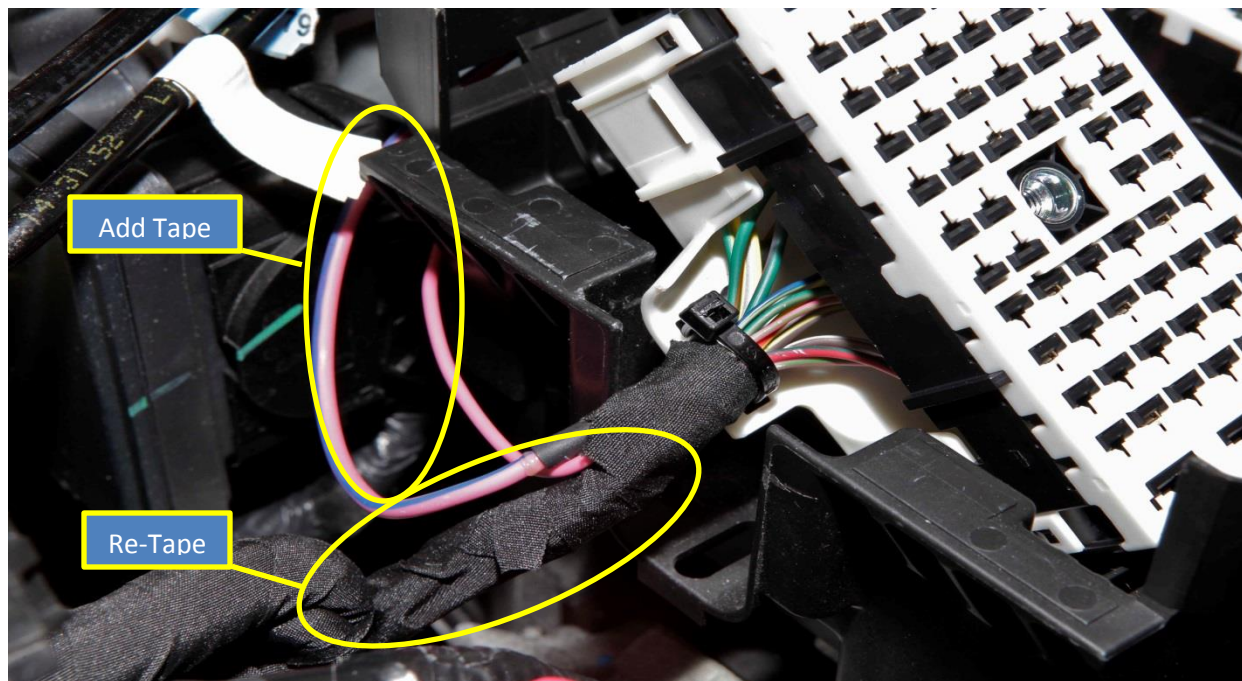

49. Re-Tape main harness bundle back up using Tesa Tape (68065586AA)
50. Tape exposed circuits together all the way back to where they exit the jumper harness using Tesa Tape (68065586AA).
51. Route jumper harness behind PDC and then along the left rail.

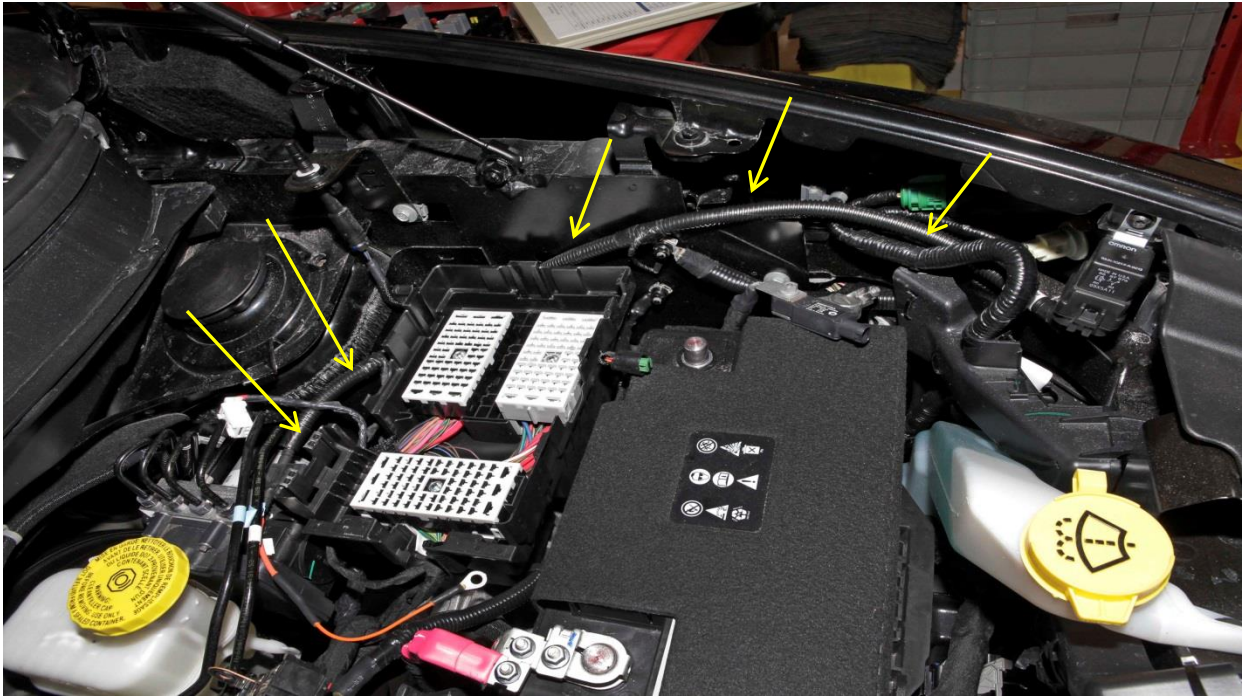

52. Attach Ground from jumper to G909A.

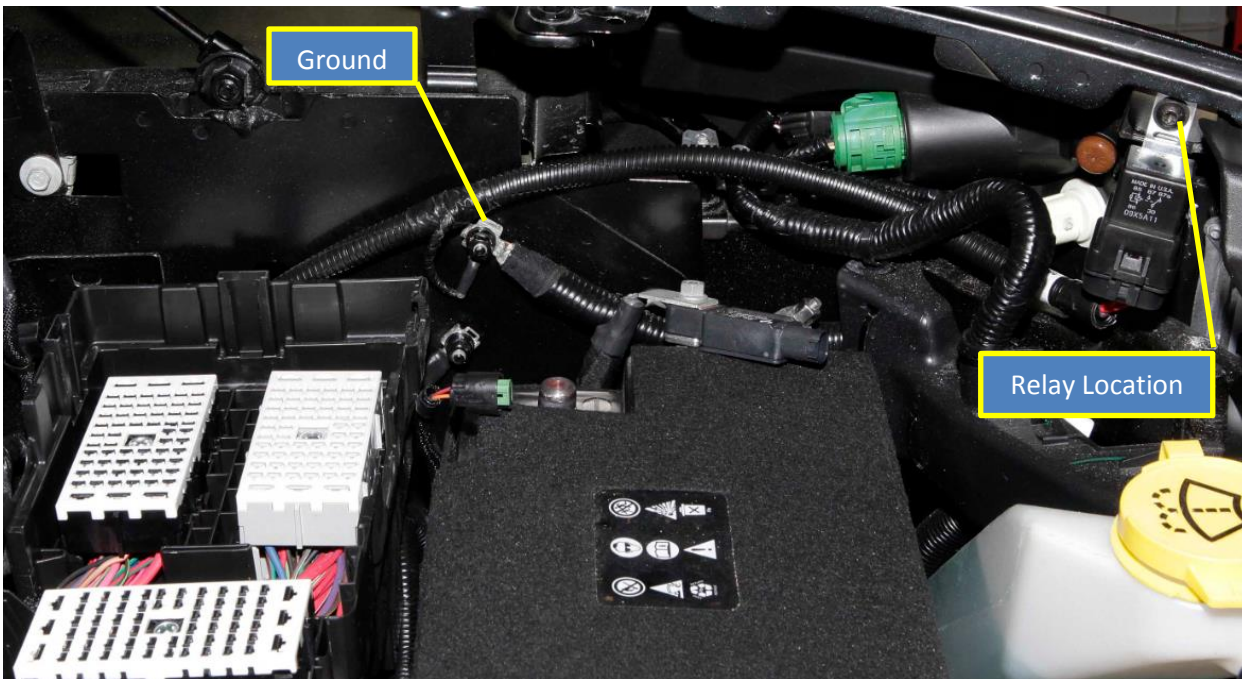

- 53. Mount relay using fender bolt above the left headlamp.
- 54. Position the upper PDC tray to the PDC base in the engine compartment.
- 55. Re-Connect the connector.

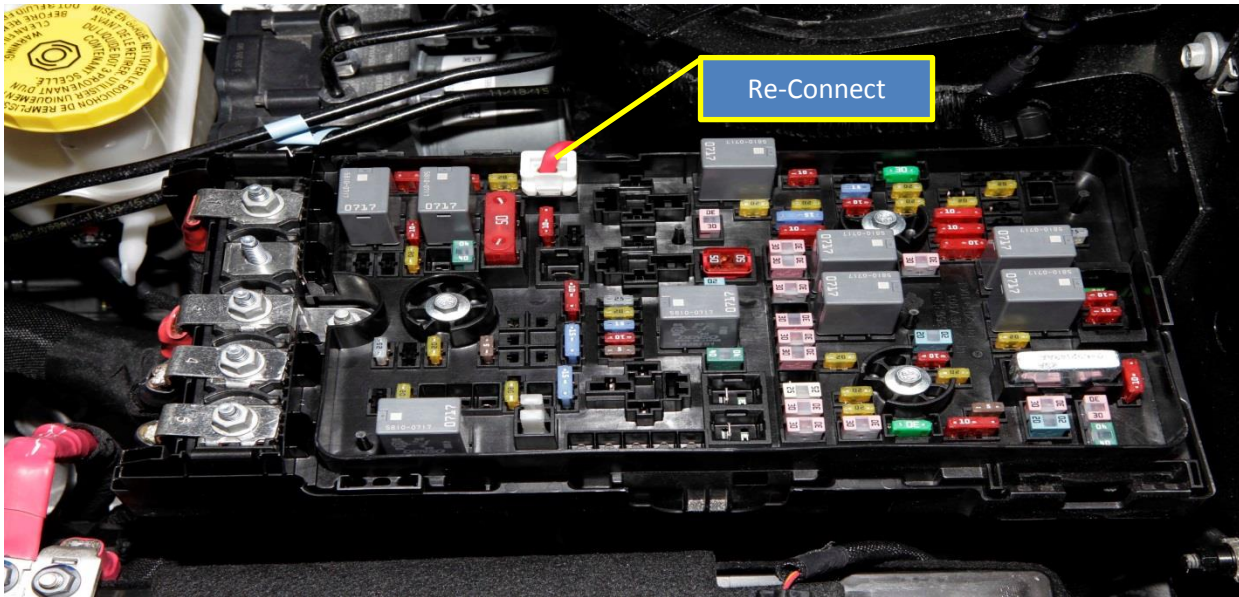

56. Connect the three bulkhead connectors located in the base of the PDC to the upper PDC tray bottom.

57. Tighten three screws (2) through the upper PDC tray until secure. Do not over tighten and crack the base or upper tray.

58. Re-Connect the PDC Z-Case Array (3) to the PDC.
59. Route the fuse holder on the jumper behind the PDC.

60. Attached the power feed from the jumper to the open stud on the (2) PDC Z-Case Array using nut part number **06101802**.

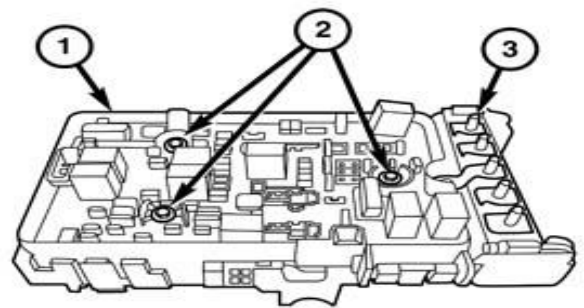

0822008650

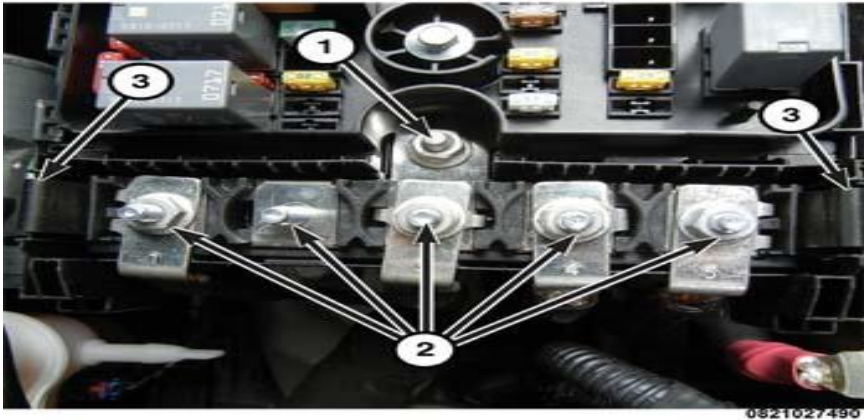

(1) Z-Case Nut, (2) Z-Case Studs, (3) Z-Case Release Tabs

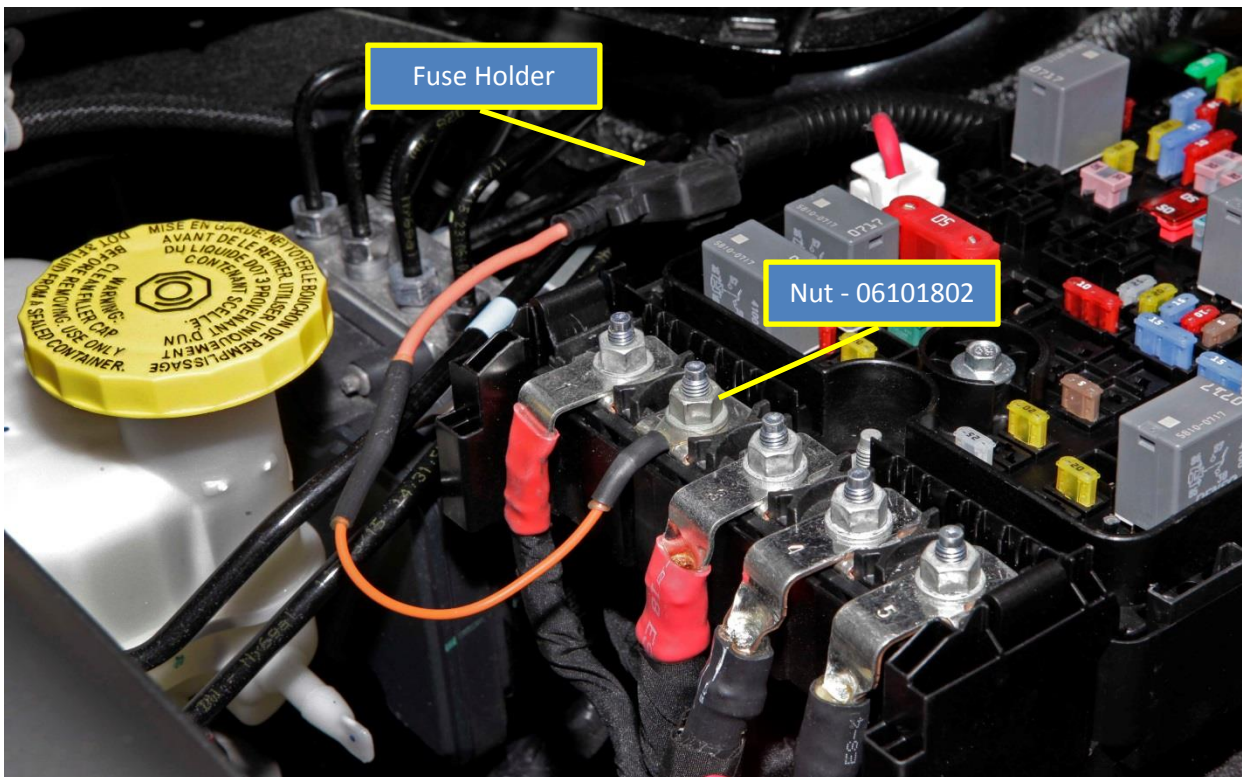

61. Install the PDC cover onto the PDC assembly.
62. Remove the 10Amp Fuse from the **Fuse Holder**.
63. Ensure that the Toggle Switch is in the Down Position (Drive Mode).
64. Connect the negative battery cable. If equipped with an Intelligent Battery Sensor (IBS), connect the IBS connector to the negative battery cable.

65. Perform EPS Verification Test

1. Turn the ignition off.
2. Remove all test equipment.
3. Connect all previously disconnected components and connectors.
4. Verify all accessories are turned off, the battery is fully charged and the charging system has a status of "charged".
5. Verify that the ignition is on. With the scan tool, record and erase all Diagnostic Trouble Codes (DTCs) from all modules. Start the engine and allow it to run for two minutes and fully operate the system that was indicating the failure.

NOTE: Turn the steering wheel from stop to stop, holding at each stop position for One second.

6. Turn the ignition off and wait five minutes. Turn the ignition on and using the scan tool, read DTCs from all modules.
7. If there are no DTCs present after turning ignition on, road test the vehicle for at least five minutes.
8. Again, with the scan tool read DTCs. If any DTCs are present, refer to the Table of Contents in the applicable section for the Diagnostic procedure and troubleshoot the new or recurring symptom.
9. If there are no DTCs present and the customer's concern can no longer be duplicated, the repair is complete

66. Place 10Amp Fuse in cup holder.

67. GIVE USER INSTRUCTIONS TO CUSTOMER.