

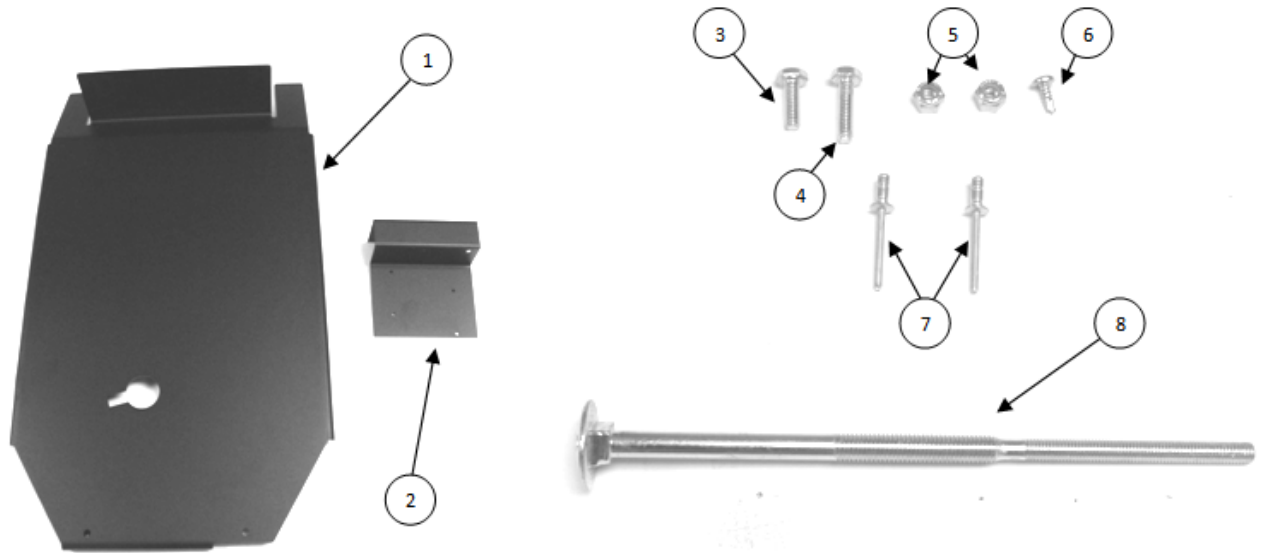

# Spare Tire Mounting Bracket

## DODGE CHARGER



Item	Qty	Description
1	1	Spare Tire Mounting Bracket
2	1	Fuse Holder & Antenna Mounting Bracket
3	1	1/4 x 20 x 3/4 Grade 5 hex head bolt
4	1	1/4 x 20 x 1 Grade 5 hex head bolt
5	2	1/4 x 20 nylock nut
6	1	Phillips Screw 10 x 0.50
7	2	Rivet Pop 3/16 Alum
8	1	Full Size Spare Tire Bolt

1. Refer to official Chrysler procedure for parts removal required to install the spare tire relocation bracket.
2. Remove spare tire & jack and save for reinstallation.
3. Remove and discard OEM spare tire bracket. Use 13mm and 18mm hex sockets.
4. Remove and discard metal clips.
5. Remove trunk remote control antenna from trunk, carefully slide the clips out.
6. Secure antenna to bracket (item 2) using two rivets (item 7).
7. Dry fit bracket (item 1) on the mat by inserting the front tabs. Mark rubber mat with white marker and cut out marked section.
8. Insert bracket tabs (item 1) inside trunk slots. Secure bracket (item 1), use bolt (item 4) with one nut (item 5) on the LH side hole. Torque to 11 N-m.
9. Slide in bracket (item 2) with antenna under bracket (item 1) RH side and line up holes.
10. Secure brackets (item 1 & 2) with one bolt (item 3) and one nut (item 5). Torque to 11 N-m.
11. Secure bracket (item 2) hole using screw (item 6) through second hole.
12. Position tire on bracket (item 1). Insert bolt head (item 8) through tire and center hole of bracket (item 1). Slide bolt (item 8) to slot. Position jack on tire passing bolt (item 8) through jack and secure as shown.

