

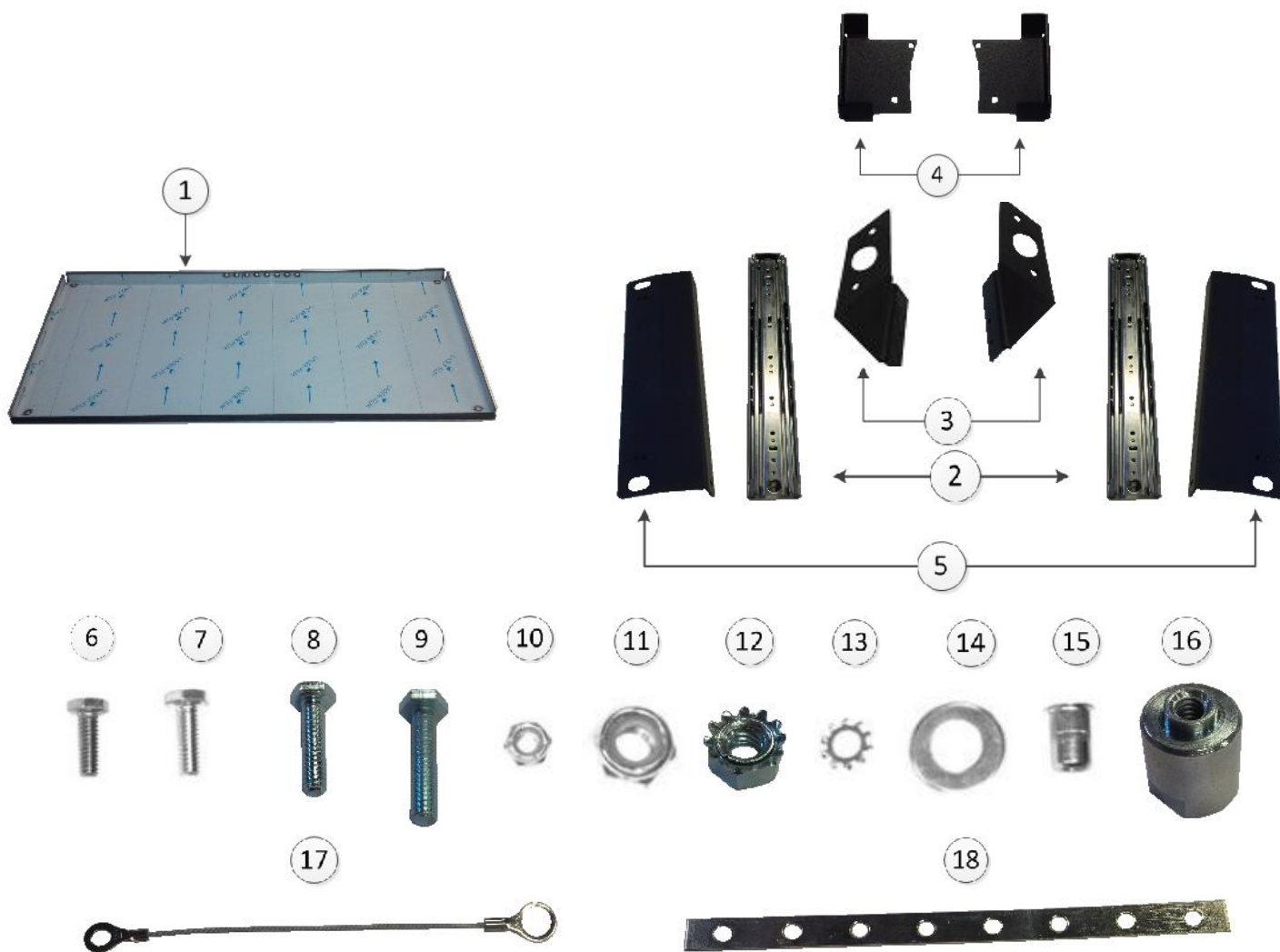

# Trunk Tray

DODGE CHARGER

www.mopar.com



Item	Qty	Description
1	1	Aluminum Trunk Tray
2	2	Drawer Slides
3	1LH & 1RH	Strut Top Mounting Brackets
4	1LH & 1RH	Tray Slide Impact Stops
5	2	Mounting Brackets: Trunk Tray to Drawer Slide
6	12	1/4"-20 Grade 5 Hex Head Bolt 3/4" Long
7	6	1/4"-20 Grade 8 Hex Head Bolt 3/4" Long
8	8	1/4"-20 Grade 5 Hex Head Bolt 1" Long
9	2	1/4"-20 Grade 8 Hex Head Bolt 1-1/4" Long
10	12	1/4"-20 Nylock Nut
11	4	M10 Nylock Nut
12	8	1/4"-20 Nut with External Tooth Lock Washer
13	26	1/4" External Tooth Lock Washer
14	4	M10 Flat Washer
15	8	1/4"-20 Rivet Nut
16	2	Lock Bushing
17	2	6-1/4" Lanyard
18	1	Ground Bar

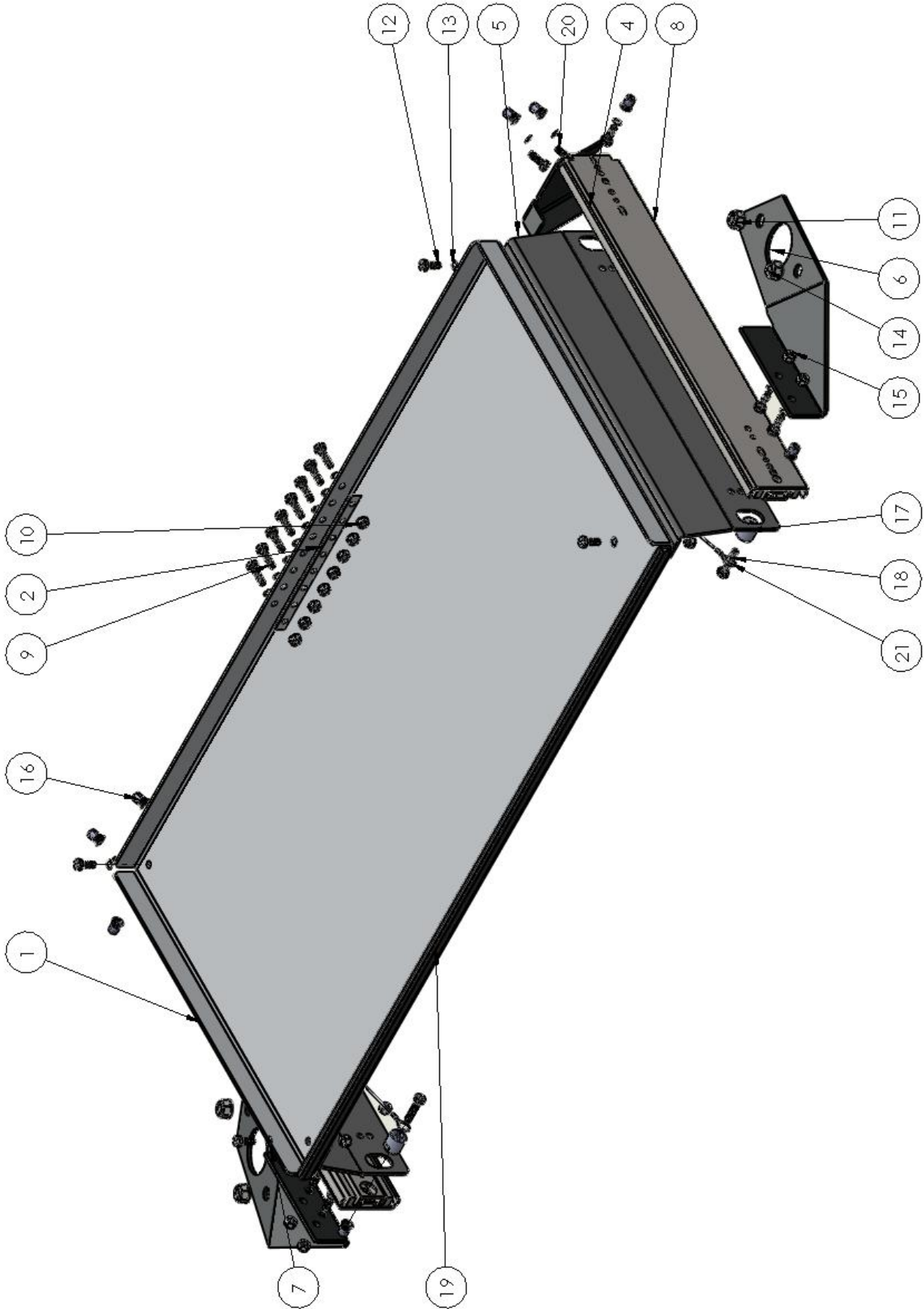

1. Before installation, refer to official Chrysler procedure to remove and install OEM parts listed in this Instruction Sheet. Refer to Chrysler "Non-Folding Seat" removal instruction.
2. Pull up on front corners of rear seat (Picture 1) to disengage the retaining clips and remove the rear seat cushion.



Picture 1

3. Remove the 2 nuts securing the bottom of the seat back rest (Picture 2). Disengage the upper seat back snap fasteners by using a flat blade tool inserted at the top of the seat and pushing down on the spring fasteners to disengage (Picture3). Remove the backrest from the vehicle.

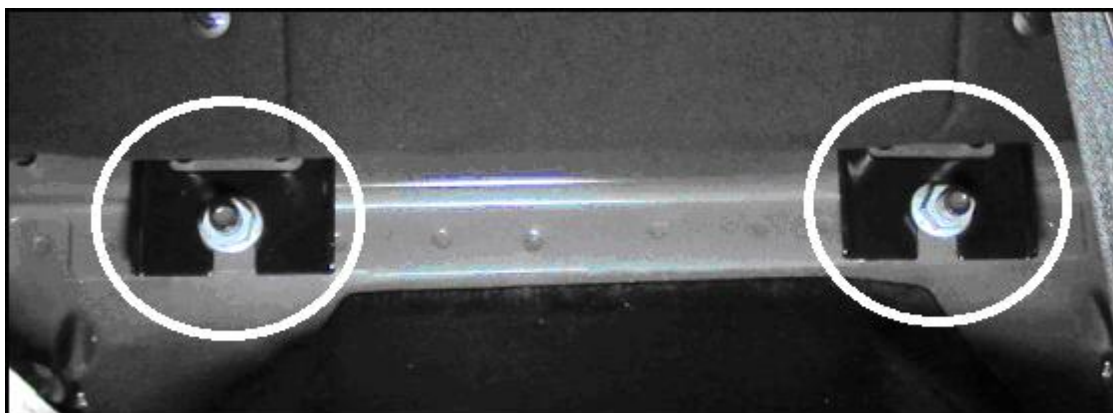

Picture 2



Picture 3

4. Remove trunk carpet as per Chrysler Carpet Removal Instructions.
5. Place impact stops (item 4) against the side panels shown in Picture 4a and 4b. Align the upper hole with the existing hole in the panel (hole #1 in Picture 5). Drill a pilot hole in the lower opening (hole #2 in Picture 5) with a 1/4" drill bit. Drill out both holes (#1 and #2) to 25/64" diameter. Apply corrosion inhibitor to the holes and allow 15 minutes to dry. Repeat for the opposite side of the vehicle.



Picture 4a



Picture 4b

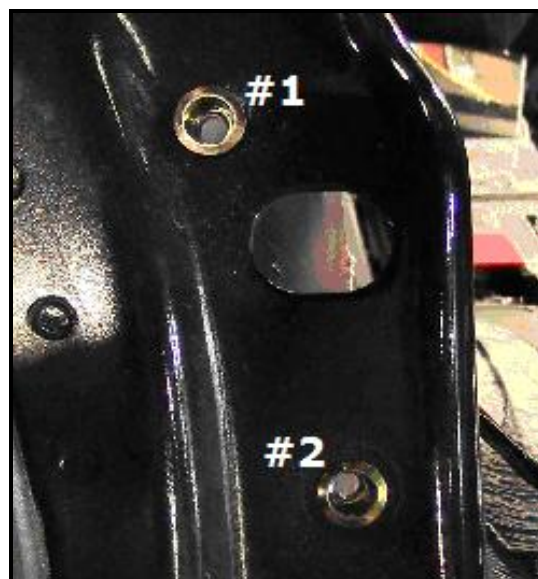

Picture 5

6. Refer to Picture 6 to locate the slotted hole #3. Hole #3 is located on the face of the side panel that is 90 degrees from holes #1 and #2. Drill out hole #3 to 25/64" diameter. Repeat on opposite side of vehicle. Apply corrosion inhibitor to the holes and allow 15 minutes to dry.



Picture 6

7. Install 6 rivet nuts (item 15) into predrilled holes (holes #1, #2 & #3 in Pictures 6). As shown in picture 7. Repeat on opposite side.

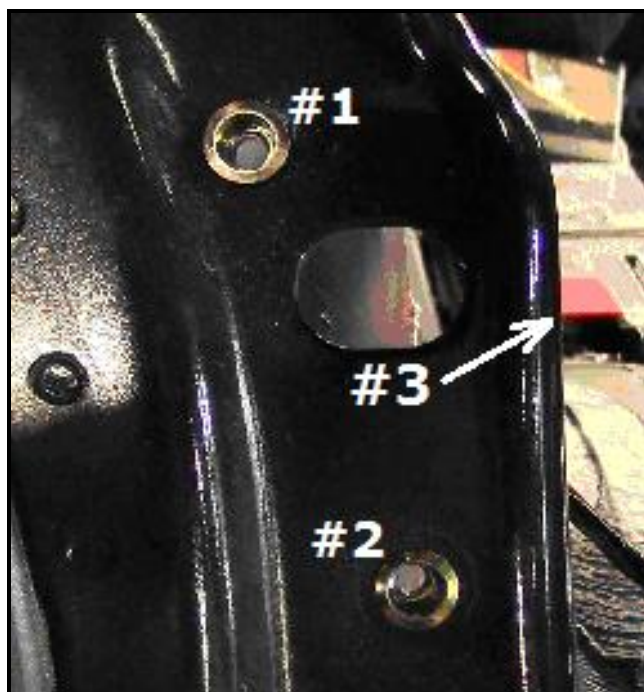

Picture 7



Picture 8

8. Install impact stops (item 4) as shown in Picture 8. Use qty 2 each of items 12 and 7. Torque to 14.5 N-m. Repeat on opposite side.



Picture 9

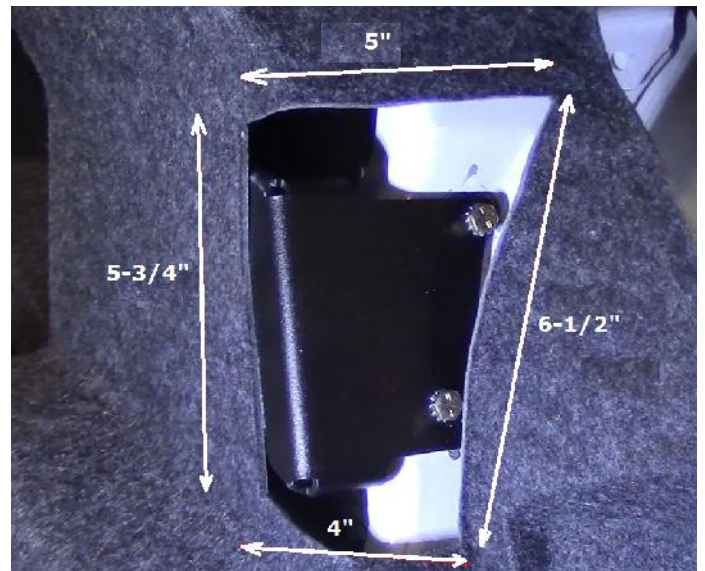

Picture 10

9. Trim quarter panel carpets to the approximate sizes shown in Picture 9 to allow impact stops to go through carpet (Picture 10). Before cutting, dry fit carpet in original position and use location of brackets to trace scribe lines for trimming.
10. Trim quarter panel carpets to approximate sizes shown in Picture 12 to allow Strut Top Mounting Brackets to go through the carpet. Before cutting, dry fit carpet in original position and use location of brackets to trace scribe lines for trimming to allow Strut Top Mounting Brackets to go through the carpet.



Picture 11

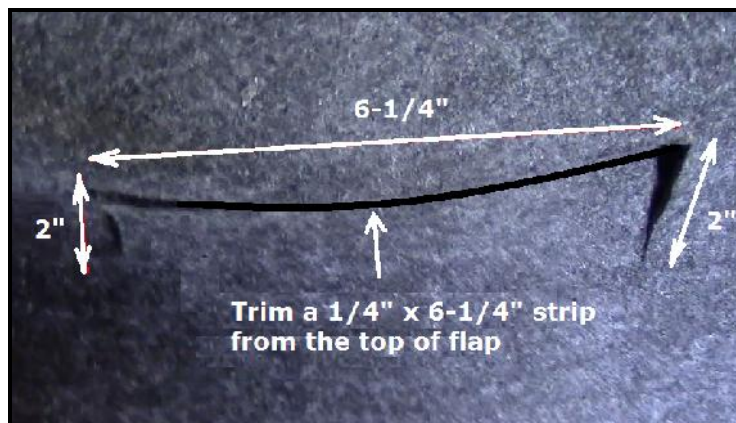

Picture 12

- 11. Install Strut Top Mounting Brackets, RH and LH (item 3). See Picture 13 & 14. Use qty 2 each of items 11 and 14. Torque to 20 N-m. Repeat on opposite side.



Picture 13



Picture 14

- 12. Reinstall trimmed quarter panel carpets and trunk carpet.

- 13. Drill last slotted hole in each drawer slide (item2) to 10 mm diameter using a 10 mm diameter drill bit (Pictures 15 & 16)

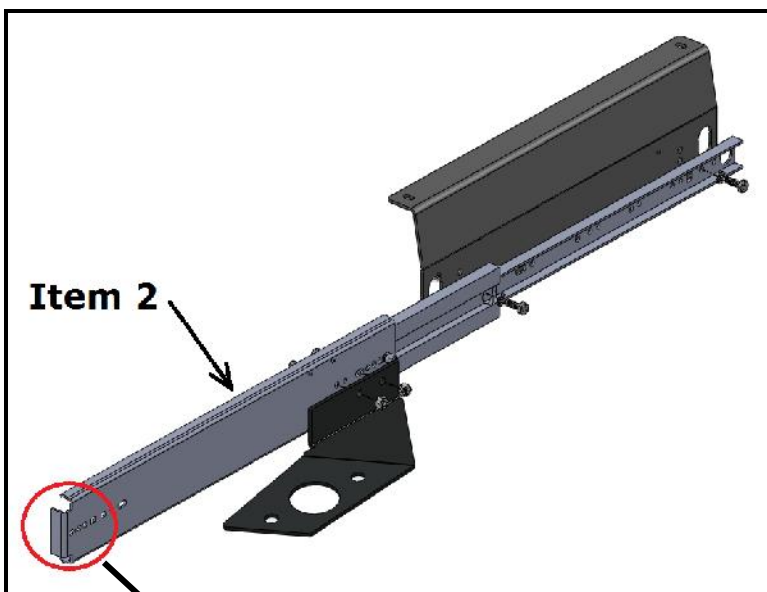

Picture 15

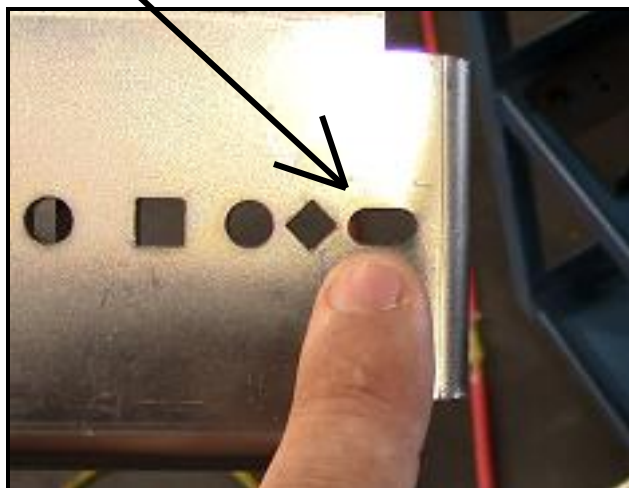

Picture 16

14. Fasten Mounting Bracket: Trunk Tray to Drawer Slide (item 5) to drawer slide (item 2) using qty 2 each of items 6, 10 & 13 as shown in Pictures 17 & 18. Torque to 11 N-m. Repeat on opposite side.

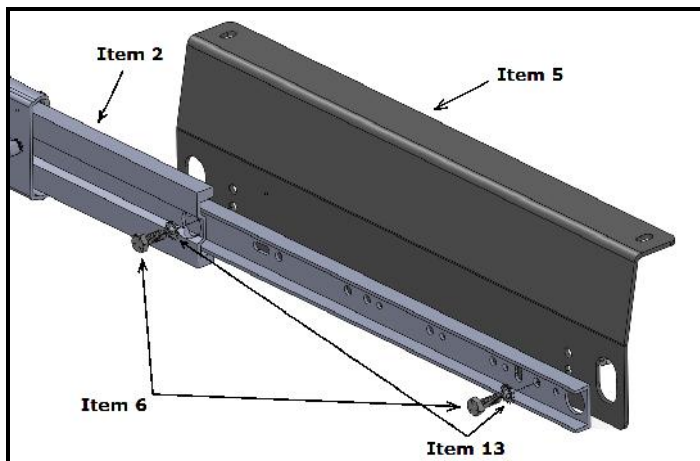

Picture 17

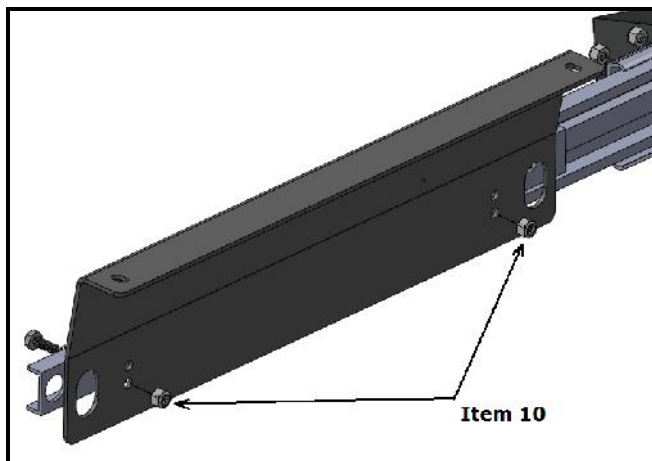

Picture 18

15. Fasten drawer slide to Strut Top Mounting Bracket (item 3) using qty 2 each of items 6, 10 & 13 as shown in Picture 19 & 20. Use the cutout hole in the middle drawer slide section (shown in Picture 20b) to insert bolts as shown in Picture 20. Torque to 11 N-m. Repeat on opposite side.

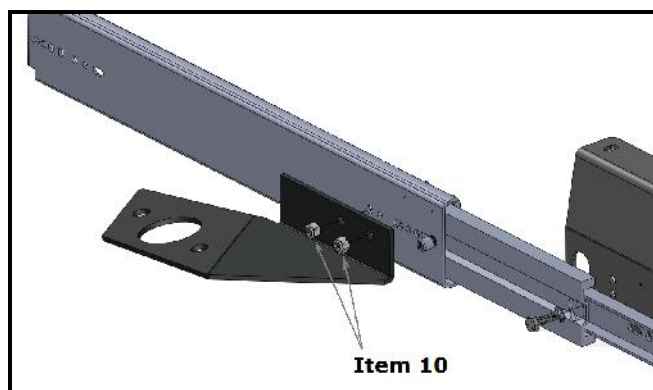

Picture 19

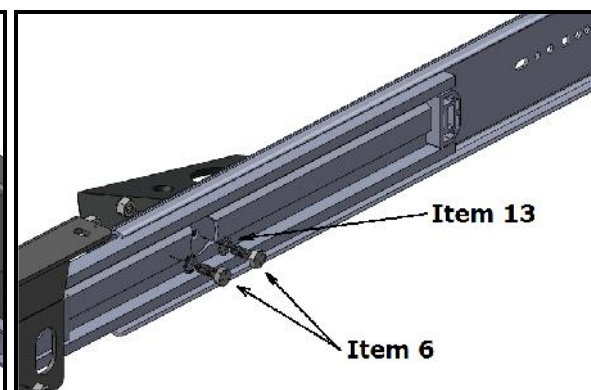

Picture 20a

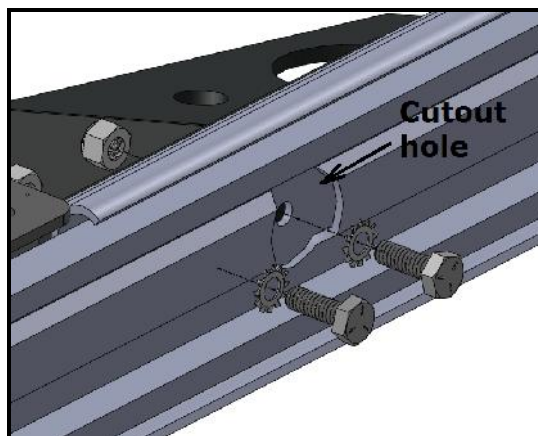

Picture 20b

16. Fasten drawer slide to vehicle through hole opened in Step 13 and hole #3 in picture 6 using qty 2 each of items 7 and 13 (refer to picture 21a and 21b). Torque to 14.5 N-m. Repeat on opposite side.



Picture 21a



Picture 21b

17. Remove film from trunk tray in area shown in Picture 22 and fasten Ground Bar (item 18) to Trunk Tray (item 1) in location shown in Picture 22 using qty 8 each of items 8, 12 & 13 as shown in Picture 23. Torque to 11 N-m.

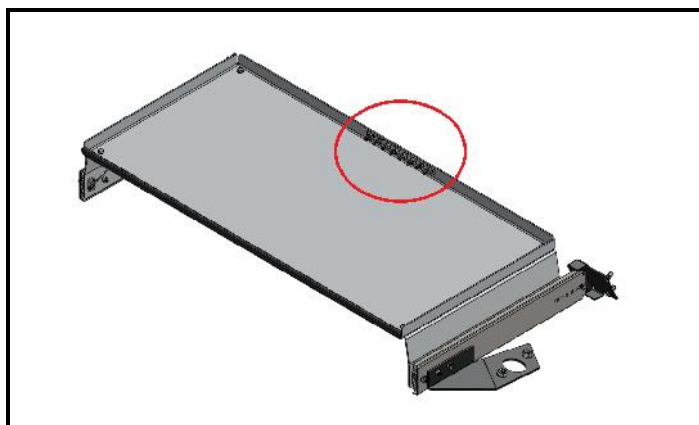

Picture 22

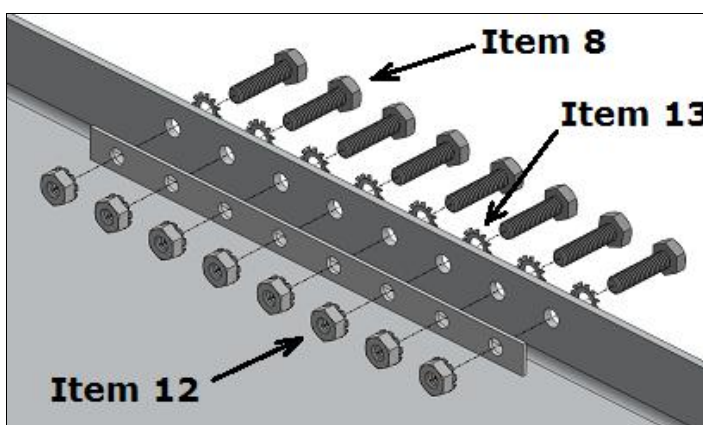

Picture 23

18. Mount aluminum tray (item 1) onto mounting brackets (item 5) using qty 4 each of items 6, 10 and 13 as shown in Picture 24a and 24b. During assembly, place item 6 through the small eyelet of item 17 between the mounting bracket (item 5) and nut (item 10) as shown in Picture 24a and 24b. Torque to 11 N-m.

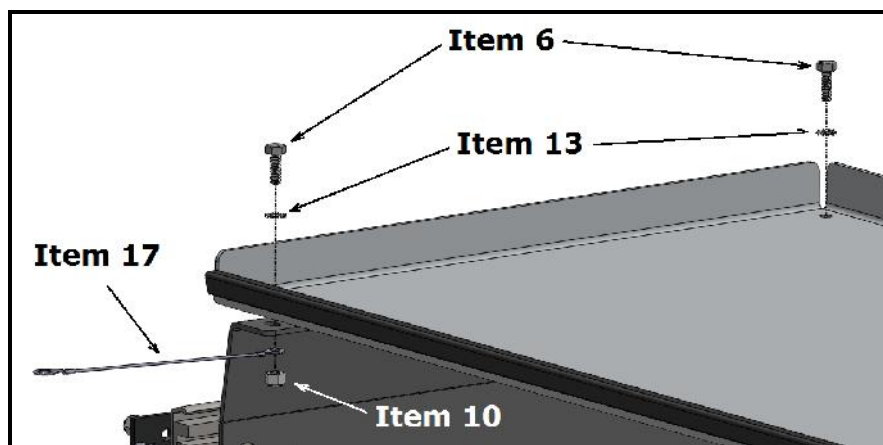

Picture 24a

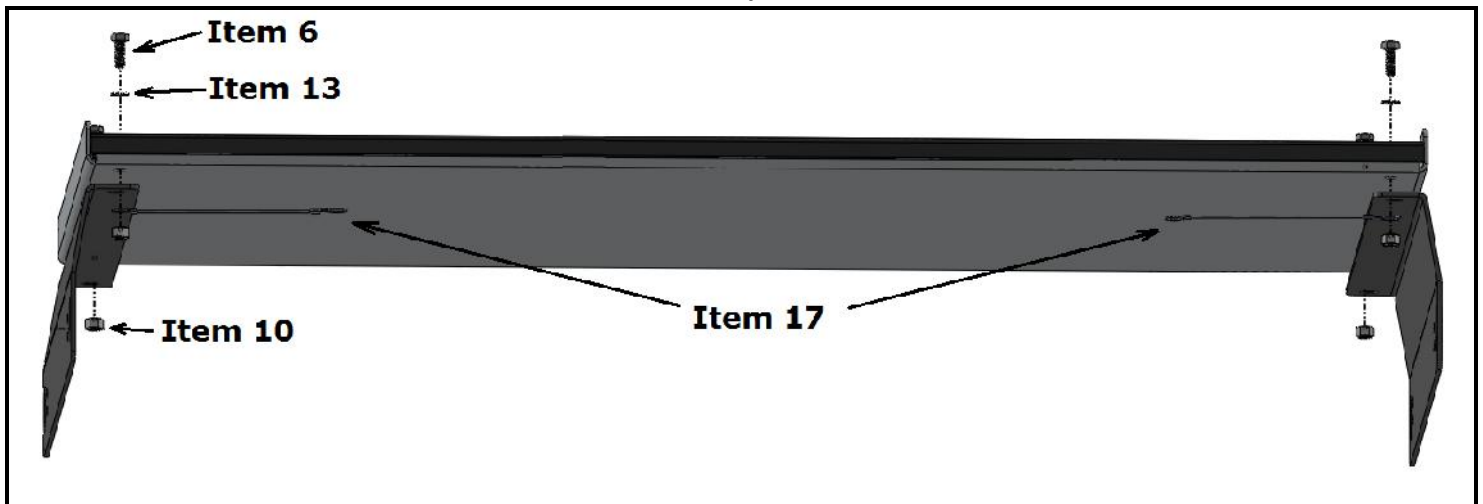

Picture 24b

19. Assemble Lock Bushing (item 16), Lanyard (item 17) and bolt (item 9) to drawer slides as shown in Picture 25. Repeat on opposite side. Torque to 14.5 N-m.

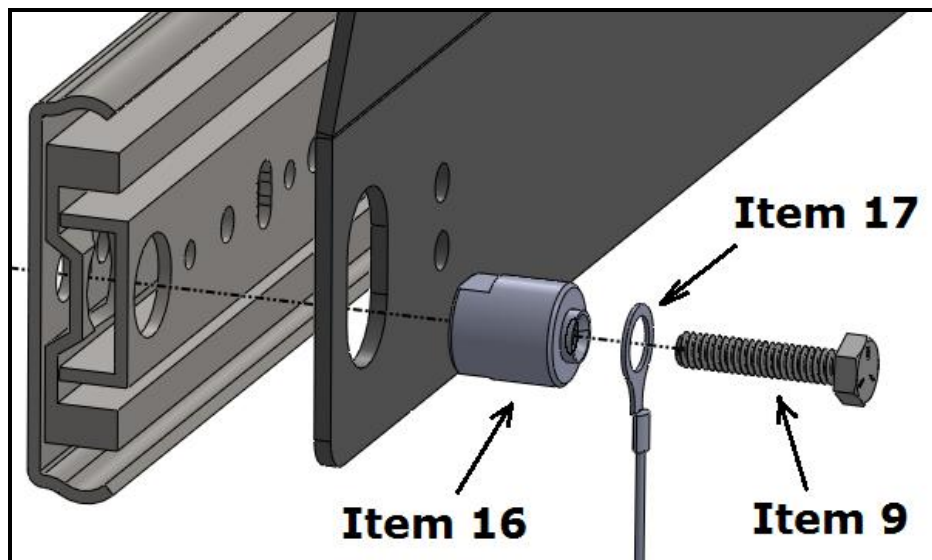

Picture 25

20. Reinstall rear plastic trim per official Chrysler procedures.
21. Reinstall rear seat back bench per official Chrysler procedures.

