

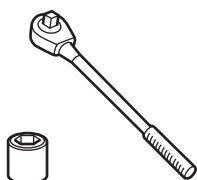

BEAD LOCK CAPABLE WHEEL RAM

www.mopar.com

82215259AB

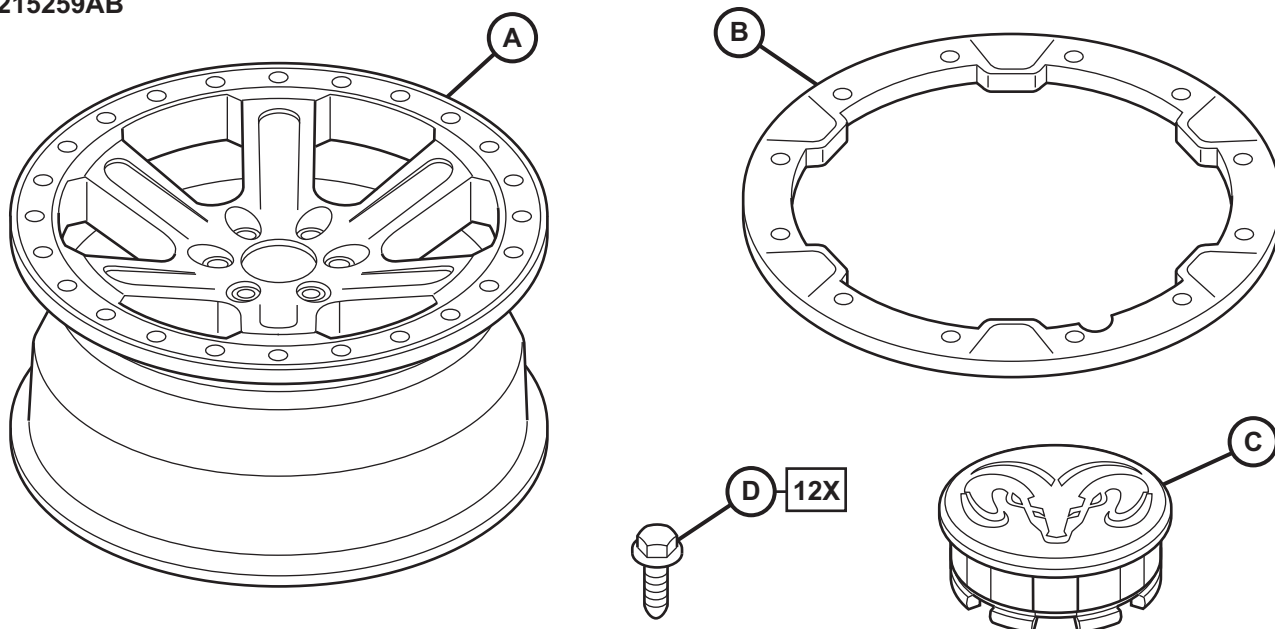

Call Out	Description	Quantity	Service Part (Y/N)	Part Number
A	Mopar Bead Lock Capable Wheel	1	Y	68369770AA
B	Trim Ring	1	Y	68369771AA
C	Ram Center Cap	1	Y	6KF18RXFAA
D	Trim Ring Hardware	12	Y	06512763AA

READ, UNDERSTAND AND FOLLOW ALL INSTRUCTION CAREFULLY BEFORE INSTALLATION

NOTE: OPTIONAL BEAD LOCK RING - PN P5160110 - SOLD SEPARATELY

**NOTE: Trim Ring "B" is decorative only and not intended to be a functional bead lock ring.
Optional Bead lock ring – PN P5160110 – Sold Separately.**

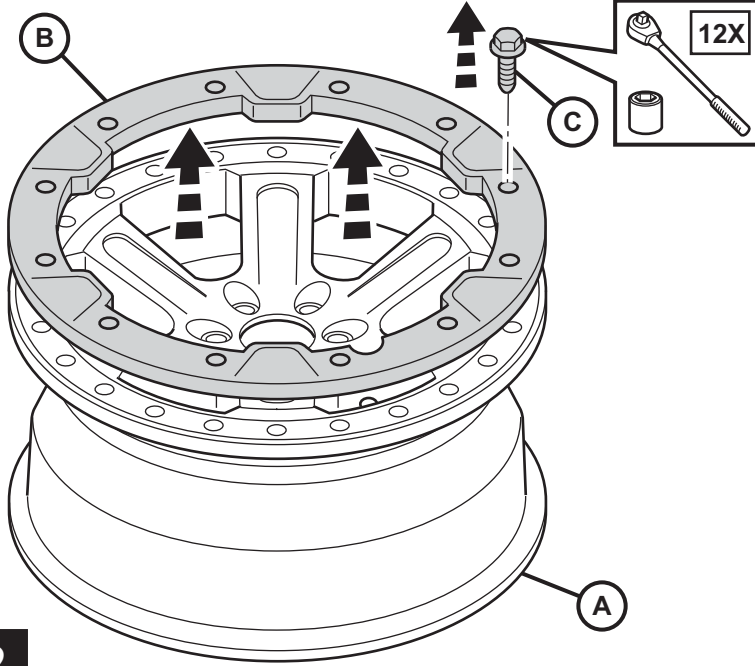

**MOUNT TIRE AS NORMAL
USING TIRE MACHINE**

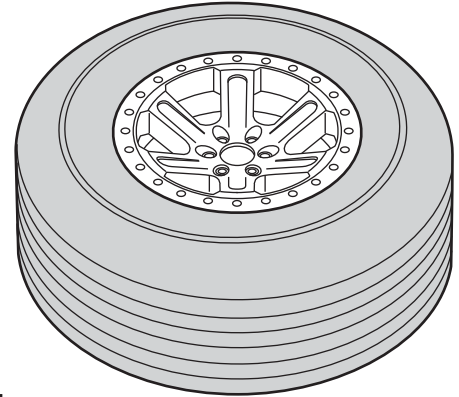

**HAND TIGHTEN ALL BOLTS
BE SURE THERE ARE NO GAPS**

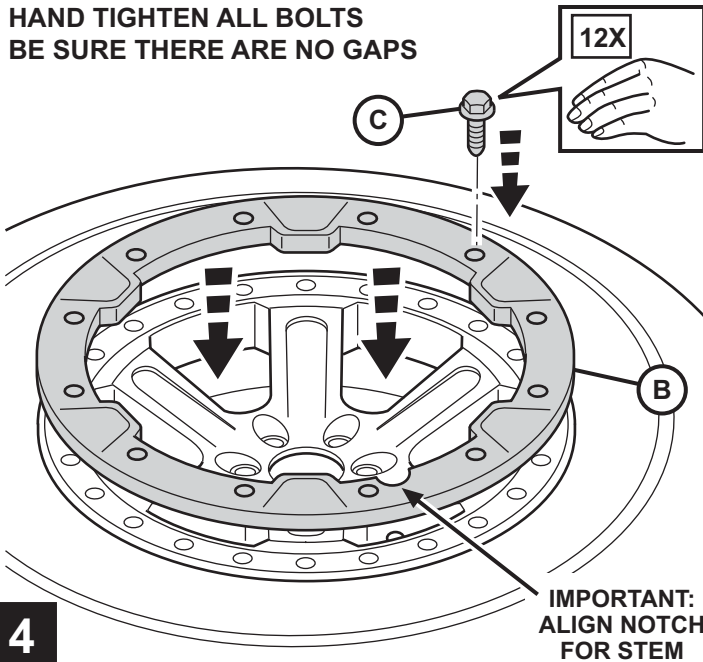

**TIGHTENING SEQUENCE
BE SURE THERE ARE NO GAPS**

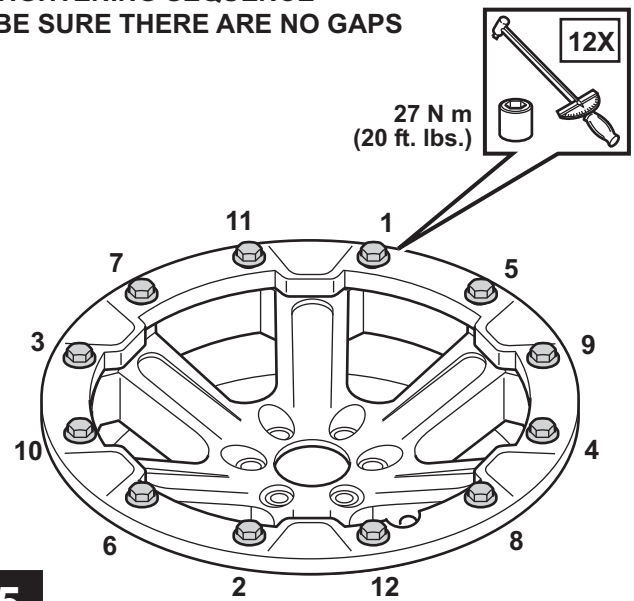

**INFLATE TIRE TO RECOMMENDED PRESSURE
BALANCE TIRE AND WHEEL ASSEMBLY
MOUNT TO VEHICLE**

6

7

