



INSTALLATION INSTRUCTIONS
AIR INTAKE KIT
2013-2016 RAM 5.7L V8 2500/3500
PART NUMBER 77072339

Bill of Materials for 77072339

No.	Qty.	Part No.	Description
1	1	341011	MOPAR Air Box
2	1	010142M	MOPAR Air Box Closure Panel
3	1	MP-M-1012	Air Filter Assembly
4	1	08512	Reducer; Plastic, Straight 3/4" to 5/8"
5	1	27370M	Air Filter Adaptor Tube
6	1	08658	Hose, Elbow 115, 4.00" ID-3.43" ID
7	1	9464	Hose Clamp #64
8	1	9456	Hose Clamp #56
9	7	08373	M6 Bolt
10	1	346001	Gasket, Closure Panel
11	1	8-134	Connector 3/4", 90 Deg.
12	24"	344025	3/4" Hose, PCV, SAE 30R7
13	1	8-139	Connector 3/4", Straight
Not Shown	1	L77072339	Instructions
Not Shown	1	11-77072339	C.A.R.B. Decal



INSTALLATION INSTRUCTIONS
AIR INTAKE KIT
2013-2016 RAM 5.7L V8 2500/3500
PART NUMBER 77072339

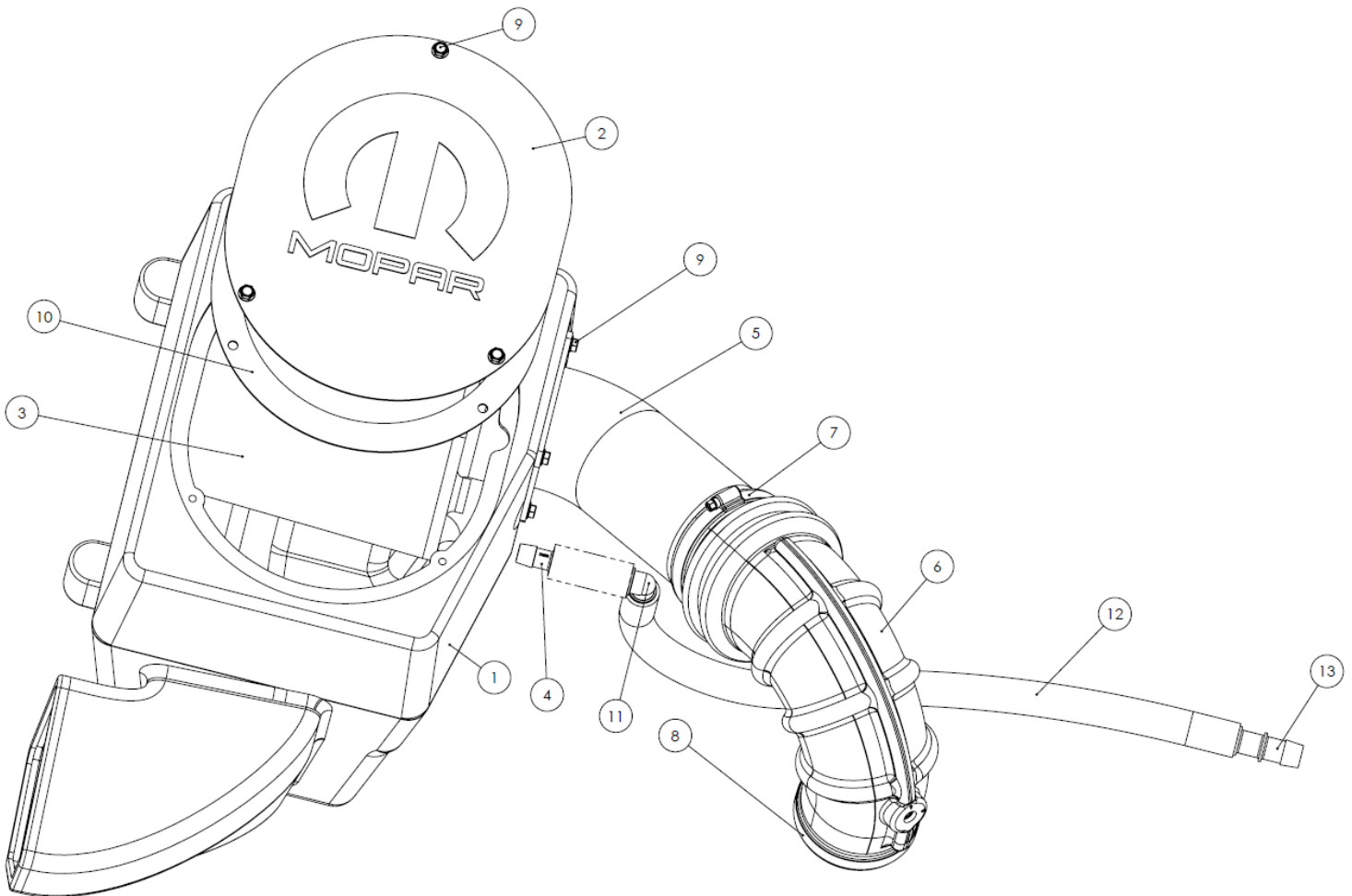



INSTALLATION INSTRUCTIONS
AIR INTAKE KIT
2013-2016 RAM 5.7L V8 2500/3500
PART NUMBER 77072339



IMPORTANT:

This kit includes a high-performance DRYFLOW Air Filter.

DO NOT APPLY ANY OIL TO THIS FILTER!

See Step 5 for cleaning instructions.

Read and understand these instructions **BEFORE** attempting to install this product.

1) Getting Started

- a) If engine has run within the past two hours, open the hood and allow it to cool down.
- b) Make sure the vehicle is parked on a level surface.
- c) Set the parking brake.
- d) Disconnect the negative battery terminal.
- e) Open the air intake kit package and make sure all parts are included.

2) Removal of the stock intake system



a) The stock air intake system should look like this.

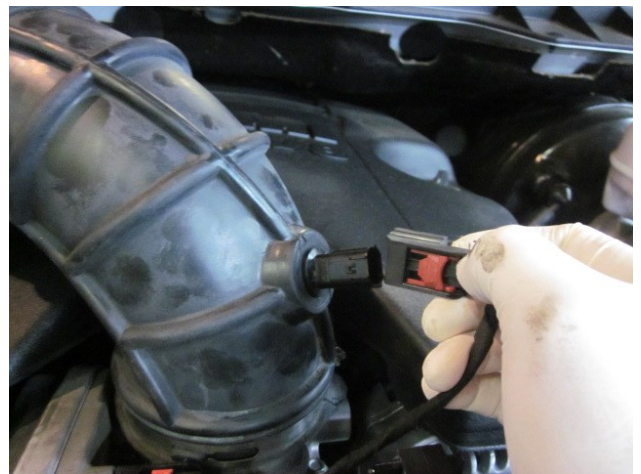

b) Disconnect the IAT (intake air temperature) sensor electrical connector from the sensor. Leave the sensor in place.



INSTALLATION INSTRUCTIONS
AIR INTAKE KIT
2013-2016 RAM 5.7L V8 2500/3500
PART NUMBER 77072339

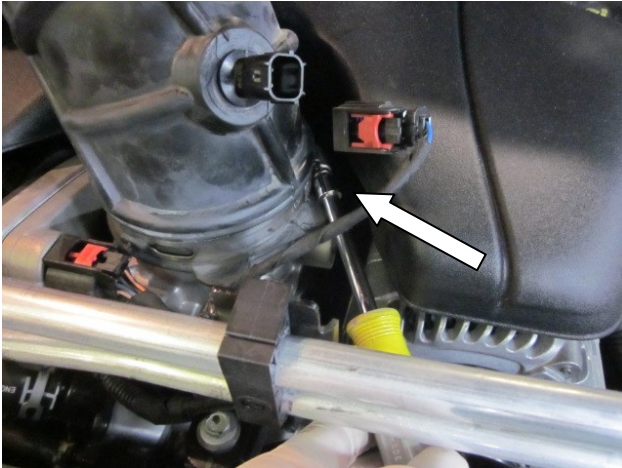

c) Loosen the hose clamp securing the factory air intake hose to the throttle body.



d) Disconnect engine crank case vent hose at the air box.



e) Detach the factory air intake hose from the throttle body.



f) Pull up on the air box to disengage it from the locator pins and remove it from the engine compartment along with the intake hose.



INSTALLATION INSTRUCTIONS
AIR INTAKE KIT
2013-2016 RAM 5.7L V8 2500/3500
PART NUMBER 77072339

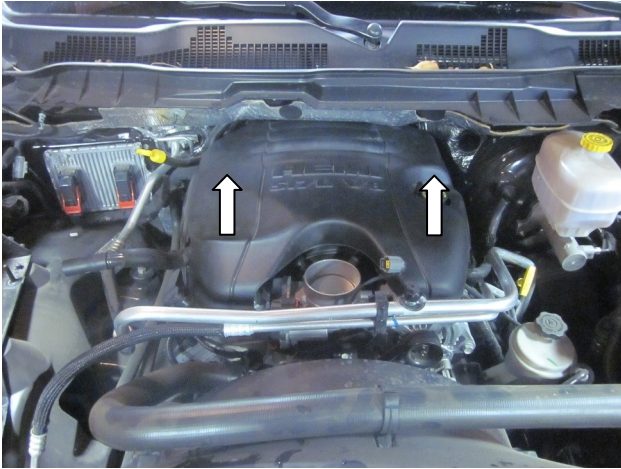

g) Remove the engine cover by lifting up on the front of the cover and then pulling towards yourself to disengage from the rear grommets.

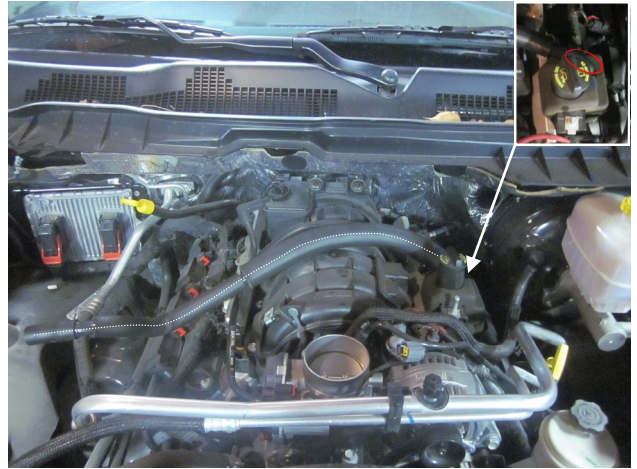

h) With care, remove the PCV hose by pulling up on the elbow connection next to the engine oil fill cap.



INSTALLATION INSTRUCTIONS
AIR INTAKE KIT
2013-2016 RAM 5.7L V8 2500/3500
PART NUMBER 77072339

3) Installation of MOPAR Air Intake System

NOTE: When installing the MOPAR Air Intake System, DO NOT completely tighten the hose clamps or mounting hardware until instructed to do so.

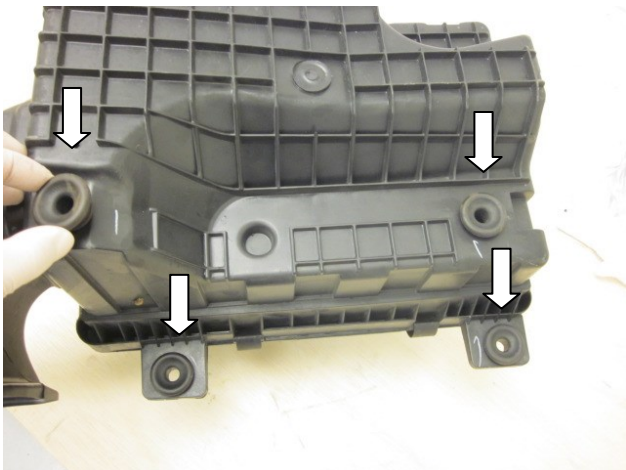

a) Remove the 4 rubber grommets on the bottom of the factory air box.

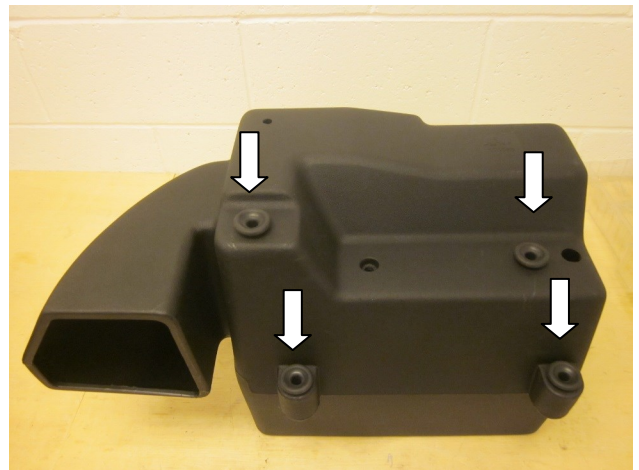

b) Insert the 4 rubber grommets removed in step 3a) into the bottom of the MOPAR Air Box.



c) Attach the flanged air filter adaptor tube to the MOPAR Air Box as shown with the four (4) M6 bolts provided with Loctite and tighten to 3.5Nm (31 in/lb). Pay attention to the adaptor orientation with reference to the air duct.



d) Install the air filter on to the air filter adaptor tube inside the air box. Make sure the bead on the adaptor tube engages the groove inside the filter. Do not fully tighten the hose clamp at this point.



INSTALLATION INSTRUCTIONS
AIR INTAKE KIT
2013-2016 RAM 5.7L V8 2500/3500
PART NUMBER 77072339



e) Remove the IAT (intake air temperature) sensor from the factory air intake hose by gently twisting, making note of the depth and orientation.

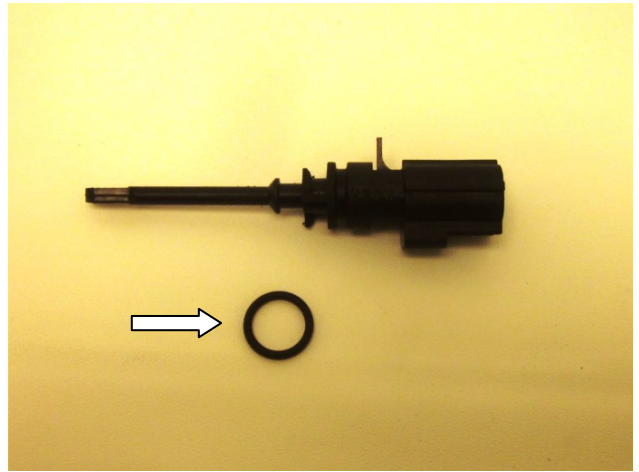

f) Remove the O-ring from the IAT sensor. **Do not** throw the O-ring away. It will be required if the vehicle is returned to its stock configuration.

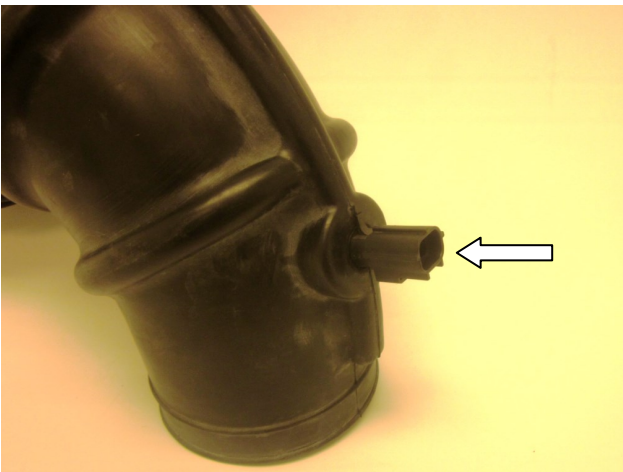

g) Insert the IAT sensor into the opening on the MOPAR air intake hose at the same depth and orientation as the factory duct.

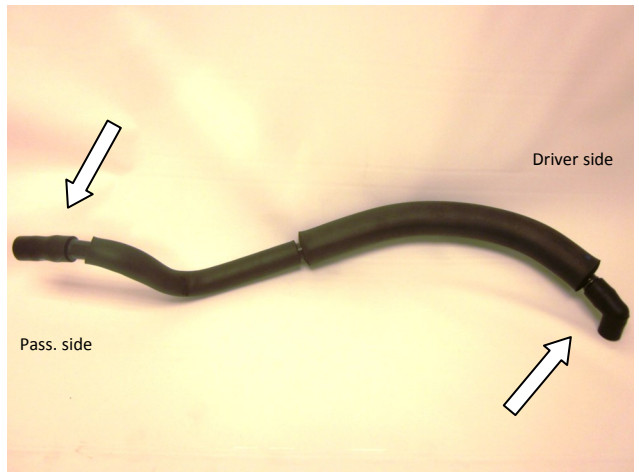

h) Remove the Stock straight & elbow fittings from the ends of the Stock PCV hose. These will be used for your new kit. **Do not** throw away the molded hose. It will be required if the vehicle is returned to its stock.



INSTALLATION INSTRUCTIONS
AIR INTAKE KIT
2013-2016 RAM 5.7L V8 2500/3500
PART NUMBER 77072339

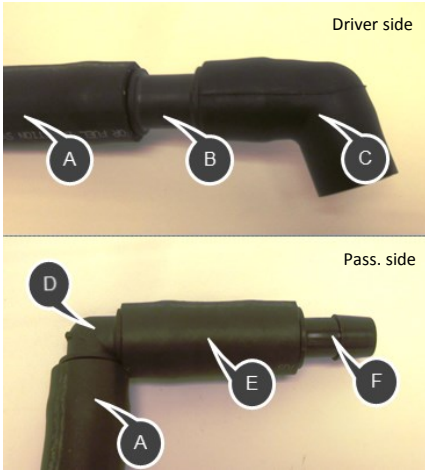

- (A) 24" L x 3/4" Dia. Hose, PCV
- (B) 3/4" x 3/4" Barbed Straight connector
- (C) Stock 3/4" Elbow
- (D) 3/4" x 3/4" Barbed 90 deg. connector
- (E) Stock 3/4" Straight
- (F) 3/4" x 5/8" Barbed Reducer connector

i) Assemble the new PCV Hose using the supplied 24" PCV hose and connectors. Make sure the 5/8" end of the straight reducer connector is facing out of the hose ("F" above)

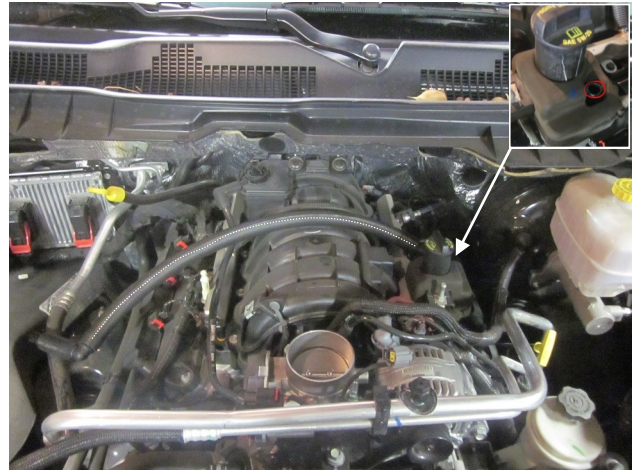

j) Install the new PCV hose in the same location you removed it from in step (2h).

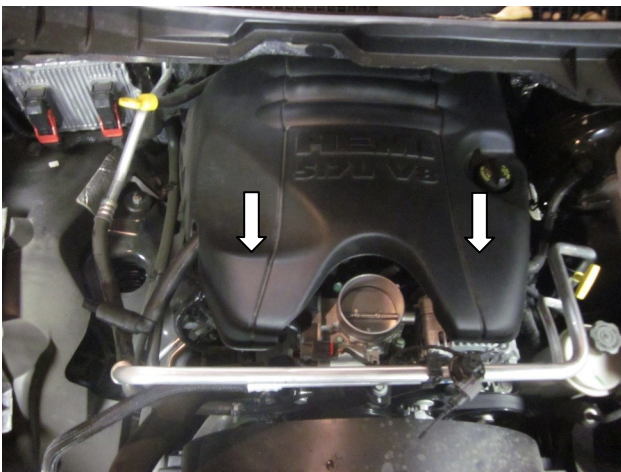

k) Reinstall the engine cover by sliding it under the cowl and engaging the two grommets at the back of the engine. Once aligned over the Engine Oil fill cap, gently press down to engage the front grommets.



l) Install the MOPAR air box on the upper and lower locator posts of the air box mounting bracket.



INSTALLATION INSTRUCTIONS
AIR INTAKE KIT
2013-2016 RAM 5.7L V8 2500/3500
PART NUMBER 77072339

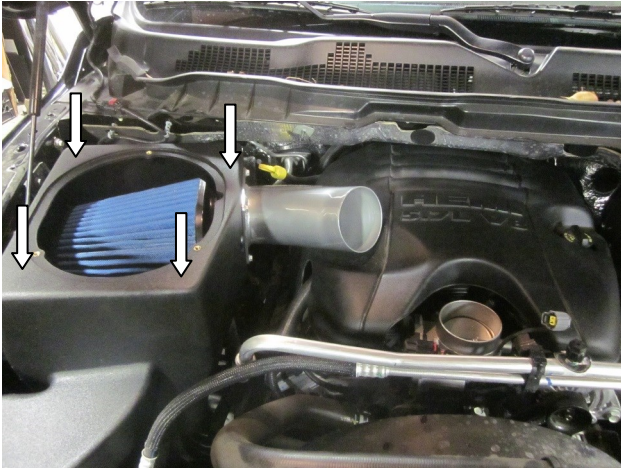

m) Install the complete air box assembly into the engine compartment. Make sure the rubber grommets on the bottom are fully engaged on the locator posts.

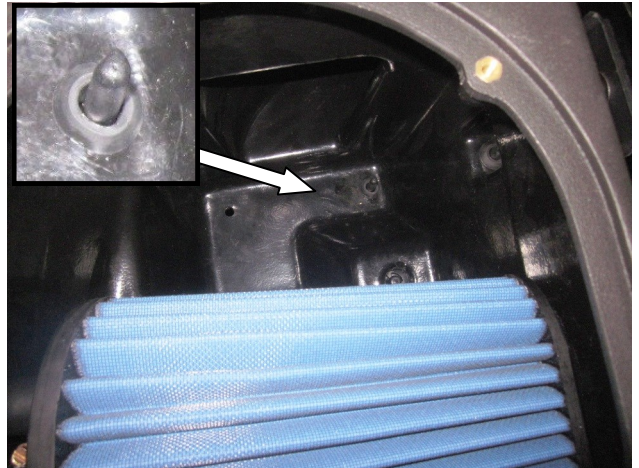

n) Press down firmly on the air box to seat the four (4) grommets on the locator posts and fully engage the air box.



o) Attach the 5/8" PCV hose fitting to the MOPAR air filter through the hole in the air box. **Make sure the air filter is fully seated on the adaptor tube and tighten the air filter hose clamp to 3.0Nm (26.5 in/lb).**



p) Attach the larger opening of the MOPAR air intake hose to the air filter adaptor tube with #62 hose clamp. Do not fully tighten the clamp at this point.



INSTALLATION INSTRUCTIONS
AIR INTAKE KIT
2013-2016 RAM 5.7L V8 2500/3500
PART NUMBER 77072339



q) Attach the other end of the MOPAR air intake hose to the throttle body with the supplied #56 hose clamp. Once the duct is correctly oriented, tighten both hose clamps to 3.0Nm (26.5 in/lb)

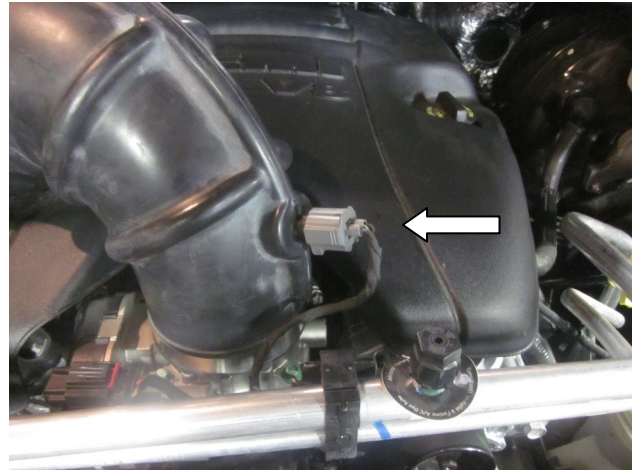

r) Connect the IAT sensor electrical connector to the IAT sensor. Make sure the connector is fully engaged and locked.



s) Install the seal on the back side of the Closing Panel making sure to align the 3 holes properly. **Note:** Avoid stretching the seal material while applying it to the panel.

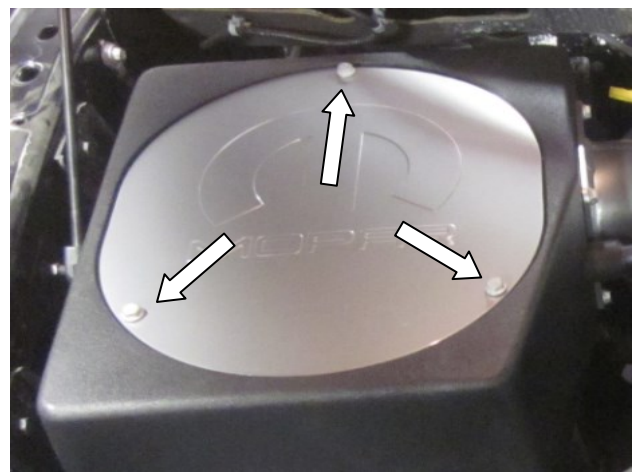

t) Install the MOPAR air box closure panel with the (3) M6 bolts provided and tighten to 3.5Nm (31 in/lb). Apply the C.A.R.B. decal in a visible location on the vehicle.



INSTALLATION INSTRUCTIONS
AIR INTAKE KIT
2013-2016 RAM 5.7L V8 2500/3500
PART NUMBER 77072339



Your **MOPAR Air Intake System** should look this when properly installed.



INSTALLATION INSTRUCTIONS
AIR INTAKE KIT
2013-2016 RAM 5.7L V8 2500/3500
PART NUMBER 77072339

4) Re-assemble the vehicle

- Inspect all MOPAR air intake kit components proximity to A/C lines, dip sticks, hoses for ample clearance.
- Tighten all fasteners to 3.5Nm (31 in/lb) and hose clamps to 3.0Nm (26.5 in/lb).**
- Inspect the engine bay for any loose tools, and then check that all fasteners are tight, and that the IAT sensor cable is properly connected.
- Start the engine and allow it to idle, and then perform a final inspection before driving the vehicle.

5) Cleaning Instructions: MOPAR DRYFLOW Air Filter

(It is recommended that you service your MOPAR air filter every 20,000 miles for optimum performance.)

- Remove the air filter from intake system and set the filter clamp aside.
- Measure the length of the filter media.
- Fill a pail with warm clean water to the depth determined in Step B. Add a mild household detergent or DRYFLOW air filter cleaning solution to the water.
- Without allowing the solution to flow into the filter neck, submerge the filter into the water and let it soak for 10 minutes. After soaking, rotate the filter back and forth to agitate the water and knock off dirt.
- Empty the bucket of dirty water. Repeat steps C and D.
- Refill the pail with clean warm water and rinse by rotating the filter as in step D. The water should be clear with no signs of dirt in the pail.
- Allow the filter to air dry. Re-install the filter on the intake system once it is dry.

DO NOT APPLY ANY OIL TO THIS FILTER.

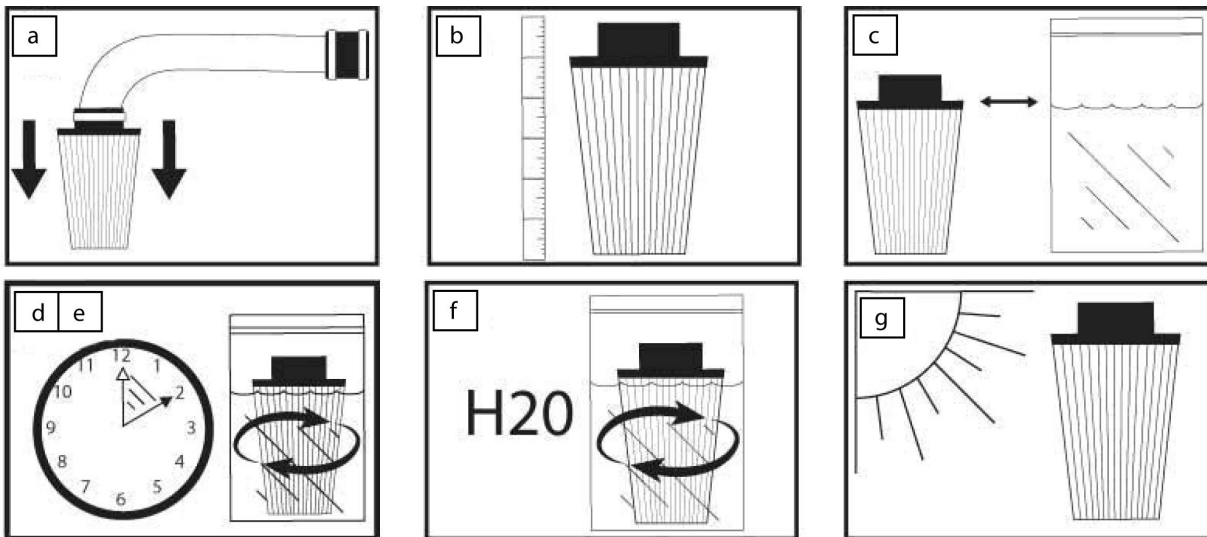

OEM-DOD300

11/16/2015