

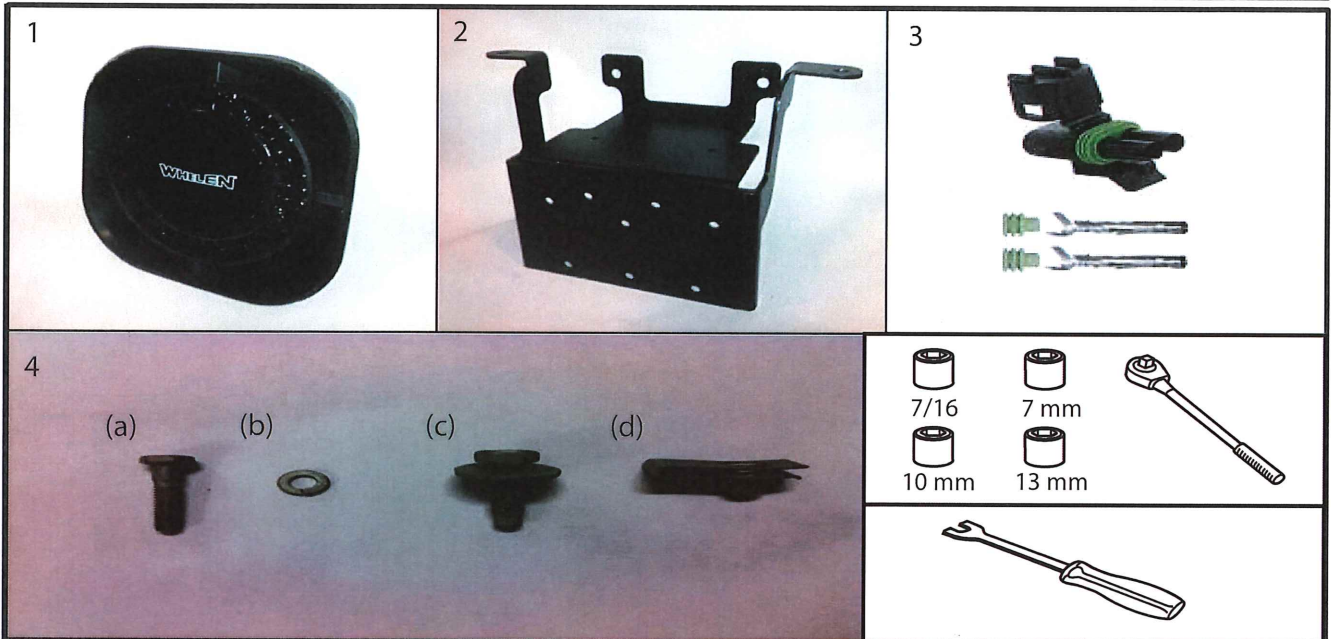

Siren Speaker and Bracket

DODGE CHARGER



Item	Qty	Description
1	1	Siren Speaker
2	1	Speaker Bracket
3	1	Connector Kit-2 connector pins, 2-weather seals, 1-hard shell
4a)	4	1/4" x 20 x 1 1/4" bolts
4b)	4	1/4" split washers
4c)	2	M8 x 1.25 x 25mm bolt
4d)	2	M8 x 1.25 U-clip

Note: Delphi crimp tool (Die set p/n 13782684 and handle p/n 13782721) are required for installation.

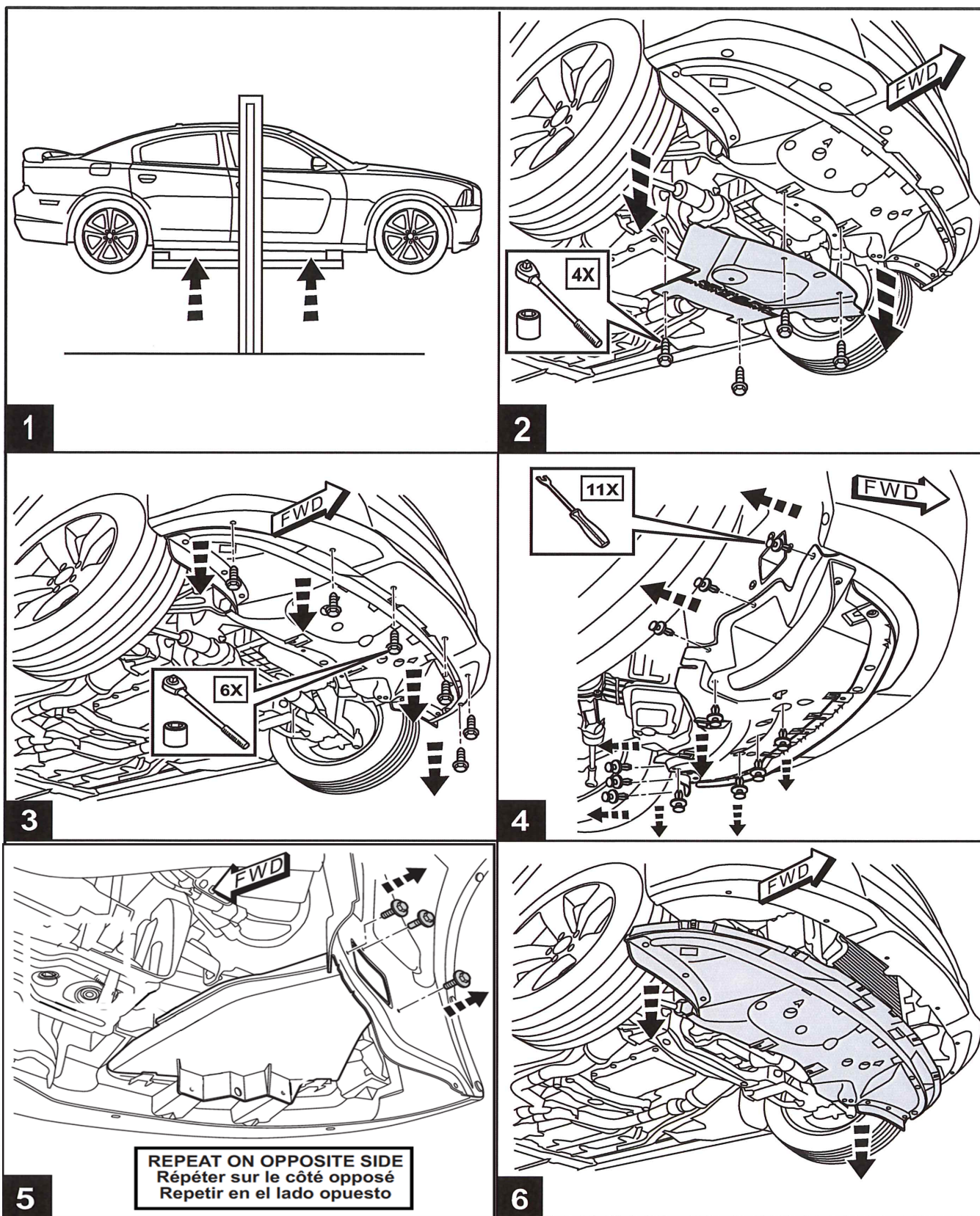

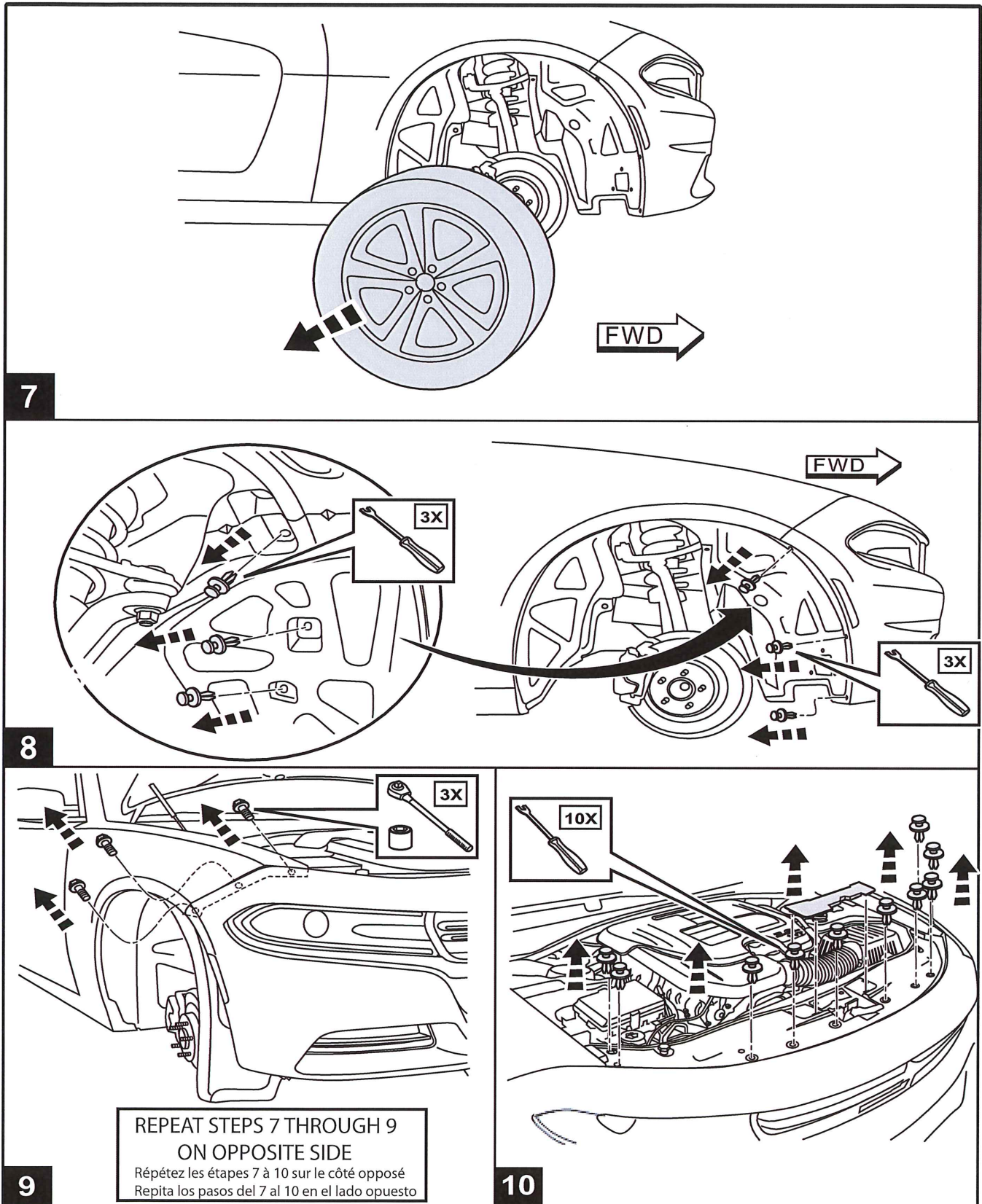

11

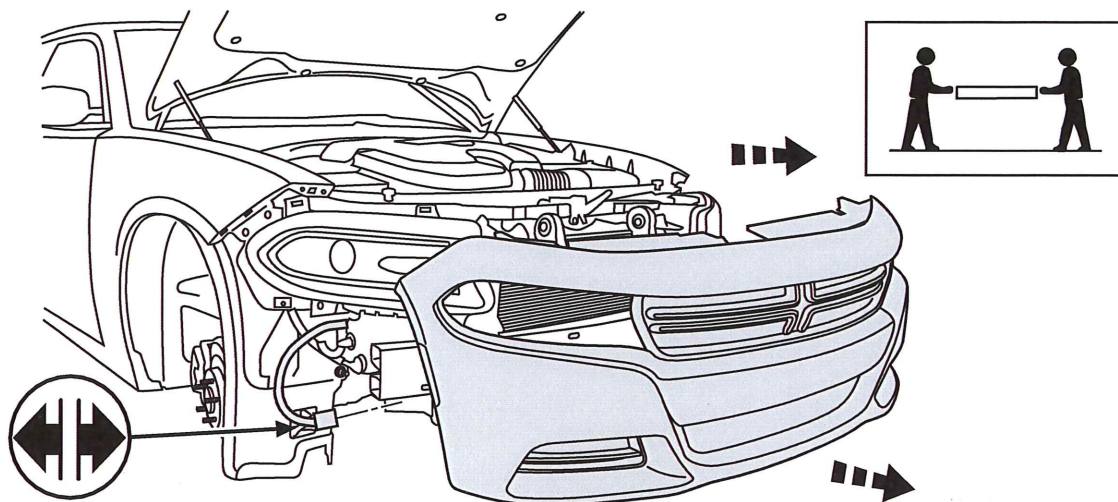

12. Remove hood latch, keep bolts for re-installation and cut wire tie under hood latch.
13. Insert (2) J-Nuts (item 4c) as shown in picture A.
14. Mount siren bracket (item 2) and the hood latch on top onto Core support re-using hood latch bolts as shown in picture B. Torque to 9 N-m.
15. Install siren speaker (item 1) onto bracket (item 2) using items 4a and 4b as shown in picture C. Torque 12 N-m.
16. Locate OEM harness as shown in picture D. Run harness up under radiator side cover, towards siren bracket. Cut OEM harness (2ft long) from bottom of bumper beam.
17. Locate Black and Green wires from OEM harness, insert weather seals through both wires individually. Using Delphi crimp tool, (Die set p/n 13782684 and handle p/n 13782721) crimp female pins to them individually from connector kit (item 3 - Delphi Weather Pack part number 12010973).
18. Attach female connector from connector kit (item 3) to wires previously crimped. Pin position A=Green, B=Black.

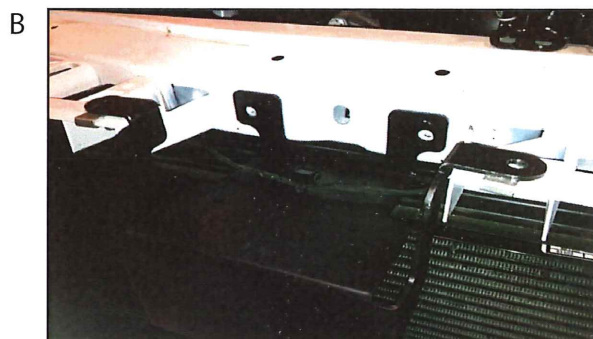
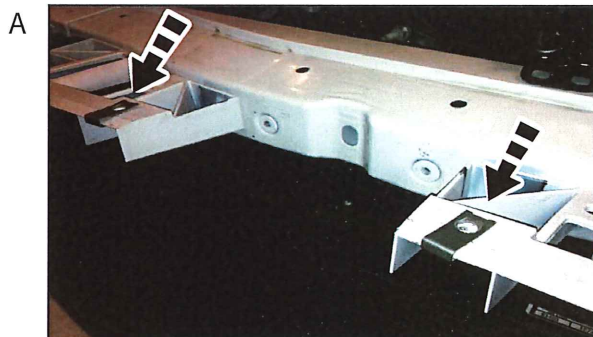

19. Connect OEM harness to siren speaker harness. Verify that Green is connected to White wire from siren. And Black is connected to Black from siren.
20. Locate Green and Black wire from 12-way grey connector in center console area, and extend to siren system.
21. Follow Step 12 back to step 1 to reinstall front fascia.
22. Install item 4d into the J-Nuts installed in step 14 as shown in picture E. Tighten to 5.6 N-m using a 13mm Socket

D

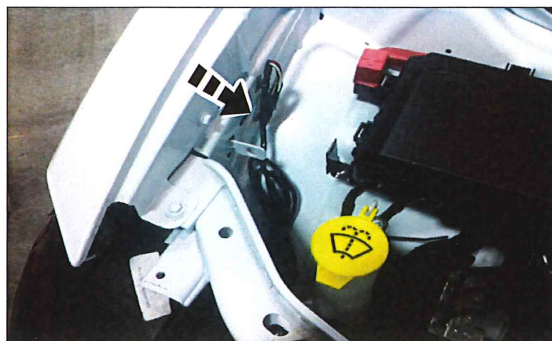

E

