

CFMOTO UFORCE 1000XL REAR WINDSHIELD

Thank you for choosing Rough Country for all your vehicle needs.

Please read instructions before beginning installation. Check the kit hardware against the kit contents shown below. Be sure you have all needed parts and know where they go.

If question exist, please call us @1-800-222-7023. We will be happy to answer any questions concerning this product.

Check all fasteners for proper torque. Check to ensure for adequate clearance between all components.

Periodically check all hardware for tightness.

KIT CONTENTS:

Windshield x1
Rubber Seal x1
Stiffening Bar x1
Top Bracket x3

Hardware Included:

1/4" x 5/8" Button Head Bolt x8
1/4" Lock Nut x11
1/4" Flat Washer x3
1/4" x 1 1/2" Button Head Bolt x3
1/4" Knob x3
Bottom Bracket x4



Torque Specs:

Size	Grade 5	Grade 8	Size	Class 8.8	Class 10.9
5/16"	15 ft/lbs	20ft/lbs	6MM	5ft/lbs	9ft/lbs
3/8"	30 ft/lbs	35ft/lbs	8MM	18ft/lbs	23ft/lbs
7/16"	45 ft/lbs	60ft/lbs	10MM	32ft/lbs	45ft/lbs
1/2"	65 ft/lbs	90ft/lbs	12MM	55ft/lbs	75ft/lbs
9/16"	95 ft/lbs	130ft/lbs	14MM	85ft/lbs	120ft/lbs
5/8"	135ft/lbs	175ft/lbs	16MM	130ft/lbs	165ft/lbs
3/4"	185ft/lbs	280ft/lbs	18MM	170ft/lbs	240ft/lbs

INSTALLATION INSTRUCTIONS

1. Clean the surface of the UTV that the windshield will be applied to.
2. Remove the protective cover from the windshield.
3. To make the installation of the seals easier, run a 1/4" extension along the center of the seals. **See Photo 1.**
4. Install the seal with the bulb along the bottom of the windshield and the thin seal around the top and sides. Trim any excess of the seal. **See Photo 2.**

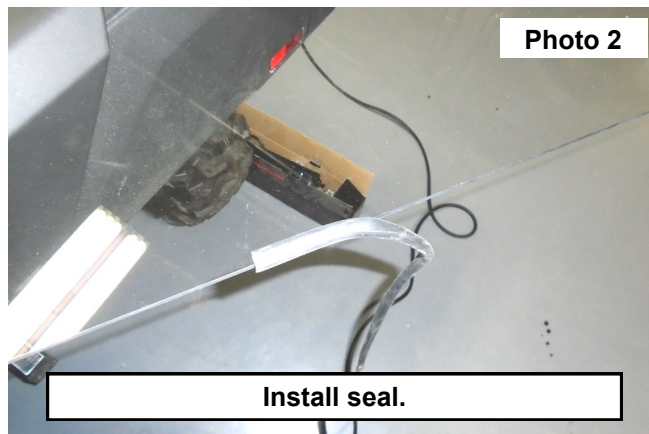
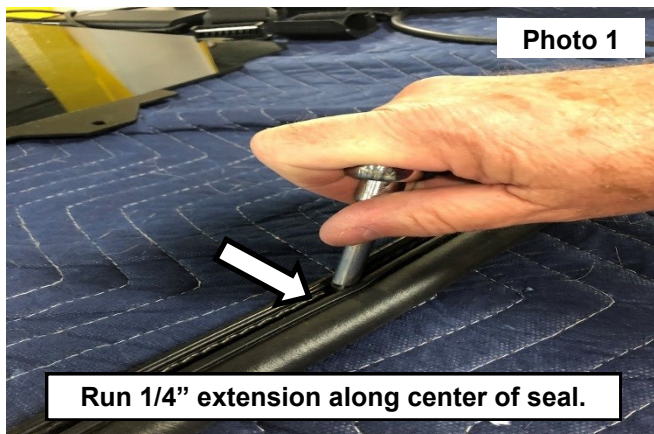

5. Peel the adhesive backer off the rubber pads and attach them to the three top brackets as shown in **Photo 3.**
6. **NOTE:** The side where the Rough Country logo can be seen will be referred to as the "front". Install the stiffening brace on the front side of the windshield using the supplied 1/4" x 1 1/2" button head bolts, 1/4" washers, and 1/4" lock nuts. Tighten with a 5/32" Allen wrench and 7/16" wrench. **See Photo 4.**



7. Flip the windshield over and install the top brackets with rubber pads onto the protruding stud of the button head bolt. Thread the 1/4" knob onto the threading. **See Photo 5.**
8. Install the four bottom brackets on the back side of the windshield as shown in **Photo 6.** Tighten with a 5/32" Allen wrench and 7/16" wrench.

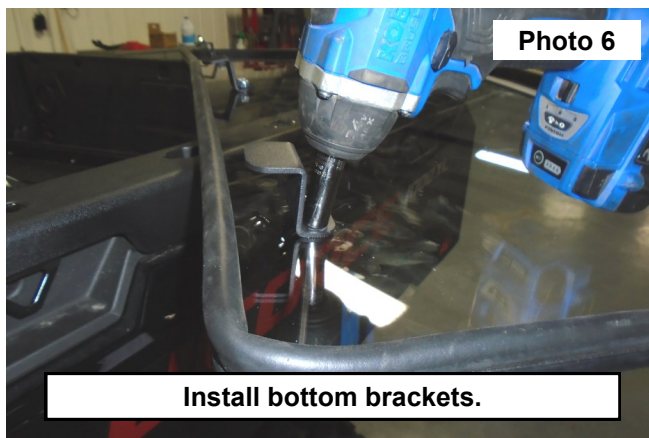
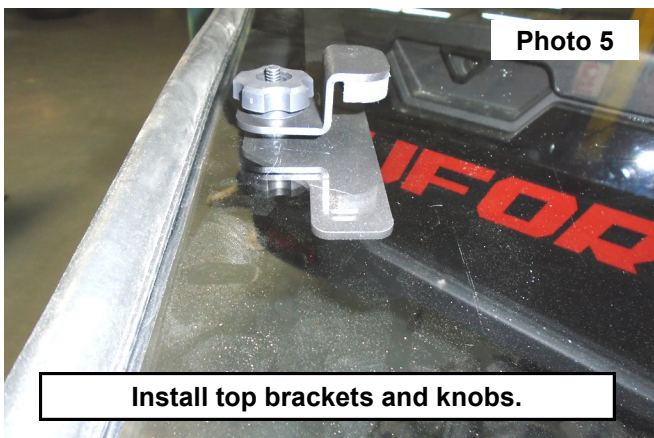

9. With assistance, lift the rear windshield and hook the bottom brackets over the metal plate as shown in **Photo 7**.
10. Rotate the top brackets as shown in **Photo 10** and tighten the knob to secure the rear windshield in place.

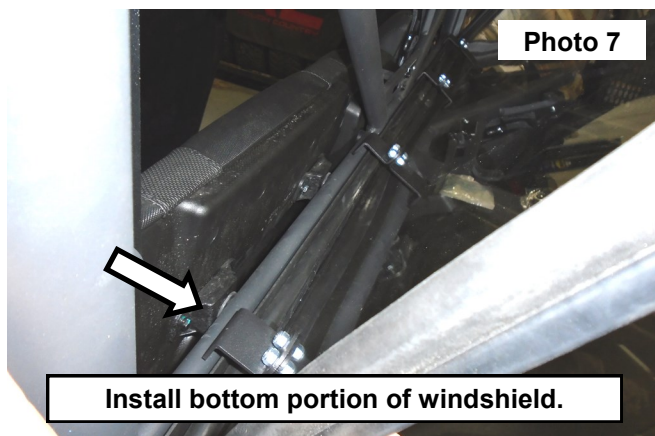

By purchasing any item sold by Rough Country, LLC, the buyer expressly warrants that he/she is in compliance with all applicable, State, and Local laws and regulations regarding the purchase, ownership, and use of the item. It shall be the buyers responsibility to comply with all Federal, State and Local laws governing the sales of any items listed, illustrated or sold. The buyer expressly agrees to indemnify and hold harmless Rough Country, LLC for all claims resulting directly or indirectly from the purchase, ownership, or use of the items.

