

ROUGH COUNTRY

SUSPENSION SYSTEMS®

9219076800

JEEP 2018 JLU 4-Door Step

Thank you for choosing Rough Country

Please read instructions before beginning installation. Check the kit hardware against the parts list and product layout. Be sure you have all needed parts and know where they go. Also please review tools needed list and make sure you have needed tools. If question exist we will be happy to answer any questions concerning the design, function, and correct use of this product.

Kit Contents:

- 1– Dr Main Step Rail
- 1– Pass Main Step Rail
- 6– Step Mounting Brackets
- 1– 90768Bag including:
 - 6– 8mm x 35mm Bolts
 - 30– 8mm Flat Washers
 - 12– 8mm x 20mm Bolts
 - 18– 8mm Lock Washers
 - 12– 8mm 25mm Bolts
 - 12– 8mm Flange Lock nuts

Tools Needed:

- 13mm Socket/Wrench
- Ratchet
- Torque Wrench



INSTALLATION INSTRUCTIONS

1. Place vehicle on a flat surface and set emergency brake.
2. On a flat surface, attach the mounting brackets to the main rail using the supplied 8mm x 20mm bolts, flat washers and lock washers . **See Photo 1 & 2.** Three brackets per side.
3. Tighten using a 13mm wrench. Torque to 18 ft-lbs.

PHOTO 1

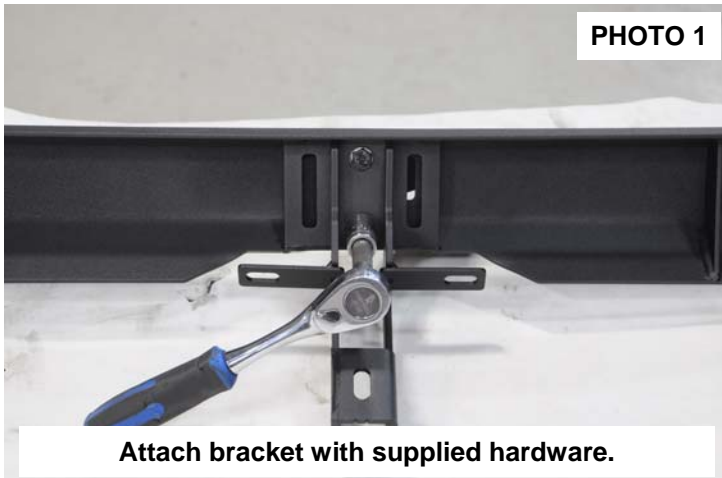

Attach bracket with supplied hardware.

PHOTO 2



- If the vehicle is equipped with factory steps, they will have to be removed. Retain the stock hardware for reuse.
- Position the steps with mounting brackets on the Jeep. Line up the factory holes in the body and install the supplied qty 3 - 8mm x 35mm bolts, lock washer and flat washer or factory hardware to attach. **See Photo 3.** Do not tighten at this time.
- Install the supplied 8mm x 25mm bolts in each bracket using factory holes in the body seam as shown with the supplied lock washers, flat washers and locking nut. **See Photo 4.** Do not tighten at this time.

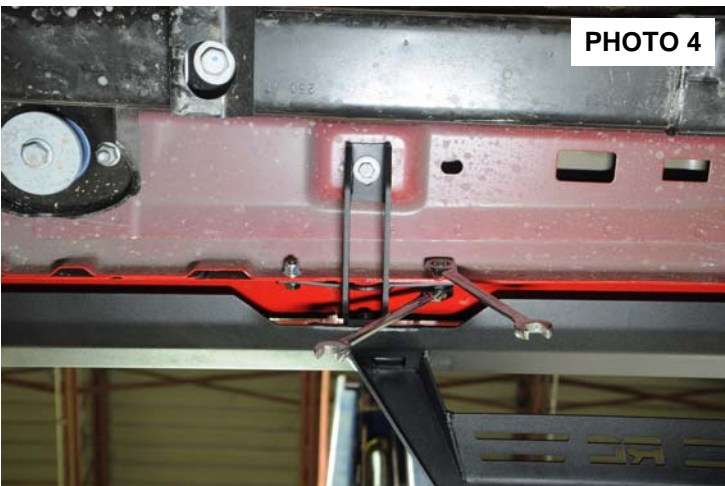

- Tighten the 8MM x 35mm bolts and then tighten the 8mm x 25mm bolts using a 13mm wrench.
- Repeat this process for all of the remaining mounting brackets.



Torque Specs:

| Size | Grade 5 | Grade 8 |
|-------|------------|------------|
| 5/16" | 15 ft/lbs | 20 ft/lbs |
| 3/8" | 30 ft/lbs | 35 ft/lbs |
| 7/16" | 45 ft/lbs | 60 ft/lbs |
| 1/2" | 65 ft/lbs | 90 ft/lbs |
| 9/16" | 95 ft/lbs | 130 ft/lbs |
| 5/8" | 135 ft/lbs | 175 ft/lbs |
| 3/4" | 185 ft/lbs | 280 ft/lbs |
| | Class 8.8 | Class 10.9 |
| 6MM | 5 ft/lbs | 9 ft/lbs |
| 8MM | 18ft/lbs | 23 ft/lbs |
| 10MM | 32ft/lbs | 45ft/lbs |
| 12MM | 55ft/lbs | 75ft/lbs |
| 14MM | 85ft/lbs | 120ft/lbs |
| 16MM | 130ft/lbs | 165ft/lbs |
| 18MM | 170ft/lbs | 240ft/lbs |

THANK YOU FOR CHOOSING ROUGH COUNTRY FOR YOUR OFF ROAD NEEDS.

By purchasing any item sold by Rough Country, LLC, the buyer expressly warrants that he/she is in compliance with all applicable , State, and Local laws and regulations regarding the purchase, ownership, and use of the item. It shall be the buyers responsibility to comply with all Federal, State and Local laws governing the sales of any items listed, illustrated or sold. The buyer expressly agrees to indemnify and hold harmless Rough Country, LLC for all claims resulting directly or indirectly from the purchase, ownership, or use of the items.

