



FORD 2015-23 F150 CREW CAB BA2 STEP

Thank you for choosing Rough Country for all your vehicle needs.

Please read instructions before beginning installation. Check the kit hardware against the kit contents shown below. Be sure you have all needed parts and know where they go.

If question exist, please call us @1-800-222-7023. We will be happy to answer any questions concerning this product.

Check all fasteners for proper torque. Check to ensure for adequate clearance between all components.

Periodically check all hardware for tightness.

Components Included

- 2 - Step Board
- 6 - Bracket

Hardware Included:

- 6 - 8mm Double Bolt Plate
- 36 - 8mm Lock Nut
- 36-8mm Flat Washer

Tools Required:

- 10mm Wrench
- 13mm Wrench



Torque Specs:

Size	Grade 5	Grade 8	Size	Class 8.8	Class 10.9
5/16"	15 ft/lbs	20ft/lbs	6MM	5ft/lbs	9ft/lbs
3/8"	30 ft/lbs	35ft/lbs	8MM	18ft/lbs	23ft/lbs
7/16"	45 ft/lbs	60ft/lbs	10MM	32ft/lbs	45ft/lbs
1/2"	65 ft/lbs	90ft/lbs	12MM	55ft/lbs	75ft/lbs
9/16"	95 ft/lbs	130ft/lbs	14MM	85ft/lbs	120ft/lbs
5/8"	135ft/lbs	175ft/lbs	16MM	130ft/lbs	165ft/lbs
3/4"	185ft/lbs	280ft/lbs	18MM	170ft/lbs	240ft/lbs



INSTALLATION INSTRUCTIONS

1. Place a bracket on the three studs protruding from the rocker of the vehicle. **NOTE: All brackets are the same and can be placed on any of the three mounting locations. See Photo 1.**
2. Thread the supplied (3 ea.) 8mm lock nuts and 8mm flat washer onto the studs and tighten with a 13mm wrench. **See Photo 2.**

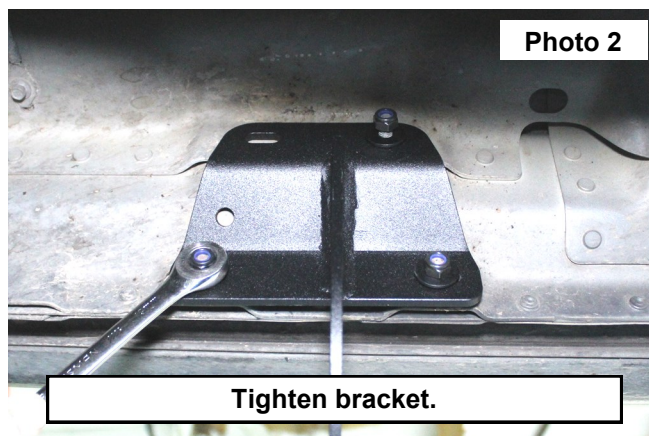
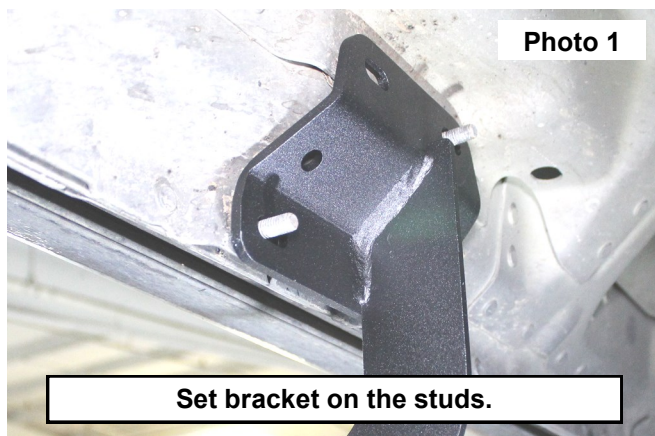

3. Repeat for remaining five brackets.
4. Place four flag studs in the rail of the step and align the studs with the slots of the bracket. **See Photo 3.**
5. Secure the flag studs with supplied 6mm washers and lock nuts. Adjust steps to desired fit and tighten with a 10mm wrench. **See Photo 4.**

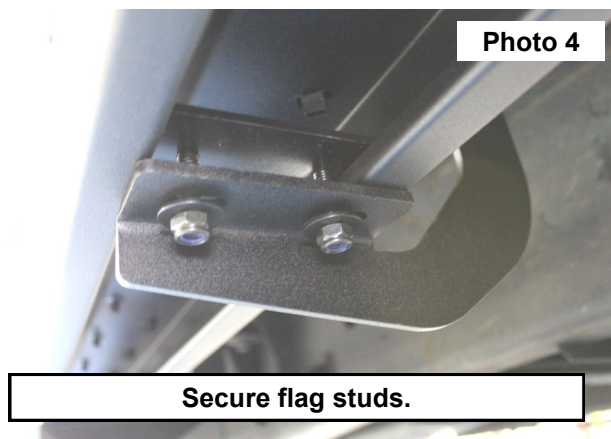
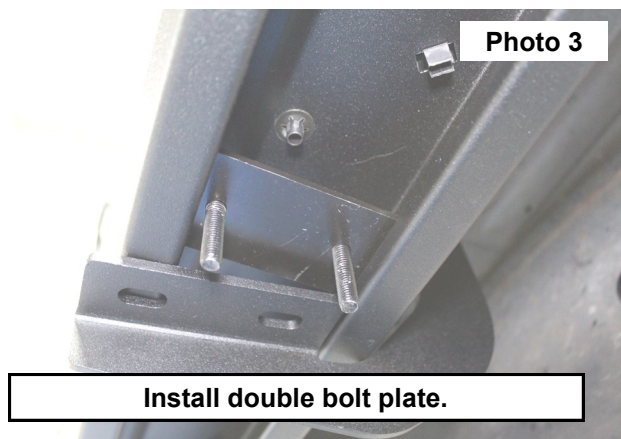

By purchasing any item sold by Rough Country, LLC, the buyer expressly warrants that he/she is in compliance with all applicable, State, and Local laws and regulations regarding the purchase, ownership, and use of the item. It shall be the buyers responsibility to comply with all Federal, State and Local laws governing the sales of any items listed, illustrated or sold. The buyer expressly agrees to indemnify and hold harmless Rough Country, LLC for all claims resulting directly or indirectly from the purchase, ownership, or use of the items.

