



RTROLL

SINGLE HAND CONTROLLER

Welcome to RIOTORO

Thank you for purchasing the RTROLL!

The rTroll, a marvel of gaming technology, redefines gaming control. Its sleek, symmetrical design fits comfortably in either hand, while the round grip ensures a secure hold.

The classic key layout is both elegant and efficient. Connect wireless via Bluetooth 5.0 for a reliable, lag-free experience up to 10 meters. Power up with 2 AAA batteries for up to 40 hours of continuous play. Compatible with iOS and Android devices, the rTrol is your gateway to immersive gaming.

Note: This manual is a guide for the RTROLL. For instructions on installing other products, please refer to their documentation.



CONTENTS

1	Before You Begin	
	- At a glance	4
	- What is in the box	5
	- Precautions	6
	- Requirements	7
2	Ready, Setup, Go	
	- Specifications	9
	- Battery installation	10
	- Startup	11
	- Pair and Connect	12
	- Switching between modes	13
	- Modes in Android OS	14
	- Modes in iOS	15
- Power off	16	
3	Top / Front Panel Assembly	
	- General Maintenance	18
	- Important Safety Information	19
	- Limited product warranty ("Limited Warranty")	20
	- Troubleshooting your new device	21
- Recommended parts	22	



1

Before You Begin

www.riotoro.com

At a glance

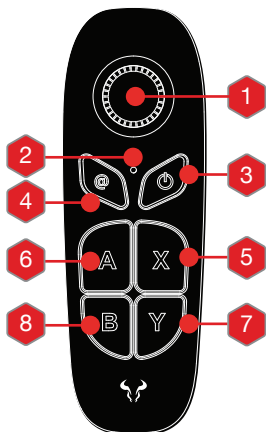

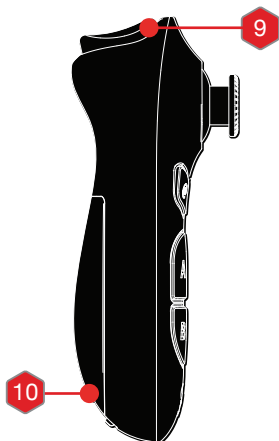

1. 360 degree rocker
2. Indicator light
3. Power button
4. Left focal distance adjustment
5. X button
6. A button



7. Y button
8. B button
9. Confirmation button
10. Battery cover



What's in the box

ITEM	DESCRIPTION	USE	QTY
 1	RTROLL	VR viewing experience	1
 2	Cleaning Cloth	Cleaning	1



PRECAUTIONS

Please take the following precautions:

- Handle the RTROLL with care.
- Avoid drops and bumps as they might scratch or damage the device.
- Always be aware of your surroundings before starting and while using the controller.
- Use caution to avoid injury.
- Only use the controller indoors, in a clear, safe area, including overhead, to avoid striking walls, furniture, objects, fans, people, and pets.
- Avoid tripping hazards, such as rugs, uneven floors, wires, and cords.
- Be mindful of nearby objects such as computers, monitors, counter tops, furniture, and other people.



REQUIREMENTS

In order to configure the RTROLL you will need:

1. A compatible mobile device,
2. A VR app installed on your mobile device,
3. Internet connection to stream content or content already downloaded.

Notes: - This is a multi-functional wireless controller, used to control smartphones, tablets, smart TV, VR, etc. Supports iOS and Android systems.



2

Ready, Setup, Go

www.riotoro.com

SPECIFICATIONS

- Material:	ABS Plastic
- Bluetooth:	Bluetooth 5.0
- Operational distance:	up to 32 feet / 10 meters
- OS support:	Android, iOS
- Battery Type:	AAA battery
- Battery duration:	up to 40 hrs
- Battery quantity:	2 batteries (not included)
- Operational Current:	0.5 – 8mA
- Operational Voltage:	2.4-3.6V
- Average Current:	<10mA
- Operational temperature:	14 °F ~ 158 °F / -10 °C ~ 70 °C

Notes: - Any changes to the product specifications will be made without prior notice. This product has been patented, and copying is not permitted.



Battery installation

Remove the back cover and install two triple A batteries making sure they are placed in the opposite direction to each other.

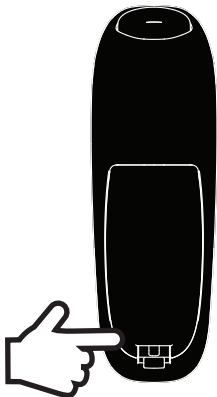

Press and hold the power button (approximately 5 seconds).

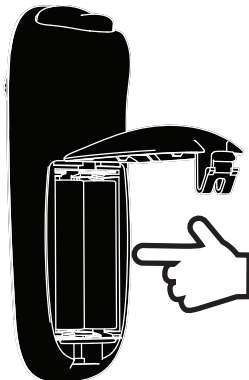

The LED light will turn off.

Tips: - Most VR games can be controlled through the gyroscope, and there is no need for a Bluetooth controller, please refer to the game play tips to see if your device is necessary with it or not.

Startup

Initiate pairing by pressing and holding the button until the LED light begins to flash blue (approximately 3 seconds). The controller will power on and automatically enter VR Mode.



Press and hold the power button (approximately 3 seconds).



The LED light begins to flash blue.



Pair and Connect

Upon boot-up, the LED indicator initiates a flashing sequence, signaling the controller's entry into wireless pairing mode.

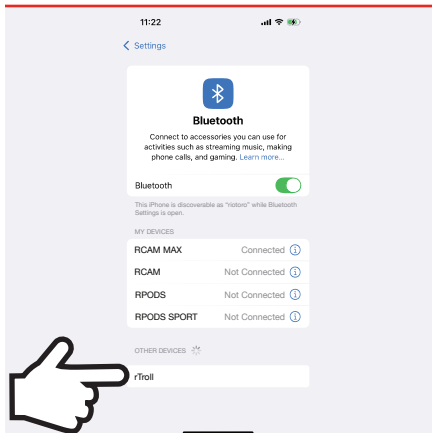

Navigate to your device's Bluetooth settings and scan for available devices; locate and select the "rTroll" controller.

A successful pairing and connection will be indicated by a transition to a slow, pulsating LED flash.

Tips: - Subsequent power cycles will automatically establish a connection with the last paired device, streamlining the user experience.



Switching between modes

Press the switch button (@ button) and the A, B or X button for 3 to 5 seconds to change the operation mode.

Mouse mode

@ Button + A

Music mode

@ Button + B

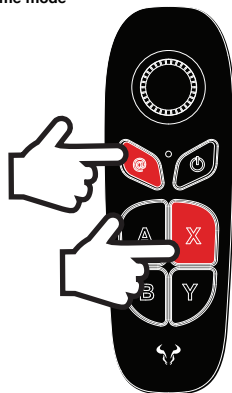
Game mode

@ Button + X

Notes: - press the @ button for 5 seconds to return to VR mode, mouse mode will only be effective on Android system.



Modes in Android OS

Each controller mode has specific button use.

Android OS					
Button	Button Press	Music Mode	VR Mode	Mouse Mode	
Confirmation	-	Play / Pause	Play / Pause	Confirmation button	
360 Rocker	Up	-	Last Song	Slide Up / Zoom In	Move mouse up
	Down	-	Next Song	Glide / Shrink	Move mouse down
	Left	Short	-	Left Slide / Fast Reverse	Move mouse left
	Right	Short	-	Left Slide / Fast Forward	Move mouse right
@ Button	Long	Press for 3 seconds to enter VR mode	-	Press for 3 seconds to enter VR mode	
Power button	Short	-	Press for 3 seconds to turn on / off	-	
A button	Short	Volume Down	Volume Down	Volume Down	
X button	Short	Volume Up	Volume Up	Volume Up	
B button	Short	Return	Return	Return	
Y button	Short	Enter Settings	-	-	

Notes: - Due to the dynamic nature of mobile operating systems and application updates, which may introduce functional modifications, the specifications and operation of this device are subject to change without prior notification. We appreciate your understanding as we strive to maintain compatibility with the evolving software ecosystem.



Modes in iOS

Each controller mode has specific button use.

iOS					
Button	Button Press	Music Mode	VR Mode	Mouse Mode	
Confirmation	-	Play / Pause	Play / Pause	Confirmation button	
360 Rocker	Up	-	Last Song	-	Move mouse up
	Down	-	Next Song	-	Move mouse down
	Left	Short	-	-	Move mouse left
	Right	Short	-	-	Move mouse right
@ Button	Long	Press for 3 seconds to enter VR mode	-	Press for 3 seconds to enter VR mode	
Power button	Short	-	Press for 3 seconds to turn on / off	-	
A button	Short	Volume Down	Volume Down	Volume Down	
X button	Short	Volume Up	Volume Up	Volume Up	
B button	Short	Return	Return	Return	
Y button	Short	Enter Settings	-	-	

Notes: - Due to the dynamic nature of mobile operating systems and application updates, which may introduce functional modifications, the specifications and operation of this device are subject to change without prior notification. We appreciate your understanding as we strive to maintain compatibility with the evolving software ecosystem.



Power off

To power down the controller, depress and hold the power button until the LED indicator extinguishes (approximately 5 seconds).



Press and hold the power button (approximately 5 seconds).



The LED light will turn off.

Tips: For optimized power management, the controller implements automatic shutdown protocols: it will enter a low-power state after 5 minutes of wireless device inactivity and will fully power off after 30 minutes of operational inactivity.



3

Everything Else

www.riotoro.com

General maintenance

Follow these tips to get the best performance from your device:

- Use a soft lint-free cloth (microfiber cloths work great) dampened with a little bit of mild soap and water, or pre-moistened disinfectant wipes. Clean every 3-6 months or whenever needed.
- Use an isopropyl alcohol (IPA) solution or prep pad that's 70% or less with a soft, lint-free cloth, we've tested the safety of using the following isopropyl alcohol (IPA) solution and disinfectant wipes:
 - Isopropyl alcohol (IPA) solution 70% or less
 - Formula 409® All-Purpose Cleaner
 - Windex® Glass Cleaner
 - Dawn (or other mild dish soap) and water
 - Clorox Healthcare® Bleach Germicidal Wipes
- Do not use disinfectant wipes.
- Do not over soak with any cleaning solution.

Note: Do not spray liquid directly onto the case, liquid could drip inside it and cause mold.



Important safety information

- Do not drop, disassemble, open, crush, bend, deform, puncture, shred, microwave, incinerate, or paint your device.
- Do not insert foreign objects into any opening on the device.
- Do not use your device if it's been damaged—for example, if cracked, punctured, or harmed by water.
- Disassembling or puncturing the integrated parts can cause discomfort during use.
- Opening and/or repairing any electronic device can present a risk of electric shock, fire, serious personal injury, death, damage to the device or other property, and/or other hazards.
- Controller repairs should only be undertaken by authorized technicians, with the knowledge, experience, and specialized tools required to repair riotoro devices.
- Improper use or handling of devices or their batteries may result in fire or explosion. Only open the enclosure on a device as outlined in this manual.
- Do not heat, puncture, mutilate, or dispose of devices or their batteries in fire. Do not leave or charge devices in direct sunlight or expose devices or their batteries to temperatures outside the recommended operating range as outlined in this manual. Doing so can result in battery failure, electric shock, fire, serious personal injury, death, and/or damage to the device or other property.



Limited product warranty ("Limited Warranty")

Limited Warranty. RIOTORO warrants the Product to be free from defects in materials and workmanship when used normally in accordance with the official documentation for the applicable Warranty Period from the date of retail purchase.

Exclusions and Limitations. This Limited Warranty does not cover:

- Software, including (without limitation) software added to the RIOTORO-branded hardware products or third-party software;
- Non-RIOTORO branded products and accessories, even if packaged and sold with the Product;
- Problems with and/or damage to the Product caused by using accessories, parts, or components not made by RIOTORO;
- Damage caused by service (including upgrades and expansions) performed by anyone who is not officially acting as an employee, representative or sub-contractor of RIOTORO;
- Claims arising from any unacceptable use or care of the Product;
- Claims arising from external causes, including (without limitation), accidents, acts of God, liquid contact, fire or earthquake;
- Products with a serial number or date stamp that has been altered, obliterated or removed;
- Cosmetic damage, minor cosmetic abnormalities (including minor pixel abnormalities) and normal wear and tear, including (without limitation) scratches, dents and chips.

For the latest and current terms of the Limited Product Warranty, please visit www.riotoro.com/warranty.



Troubleshooting your new device

Controller not connecting

Some Android devices have the function of automatically connecting when detecting the last Bluetooth devices used. Check if this joystick has been connected to other devices when you try to connect. If it is connected to another device, stop the connection and try pairing again.

Controller not disconnecting

If you have already connected the controller and are having difficulty disconnecting it from other devices, connect it again and repeat the procedure with another device.

Connection issues

A common problem with cell phones is that the Bluetooth and WIFI signals can affect each other. It is recommended to turn off the WIFI before connecting.

Abnormal use

When the controller does not work as intended, remove the battery and put it back in. If the issue still continues, replace the battery.

Light indicator intensity change

When the indicator light is not bright enough, it shows that the battery is weak and needs to be replaced.



Recommended accessories



RGOGGLE: Immersive virtual reality experience with a large 50-80 inch virtual screen size and a wide 90-100 degree field of view.



RGOGGLE PLAY: Immerse yourself in a vast virtual screen, tailored to your unique vision. With adjustable comfort and compatibility with a variety of smartphones.



RPODS: Enjoy your favorite games with the RPODS CLASSIC true wireless earbuds enabled with DSP Noise Cancellation. The 6.0mm drivers enrich your listening experience with high-fidelity sound, and on-board touch controls let you manage your RPODS CLASSIC with a tap.



AVIATORS: Immerse yourself in the game with Aviator CLASSIC II's 7.1 surround sound, personalized comfort and for PCs, consoles and mobile devices.



RMIC DESKTOP: Features a custom mic capsule to provide an exceptional voice presence for pro-level recording or streaming. Ready to rock out of the box, no need to configure anything to broadcast yourself with crystal clear sound.





© 2014-2026 RIOTORO. All rights reserved. RIOTORO, the RIOTORO logo, and RCAM are trademarks of RIOTORO, Registered in the U.S. and other countries. All other trademarks are the property of their respective owners. Product may vary slightly from those pictured.

Technical Support and Customer Service
US & Canada
1-888- 270-7090
support@riotoro.com
sales@riotoro.com

© Copyright 2014-2026 RIOTORO. All rights reserved.
All trademarks are the property of their respective owners.
Reproduction in whole or part without written permission is prohibited.

www.riotoro.com