

# RHINO-RACK

## Rhino-Rack Alloy Tray Vortex/ Sports Bar Fit

**Important:** Please read these instructions carefully prior to installation.  
Please refer to your fitting instruction to ensure that the roof racks are installed in the correct locations.  
Check the contents of kit before commencing fitment and report any discrepancies.

### Layout Example

Alloy Luggage Tray comes in assorted sizes from  
2 - 4 Crossbars, 3 - 6 Planks.

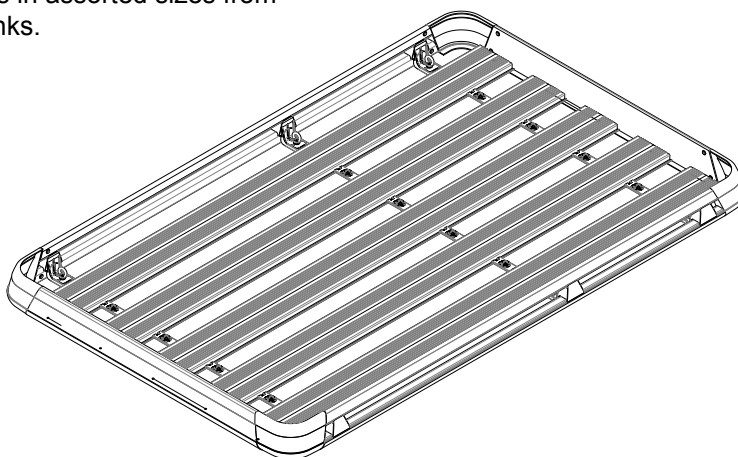

### Download your Vehicle Fitment Sheet

Individual fitment sheets exist for every vehicle and tray size available. Fitment sheets can be checked on the RhinoRack Website under 'Fit My Car'. Simply select the make and model of the vehicle, select the Pioneer tray of choice and click on instructions:

<http://www.rhinorack.com.au/fit-my-car/select-vehicle>

**Max Load Capacity:** Max permissible load is dependent on vehicle carrying capacity. Note that in off road conditions, the load limit must use a safety factor of 1.5. Eg: If maximum allowable load is 150kg (330lbs),  $150/1.5 = 100\text{kg}$  (220lbs).

Read through instructions before installation. If you are unsure or have any questions, refer to the dealer or place of purchase.

#### Recommendations:

It is essential that all bolt connections be checked after driving a short distance when you first install your crossbars. Bolt connections should be checked again at regular intervals (once a week is enough, depending on road conditions, usage, loads and distances travelled). You should also check the Alloy Tray each time it is refitted. Make sure to fasten your load securely. Please ensure that all loads are evenly distributed and that the centre of gravity is kept as low as possible. Use non stretch ropes.

**Please remove Crossbars/ Alloy Trays when putting vehicle through an automatic car wash.**

**Never use side rails as tie off points.**

**Vehicle sensitivity to cross winds and behaviour in curves and breaking may be altered when transporting loads on the roof. It is recommended to take extreme care when driving and braking.**

#### Load Ratings:

Maximum permissible load is vehicle specific, check vehicle owners handbook. Although the Alloy Trays are tested and approved to AS1235-2000, Off road conditions can be much more rigorous. However, increasing the number of crossbars does not increase the vehicles maximum permissible roof loading.

**Note for Dealers and Fitters: This is a two person installation. Lifting the Alloy Tray to the roof requires assistance.** It is your responsibility to ensure instructions are given to the end user or client.

Rhino-Rack  
3 Pike Street, Rydalmere,  
NSW 2116, Australia.  
(Ph) (02) 9638 4744  
(Fax) (02) 9638 4822

Document No: RS50  
Prepared By: Kayle Everett  
Authorised By: Chris Murty

Fit Time: 45min  
Issue No: 04  
Issue Date: 03/09/2015

These instructions remain the property of Rhino-Rack Australia Pty. Ltd. and may not be used or changed for any other purpose than intended.



# Rhino-Rack Alloy Tray Vortex/ Sports Bar Fit

## Parts List

Item	Component Name	Qty	Part No.
1	Side Rail Assembly	2	-
2	Plank Extrusion (with 2 slots)	2	-
3	Plank Extrusion (with no slots)	3-6	-
4*	Metal Bracket	4-6	C129
5	5mm Allen Key	1	H011/H013
6	Front/Rear Rail	2	-
7*	M8 Spring Washer	4-6	W019
8*	M8 Flat Washer	4-6	W020
9	M6 Spring Washer	6-12	W004
10	1/4" 10mm Screw	8	B046
11*	M8 Eye Nut	4-6	C079
12*	M6 x 16mm Bolt	6-12	B061
13*	M8 x 30mm Square Head Bolt	4-6	B130
14*	Securing Knob	4-12	M137
15*	Securing Lock Tab Plate	4-12	M136
16	Fitting Instruction	1	RS-50

### Tools Required:

Philips Head Screw Driver.  
Measuring Tape.

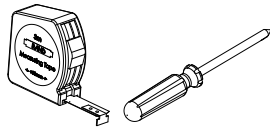

\* Note: Items sold separately in fit kit.

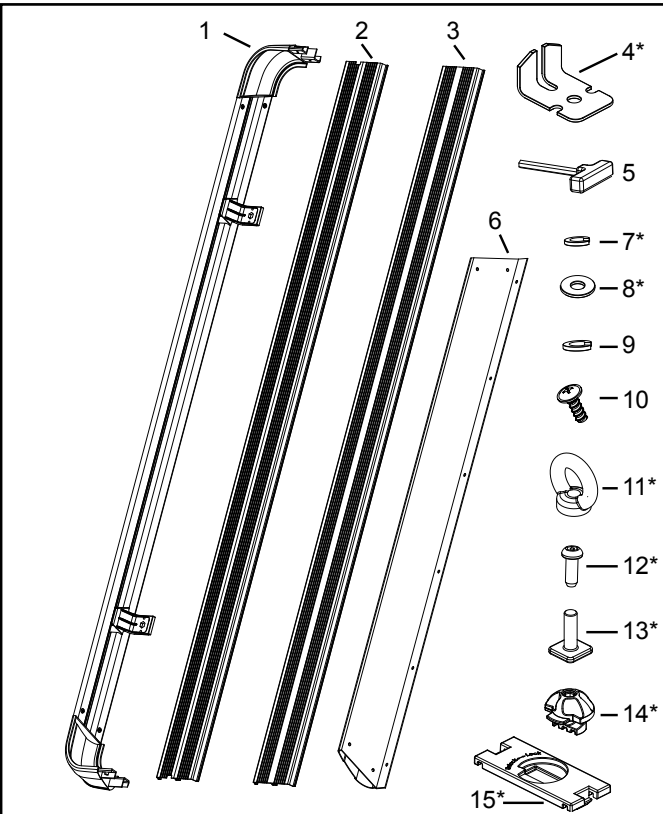

Fit kits are required to fit Rhino-Rack Alloy Trays to your vehicle.  
Refer to table below or <http://www.rhinorack.com.au/fit-my-car/select-vehicle>

Kit	Component Name
EK2	AT FIT KIT 2 BAR SUIT EURO BAR
HK23	AT FIT KIT 2 BAR 3 PLANK - H/D
HK24	AT FIT KIT 2 BAR 4 PLANK - H/D
HK35	AT FIT KIT 3 BAR 5 PLANK - H/D
HK36	AT FIT KIT 3 BAR 6 PLANK - H/D
HK45	AT FIT KIT 4 BAR 5 PLANK - H/D
S400-FK1	S400 FIT KIT SEE NOTES FOR APPLICATION

Kit	Component Name
SK23	AT FIT KIT 2 BAR 3 PLANK- SUIT AERO BA
SK24	AT FIT KIT 2 BAR 4 PLANK - SUIT AERO B
SK35	AT FIT KIT 3 BAR 5 PLANK - SUIT AERO B
SK36	AT FIT KIT 3 BAR 6 PLANK - SUIT AERO B
SK45	AT FIT KIT 4 BAR 5 PLANK - SUIT AERO B
TK24	AT FIT KIT 2 BAR 4 PLANK SUIT THULE BAR
TK25	AT FIT KIT 2 BAR 5 PLANK SUIT THULE BAR

## Instructions

- 1 Insert the two Front Rail Extrusions into the Side Rail Assemblies. Insert the screws with a Philips Head Screw Driver as shown.

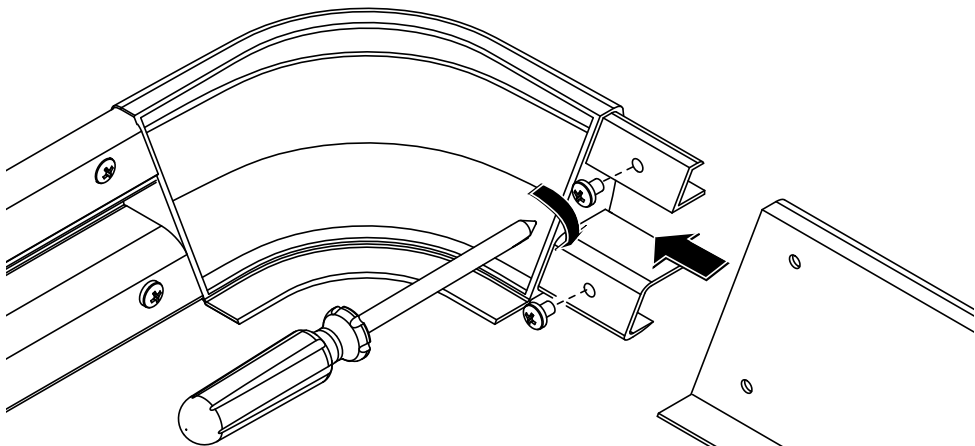

# Rhino-Rack Alloy Tray Vortex/ Sports Bar Fit

- 2 Insert the Plank Extrusions into the tray. Attach each Plank with two M6 Security Bolts and two Spring Washers using the Allen key provided. Please note there are two Plank Extrusions with slots. These are to be positioned on the far left and right hand side of the tray.

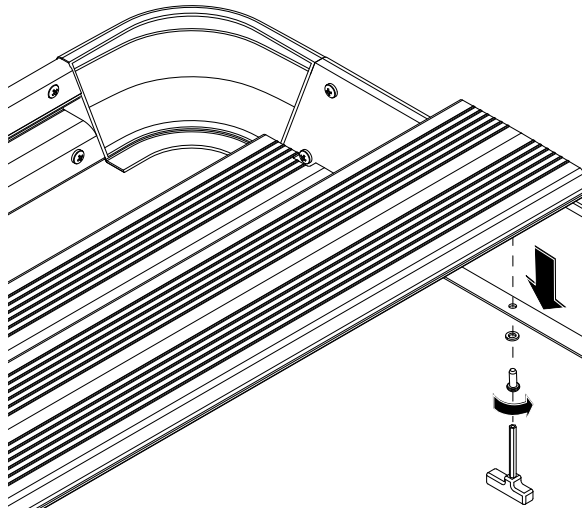

- 3 Remove the rubber strip.

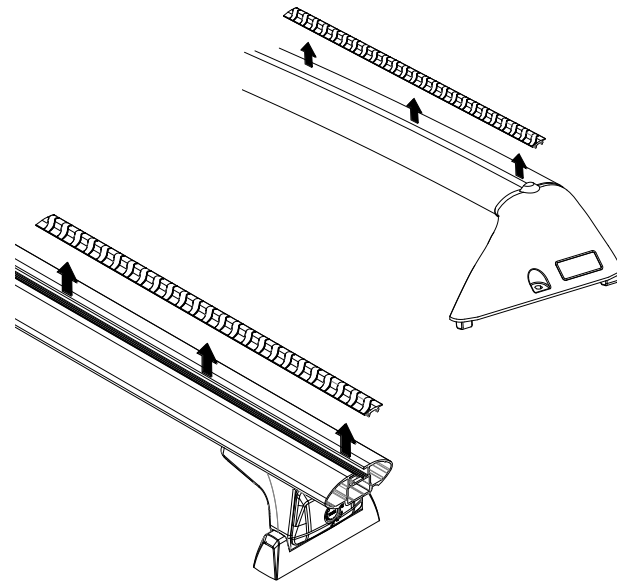

- 4 Slide a M8 x 30mm square head bolt into the cross-bar. Repeat this till all these parts are used. Place a Metal bracket in each Plastic Side Rail Housing. Place the Alloy tray on top of the vehicle so the M8 bolts protude though the metal bracket. Place a Flat Washer, a Spring Washer and a M8 Eye Nut on each bolt.

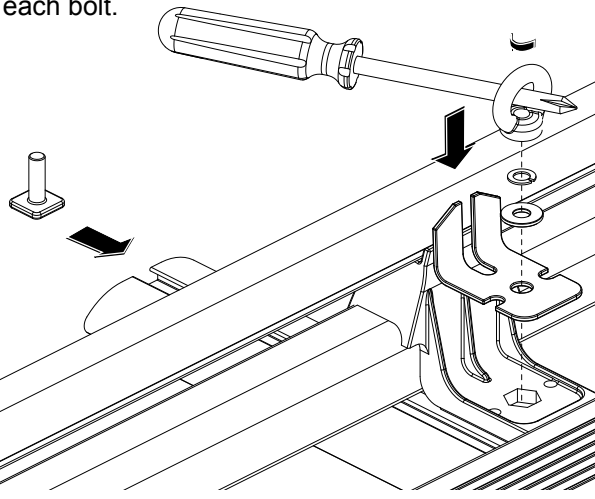

- 5 Adjust the Alloy Tray on the cross bars so that dimension 'A' is equal and dimension 'B' is equal. Tighten the eye nuts to secure the Alloy Tray to the cross bars, make sure the eye nuts are parallel to the cross bars as shown.

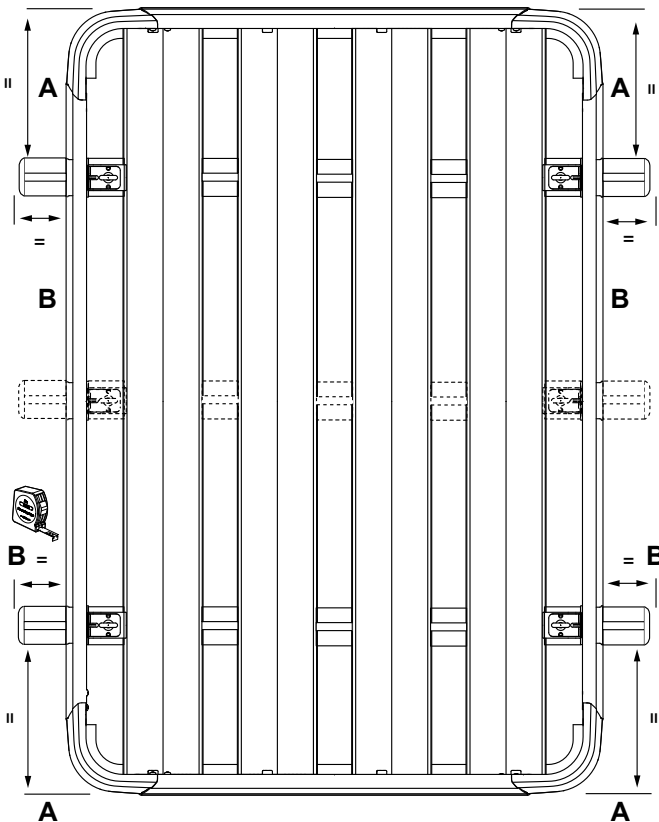

- 6 Place a securing lock tab plate in the cross bar between each Plank. Place the securing knob into the securing lock tab plate. Rotate the channel nut 90° with the allen key provided. Repeat till all Planks are secured to the cross bar.

