

8.4-83

**TYPICAL CROSS - SECTION A-A**  
NO SCALE

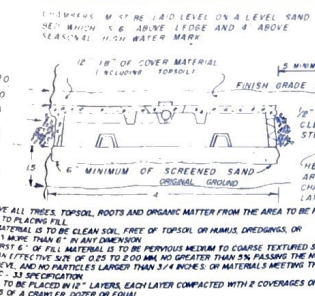

**TEST PIT LOG**

OBSERVED 6/3/86

DEPTH	DESCRIPTION	TEST PIT NO.
0 - 6"	ORGANIC MAT	523BH
6 - 12"	DARK BROWN FINE SANDY LOAM GRANULAR FRIABLE	523BH
12 - 28"	BROWN FINE SANDY LOAM GRANULAR FRIABLE	523BH
28 - 36"	VERY GRAVELLY YELLOWISH BROWN SANDY LOAM AND GRAVEL	523BH
36 - 54"	BOULDERY DARK BROWN, YELLOWISH BROWN AND GRAY GRAVELLY FINE SANDY LOAM. PLTY, FINE	523BH
54"	REFUSAL (LEDGE) ESHW 36"	523BH

**LEGEND:**

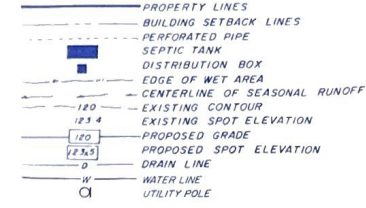

**DESIGN DATA:**

SYSTEM DESIGN IS FOR 3 BEDROOMS  
3 BEDROOMS AT 15 MINUTES PER INCH = 955 SQ FT  
LEACHING AREA WITH CHAMBERS IS 355 ± 60% = 323 SQ FT  
REQUIRED SIZE SQ FT PROVIDED  
1000 GALLON CONCRETE SEPTIC PROVIDED  
SEPTIC TANK, DISTRIBUTION BOX, LEACHING & PUMP CHAMBERS ARE TO BE SUPPLIED BY ROTONDO B SONS, INC., REHOBOTH, MA., WASTE INC., CONCORD, NH OR EQUIVALENT

**DESIGN INTENT:**

BOTTOM OF BED IS TO BE 15 FEET ABOVE THE HIGHEST EXISTING GRADE WITHIN THE PROPOSED LEACHFIELD AREA

**NOTES:**

- THE SUBJECT PROPERTY (IS) (IS NOT) PART OF A SUBDIVISION SUBDIVISION NAME POINT - GREENE INC. N H W S P C C SUBDIVISION APPROVAL NO 36030 DATED 5/18/88 PREVIOUS INDIVIDUAL APPROVAL FOR CONSTRUCTION NO 195728, DATED 11/2/92
- DESIGNER IS TO BE NOTIFIED IF SOIL PROPERTIES FOUND DURING CONSTRUCTION DIFFER SIGNIFICANTLY FROM THOSE DETERMINED FOR THE DESIGN

The Wetland Conservation District Boundary westerly of the 7 foot contour marsh was established 50 feet from the discernibly westerly of the salt water marsh boundary as defined by the N.H. Wetlands Board, the definition by the High Intensity Soil Survey criteria, and the Mean High Tide elevation of 4.35 Feet, National Hydrographic Vertical Datum of 1929, as established by the Portsmouth Harbor, Gaging Station by the National Ocean Survey.

- THERE ARE NO EXISTING OR PROPOSED ABUTTING FOUNDATIONS, WELLS OR DRAINS WITHIN 75' OF THE PROPOSED SYSTEM
- DEED REFERENCE TO THE PARCEL IS VOL 2912 PAGE 1073 DATED JUNE 26/1990 IN THE ROCKINGHAM COUNTY REGISTRY OF DEEDS
- PLAN REVISED FOR CHANGE OF HOUSE LOCATION AND THE ADDITION OF A PUMP



8.0-75

8.0-76

2.083 ACRES  
90,732 SQ. FT.  
53,900 SQ. FT. (NON-WETLAND CONSERVATION DISTRICT) EXCLUDING THE 100 YEAR BASE FLOOD AREA

8.0-77

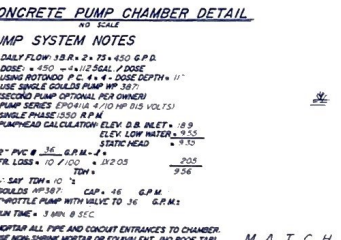
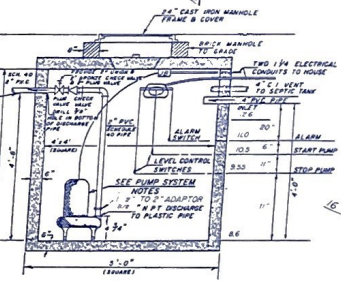

APPROVED FOR CONSTRUCTION  
BY N.H. DEPT. OF ENVIRONMENTAL SERVICES  
WATER SUPPLY & POLLUTION CONTROL DIVISION  
DATE 12/19/92

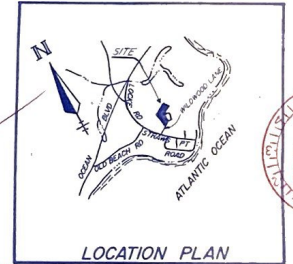

REVISOR YOUR COMMENTS ON PROPOSED SEWAGE DISPOSAL SYSTEM PLAN & DETAILS REVISIONS BEING AS INDICATED ON THIS CONDITIONAL APPROVAL

REVIEWED AND APPROVED IN ACCORDANCE WITH REGULATIONS OF THE N.H. DEPT. OF ENVIRONMENTAL SERVICES WATER SUPPLY & POLLUTION CONTROL DIVISION  
Signed: *Deanna Knapp*  
DATE 12/92 # 192187

**PATRICK J. & ROBIN L. CANAL**  
RYE, N.H.  
LOT NO. 8.0-76

DESIGNER OF SUBSURFACE DISPOSAL SYSTEMS  
Dawn B. Tomala  
No. 638  
Water Supply & Pollution Control

SCALE 1" = 20'

DATE OCT 8, 1992 (REVISED DEC 7, 1992)

