



790 LAFAYETTE ROAD  
MEDINA, OH 44256

LEASE RATE: \$300 - \$675/MO



### PROPERTY HIGHLIGHTS:

- Available: 120 SF - 800 SF
- **Suite 3 (120 SF)** consists of a single office with natural light
- **Lower Level Suite (800 SF) \*Available in September\*** consists of 4 private rooms ranging from 72 SF to 377 SF, and shared restrooms on entry floor
- Utilities included with both spaces
- Parking: 24 Spaces
- Zoning: C-3 General Commercial
- 1.5 Miles to Medina's Historic District
- Highway Access: Less than 5 miles to I-71/SR 18 Interchange

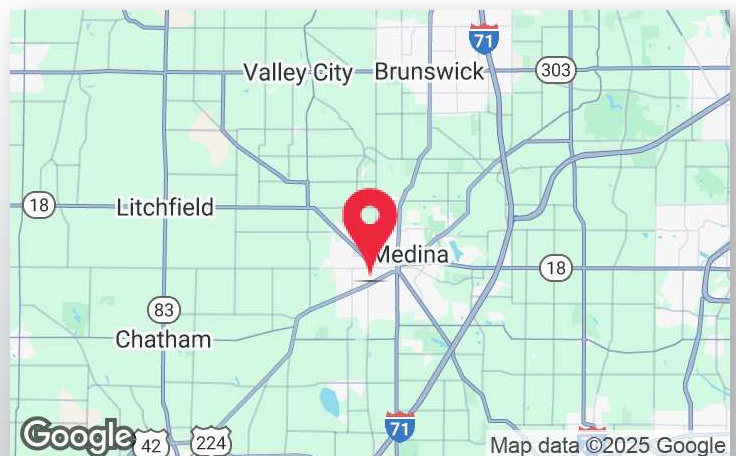

### LISTING AGENT

Emily Faust  
emily@gerspachergroup.com  
**330.722.5002**







**790 LAFAYETTE ROAD  
MEDINA, OH 44256**

**LEASE RATE: \$300 - \$675/MO**



## PROPERTY OVERVIEW

Two story office building just southwest of the Medina Square. Updated multi-use office space. First floor single office (120 SF), carpeted, with natural light. Common area with small reception and shared restrooms. Upstairs is the owner's office and an additional storage room. 800 SF of brightly lit lower-level space is available, 4 private rooms ranging from 72 SF to 377 SF. Shared restrooms on the entry floor. Ample parking shared by all tenants and great visibility along Lafayette Road.

## LOCATION OVERVIEW

This is a high-traffic and high-visibility location that is just southwest of the Historic Medina Square and less than five miles from the I-71 at SR-18 interchange.

### DEMOGRAPHICS

	1 MILE	3 MILES	5 MILES
Total Households	2,200	14,671	22,798
Total Population	5,709	36,468	57,037
Average HH Income	\$119,836	\$120,761	\$130,562

*The information contained herein is from sources deemed reliable but no warranty or representation is made to the accuracy thereof.*





790 LAFAYETTE ROAD  
MEDINA, OH 44256

LEASE RATE: \$300 - \$675/MO

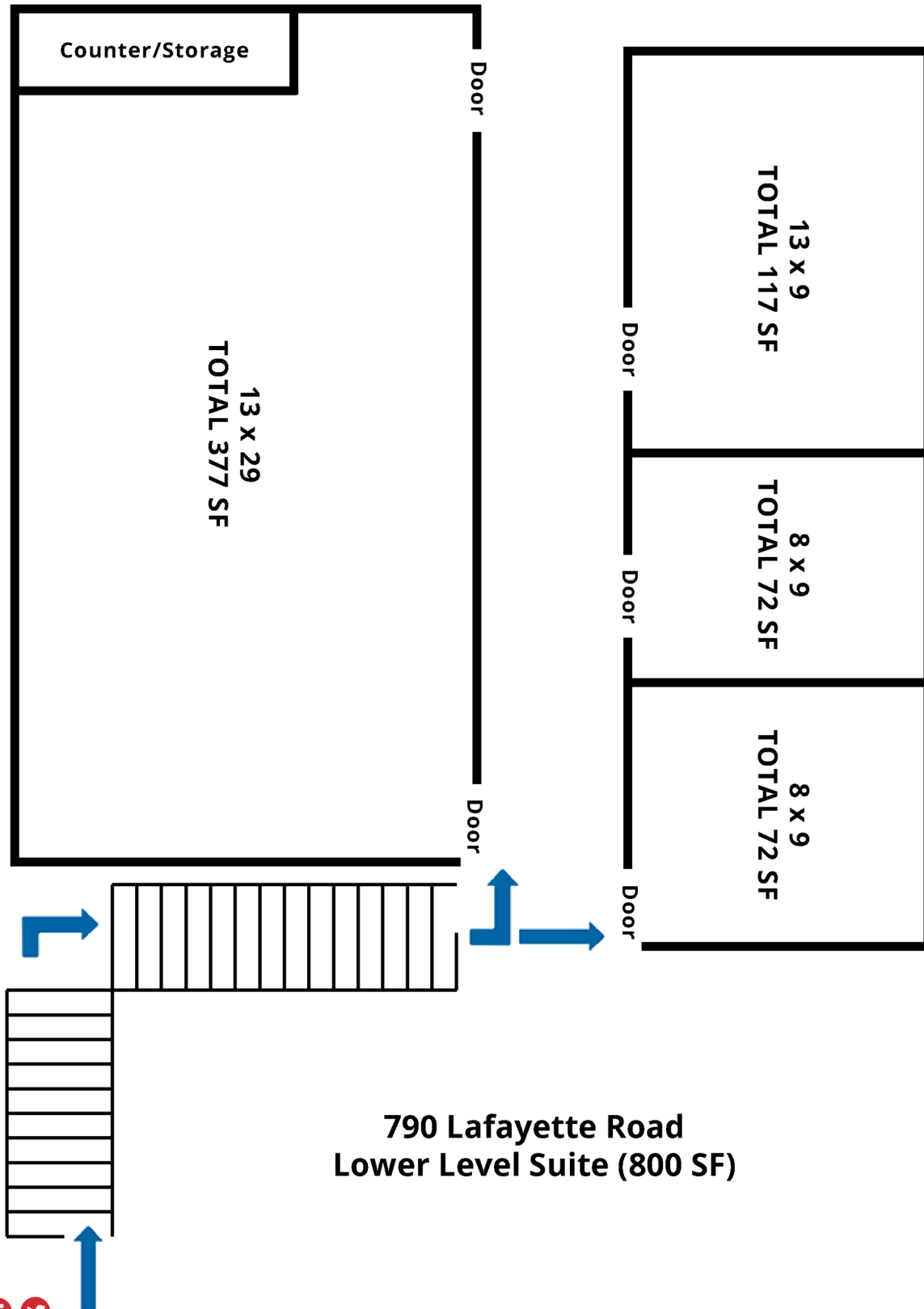



**SINGLE & LOWER-LEVEL OFFICE SPACES AVAILABLE IN MEDINA**



**790 LAFAYETTE ROAD  
MEDINA, OH 44256**

**LEASE RATE: \$300 - \$675/MO**

