

CLASS A OFFICE SPACE

Newly Constructed October of 2025

Herndon Pinnacle Office Complex
700 & 650 W. Herndon Avenue Clovis, CA 93612



FOR LEASE

GREG MAROOT
Broker Associate
(559) 994-0254
gmaroot@comcast.net
DRE #01102553, CA

PROPERTY DESCRIPTION

Available newly constructed class A office space in the brand new premier Herndon Pinnacle Office Complex building of Fresno & Clovis, which will feature contemporary and distinctive attributes designed by the by the internationally recognized architectural firm SmithGroup.

LOCATION DESCRIPTION

Strategically located on the Herndon Avenue Office corridor with close proximity to Freeway 168. Located between St. Agnes Hospital & Clovis Community Hospital. Adjacent to the premier shopping centers & restaurants of Fresno & Clovis.

SUMMARY

Building SF: Two \pm 45,000 SF Buildings

Projected Shell Completion Date: October 2025 - Building A

Available SF: \pm 90,000 SF
Divisible to 5,000 USF

Lease Rate: Contact Listing Agent

TI Allowance: Negotiable

RE/MAX GOLD
COMMERCIAL

FOR LEASE

HERNDON PINNACLE OFFICE COMPLEX

700 W. HERNDON AVENUE, CLOVIS, CA 93612



RE/MAX GOLD
COMMERCIAL

RE/MAX GOLD

Each office independently owned and operated

GREG MAROOT

Broker Associate

(559) 994-0254

gmaroot@comcast.net

7815 N. Palm Ave. Ste. 120

Fresno, CA. 93711

This communication is not intended to cause or induce breach of an existing agency agreement. All information contained herein is deemed reliable but not guaranteed. *Personal Real Estate Corporation

FOR LEASE

HERNDON PINNACLE OFFICE COMPLEX

700 W. HERNDON AVENUE, CLOVIS, CA 93612



RE/MAX GOLD
COMMERCIAL

RE/MAX GOLD

Each office independently owned and operated

GREG MAROOT

Broker Associate

(559) 994-0254

gmaroot@comcast.net

7815 N. Palm Ave. Ste. 120

Fresno, CA. 93711

This communication is not intended to cause or induce breach of an existing agency agreement. All information contained herein is deemed reliable but not guaranteed. *Personal Real Estate Corporation

HERNDON PINNACLE OFFICE COMPLEX

700 W. HERNDON AVENUE, CLOVIS, CA 93612

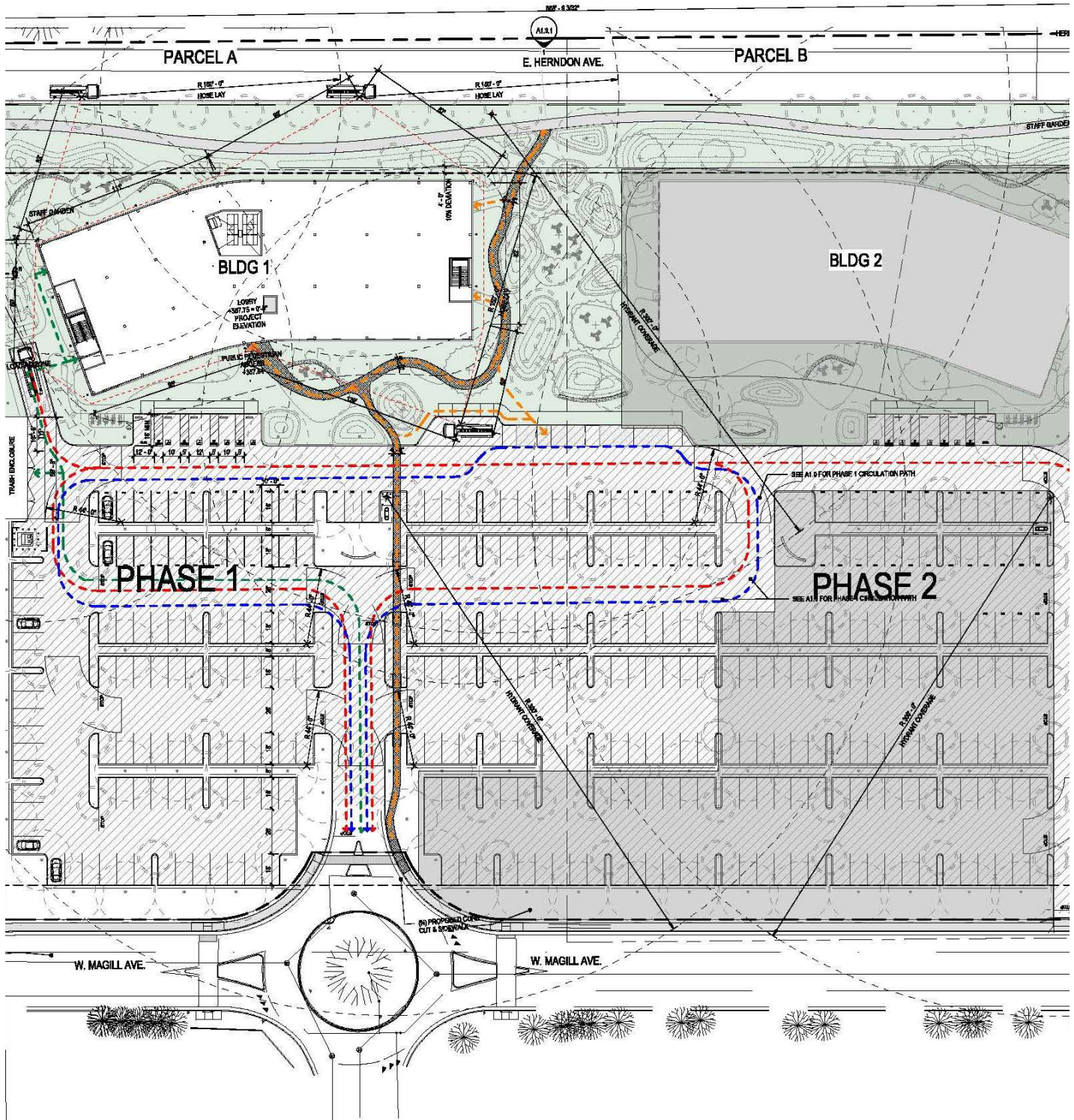

RE/MAX GOLD
COMMERCIAL

RE/MAX GOLD

Each office independently owned and operated

GREG MAROOT

Broker Associate

(559) 994-0254

gmaroot@comcast.net

7815 N. Palm Ave. Ste. 120

Fresno, CA. 93711

HERNDON PINNACLE OFFICE COMPLEX

700 W. HERNDON AVENUE, CLOVIS, CA 93612

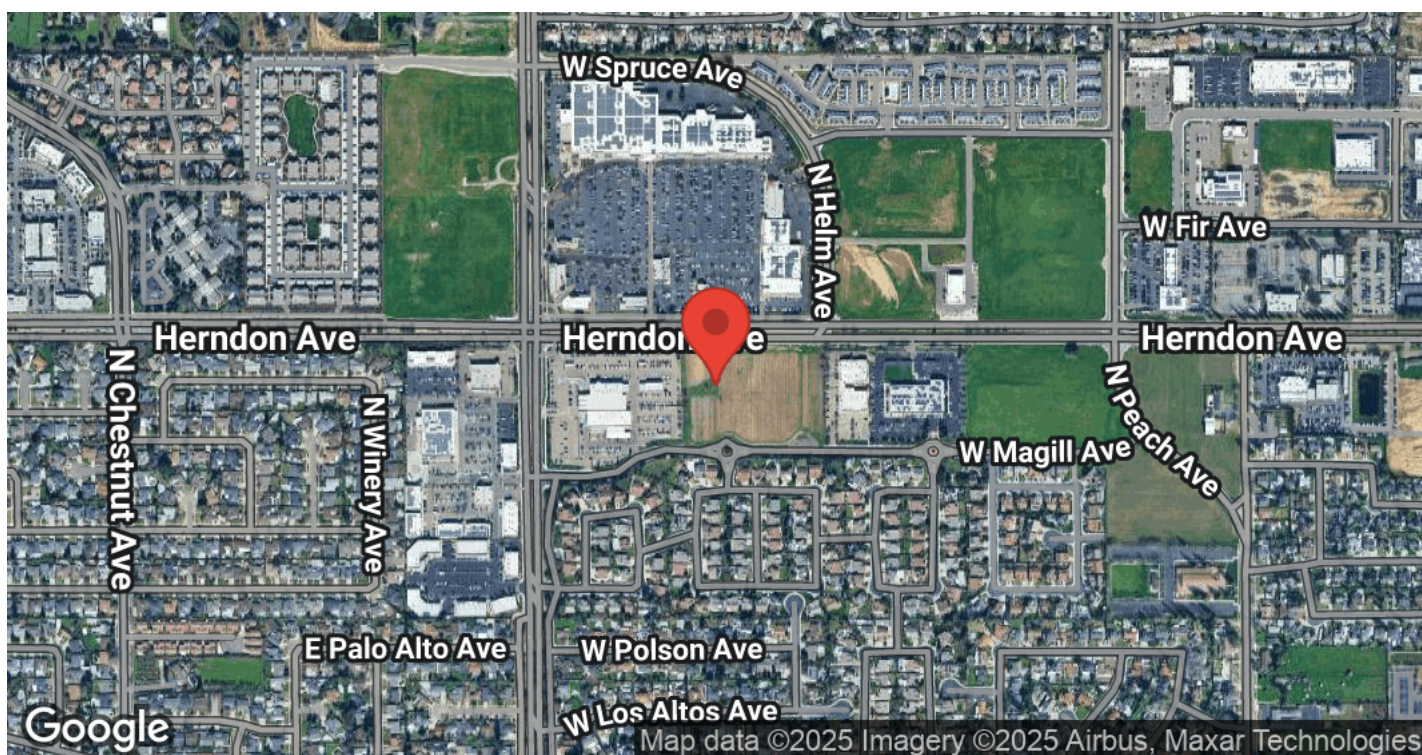

RE/MAX GOLD
COMMERCIAL

RE/MAX GOLD

Each office independently owned and operated

GREG MAROOT

Broker Associate

(559) 994-0254

gmaroot@comcast.net

7815 N. Palm Ave. Ste. 120

Fresno, CA. 93711

HERNDON PINNACLE OFFICE COMPLEX

700 W. HERNDON AVENUE, CLOVIS, CA 93612

