



SSCX series

Stainless Steel Centrifugal Pumps



The SSCX Series Centrifugal Pumps feature high-head performance and quiet operation. These pumps are remarkably versatile and have corrosion-resistant dependability.

APPLICATIONS

- Ideal choice for a wide range of pump applications and varying temperature conditions

SPECIFICATIONS

- Pump Body** – Stainless steel
- Impeller** – Noryl®
- Multiple Seal Options**

FEATURES

Stainless Steel Housing and Shaft

– Maximum corrosion resistance in chemical as well as water applications; smooth flow path assures quiet operation.

High Temperature Rating – The SSCX Series centrifugal pumps are designed for temperatures up to 185°F.

Mechanical Shaft Seal – Precision lapped and highly polished carbon-ceramic, stainless steel construction with buna elastomers; delivers long-life reliability.

Multiple Seal Options – Choice of three seal options to meet a wide variety of pump applications.

- The standard seal in a SSCX Series is a Buna carbon/ceramic. The volute uses a Buna O-ring to seal the pumping chamber sections.
- Viton with carbon/ceramic faces, includes Viton O-ring change out in pump volute.
- Viton with carbon/silicon carbide faces, includes Viton O-ring change out in pump volute.

Noryl® Composite Impeller

– Precision molded for perfect balance and lasting quality; ultra-smooth flow ports maximize performance and efficiency. 304SS impeller insert for increased durability.

Drain/Vent Ports – Priming and draining is easier, faster.

BERKELEY® is a registered trademark of Pentair Water. Noryl® is a registered trademark of General Electric Co.

In order to provide the best products possible, specifications are subject to change.



SSCX series

Stainless Steel Centrifugal Pumps

ORDERING INFORMATION

| Model Number | Catalog Number | HP | Suction | Discharge | Motor Voltage | Phase | Enclosure | Approx. Wt. Lbs. |
|-----------------|----------------|-------|---------|-----------|---------------|-------|-----------|------------------|
| SS1XN-1/2 | B78635 | 1/2 | 1-1/4" | 1" | 115/230 | 1 | ODP | 29 |
| | B78636 | | | | 230/460 | 3 | ODP | 29 |
| | B78647 | | | | 115/230 | 1 | TEFC | 32 |
| | B78648 | | | | 230/460 | 3 | TEFC | 32 |
| SS1XN-3/4 | B78637 | 3/4 | 1-1/4" | 1" | 115/230 | 1 | ODP | 38 |
| | B78638 | | | | 230/460 | 3 | ODP | 38 |
| | B78649 | | | | 115/230 | 1 | TEFC | 41 |
| | B78650 | | | | 230/460 | 3 | TEFC | 41 |
| SS1XN-1 | B78639 | 1 | 1-1/4" | 1" | 115/230 | 1 | ODP | 47 |
| | B78640 | | | | 230/460 | 3 | ODP | 47 |
| | B78651 | | | | 115/230 | 1 | TEFC | 50 |
| | B78652 | | | | 230/460 | 3 | TEFC | 50 |
| SS1XN-1-1/2 | B78641 | 1-1/2 | 1-1/4" | 1" | 115/230 | 1 | ODP | 62 |
| | B78642 | | | | 230/460 | 3 | ODP | 62 |
| | B78653 | | | | 115/230 | 1 | TEFC | 65 |
| | B78654 | | | | 230/460 | 3 | TEFC | 65 |
| SS1-1/4XN-2 | B78643 | 2 | 1-1/2" | 1-1/4" | 230 | 1 | ODP | 77 |
| | B78644 | | | | 230/460 | 3 | ODP | 77 |
| | B78655 | | | | 230 | 1 | TEFC | 80 |
| | B78656 | | | | 230/460 | 3 | TEFC | 80 |
| SS1-1/4XN-2-1/2 | B78645 | 2-1/2 | 1-1/2" | 1-1/4" | 230 | 1 | ODP | 90 |
| | B78646 | | | | 230/460 | 3 | ODP | 90 |
| | B78657 | | | | 230 | 1 | TEFC | 93 |
| | B78658 | | | | 230/460 | 3 | TEFC | 93 |

PUMP PERFORMANCE

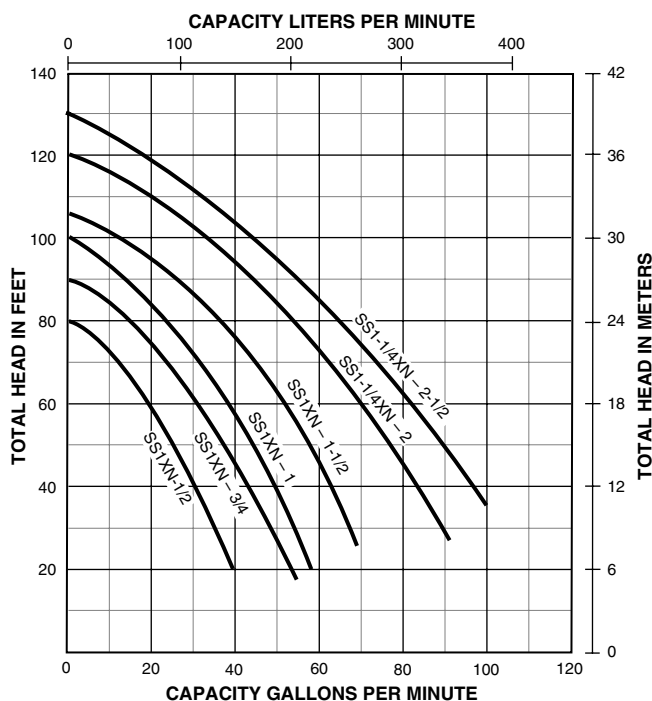



SSCX series

Stainless Steel Centrifugal Pumps

OUTLINE DIMENSIONS

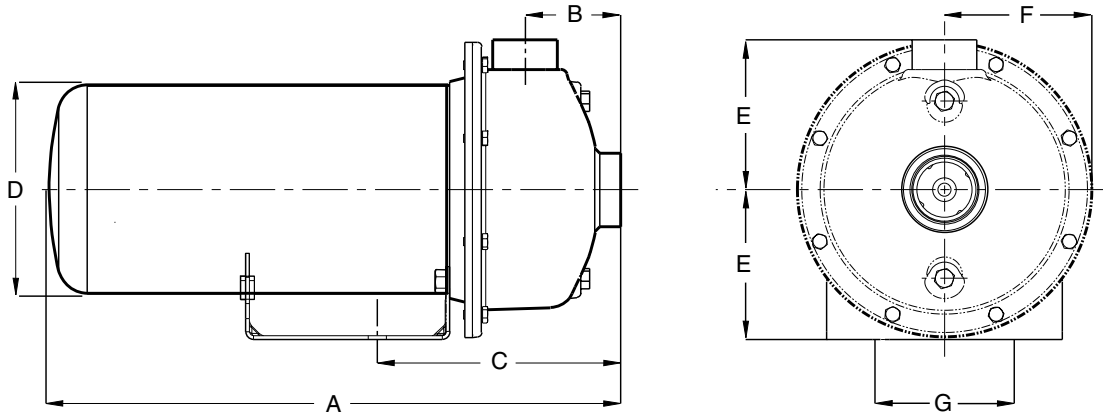

Dimensions (in inches) are for estimating purposes only.

DIMENSIONS IN INCHES – SSCX ODP

| HP | NPT Suct. | NPT Disch. | A (1 phase) | A (3 phase) | B | C | D | E | F | G |
|-------|-----------|------------|-------------|-------------|------|------|------|------|------|-------|
| 1/2 | 1-1/4 | 1 | 13.2 | 13.5 | 2.43 | 6.51 | 5.63 | 4.13 | 4.06 | 4.875 |
| 3/4 | 1-1/4 | 1 | 13.2 | 13.5 | 2.43 | 6.51 | 5.63 | 4.13 | 4.06 | 4.875 |
| 1 | 1-1/4 | 1 | 14.2 | 14.0 | 2.43 | 6.51 | 5.63 | 4.13 | 4.06 | 4.875 |
| 1-1/2 | 1-1/4 | 1 | 14.5 | 14.5 | 2.43 | 6.51 | 5.63 | 4.13 | 4.06 | 4.875 |
| 2 | 1-1/2 | 1-1/4 | 16.0 | 15.7 | 2.63 | 6.71 | 5.63 | 4.13 | 4.06 | 4.875 |
| 2-1/2 | 1-1/2 | 1-1/4 | 16.9 | 16.4 | 2.63 | 6.71 | 5.63 | 4.13 | 4.06 | 4.875 |

DIMENSIONS IN INCHES – SSCX TEFC

| HP | NPT Suct. | NPT Disch. | A (1 phase) | A (3 phase) | B | C | D | E | F | G |
|-------|-----------|------------|-------------|-------------|------|------|------|------|------|-------|
| 1/2 | 1-1/4 | 1 | 14.0 | 14.2 | 2.43 | 6.51 | 6.44 | 4.13 | 4.06 | 4.875 |
| 3/4 | 1-1/4 | 1 | 14.9 | 14.2 | 2.43 | 6.51 | 6.44 | 4.13 | 4.06 | 4.875 |
| 1 | 1-1/4 | 1 | 15.7 | 15.2 | 2.43 | 6.51 | 6.44 | 4.13 | 4.06 | 4.875 |
| 1-1/2 | 1-1/4 | 1 | 16.2 | 15.2 | 2.43 | 6.51 | 6.44 | 4.13 | 4.06 | 4.875 |
| 2 | 1-1/2 | 1-1/4 | 16.4 | 16.4 | 2.63 | 6.71 | 6.44 | 4.13 | 4.06 | 4.875 |
| 2-1/2 | 1-1/2 | 1-1/4 | 16.9 | 16.4 | 2.63 | 6.71 | 6.44 | 4.13 | 4.06 | 4.875 |