

Take Control[®]
ion[®]

Technologies



Auxiliary Catalog

Pumps Controllers Packages Systems Accessories



37 Forestwood Dr., Romeoville, IL 60446 www.ionproducts.net [815] 886-9200

Take Control.
ION
Controllers



Ion®

Digital Level Control Switch

- Rated for use in both sump and sewage pump applications
- Will work with any 115 volt pump up to 15 amps
- Solid state sensing technology with no moving parts to wear or fail
- Designed to operate for over 2 million cycles
- Longer pumping differential means it will pump more water less frequently
- 10 and 20 foot cord options are available



37 Forestwood Dr., Romeoville, IL 60446 www.ionproducts.net [815] 886-9200

Patent No. 8,591,198

Assembly View

1. Cord strain relief follower
2. Mounting arm screw
3. Switch mounting arm
4. Top housing
5. Control and logic boards
6. Switch bracket
7. Strain gauge
8. Pressure plate
9. Diaphragm with integrated o-ring gasket
10. Diaphragm guard

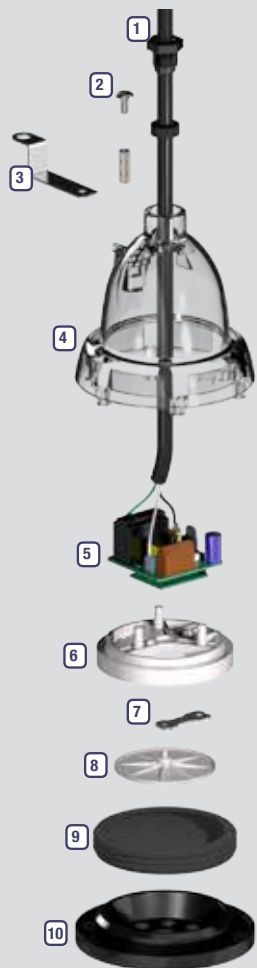

Switch Dimensions

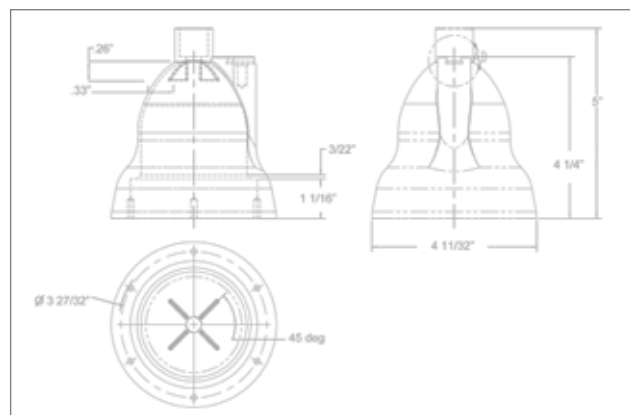

Piggyback Plug Illustration

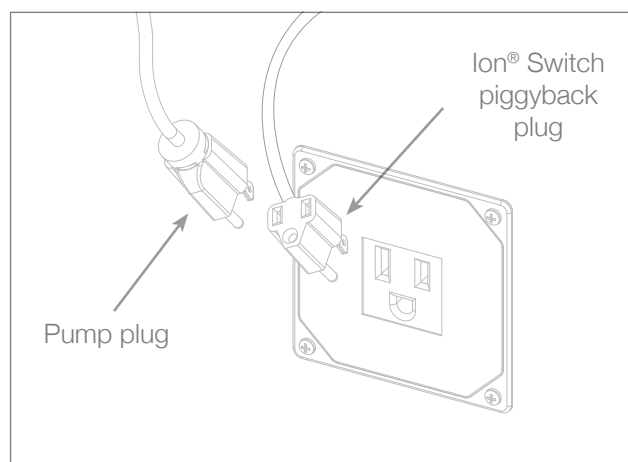

System Specifications

- Type of Application: Sump and sewage
- Voltage: 115 volt
- Amp Rating: 13 FLA, 15 amp max
- Power Cord: 10' or 20'
- Pump Range: 6" or 8.5"
- 3 year warranty

Take Control.
ion
Controllers



Ion+[®]

Digital Level Control with High Water Alarm

- World's first digital piggyback style sump & sewage pump level control sensor with integrated alarms
- Provides alarm notification via an audible buzzer, LED indicators, and dry alarm contact
- Device can be connected to external alarm notification systems such as our Ion Gateway[®] or MetroMail[™] systems, for real-time notification capability
- Ion[®] digital level control technology provides superior performance and reliability when compared to industry standard mechanical pump switches



Typical Installation

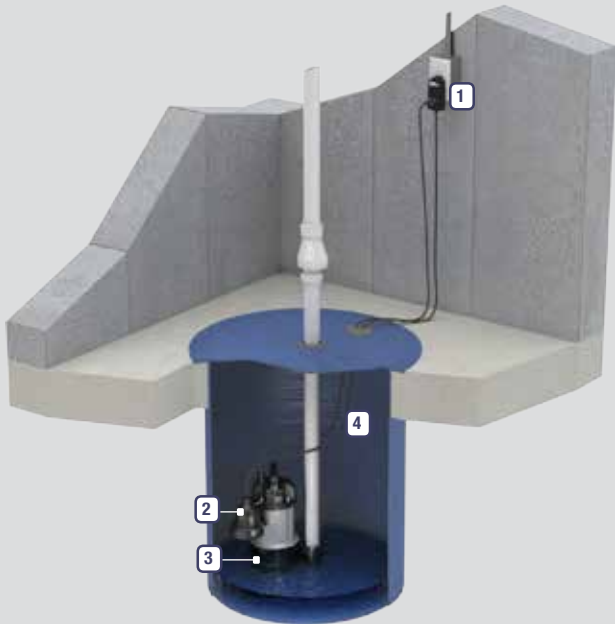

1. Ion+® piggyback plug with audible alarm and visual status LEDs
2. Ion+® digital level control sensor
3. Standard Ion® StormPro® pump (not included)
4. Basin (not included)

Switch Dimensions

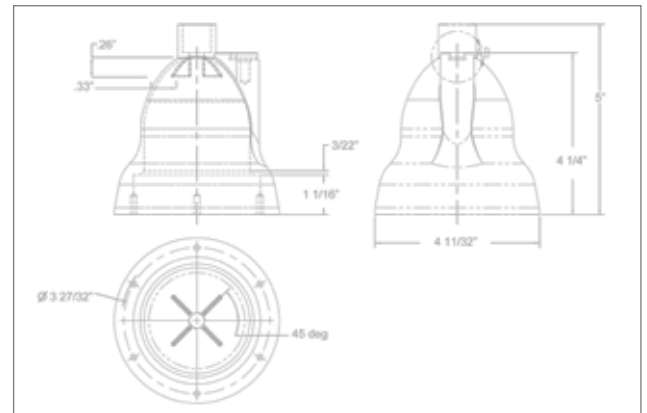

Piggyback Plug Illustration

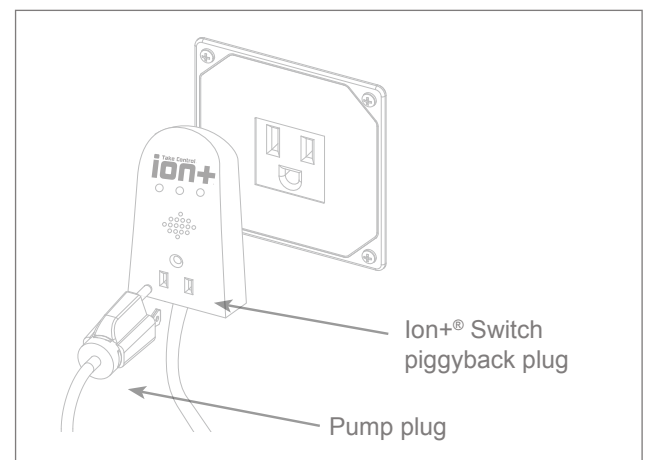

System Specifications

- Built in alarm and monitoring system
- Power, system and high water LEDs indicate system status
- Audible alarm buzzer
- Dry contact
- Remote alarm port - type RJ11
- First of a kind solid-state sensing technology with no moving parts
- Starts and stops pump via the piggyback pump power receptacle
- Multipoint sealing mechanism that supersedes single surface seals
- Inverter rated for use with most battery backup systems
- No contact points
- 3 year warranty

Take Control. **ION** Controllers



Ion Genesis®

Smart Controller and Sensors



The Ion Genesis® is a first of a kind digital pump controller that is designed to operate one or two pumps, alternating or simultaneously, with combined amp draws of 12 amps. The Ion® digital level sensors are used in place of standard float switches and allow for an adjustable on level from 2.5" to 72" in 0.5" increments. The Ion Genesis® controller incorporates smart sensing technology that utilizes critical system information such as pump amp draw, how long the pump operates, water level, and many more features.

You can collect and analyze system data never before possible with the level sensor controllers. Any change or variation in your system performance will sound an alarm or alert of possible equipment failure before flooding occurs. This new technology allows you to adjust the turn on level of your system without removing the system cover.

Patent No. 8,591,198 & 8,907,789 B2



37 Forestwood Dr., Romeoville, IL 60446 www.ionproducts.net [815] 886-9200

Ion Genesis®

Smart Controller and Sensors

Typical Installation Diagram

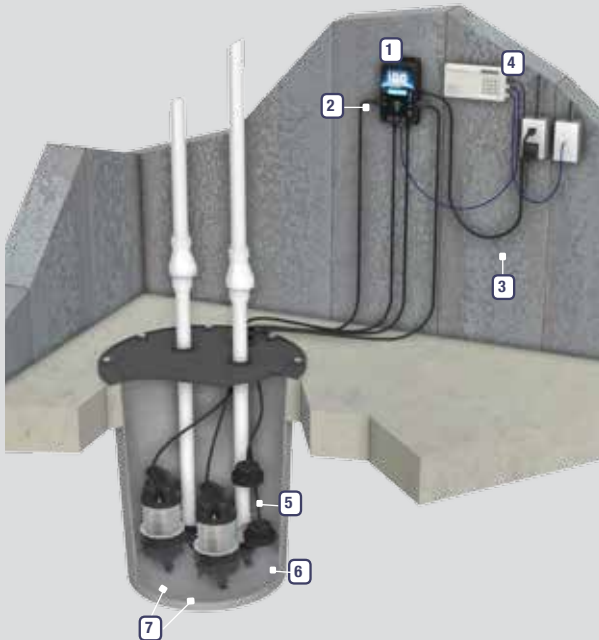

1. Ion Genesis®
2. Pump outlets
3. Power cord
4. Dialer (optional)
5. High water sensor
6. Digital level sensor
7. Pumps (optional)

System Features



1. LED Lights: Indicate when the pump or pumps are running, system power, and alarm mode.
2. LCD Screen: Displays vital equipment data and alarm notifications.
3. Plug & Play Outlets: Pump(s) plug directly into controller just as they would a wall outlet.
4. Ion® Digital Level Sensor: Communicates system levels to the Ion Genesis® controller.
5. Ion® Digital High Water Sensor: Detects high water and also acts as a secondary switch in case the primary Ion® sensor fails.
6. Remote Alarm Contact: Connects to optional dialer or existing security system for remote monitoring when you're away.
7. Reset/Test Button: Allows user to manually test system without having to access basin.
8. On Level: Manually adjust the pumping turn on level from 2.5" to 72" in 0.5" increments.

System Specifications

- Featuring Ion® digital level sensors
 - First of its kind solid-state sensing technology with no moving parts
 - Multipoint sealing mechanism that supersedes single surface seals
 - Rated at 2 million cycles, it will last 4 times longer than a standard pump switch
- Voltage: 120 VAC, 60 Hz
- Output Capacity (per outlet): ½ HP, 12 FLA, 15 amp max, 72 LRA
- Remote Alarm Contacts: Normally closed (open during alarm state) 30 V/DC @ 1 amp max
- Temperature Range: 32° F to 104° F (0° C to 40° C)
- Audible Alarm: 80 dB @ 10 ft.
- Enclosure: NEMA-1 UL94V-0 ABS
- Mounting Hardware (controller): (4) #10 Screws (not included)
- Mounting Dimensions (controller): 8.25" X 3.5"
- 3 year warranty

Take Control.
ION
Controllers

Now available
with optional
factory installed
Ethernet Module.



ION® Endeavor

Smart Controller and Sensors



- Three model options
- First of a kind 115 or 230 volt standard plug in receptacle, dual pump run and alternating controller for residential and commercial applications
- Ion® sensors communicate with controller to provide controller based turn on level adjustment from 2.5" to 72" for optimal pump operation
- Track critical information through the panel based display, including switch failure, pump amp draw, water level, and more
- Wide range of communication options available

Patent No. 8,591,198 & 8,907,789 B2



37 Forestwood Dr., Romeoville, IL 60446 www.ionproducts.net [815] 886-9200

Ion® Endeavor

Smart Controller and Sensors

Typical Installation Diagram

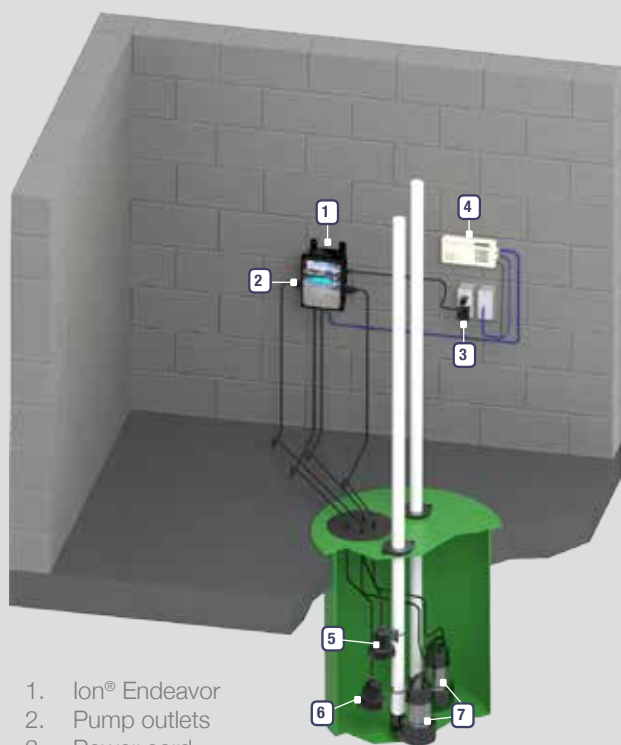

1. Ion® Endeavor
2. Pump outlets
3. Power cord
4. Dialer (optional)
5. High water sensor
6. Digital level sensor
7. Pumps (optional)

Controller Options

	Endeavor Power Plug Configuration	Dedicated Supporting Wall Receptacle Needed
Model 100-15 operates two (2) 120 VAC, single-phase pumps, up to 12 amps total	 115 V, 15 A	 115 V, 15 A
Model 100-20 operates two (2) 120 VAC, single-phase pumps, up to 16 amps total	 115 V, 20 A	 115 V, 20 A
Model 200-15 operates two (2) 208-240 VAC single-phase pumps, up to 12 amps total	 230 V, 15 A	 230 V, 15 A

System Specifications

- Featuring Ion® digital level sensors
 - First of its kind solid-state sensing technology with no moving parts
 - Multipoint sealing mechanism that supersedes single surface seals
 - Rated at 2 million cycles, it will last 4 times longer than a standard pump switch
- Simultaneously operates two (2) single-phase plug in pumps together when required
- Automatic pump alternation based on duty cycle and/or pump availability
- Clean & safe operation
- Microprocessor based process controls continually monitor system
- Dry digital contact for common alarm, allows remote monitoring
- Metropolitan's variety of optional com-devices allow many communications possibilities:
 - Ethernet Module: system status via web page and email or text message alerts
 - Ion Gateway®: Cellular based unit sends email or text message alerts
 - Telephone Dialer: Phone line unit sends voice message alerts
- 3 year warranty

Take Control. ion Gateway



*Tablet & cell phone not included

A Way To Look In When You're Out.™

Protect your home from potential disasters with the Ion Gateway® Monitoring and Alarm System

Take Control®

Ion Gateway® makes it easy to take control of home monitoring such as power loss, temperature, water presence, open/closed doors and windows.

Easy Set-Up

Installing our wireless system is easy with no alterations to existing structures required.

Low Cost

There are no monitoring fees or installation fees and our data plans start at \$6 a month.

Customized Monitoring

With unlimited sensor possibilities, the freedom to choose the level of monitoring is yours.

Peace Of Mind

Our wireless system is battery operated. No need to worry about losing contact during a power outage.

No wires, No worries

100% wireless. No landline required. Connect to the Ion Gateway® monitoring grid with cellular technology.



37 Forestwood Dr., Romeoville, IL 60446 www.ionproducts.net [815] 886-9200

Ion Gateway®

Alarm & Monitoring System

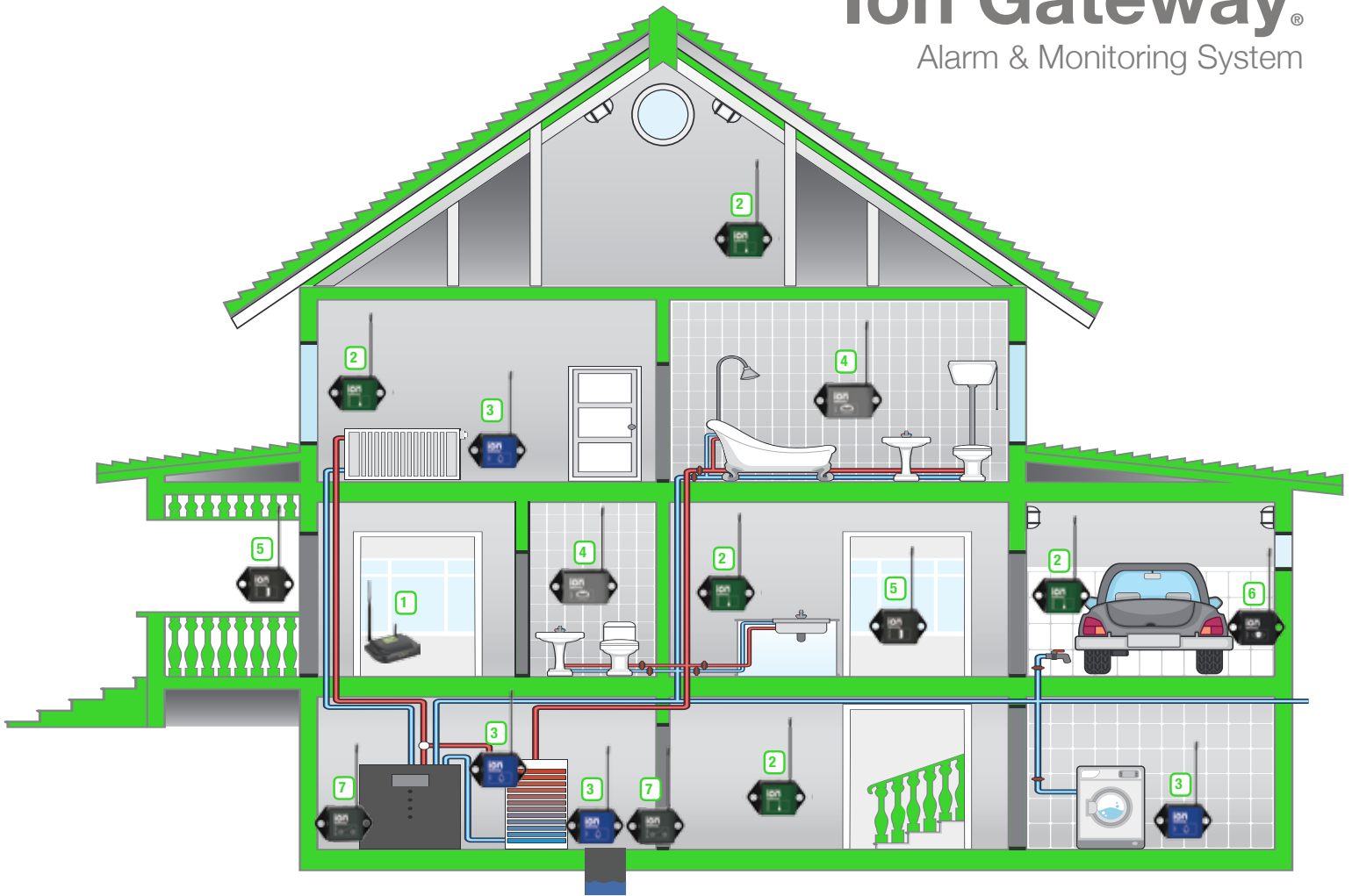

Wireless Sensor Network Typical Installation

The Ion Gateway® Wireless Sensor Network detects incidents you wish to monitor such as power loss, temperature, and high water. Utilizing a web based configuration, alarms are sent direct to your email and text to your cell phone.

1. Ion Gateway® base unit wirelessly communicates with all sensors in the house.*
2. Temperature sensor throughout the house to ensure proper temperature regulation
3. Water sensor next to household products to detect possible water leakage/overflow
4. Button sensor in bathrooms for alerting the need for help/assistance
5. Open/Close sensor on doors and windows
6. Motion sensor in garages & lesser used entryways
7. Dry Contact sensor for use with water heaters and sump pits

Wireless Sensor Features

- Completely wireless for easy installation
 - Small profile
 - Configuration is web based, allowing you to change the user-defined settings from anywhere with internet access
 - Cellular based communications (check for coverage in your area)
 - FCC & IC Certified
 - Base unit is equipped with battery backup, so no need to worry if the power goes out
 - Sensors come with a lithium battery for long life
 - Sensor range to the base unit is 250 - 300 ft*
- *Actual range may vary depending on environment. Further range attainable through an Ion Gateway® Signal Repeater.

Optional Sensors

- Dry Contact
- Open/Close
- Motion
- Button
- Temperature
- Water
- Other sensors available on request



actual size

Take Control. **ION** Packages

Now available
with optional
factory installed
Ethernet Module.



Ion® Endeavor WC33



All parts included to install a smart controller with sensors & pump

- First of a kind 115 volt standard plug in receptacle, dual pump run and alternating controller for residential and commercial applications
- Ion® sensors communicate with controller to provide controller based turn on level adjustment from 2.5" to 72" for optimal pump operation
- Track critical information through the panel based display, including switch failure, pump amp draw, water level and more
- Wide range of communication options available



37 Forestwood Dr., Romeoville, IL 60446 www.ionproducts.net [815] 886-9200

Patents Pending, Patent No. 8,591,198

Ion® Endeavor WC33

System Specifications

- Typical Applications
- Basement sump
 - Dewatering
 - Septic tank effluent

Maximum Capacity Up to 45 GPM

Maximum Head Up to 24'

Electrical Data 115 V, 1 Ø, 4 FLA, 60 Hz

Motor Data 1/3 HP, 3450 RPM

Recommended Minimum Basin Size 18" x 24"

Manual Operation M: Manual

Materials of Construction Cast iron & engineered thermoplastic

Power Cord 10' Standard

Discharge 1 1/2" NPT

Solids 1/2"

WC33 Sump Pump Dimensions

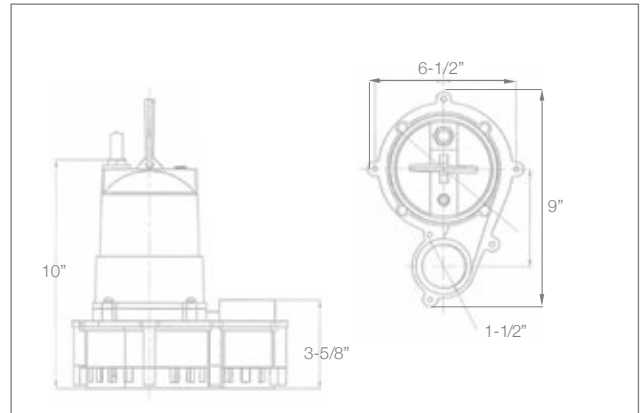

WC33 Sump Pump Performance

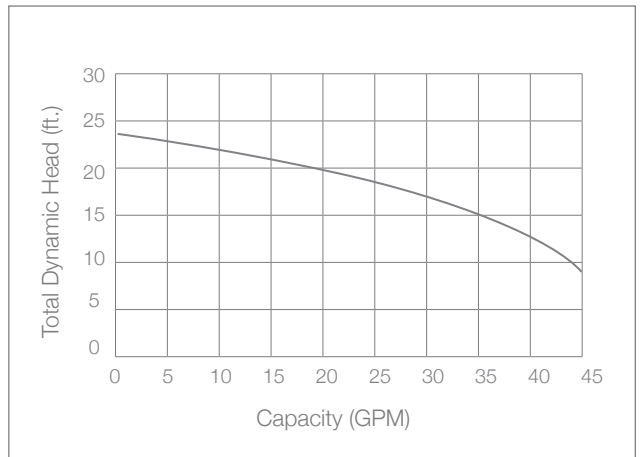

Features

- Carbon ceramic mechanical seal
- Oil-filled high efficiency PSC motor that uses half the AC power of most 1/3 HP pumps
- Ion® digital level control sensor has no moving parts (standard)
- Size allows 2 pumps in 18" basin
- 3 year warranty

Take Control. **ION** Packages

Now available
with optional
factory installed
Ethernet Module.



Ion® Endeavor BA33

All parts included to install a smart controller with sensors & pump



- First of a kind 115 volt standard plug in receptacle, dual pump run and alternating controller for residential and commercial applications
- Ion® sensors communicate with controller to provide controller based turn on level adjustment from 2.5" to 72" for optimal pump operation
- Track critical information through the panel based display, including switch failure, pump amp draw, water level and more
- Wide range of communication options available



37 Forestwood Dr., Romeoville, IL 60446 www.ionproducts.net [815] 886-9200

Patents Pending, Patent No. 8,591,198

Ion® Endeavor BA33

System Specifications

Typical Applications	<ul style="list-style-type: none">• Basement sump• Dewatering
Maximum Capacity	Up to 68 GPM
Maximum Head	Up to 25'
Electrical Data	115 V, 1 Ø, 4.5 FLA, 60 Hz
Motor Data	1/3 HP, 3450 RPM
Recommended Minimum Basin Size	18" x 24"
Manual Operation	M: Manual
Materials of Construction	Cast iron & stainless steel
Impeller	Thermoplastic vortex
Power Cord	10' Standard
Discharge Size	1½" NPT
Solids Handling	½"

BA33 Sump Pump Dimensions

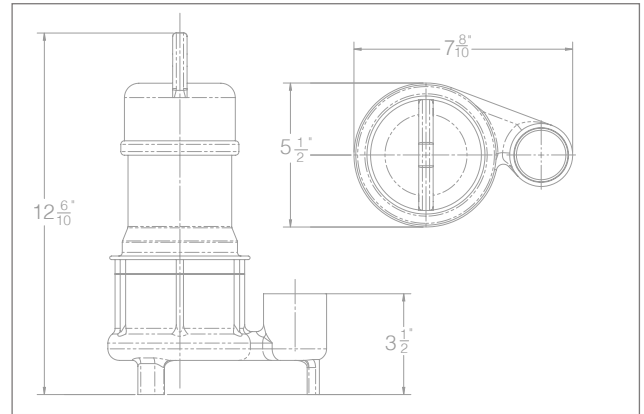

BA33 Sump Pump Performance

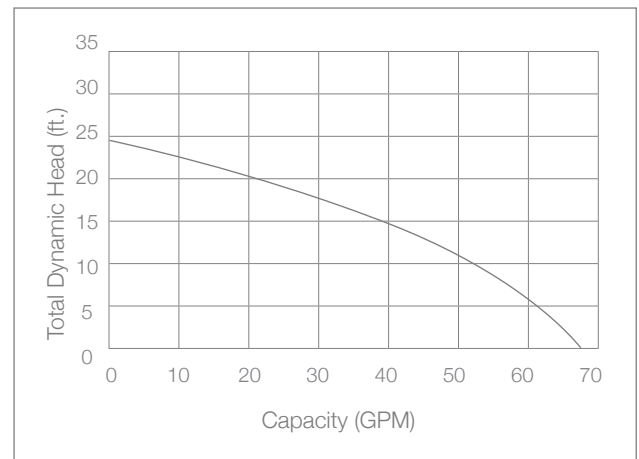

Features

- Energy efficient motor
- Carbon ceramic mechanical seal
- Thermal overload protection
- Ion® digital level control sensor has no moving parts (standard)
- Stainless steel screen prevents debris from entering the pump
- 3 year warranty

Take Control. **ION** Packages

Now available
with optional
factory installed
Ethernet Module.



Ion® Endeavor BA50

All parts included to install a smart controller with sensors & pump



- First of a kind 115 volt standard plug in receptacle, dual pump run and alternating controller for residential and commercial applications
- Ion® sensors communicate with controller to provide controller based turn on level adjustment from 2.5" to 72" for optimal pump operation
- Track critical information through the panel based display, including switch failure, pump amp draw, water level and more
- Wide range of communication options available



37 Forestwood Dr., Romeoville, IL 60446 www.ionproducts.net [815] 886-9200

Patents Pending, Patent No. 8,591,198

Ion® Endeavor BA50

System Specifications

Typical Applications	<ul style="list-style-type: none">• Basement sump• Dewatering
Maximum Capacity	Up to 78 GPM
Maximum Head	Up to 29'
Electrical Data	115 V, 1 Ø, 5.8 FLA, 60 Hz
Motor Data	½ HP, 3450 RPM
Recommended Minimum Basin Size	18" x 24"
Manual Operation	M: Manual
Materials of Construction	Cast iron & stainless steel
Impeller	Cast iron vortex
Power Cord	10' Standard (20' optional)
Discharge Size	2" NPT
Solids Handling	½"

BA50 Sump Pump Dimensions

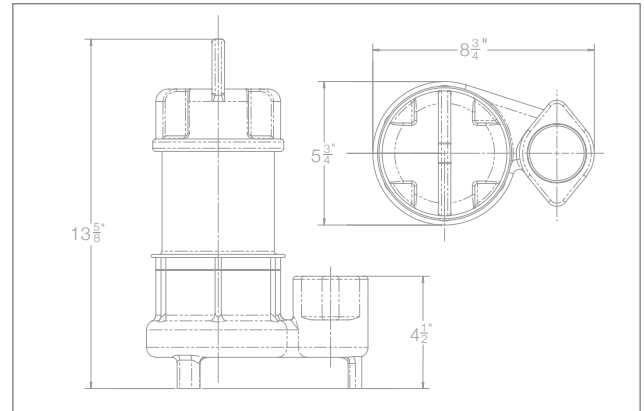

BA50 Sump Pump Performance

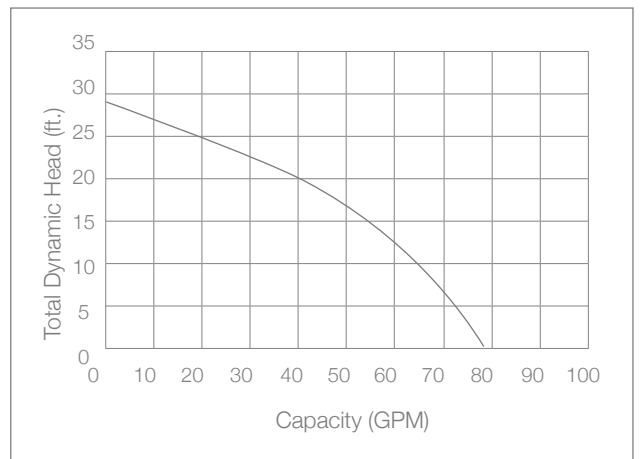

Features

- Energy efficient motor
- Carbon ceramic mechanical seal
- Thermal overload protection
- Ion® digital level control sensor has no moving parts (standard)
- Stainless steel screen prevents debris from entering the pump
- 3 year warranty

Take Control.
ION
Systems



StormPro[®] 2100DC

Battery Backup System

- High quality DC pump capable of pumping over 2,100 gallons per hour
- Heavy duty adjustable vertical float switch for maximum reliability
- High output 8 amp charger unit with 5 charging stages
- Safe for use with AGM maintenance free batteries
- Built-in audible alarm and indicator lights for added protection
- Pump base keeps the pump off the bottom of the basin to avoid clogging from debris
- UL listings ensure reliability



37 Forestwood Dr., Romeoville, IL 60446 www.ionproducts.net [815] 886-9200

StormPro® 2100DC

Battery Backup System

Typical Installation Diagram

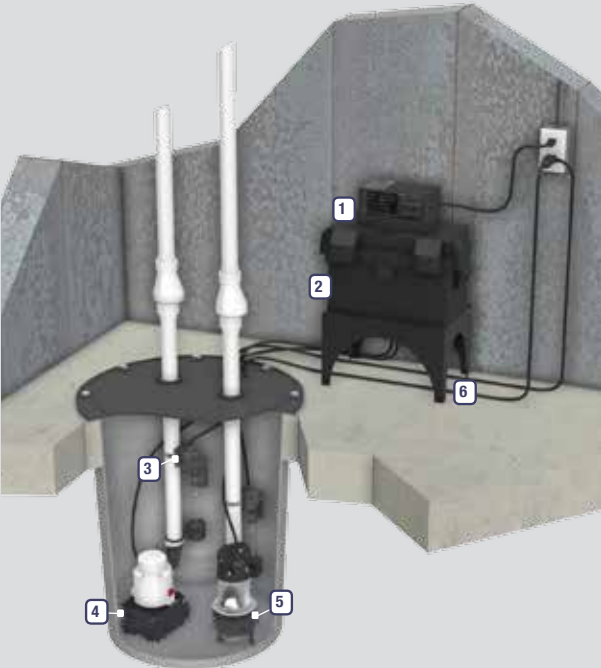

1. 8 amp charger unit
2. Battery box
3. Backup switch
4. 12 volt backup pump
5. Primary sump pump (not included)
6. Stand (optional)

System Performance

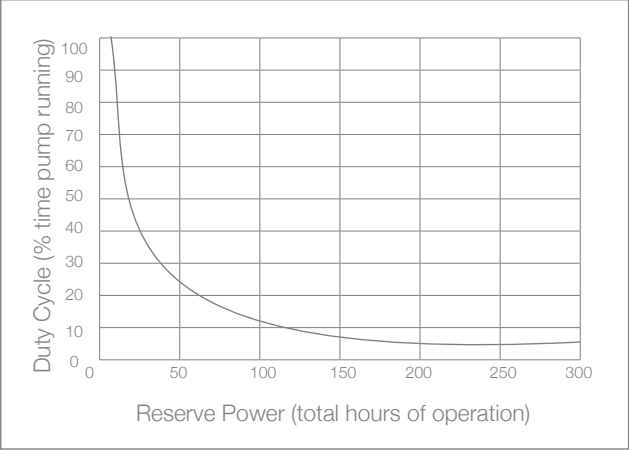

System Specifications

- Includes
- 12 volt DC pump
 - Pump base
 - Battery box
 - Heavy duty float switch
 - 8 amp charger with built-in audible alarm and status lights

Input Voltage	AC
Output Voltage	DC
Pump Type	12 volt DC submersible
Capacity	35 GPM / 2,100 GPH @ 10'
Installation	Floor mount
Options	Stand, battery add-on kit
Warranty	3 years

Take Control.
ION
Systems



JSPII

JSPII & JSPIII

Preassembled Sump & Battery Backup Systems

- All-in-one system with primary and backup pump
- Comes completely assembled with pumps and valves pre-plumbed
- Simply drop into your existing basin and make one discharge connection
- 3 year warranty
- JSPIII available with the BA33i



JSPII & JSPIII

Preassembled Sump & Battery Backup System

JSPII Primary Pump Specifications

Typical Applications	<ul style="list-style-type: none"> • Residential sump • Dewatering
Maximum Capacity	Up to 45 GPM
Maximum Head	Up to 24'
Electrical Data	115 V, 1 Ø, 4 FLA, 60 Hz
Motor Data	1/3 HP, PSC, high efficiency motor with thermal overload protection, 3450 RPM
Recommended Minimum Basin Size	18" x 24"
Automatic Operation	i: Ion Digital Level Control
Materials of Construction	Cast iron and engineered thermoplastic
Impeller	Thermoplastic vortex
Power Cord	10' Standard
Discharge	1½" NPT
Solids Handling	½"

Typical Installation Diagram

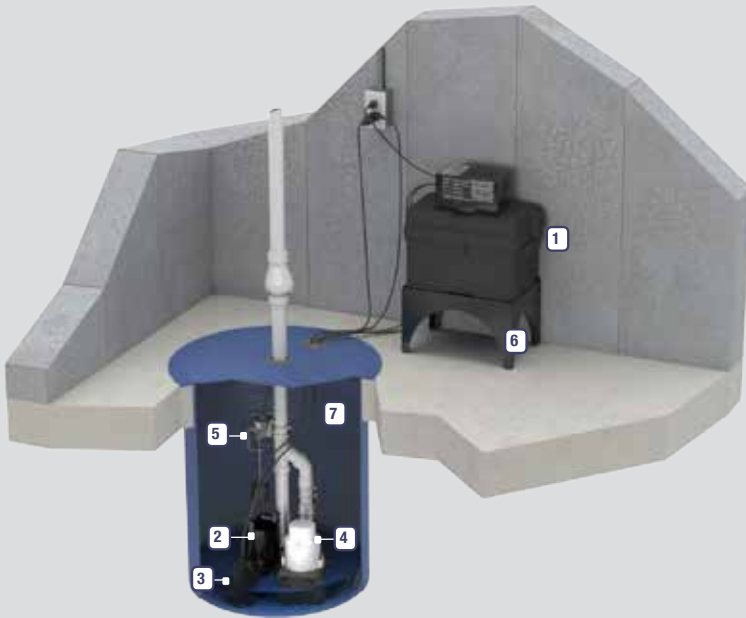

1. Battery box with DC charger
2. 1/3 HP primary pump
3. Ion® digital level control switch
4. Backup pump
5. Backup vertical switch
6. Stand (optional)
7. Recommended minimum basin size: 18" x 24" (not included)

Primary Pump Performances

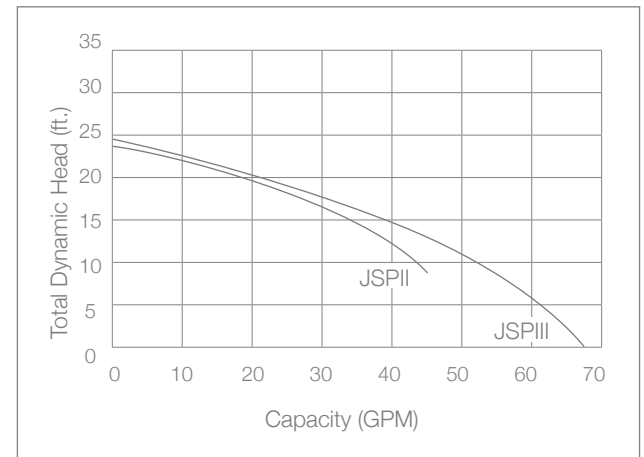

Battery Backup System Features

- Primary pump with high efficiency oil filled motor that uses half the power of most 1/3 HP pumps
- Piggyback Ion digital level control primary switch with no moving parts
- High quality 2100DC battery backup pump rated for 2,100 GPH
- Backup pump base keeps the pump off the bottom of the basin to avoid clogging from debris
- Heavy duty adjustable vertical backup float switch for maximum reliability
- Solid state 8 amp charger unit with 5 charging stages automatically switches to DC mode when power is out
- Built-in audible alarm and indicator lights on charger for added protection
- Uses one 12 volt deep cycle AGM battery (battery is NOT included)
- 1½" Sch. 40 PVC piping
- Check valve on each pump and a combination valve on the main discharge
- 3 year warranty

Revised: 08.10.16 09:36

Take Control.
ION
Systems

Can be used with
the Ion Gateway.
See page 10 for
more information.



MPPII

Power Pac System

- (2) 1/3 HP pumps with PSC motor
- Recommended minimum basin size: 18 x 24"
- Includes Ion Genesis® controller, 1 1/2" check valve and 1 1/2" Sch. 40 PVC piping
- Every cycle alternates to the other pump
- Low amp draw pumps 4 amps
- Each pump rated up to 2700 GPH
- Factory built; easy and quick to install
- Built-in alarm system
- 3 year warranty



37 Forestwood Dr., Romeoville, IL 60446 www.ionproducts.net [815] 886-9200

System Specifications

- Typical Applications
- Basement sump
 - Dewatering
 - Septic tank effluent

Maximum Capacity Up to 45 GPM

Maximum Head Up to 24'

Electrical Data 115 V, 1 Ø, 4 FLA, 60 Hz

Motor Data 1/3 HP, 3450 RPM

Recommended Minimum Basin Size 18" x 24"

Manual Operation M: Manual

Materials of Construction Cast iron & engineered thermoplastic

Power Cord 10' Standard

Discharge 1 1/2" NPT

Solids 1/2"

WC33 Sump Pump Dimensions

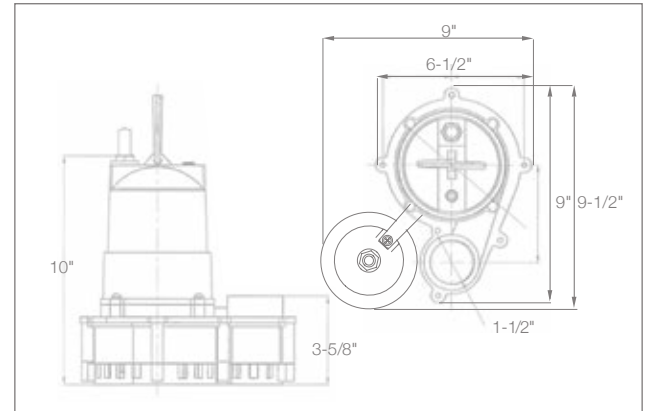

WC33 Sump Pump Performance

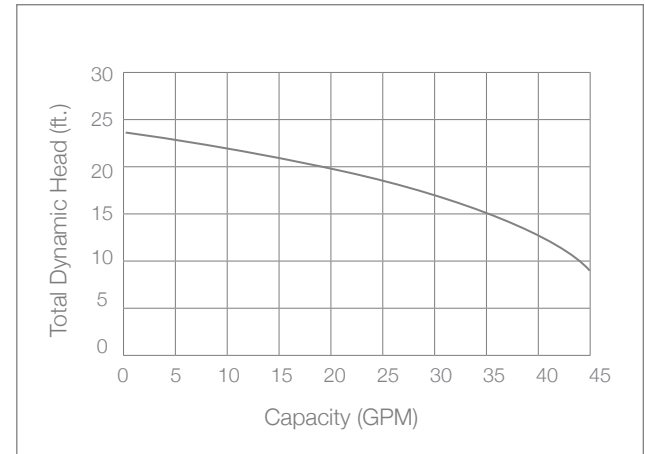

Features

- Carbon ceramic mechanical seal
- Oil-filled high efficiency PSC motor that uses half the AC power of most 1/3 HP pumps
- Ion® digital level control sensors have no moving parts (standard)
- 3 year warranty

Take Control.
ION
Systems

Can be used with
the Ion Gateway.
See page 10 for
more information.



MPPIII

Power Pac System For Sumps

- (2) 1/3 HP pumps with PSC motor
- Recommended minimum basin size: 18 x 24"
- Includes Ion Genesis® controller, 1 1/2" check valve and 1 1/2" Sch. 40 PVC piping
- Every cycle alternates to the other pump
- Low amp draw pumps 4.5 amps
- Each pump rated up to 3180 GPH
- Factory built; easy and quick to install
- Built-in alarm system
- 3 year warranty



37 Forestwood Dr., Romeoville, IL 60446 www.ionproducts.net (815) 886-9200

MPPIII

BA33 Sump Pumps

System Specifications

Typical Applications	<ul style="list-style-type: none">• Basement sump• Dewatering
Maximum Capacity	Up to 68 GPM
Maximum Head	Up to 25'
Electrical Data	115 V, 1 Ø, 4.5 FLA, 60 Hz
Motor Data	1/3 HP, 3450 RPM
Recommended Minimum Basin Size	18" x 24"
Materials of Construction	Cast iron & stainless steel
Impeller	Thermoplastic vortex
Power Cord	10' Standard
Discharge Size	1 1/2" NPT
Solids Handling	1/2"

Pump Dimensions

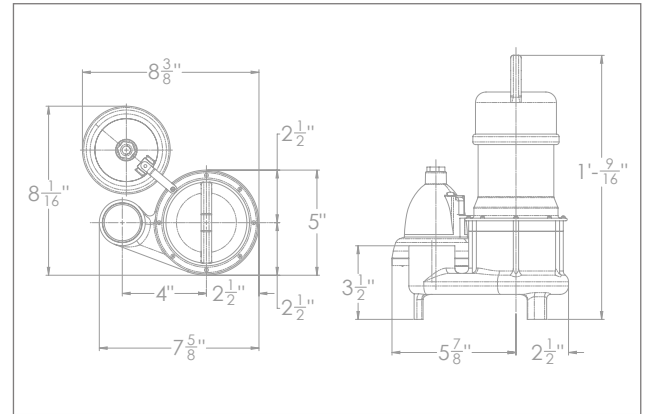

Pump Performance

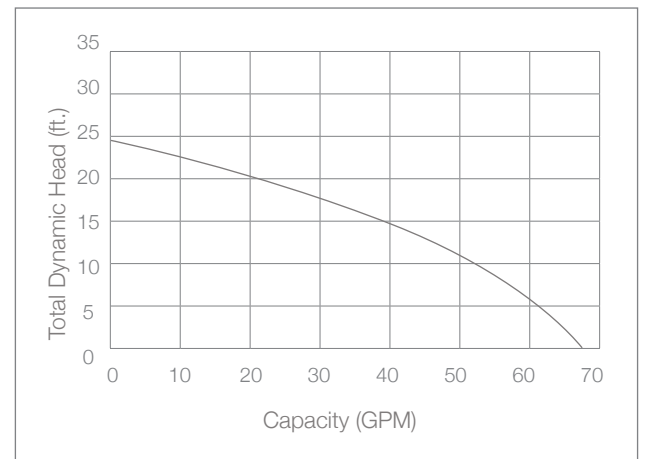

Features

- Thermal overload protection
- Energy efficient motor
- Carbon ceramic mechanical seal
- Stainless steel screen prevents debris from entering the pump
- 3 year warranty

Take Control.
ION
Systems

Can be used with
the Ion Gateway.
See page 10 for
more information.



30ACi+

Battery Backup System

- Fully automatic auxiliary power source
- Backup system runs on AC or DC power
- Runs the same 1/3 HP pump in AC or DC mode
- Ion+® digital level control sensor with integrated alarms



30ACi+

Battery Backup System

Typical Installation Diagram

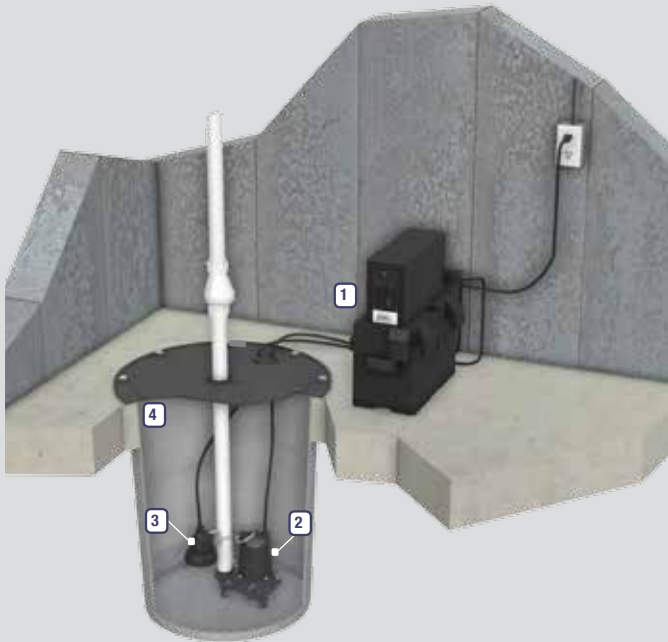

1. Battery box with inverter
2. 1/3 HP Ion[®] StormPro[®] WC33 sump pump
3. Ion+[®] digital level control/alarm sensor
4. Recommended minimum basin size: 18" x 24" (not included)

System Performance

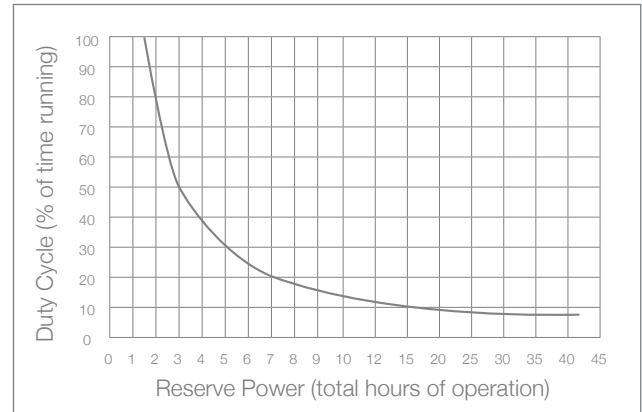

Pump Performance

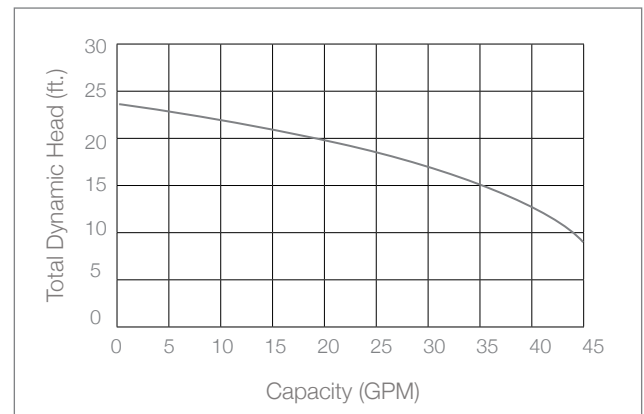

System Specifications

- 1/3 HP pump with PSC, energy efficient motor: 4.0 amps
- Up to 45 GPM
- Fully automatic, converts 12 volt DC to 120 volt AC when utility power is lost
- Runs 1/3 HP pump on AC or DC power
- Inverter has digital display, tells status of system at all times
- Requires one 12 volt deep cycle AGM battery (battery is NOT included)
- Non-corrosive battery enclosure
- Includes piggyback Ion+[®] digital level control/alarm sensor with no moving parts
 - Built-in alarm and monitoring system with Power, System and High Water LEDs and audible alarm
 - Dry contacts to connect to a monitoring device via an RJ11 connection
 - Rated at 2 million cycles, it will last 4 times longer than a standard pump switch
- Quick and easy installation
- 3 year warranty

Take Control.
ION
Systems

Can be used with
the Ion Gateway.
See page 10 for
more information.



30ACi Deluxe

Battery Backup System

- Fully automatic auxiliary power source
- Backup system runs on AC or DC power
- Runs the same 1/3 HP pump with power on or off
- Ion Genesis® controller monitors all pump activity
- Full digital display on inverter and controller
- Ion® digital level sensors have no moving parts



37 Forestwood Dr., Romeoville, IL 60446 www.ionproducts.net [815] 886-9200

Patents Pending, Patent No. 8,591,198

30ACi Deluxe

Battery Backup System

Typical Installation Diagram

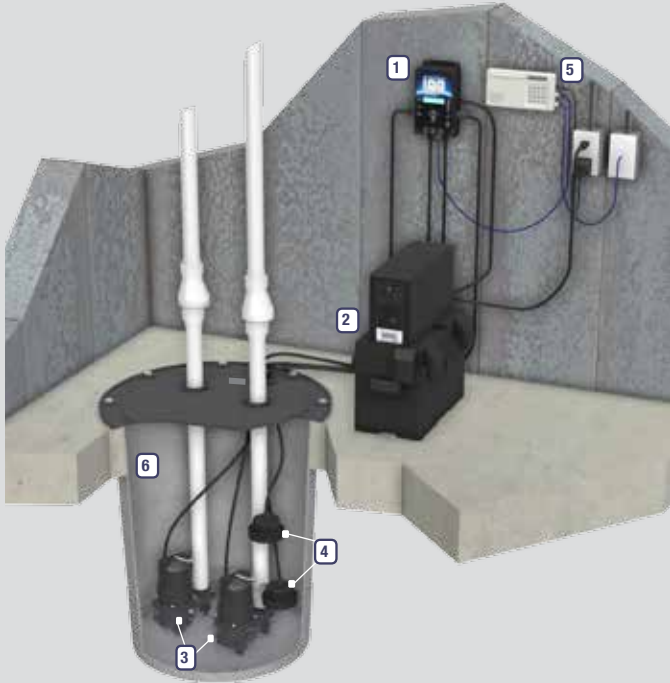

1. Ion Genesis® controller
2. Battery box with inverter
3. 1/3 HP Ion® StormPro® WC33 sump pump
4. Ion® digital level control sensors
5. Phone dialer (optional)
6. Recommended minimum basin size: 18" x 24" (not included)

System Performance

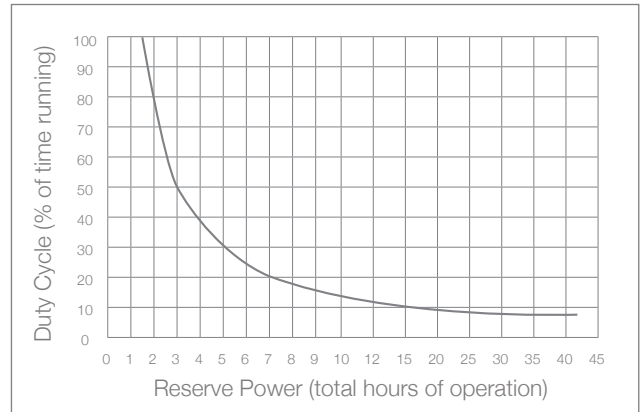

Pump Performance

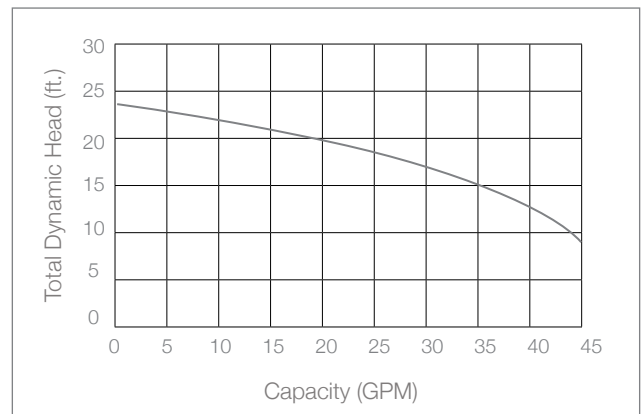

System Specifications

- 1/3 HP pump with PSC, energy efficient motor: 4.0 amps
- Up to 45 GPM
- Fully automatic, converts 12 volt DC to 120 volt AC when power is off
- Ion Genesis® controller alternates each pump and alarms
- Runs 1/3 HP pump on AC or DC power
- Inverter has digital display, tells status of system at all times
- Uses one 12 volt deep cycle AGM battery (battery is NOT included)
- Non-corrosive battery enclosure
- Includes piggyback Ion® digital level control sensors with no moving parts
 - First of its kind solid-state sensing technology with no moving parts
 - Multipoint sealing mechanism that supersedes single surface seals
 - Rated at 2 million cycles, it will last 4 times longer than a standard pump switch
- Quick and easy installation
- 3 year warranty

Take Control.
ION
Systems

Can be used with
the Ion Gateway.
See page 10 for
more information.



35ACi+

Battery Backup System

- Fully automatic auxiliary power source
- Backup system runs on AC or DC power
- Runs the same 1/3 HP pump in AC or DC mode
- Ion+® digital level control sensor with integrated alarms



37 Forestwood Dr., Romeoville, IL 60446 www.ionproducts.net [815] 886-9200

Patent No. 8,591,198

35ACi+

Battery Backup System

Typical Installation Diagram

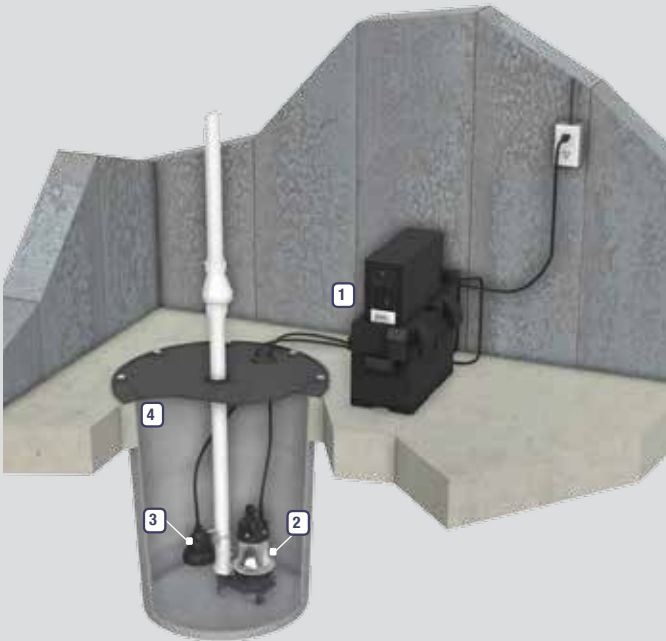

1. Battery box with inverter
2. Ion[®] StormPro[®] sump pump
3. Ion+[®] digital level control/alarm sensor
4. Recommended minimum basin size: 18" x 24" (not included)

System Performance

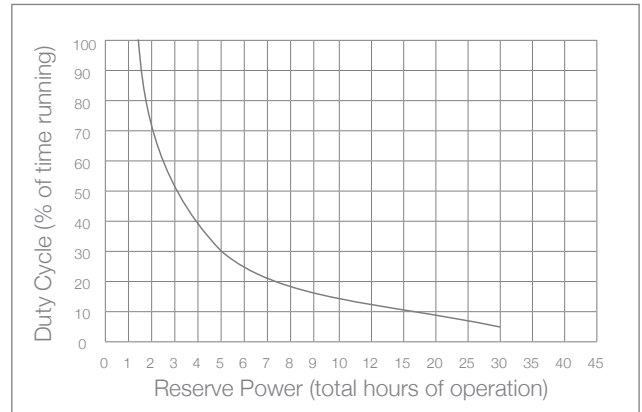

Pump Performance

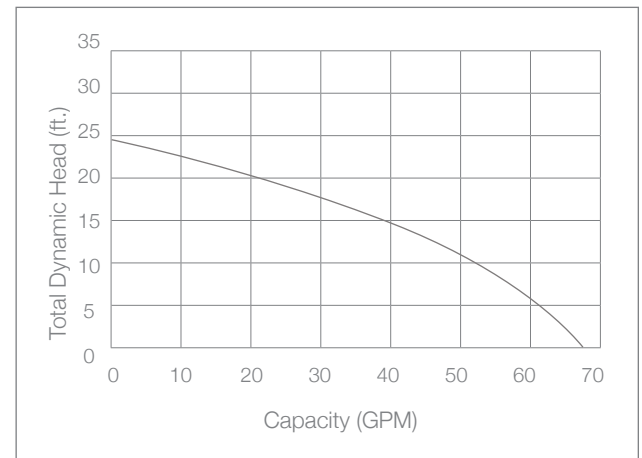

System Specifications

- 1/3 HP pump with PSC, energy efficient motor: 4.5 amps
- Up to 68 GPM
- Fully automatic, converts 12 volt DC to 120 volt AC when utility power is lost
- Runs 1/3 HP pump on AC or DC power
- Inverter has digital display, tells status of system at all times
- Requires one 12 volt deep cycle AGM battery (battery NOT included)
- Non-corrosive battery enclosure
- Includes piggyback Ion+[®] digital level control/alarm sensor with no moving parts
 - Built-in alarm and monitoring system with Power, System and High Water LEDs and audible alarm
 - Dry contacts to connect to a monitoring device via an RJ11 connection
 - Rated at 2 million cycles, it will last 4 times longer than a standard pump switch
- Quick and easy installation
- 3 year warranty

Take Control.
ION
Systems

Can be used with
the Ion Gateway.
See page 10 for
more information.



35ACi Deluxe

Battery Backup System

- Fully automatic auxiliary power source
- Backup system runs on AC or DC power
- Runs the same 1/3 HP pump with power on or off
- Ion Genesis® controller monitors all pump activity
- Full digital display
- Ion® digital level sensors have no moving parts



37 Forestwood Dr., Romeoville, IL 60446 www.ionproducts.net [815] 886-9200

Patents Pending, Patent No. 8,591,198

35ACi Deluxe

Battery Backup System

Typical Installation Diagram

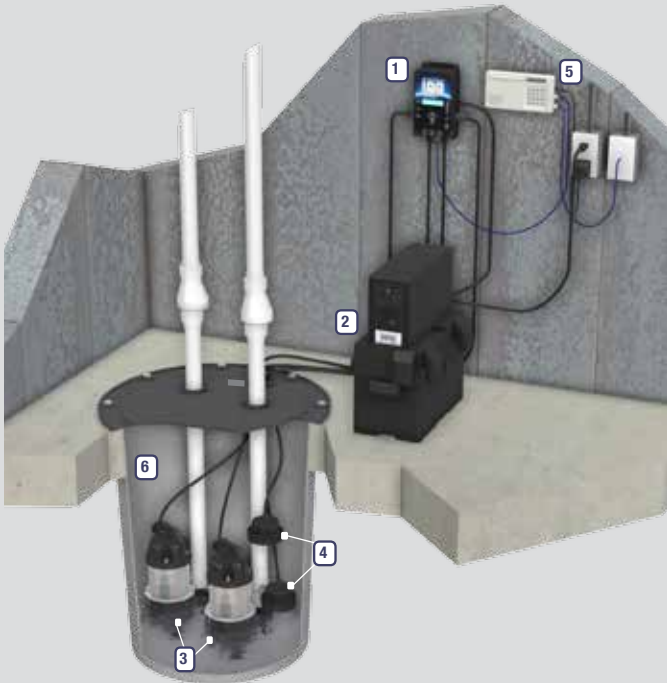

1. Ion Genesis® controller
2. Battery box with inverter
3. Ion® StormPro® sump pumps
4. Ion® digital level control sensors
5. Phone dialer (optional)
6. Recommended minimum basin size:
18" x 24" (not included)

System Performance

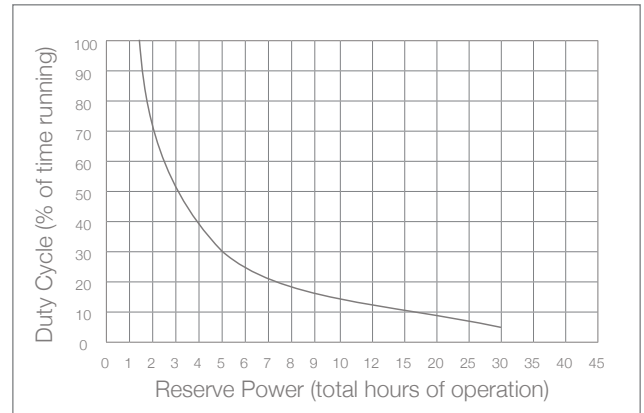

Pump Performance

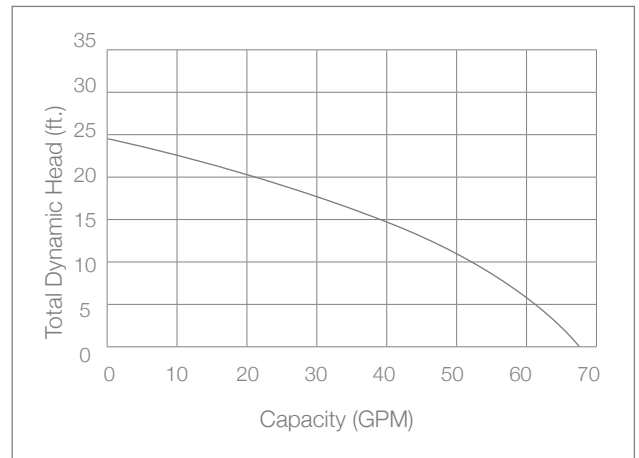

System Specifications

- 1/3 HP pump with PSC, energy efficient motor: 4.5 amps
- Up to 68 GPM
- Fully automatic, converts 12 volt DC to 120 volt AC when power is off
- Runs 1/3 HP pump on AC or DC power
- Inverter has digital display, tells status of system at all times
- Uses one 12 volt deep cycle AGM battery (battery NOT included)
- Non-corrosive battery enclosure
- Includes piggyback Ion® digital level control switch with no moving parts
- Quick and easy installation
- 3 year warranty

Take Control.
ION
Systems

Can be used with
the Ion Gateway.
See page 10 for
more information.



55ACi+

Battery Backup System

- Fully automatic auxiliary power source
- Backup system runs on AC or DC power
- Runs the same ½ HP pump in AC or DC mode
- Ion+® digital level control sensor with integrated alarms



55ACi+

Battery Backup System

Typical Installation Diagram

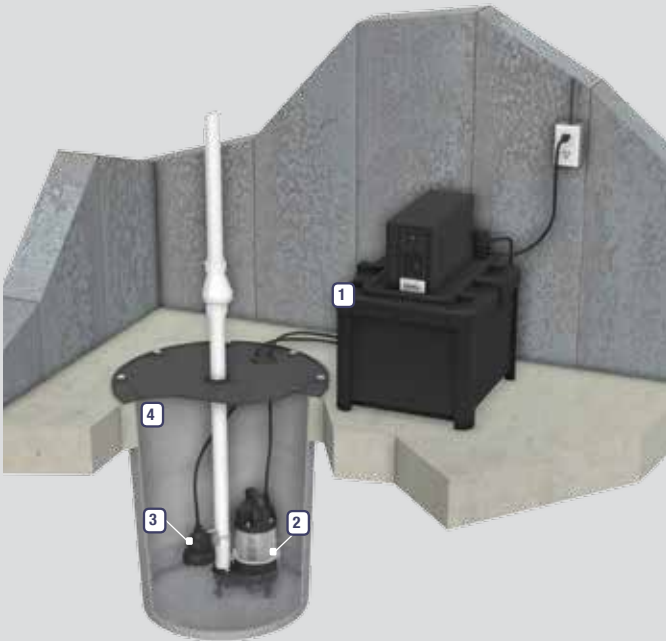

1. Battery box with inverter
2. Ion[®] StormPro[®] sump pump
3. Ion+[®] digital level control/alarm sensor
4. Recommended minimum basin size:
18" x 24" (not included)

System Performance

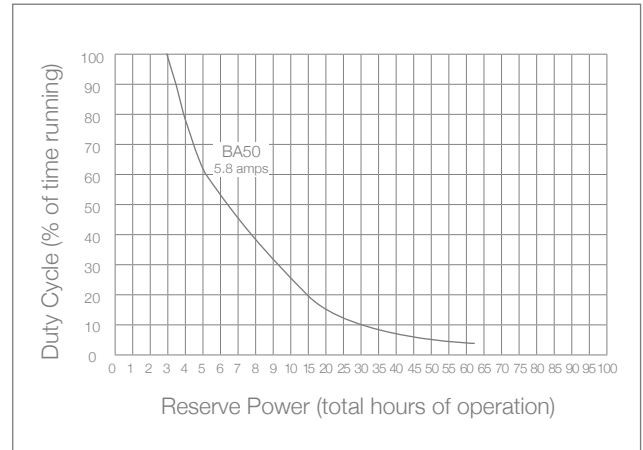

Pump Performance

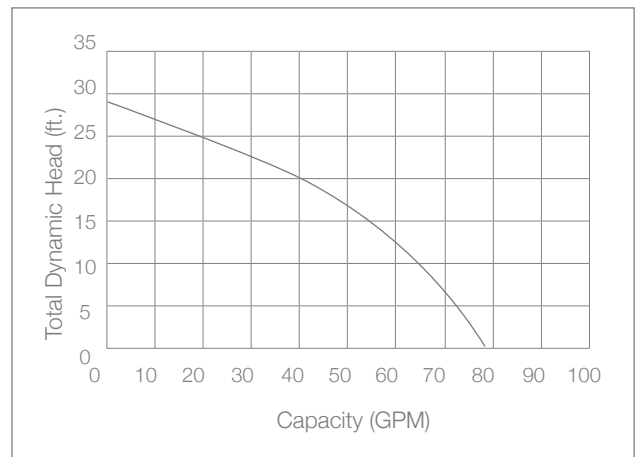

System Specifications

- ½ HP pump with PSC, energy efficient motor: 5.8 amps
- Up to 78 GPM
- Fully automatic, converts 24 volt DC to 120 volt AC when utility power is lost
- Runs ½ HP pump on AC or DC power
- Inverter has digital display, tells status of system at all times
- Requires two 12 volt deep cycle AGM batteries (batteries are NOT included)
- Non-corrosive battery enclosure
- Includes piggyback Ion+[®] digital level control/alarm sensor with no moving parts
 - Built-in alarm and monitoring system with Power, System and High Water LEDs and audible alarm
 - Dry contacts to connect to a monitoring device via an RJ11 connection
 - Rated at 2 million cycles, it will last 4 times longer than a standard pump switch
- Quick and easy installation
- 3 year warranty

Take Control.
ION
Systems

Can be used with
the Ion Gateway.
See page 10 for
more information.



55ACi Deluxe

Battery Backup System

- Fully automatic auxiliary power source
- Backup system runs on AC or DC power
- Runs the same pump with power on or off
- Ion Genesis® controller monitors all pump activity
- Full digital display
- Ion® digital level sensors have no moving parts



37 Forestwood Dr., Romeoville, IL 60446 www.ionproducts.net [815] 886-9200

Patents Pending, Patent No. 8,591,198

55ACi Deluxe

Battery Backup System

Typical Installation Diagram

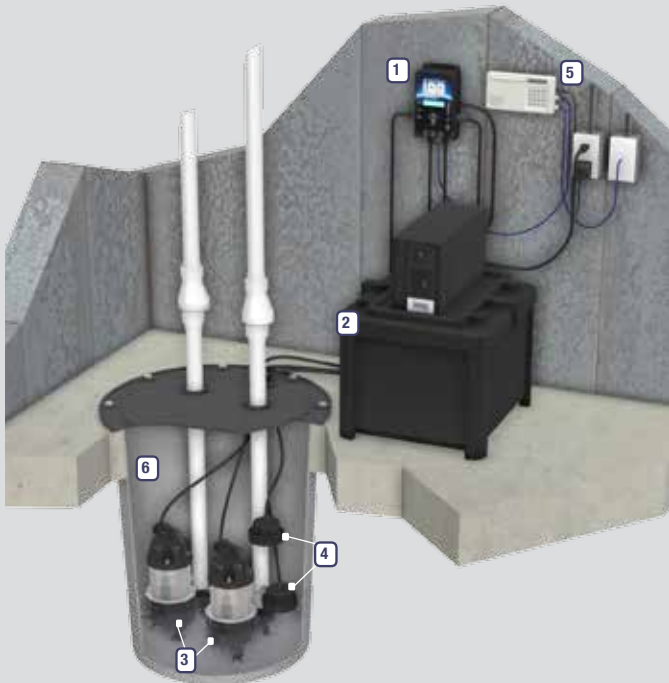

1. Ion Genesis® controller
2. Battery box with inverter
3. Ion® StormPro® sump pumps
4. Ion® digital level control sensors
5. Phone dialer (optional)
6. Recommended minimum basin size:
18" x 24" (not included)

System Performance

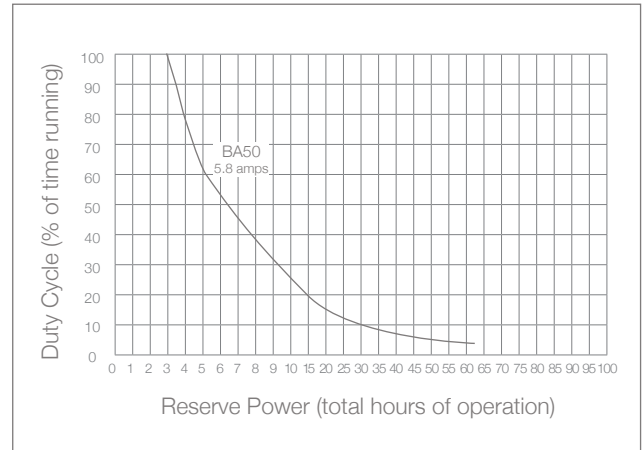

Pump Performance

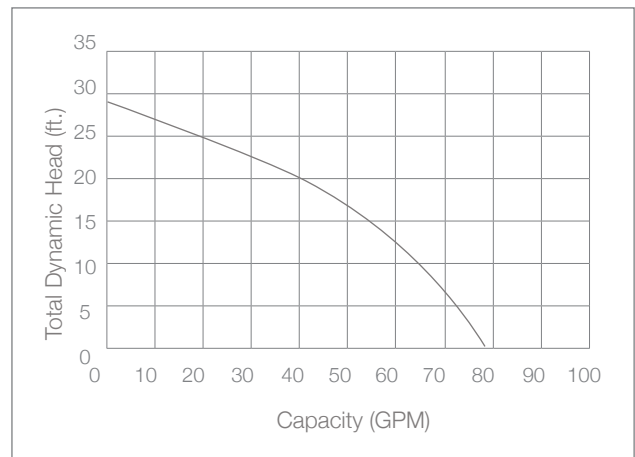

System Specifications

- Fully automatic, converts 24 volt DC to 120 volt AC when power is off
- Runs pump on AC or DC power
- Inverter has digital display, tells status of system at all times
- Requires two 12 volt deep cycle AGM batteries (batteries are NOT included)
- Non-corrosive battery enclosure
- Ion Genesis® controller alternates each pump and alarms
- Ion Genesis® includes piggyback Ion® digital level control sensors with no moving parts
 - First of its kind solid-state sensing technology with no moving parts
 - Multipoint sealing mechanism that supersedes single surface seals
 - Rated at 2 million cycles, it will last 4 times longer than a standard pump switch
- Quick and easy installation
- 3 year warranty

Take Control.
ION
Sumpro

Can be used with
the Ion Gateway.
See page 10 for
more information.



Sumpro[®]

Battery Backup System

- Smaller footprint & lighter than original Sumpro[®] with quieter operation
- Easy to read LCD screen for real time monitoring
- Alarm contact for remote monitoring and notification
- Solar & wind inputs for battery charging
- Improved charging circuit
- High inrush capability



37 Forestwood Dr., Romeoville, IL 60446 www.ionproducts.net [815] 886-9200

Patents Pending, Patent No. 5,508,905

Sumpro®

Battery Backup System

Typical Installation Diagram

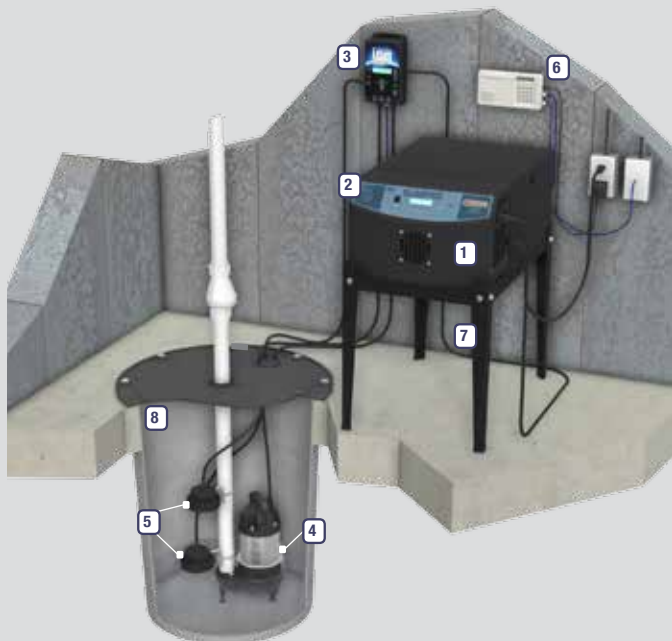

1. Sumpro®
2. Wind & solar inputs
3. Ion Genesis® (optional)
4. Sump pump (optional)
5. Ion Genesis® sensors (optional)
6. Phone dialer (optional)
7. Stand (optional)
8. Recommended minimum basin size:
18" x 24" (not included)

System Performance

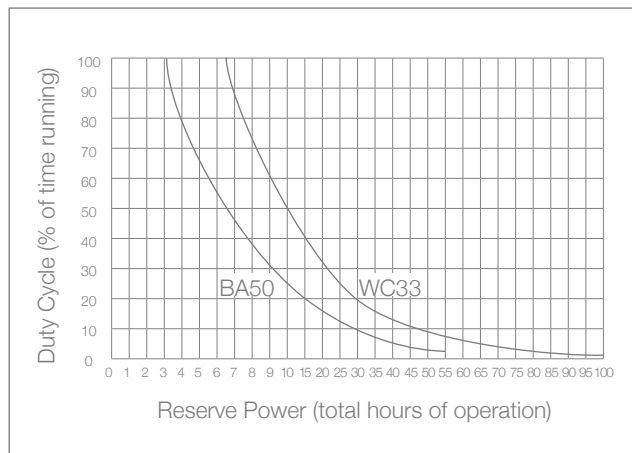

Performance curve results using a 1/3 and 1/2 HP pump with (2) fully charged Power+ 100 amp hour batteries.

Dimensions



System Specifications

System Model	Sumpro® Model 100
Includes	<ul style="list-style-type: none"> • 15 amp inverter with status lights • Dual battery box with fuse bar
Input Voltage	120 VAC/24VDC (2 batteries, sold separately), 60 Hz, 12 amp
Output Voltage	120 VAC, 12 amp
Pump Type	Any 115 volt pump up to 12 amps (not included)
Options	Stand, battery add-on kit, Ion Genesis®
Weight	60 lbs
Warranty	3 years

Take Control.
ION
Sumpro.

Can be used with
the Ion Gateway.
See page 10 for
more information.



Sumpro® Platinum

Battery Backup System

- Runs on either AC or DC power
- Supplied with two ¾ HP, 115 volt sump pumps
- Ion Genesis® controller monitors all pump activity, including pump running current, pump trending, and self testing without having to access the basin
- Ion Genesis® sensors have no moving parts or pieces to fail and will far outlast common switch types
- Can be installed as a backup or primary pump



Patents Pending, Patent No. 5,508,905 & 8,591,198



37 Forestwood Dr., Romeoville, IL 60446 www.ionproducts.net [815] 886-9200

Take Control.
ION
Sumpro

Can be used with
the Ion Gateway.
See page 10 for
more information.



Sumpro[®] Titanium

Battery Backup System

- Runs on either AC or DC power
- Supplied with two ½ HP, 115 volt sump pumps
- Ion[®] Endeavor controller alternates each pump run, monitors all pump activity, including pump running current, pump trending, and self testing without having to access the basin
- Ion[®] sensors have no moving parts or pieces to fail and will far outlast common switch types
- Can be installed as a backup or primary pump



Patents Pending, Patent No. 5,508,905 & 8,591,198



37 Forestwood Dr., Romeoville, IL 60446 www.ionproducts.net [815] 886-9200

Take Control.
ION
 Products



Power+

Maintenance Free AGM Battery

Power+ maintenance free batteries are revolutionizing the way we power our backup systems. Simply connect a battery or batteries to your backup system without having to perform monthly maintenance. The Power+ battery is completely sealed and spill-proof with no risk of exposure to hazardous chemicals. It is safe for standard shipping anywhere in the U.S.



37 Forestwood Dr., Romeoville, IL 60446 www.ionproducts.net [815] 886-9200

Accessories



**Part
Number**

Description

P20301

Battery 151P-36 Maintenance Free AGM Sealed Lead Acid



Mi20139

12 Volt Battery Add-On Kit, Single Battery Box With 18" Jumpers



UA20195

24 Volt Battery Add-On Kit, Dual Battery Box With 18" Jumpers And Fuse Link



EM020156

Single Battery Stand For All 12 Volt Systems With A Single Battery Box



iB30102

Ion Sumpro Battery Box With Fuse Link Model 100BBXL

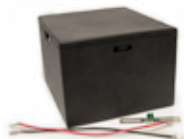

iBA20383

Ion Sumpro Battery Box With Fuse Link Model 100BBXL With Fuse Link & Jumpers



iSS20326

Stand For Ion Sumpro Model 100



SLA105

Automatic Dialer Ion Genesis or Ion Endeavor Required



A0000702i7

Standard Fuse Link 7"



iN-SPB1-1

Ion Bracket Switch To Pipe Clamp

 **Take Control.**®

ION®

Technologies

37 Forestwood Dr. Romeoville, IL 60446
www.ionproducts.net ■ (815) 886 - 9200