



RVNB-NL SERIES NO LEAD BRASS RELIEF VALVES

Specification:

- Threads conform to ANSI/ASME B1.20.1
- Operating Temperature: 40 - 160°F (5 - 71°C)

Certification:

- NSF/ANSI Standard 372 Certified

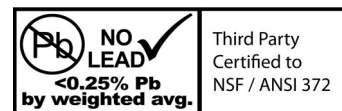

MATERIAL LIST		
No.	Description	Materials
1	Bonnet	NL Brass C89550
2	Washer	Fibre H
3	Spring Cup	NL Brass C89550
4	Spring	304 Stainless Steel
5	Seat	NL Brass C89550
6	Seat Packing	Buna-N Rubber
7	Seat Screw	Steel C2600W
8	Body	NL Brass C89550

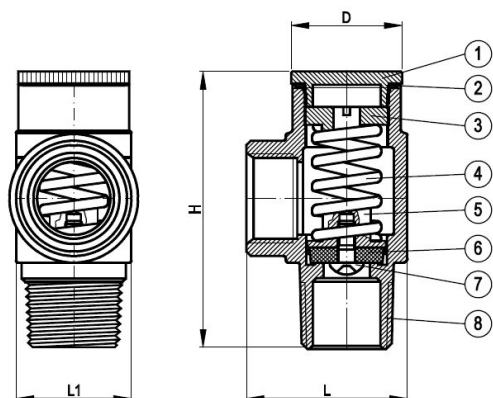

DIMENSIONS												
Part No.	Size		Factory Pre-Set	H		L		D		L1		Weight
	Inlet	Outlet		inches	mm	inches	mm	inches	mm	inches	mm	
RVNB05-075NL	1/2" MPT	1/2" FPT	75	2.45	62.2	1.44	36.5	0.98	25.0	1.02	26.0	149
RVNB05-100NL	1/2" MPT	1/2" FPT	100	2.45	62.2	1.44	36.5	0.98	25.0	1.02	26.0	149
RVNB07-075NL	3/4" MPT	1/2" FPT	75	2.45	62.2	1.44	36.5	0.98	25.0	1.02	26.0	162
RVNB07-100NL	3/4" MPT	1/2" FPT	100	2.45	62.2	1.44	36.5	0.98	25.0	1.02	26.0	162

Pressure relief valves are recommended for all cold water system installations to protect against damage to piping and pressure tanks. Valves will be sold at factory pre-set PSI only. Accuracy +/- 15% of factory pre-set PSI. While field adjustments are not recommended the approximate operating range has been provided by the manufacturer. Any changes made to the pre-set pressure is entirely at the risk of the person/company who makes the adjustment. Any changes made should be thoroughly tested for accuracy at the time of installation. Neither the manufacturer or Boshart Industries will assume liability or responsibility caused as a result of adjusting the relief valve setting. If the pressure setting is adjusted, it will void any warranty or return of the product. Relief valves must be installed so that they drain to a floor drain, sump or other safe location with an air brake. If an outlet pipe is used then it must be at least the same diameter as the relief valve outlet.

For cold water use only. These valves are not T & P valves that are required with water heaters.



25 Whaley Ave., Milverton, Ontario, Canada N0K 1M0

Tel: (519)-595-4444

Toll Free: (800)-561-3164

Fax: (519)-595-4380

Web: www.boshart.com