

Pump end with 2 HP
and smaller motor at
3500 RPM or 1 HP
and smaller motor at
1750 RPM

| Item No. | Name of Part | Material of Construction |
|----------|---|--------------------------|
| 1 | Casing | Cast Iron |
| * 2 | Impeller | Bronze |
| 11 | Casing Cover | Cast Iron |
| * 26 | Impeller Screw | Steel |
| 40 | Deflector (Liquid) | Neoprene |
| †* 65 | Mechanical Shaft Seal (Stationary Element) | Ni-Resist |
| * 73 | Casing Gasket | Cork-Cellulose |
| †* 80 | Mechanical Shaft Seal (Rotating Element) | Carbon |

† Furnished only in Pairs as complete units

* For domestic service we recommend these parts be carried in stock as spares
NOTE: All pumps have a maximum working pressure - 126 PSIG

* Recommended Spare Parts

Assembly Parts

Type AC & AE Unipumps with Type 21
Mechanical Shaft Seal - Bulletin Repair Parts - 100

WEINMAN®

www.cranepumps.com

Repair Parts

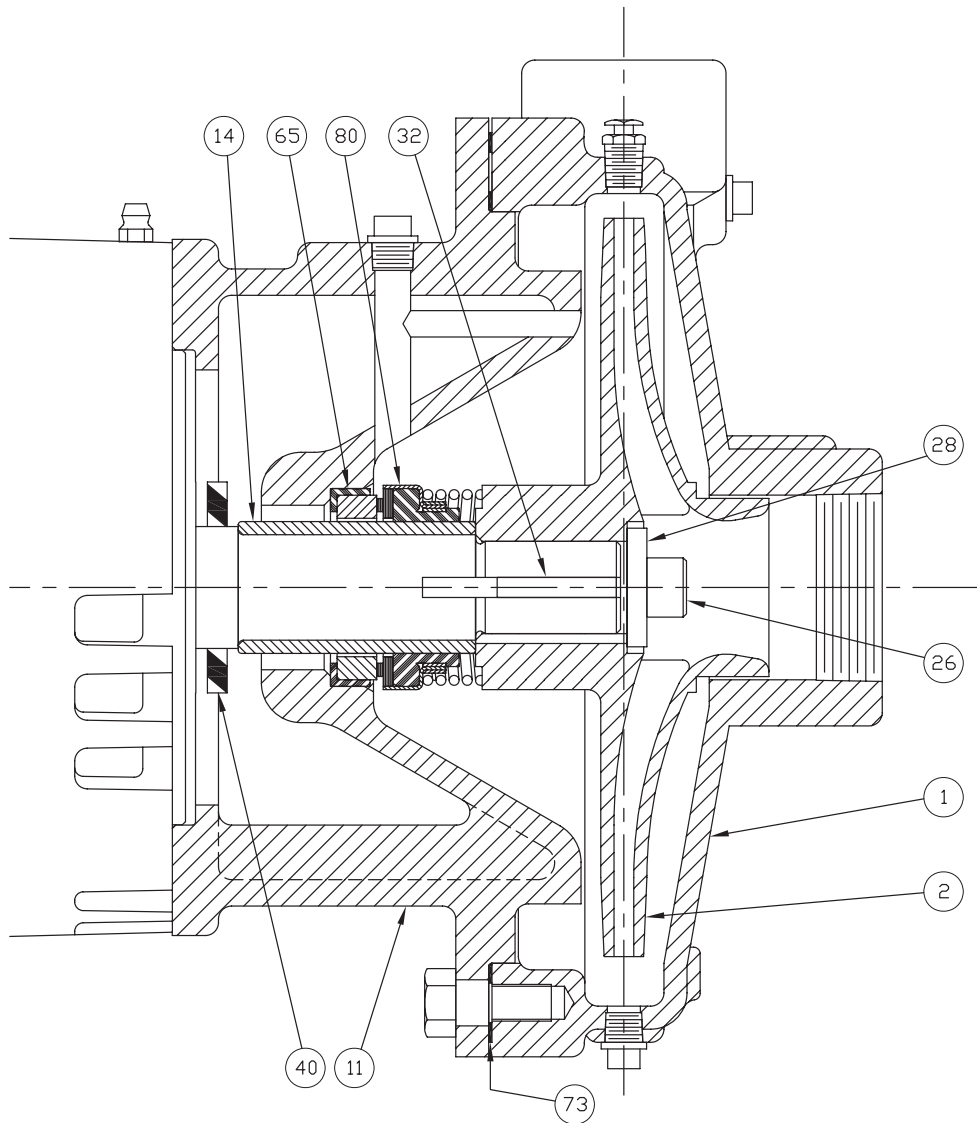

Pump end with 3 HP
and larger motor at
3500 RPM

| Item No. | Name of Part | Material of Construction |
|----------|---|--------------------------|
| 1 | Casing | Cast Iron |
| * 2 | Impeller | Bronze |
| * 14 | Shaft Sleeve | Bronze |
| * 26 | Impeller Screw | Stainless |
| * 28 | Impeller Screw Washer | Stainless |
| * 32 | Impeller Key | Stainless |
| †* 65 | Mechanical Shaft Seal (Stationary Element) | Ni-Resist |
| * 73 | Casing Gasket | Cork-Cellulose |
| †* 80 | Mechanical Shaft Seal (Rotating Element) | Carbon |

† Furnished only in Pairs as complete units

* For domestic service we recommend these parts be carried in stock as spares

NOTE: All pumps have a maximum working pressure - 126 PSIG

* Recommended Spare Parts

SECTION RP
PAGE 2
DATE 9/10

CRANE
®

A Crane Co. Company

PUMPS & SYSTEMS

USA: (937) 778-8947 • Canada: (905) 457-6223 • International: (937) 615-3598

56J Frame Motor

| 100 Series AC & AE Unipumps | 4AC-301 | 4AE-301 | 6AC-301 | 6AE-301 | 8AC-301 | Quantity |
|-------------------------------------|-------------|-------------|-------------|-------------|-------------|----------|
| 1 Casing | 4167-1-A2 | C5832-A2 | 4356-1-A2 | C5838-A2 | 4384-1-A2 | 1 |
| 2 Impeller | B4764-2-B12 | B5833-4-B12 | B4828-5-B12 | B5839-6-B12 | B4839-3-B12 | 1 |
| 11 Casing Cover / Adapter | 4056-2-A2 | C5826-2-A2 | C4859-1-A2 | C5826-2-A2 | C4859-1-A2 | 1 |
| 26 Impeller Screw | Q16-44-J8 | Q16-44-J8 | Q16-44-J8 | Q16-44-J8 | Q16-44-J8 | 1 |
| 40 Deflector (Liquid) | H1936-7-K2 | H1936-7-K2 | H1936-7-K2 | H1969-7-K2 | H1969-7-K2 | 1 |
| 65 & 80 Mechanical Seal - STD | Q26-77-Y2 | Q26-77-Y2 | Q26-77-Y2 | Q26-77-Y2 | Q26-77-Y2 | 1 |
| 65 & 80 Mechanical Seal - Hot Water | Q26-77-Y6 | Q26-77-Y6 | Q26-77-Y6 | Q26-77-Y6 | Q26-77-Y6 | 1 |
| 73 Case Gasket | A6551-L13 | A6345-L13 | A6345-L13 | A6345-L13 | H2267-1-L13 | 1 |
| N.S. Air Vent Valve | Q24-3-C2 | Q24-3-C2 | Q24-3-C2 | Q24-3-C2 | Q24-3-C2 | 1 |
| N.S. Pipe Coupling | Q29-68-E4 | Q29-68-E4 | Q29-68-E4 | Q29-68-E4 | Q29-68-E4 | 1 |
| N.S. Nipple | Q29-69-E4 | Q29-69-E4 | Q29-69-E4 | Q29-69-E4 | Q29-103-E4 | 1 |
| N.S. Mounting Base | 57028 | 57028 | 57028 | 57028 | - | 1 |
| N.S. Mounting Plate | - | - | - | - | 57028 | 1 |
| N.S. Bushing | - | - | - | - | Q29-52-E4 | 1 |

* = Quantity 2 Required

Repair Parts

| 145JM thru 184JM Frame Motor | | | | | | |
|------------------------------|-----------------------------|-------------|-------------|-------------|--------------|---|
| 100 Series AC & AE Unipumps | 4AE-401 | 6AC-401 | 6AE-401 | 8AC-401 | Quantity | |
| 1 | Casing | C5832-A2 | 4356-1-A2 | C5838-A2 | 4384-1-A2 | 1 |
| 2 | Impeller | B5833-5-B12 | B4828-4-B12 | B5839-5-B12 | B4839-4-B12 | 1 |
| 11 | Casing Cover / Adapter | C8486-A2 | C8486-1-A2 | C8486-A2 | C8486-1-A2 | 1 |
| 14 | Shaft Sleeve | A5782-C9 | A5782-C9 | A5782-C9 | Q5782-C9 | 1 |
| 26 | Impeller Screw | Q60-2-J3 | Q60-2-J3 | Q60-2-J3 | Q60-2-J3 | 1 |
| 28 | Impeller Screw Washer | A5090-J3 | A5090-J3 | A5090-J3 | A5090-J3 | 1 |
| | Impeller Key | Q21-4-J8 | Q21-4-J8 | Q21-4-J8 | Q21-4-J8 | 1 |
| 40 | Deflector (Liquid) | H1936-13-K2 | H1936-13-K2 | H1936-13-K2 | H1936-13-L13 | 1 |
| 65 & 80 | Mechanical Seal - STD | Q26-395-Y34 | Q26-395-Y34 | Q26-395-Y34 | Q26-395-Y34 | 1 |
| 65 & 80 | Mechanical Seal - Hot Water | Q26-395-Y6 | Q26-395-Y6 | Q26-395-Y6 | Q26-395-Y6 | 1 |
| 73 | Case Gasket | A6345-L13 | H2267-1-L13 | A6345-L13 | H2267-1-L13 | 1 |
| N.S. | Air Vent Valve | Q24-3-C2 | Q24-3-C2 | Q24-3-C2 | Q24-3-C2 | 1 |
| N.S. | Bushing | - | - | - | Q29-52-E4 | 1 |
| 213JM / 215JM Frame Motor | | | | | | |
| 100 Series AC & AE Unipumps | 6AE-410 | 8AC-410 | Quantity | | | |
| 1 | Casing | C5838-A2 | 4384-1-A2 | | | 1 |
| 2 | Impeller | B5839-5-B12 | B4839-4-B12 | | | 1 |
| 11 | Casing Cover / Adapter | C8486-10-A2 | C8486-11-A2 | | | 1 |
| 14 | Shaft Sleeve | A5782-C9 | A5782-C9 | | | 1 |
| 26 | Impeller Screw | Q60-2-J3 | Q60-2-J3 | | | 1 |
| 28 | Impeller Screw Washer | A5090-J3 | A5090-J3 | | | 1 |
| 32 | Impeller Key | Q21-4-J8 | Q21-4-J8 | | | 1 |
| 40 | Deflector (Liquid) | H1936-2-K2 | H1936-2-K2 | | | 1 |
| 65 & 80 | Mechanical Seal - STD | Q26-395-Y34 | Q26-395-Y34 | | | 1 |
| 65 & 80 | Mechanical Seal - Hot Water | Q26-395-Y6 | Q26-395-Y6 | | | 1 |
| 73 | Case Gasket | A6345-L13 | H2267-1-L13 | | | 1 |
| N.S. | Air Vent Valve | Q24-3-C2 | Q24-3-C2 | | | 1 |
| N.S. | Bushing | - | Q29-52-E4 | | | 1 |