

## FIXTURE KEY

	JDC1	11
	MAC Aura XB	10
		
	Impression X4 Bar 20	18
	Perseo	7
		
	Creative Light 1	36







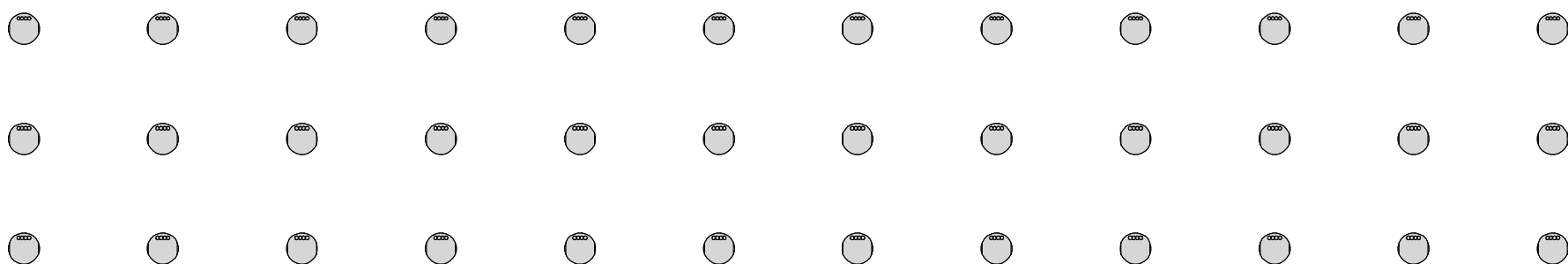

Frame Backdrop - 32' x 20' (9.75m x 6.09m)

6mm LED screen - 6m x 1.5m  
Hung from Video Truss on 2 x hoists  
(Hoists supplied by touring production)

12 x 2.5 m booms with 36 GLP Creative Lights

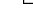

-  Scenic Point
-  Automation Point
-  Audio Point
-  2 Ton Point
-  1 Ton Point
-  1/2 Ton Point
-  1/4 Ton Point

## LABEL LEGEND

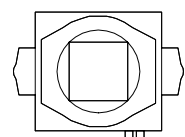

Unit No.

## DISCLAIMER

This drawing is only a representation of design concepts. Bryte Design Studio .Ltd takes no responsibility, and here with disclaims liability for the erection, engineering or use of any component or concept shown on this drawing.



## PRODUCTION TEAM

## DESIGNER

Cate Carter  
-  
cate@cate-carter.com

## PRODUCTION MANAGER

Mark Jones  
-  
markcjones@mac.com

## DRAWING INFO.

**DRAWING TITLE**

EG\_Tour2021\_v5r1\_prep -

## DRAWN BY

Cate Carter

## PRINT DATE

27/Sep/21 15:36

**PRINT SIZE**

A2

### DRAWING SCALE

NOT TO SCALE

## CLIENT INFO.

## CLIENT

ELLIE GOULDING

## PRODUCTION

ELLIE GOULDING TOUR 2021

**VENUE**

UK venues

**VENUE CONTACT**

—  
—  
—

PRODUCTION	SHEET TITLE	REVISION
ELLIE GOULDING TOUR 2021	Lighting Elevated - Front View	<b>v5r1</b>