

*Brandi Carlile*

This Drawing is a suggestion for placement of show elements.  
 LEAPS and it's employees are not qualified or certified in rigging or engineering.  
 All plans need to be checked and approved of by a qualified engineer or rigger to ensure safety.



Title Perspective Views- Floor LX		
Drawing Number 1 of 10	Drawn By Bornt	Date 05/26/2023
The Highwomen- Gorge 2023		Version 3

## CARRIED BY THE TOUR:

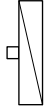
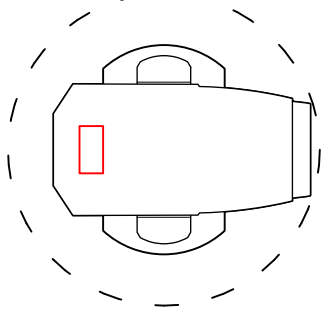
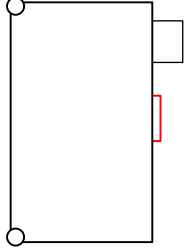
  	<p>Portman P2 Hexalin (6ch)</p> <p>Robe Robin Esprite (Mode 1)</p> <p>Chauvet AmHaze Stadium Open</p>	<p>12</p> <p>4</p> <p>2</p>
---	---	-----------------------------

## PROVIDED LOCALLY:

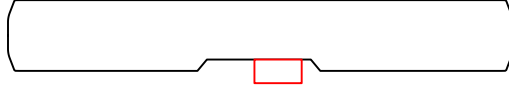
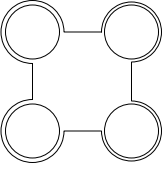
 	<p>Elation Chorus Line 16 (Extended mode- 78ch)</p> <p>Chauvet Strike 4 (4ch mode)</p> <p>10' PIPE</p> <p>6' PIPE</p> <p>SWIVEL CHESBORO</p> <p>40' TRUSS (BLACK)</p>	<p>12</p> <p>6</p> <p>2</p> <p>2</p> <p>8</p>
--	---	---

*Brandi Carlile*

This Drawing is a suggestion for placement of show elements.  
 LEAPS and it's employees are not qualified or certified in rigging or engineering.  
 All plans need to be checked and approved of by a qualified engineer or rigger to ensure safety.



Title Lighting Key and Counts		
Drawing Number 2 of 10	Drawn By Bornt	Date 05/26/2023
The Highwomen- Gorge 2023		Version 3

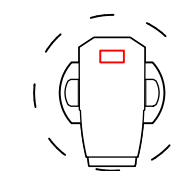
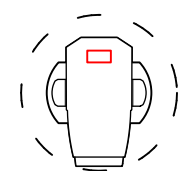
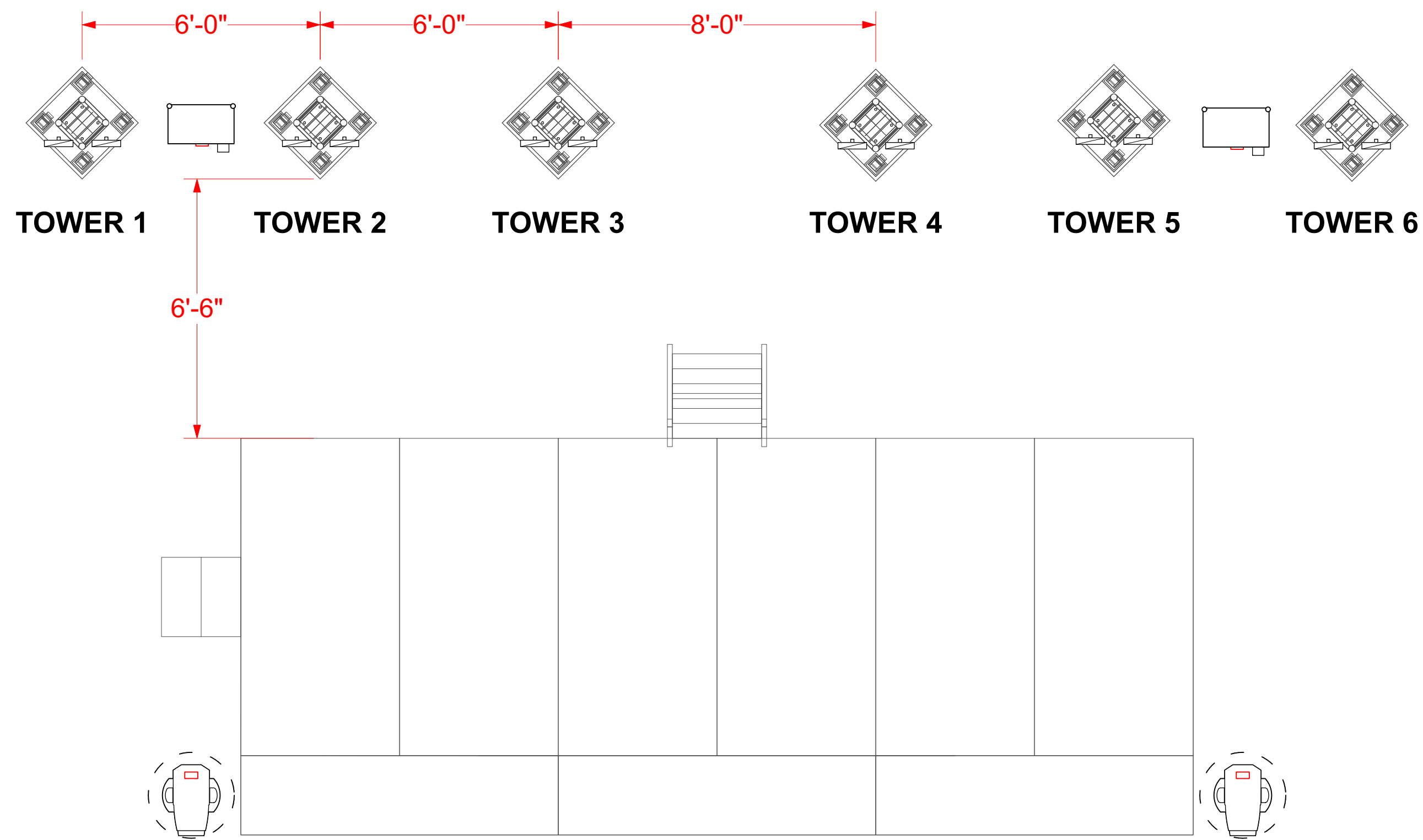

*Brandi Carlile*

This Drawing is a suggestion for placement of show elements.  
 LEAPS and it's employees are not qualified or certified in rigging or engineering.  
 All plans need to be checked and approved of by a qualified engineer or rigger to ensure safety.



Title Top/Plan View- Floor LX		
Drawing Number 3 of 10	Drawn By Bornt	Date 05/26/2023
The Highwomen- Gorge 2023		Version 3

1/193 1/199  
301 302

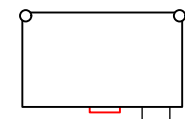

1/205 1/211  
303 304

1/217 1/223  
305 306

2/193 2/199  
307 308

2/205 2/211  
309 310

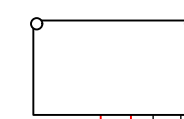

2/217 2/223  
311 312

901  
1/501

902  
2/501

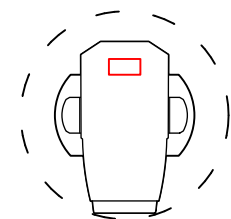

102  
1/278

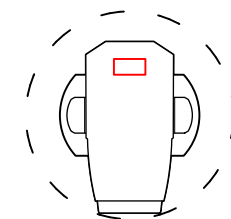

103  
2/229

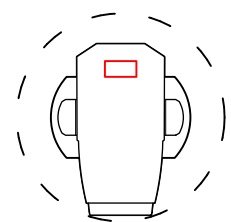

101  
1/229

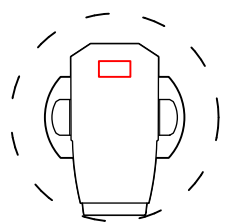

104  
2/278

*Brandi Carlile*

This Drawing is a suggestion for placement of show elements.  
LEAPS and it's employees are not qualified or certified in rigging or engineering.  
All plans need to be checked and approved of by a qualified engineer or rigger to ensure safety.



Title Top/Plan View- Floor LX Only		
Drawing Number 4 of 10	Drawn By Bornt	Date 05/26/2023
The Highwomen- Gorge 2023		Version 3

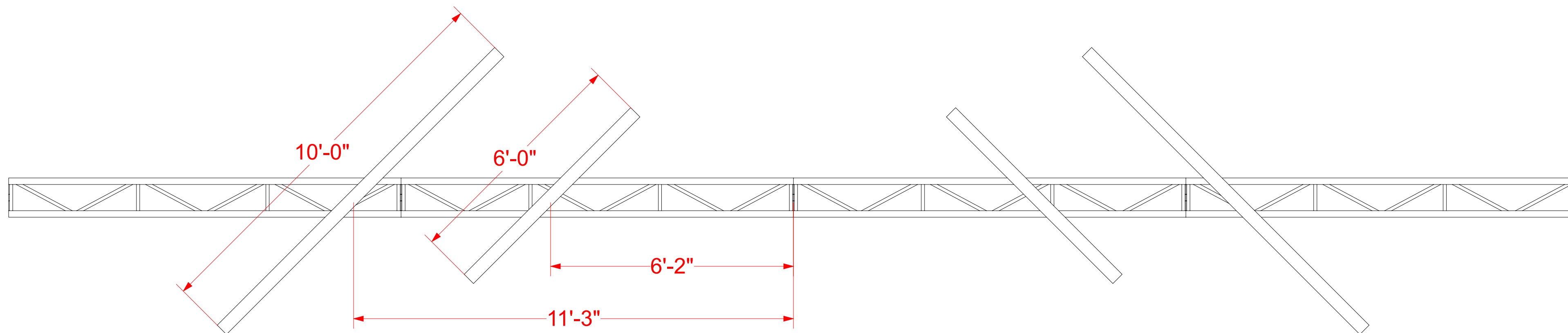
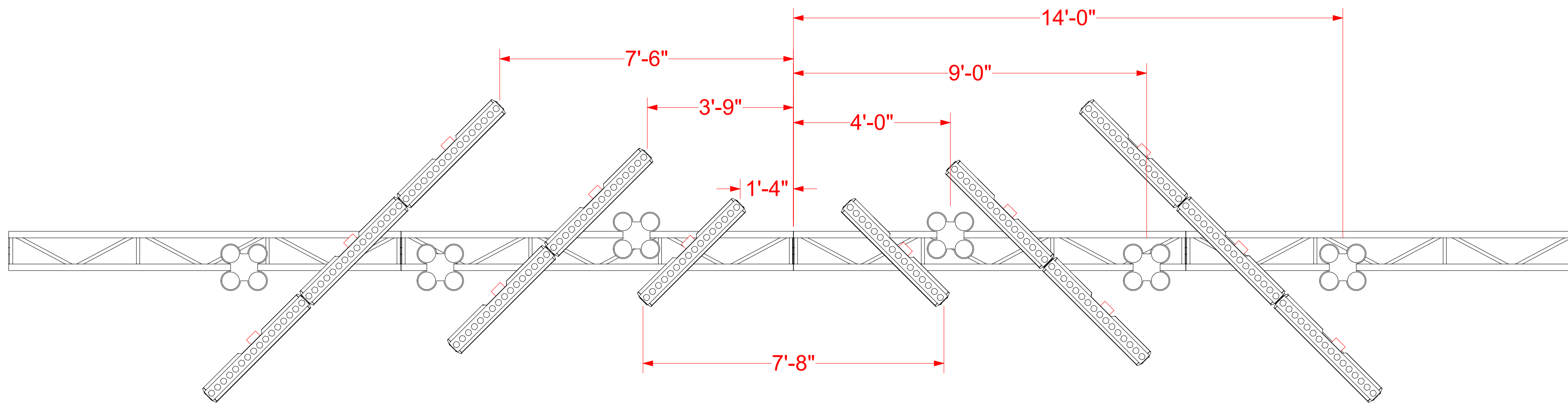

**Choruslines mounted to Pipes (or unistrut if available to keep fixtures from rolling) that are mounted to truss by chesboro to create chevrons**

**Truss can fly out during support act to hide, then fly in during changeover for Highwomen**

*Brandi Carlile*

This Drawing is a suggestion for placement of show elements.  
 LEAPS and it's employees are not qualified or certified in rigging or engineering.  
 All plans need to be checked and approved of by a qualified engineer or rigger to ensure safety.



Title Front Detail Additional Flown LX		
Drawing Number 5 of 10	Drawn By Bornt	Date 05/26/2023
The Highwomen- Gorge 2023		Version 3

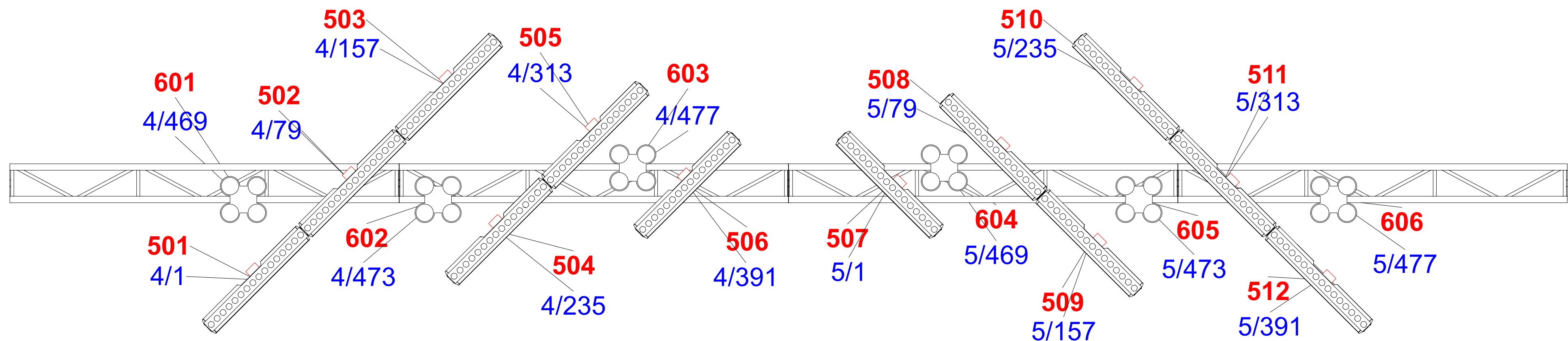

**Choruslines mounted to Pipes (or unistrut if available to keep fixtures from rolling)  
that are mounted to truss by chesboro to create chevrons**

**First pixel of chorusline on Stage right side of fixture.  
Bliner cells starting top Stage right.**

**Truss can fly out during support act to hide, then fly in during changeover for Highwomen**

*Brandi Carlile*



Title Front Detail 2 Additional Flown LX		
Drawing Number 6 of 10	Drawn By Bornt	Date 05/26/2023
The Highwomen- Gorge 2023		Version 3

This Drawing is a suggestion for placement of show elements.  
LEAPS and it's employees are not qualified or certified in rigging or engineering.  
All plans need to be checked and approved of by a qualified engineer or rigger to ensure safety.

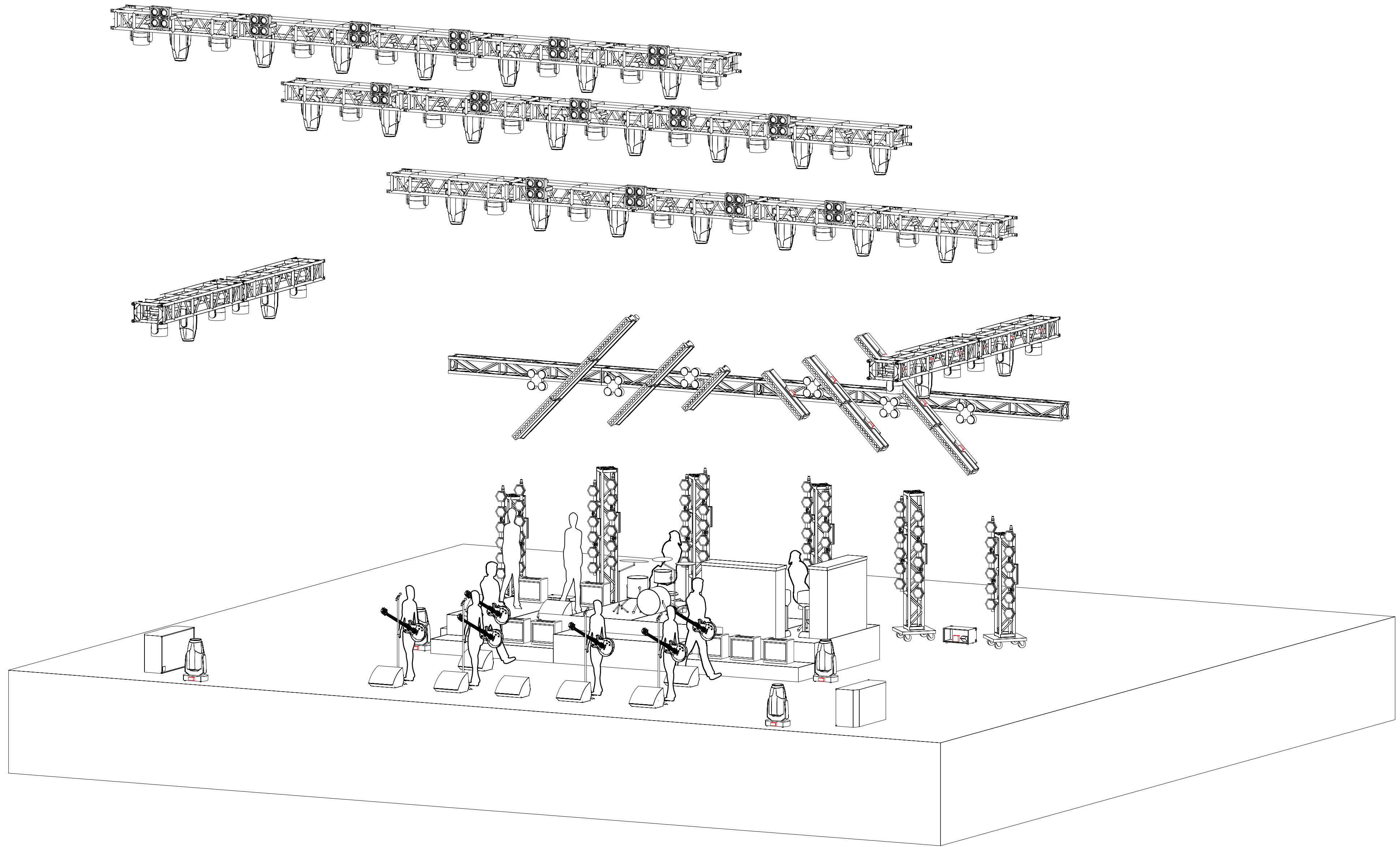

*Brandi Carlile*

This Drawing is a suggestion for placement of show elements.  
 LEAPS and it's employees are not qualified or certified in rigging or engineering.  
 All plans need to be checked and approved of by a qualified engineer or rigger to ensure safety.



Title Perspective Views- OH LX		
Drawing Number 7 of 10	Drawn By Bornt	Date 05/26/2023
The Highwomen- Gorge 2023		Version 3

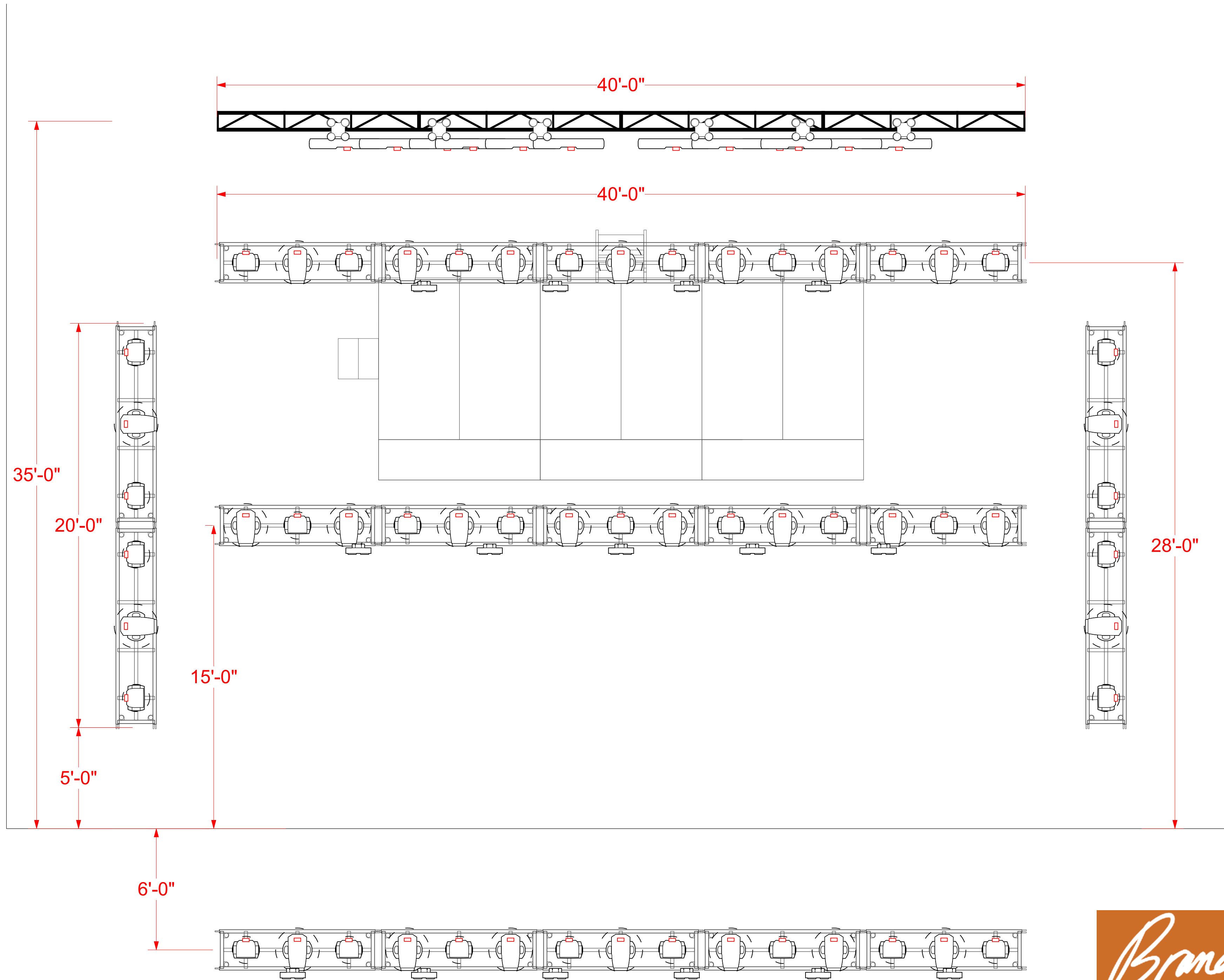

*Brandi Carlile*

This Drawing is a suggestion for placement of show elements.  
 LEAPS and it's employees are not qualified or certified in rigging or engineering.  
 All plans need to be checked and approved of by a qualified engineer or rigger to ensure safety.



Title Top/Plan View- OH LX		
Drawing Number 8 of 10	Drawn By Born	Date 05/26/2023
The Highwomen- Gorge 2023		Version 3

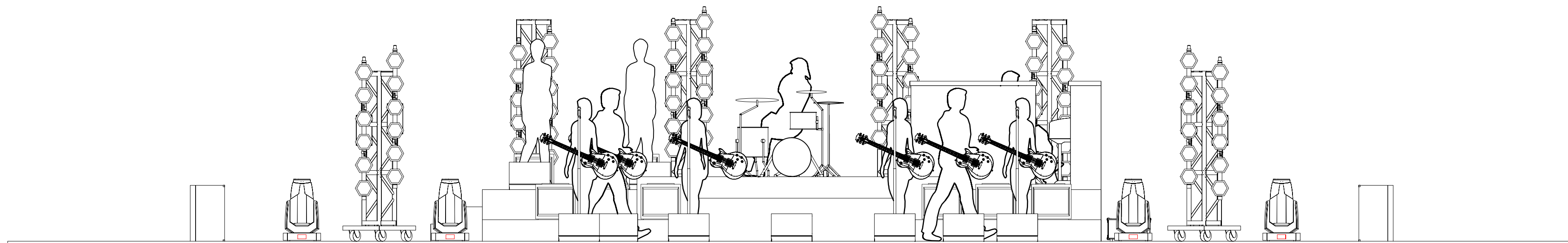
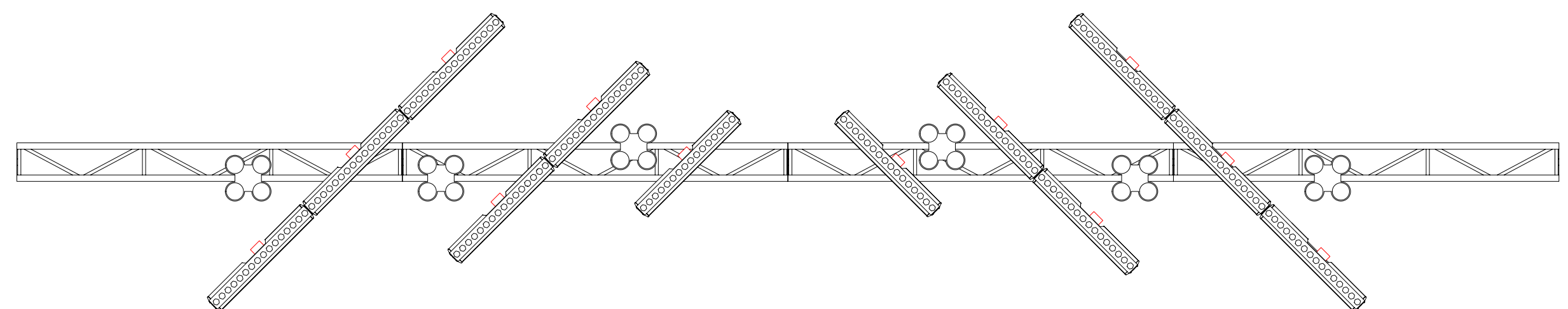
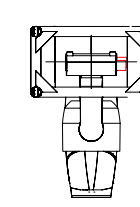
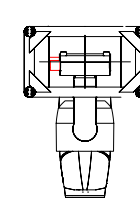
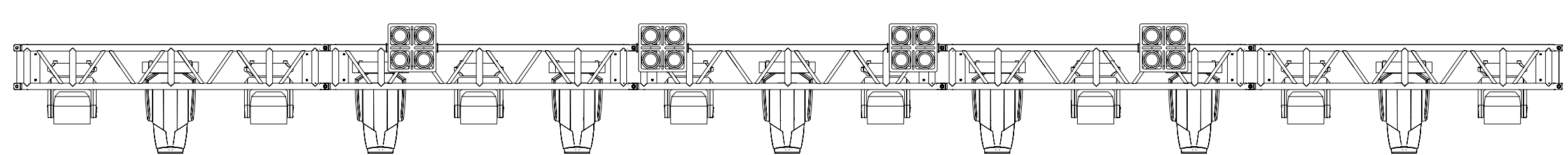
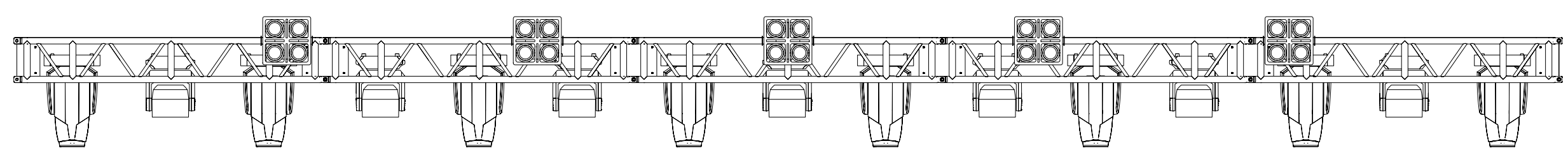
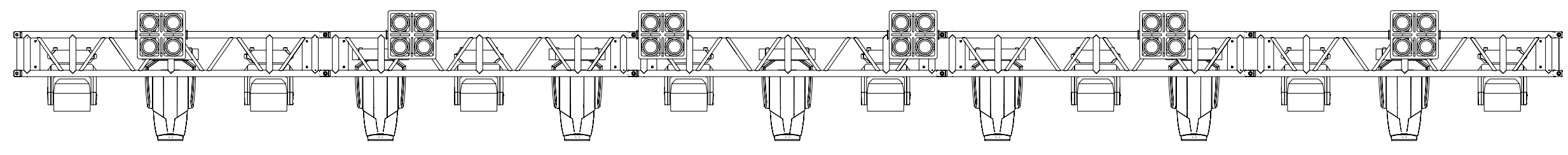

*Brandi Carlile*

This Drawing is a suggestion for placement of show elements.  
 LEAPS and it's employees are not qualified or certified in rigging or engineering.  
 All plans need to be checked and approved of by a qualified engineer or rigger to ensure safety.



Title Front Elevation- OH LX		
Drawing Number 9 of 10	Drawn By Bornt	Date 05/26/2023
The Highwomen- Gorge 2023		Version 3

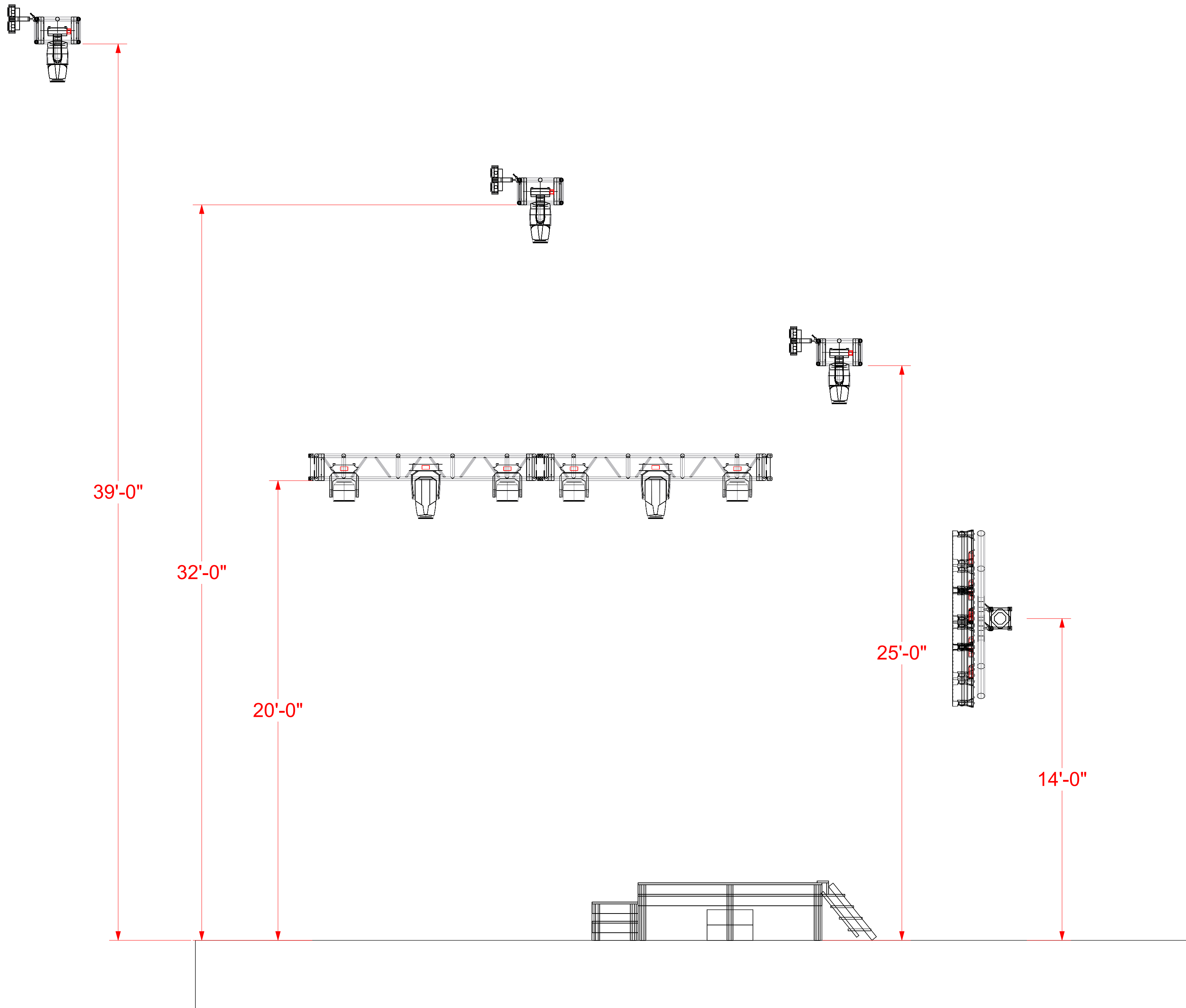

*Brandi Carlile*

This Drawing is a suggestion for placement of show elements.  
 LEAPS and it's employees are not qualified or certified in rigging or engineering.  
 All plans need to be checked and approved of by a qualified engineer or rigger to ensure safety.



Title Side Elevation- OH LX		
Drawing Number 10 of 10	Drawn By Bornt	Date 05/26/2023
The Highwomen- Gorge 2023		Version 3