

FLEXSTEEL®

W1147-826

Buffet

IMPORTANT NOTE

Carefully remove all the parts from the carton and put them individually on a soft cloth to prevent damage to the parts.

We have taken great care in the design of this product and request that you carefully and strictly follow our assembly instructions to ensure a completed product as it was designed.

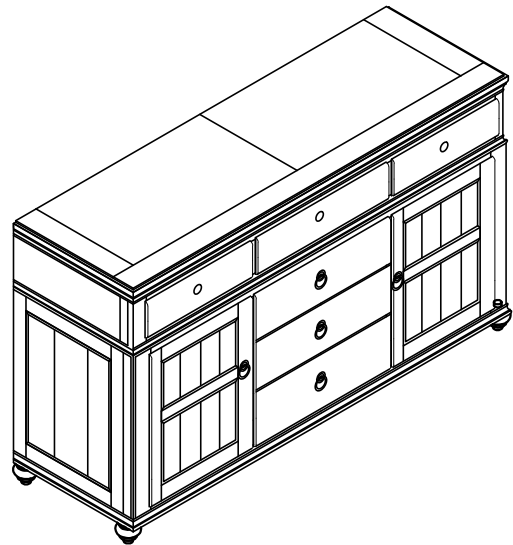

Part List

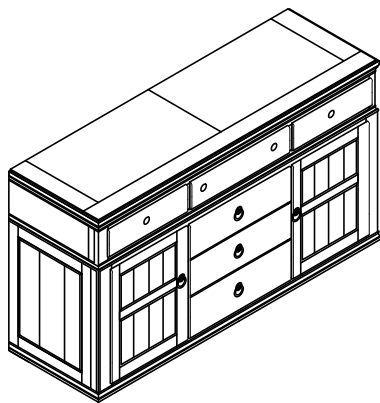

A. Top Section
1 piece

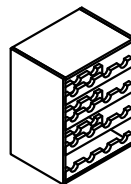

B. Wine Rack
1 pieces

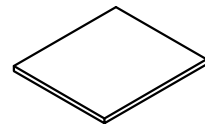

C. Shelf
2 pieces



D. Foot
4 pieces



E. Support Leg
1 piece

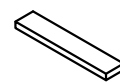

F. Wood Filler
1 piece

Hardware List

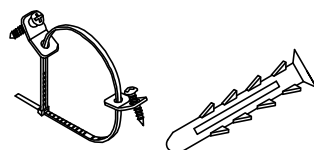

Anti-Tipping Device
1 set

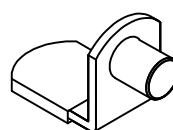

Shelf Support
8 pieces

Tool(s) recommended for assembly: Level

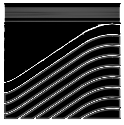

IMPORTANT

- Use a soft cloth between these parts and the floor.

STEP 1

Place the Top Section (A) upside down on a soft surface and screw in the Foot (D), Support Leg (E). (See Figure 1.)

Taking care not to put any undue pressure on the feet, carefully position the buffet in an upright position.

Note: We recommend at least two adults assemble this item.

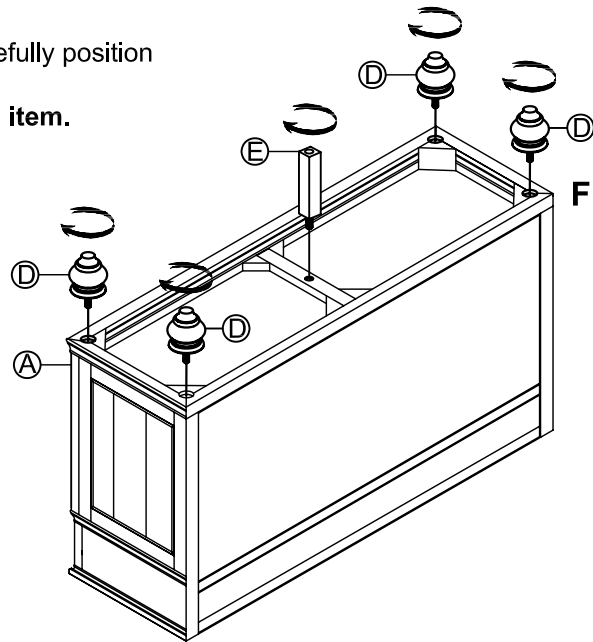

Figure 1

STEP 2

To prevent movement on the Wine Rack (B) slot in the Wood Filler (F) to Left/Right cabinet.

To add a Shelf (C), place the Shelf Supports in the desired position, and insert the Shelf (C).

To remove a Shelf (C), remove it from the furniture, and remove the Shelf Supports. (See Figure 2.)

STEP 3

Adjust the levelers on the feet until the furniture is level. (See Figure 3.)

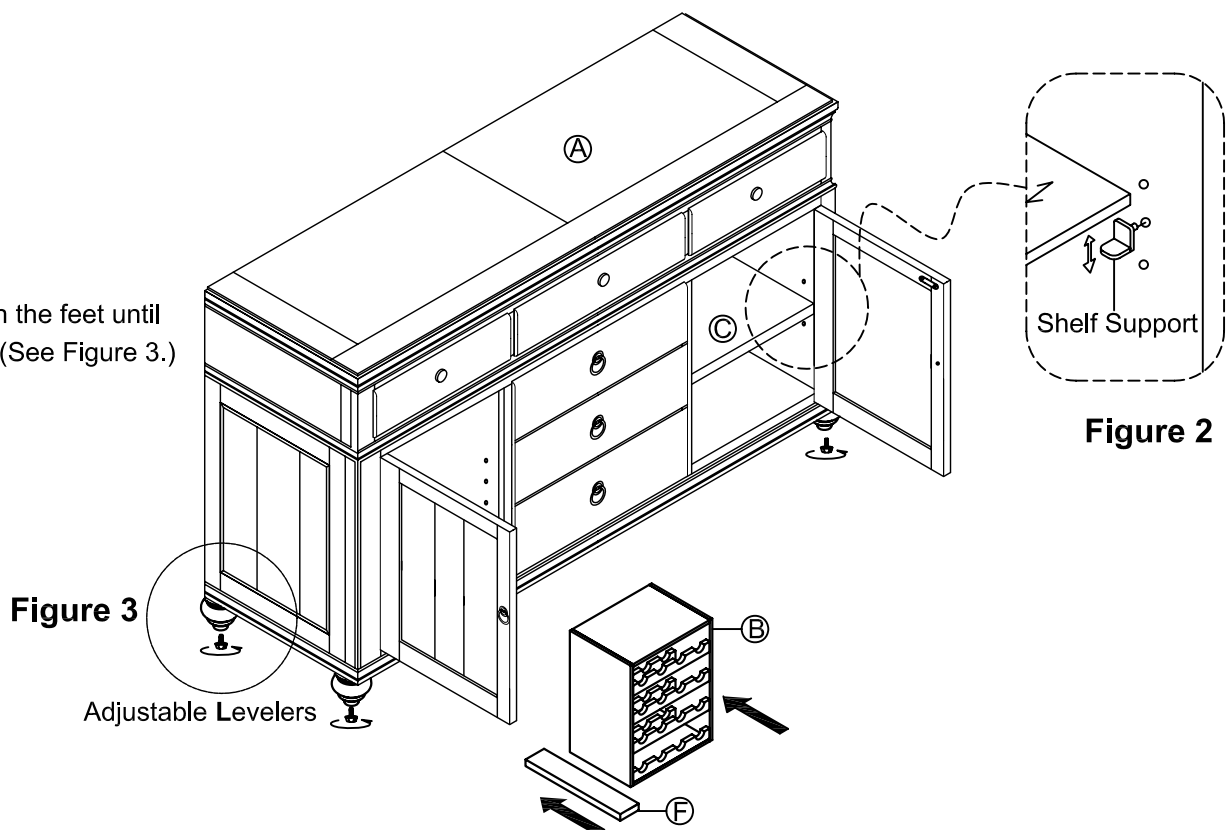

Figure 3

Figure 2