



Liberty Furniture
INDUSTRIES, INC

LIBERTY FURNITURE

ASSEMBLY INSTRUCTION

ITEM#: 417-HO120B/417-HO120T

DESCRIPTION: JR.EXECUTIVE CREDENZA BASE
JR.EXECUTIVE CREDENZA TOP

Thank you for purchasing this quality product. Be sure to check all packing material carefully for small parts, which may have come loose inside the carton during shipment. Identify and count all parts and compare with the parts list below.

COMPLETED:

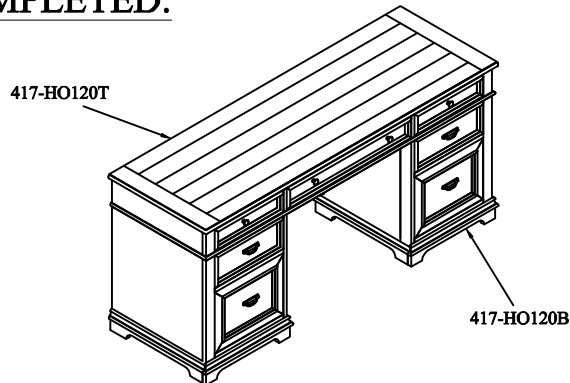

PARTS LIST

NO	DRAWING	DESCRIPTION	Q'TY
1		Jr. Executive Credenza Top	1
2		Jr. Executive Credenza Left Base	1
3		Jr. Executive Credenza Right Base	1
4		Back panel	1

HARDWARE LIST 1 (417-HO120B)

NO	DRAWING	DESCRIPTION	Q'TY
A		Bolt Ø1/4"-20*38mm(L)	7
B		Spring Washer Ø1/4"*Ø13mm	7
C		Flat Washer Ø1/4"*Ø19mm	7
D		Allen Key 4mm	1
E		Wood Button Ø8*30mm	4

HARDWARE LIST 2 (417-HO120T)

NO	DRAWING	DESCRIPTION	Q'TY
A		Bolt Ø1/4"-20*38mm(L)	8
B		Spring Washer Ø1/4"*Ø13mm	8
C		Flat Washer Ø1/4"*Ø19mm	8
D		Allen Key 4mm	1
E		Wood Button Ø8*30mm	8

STEP 1

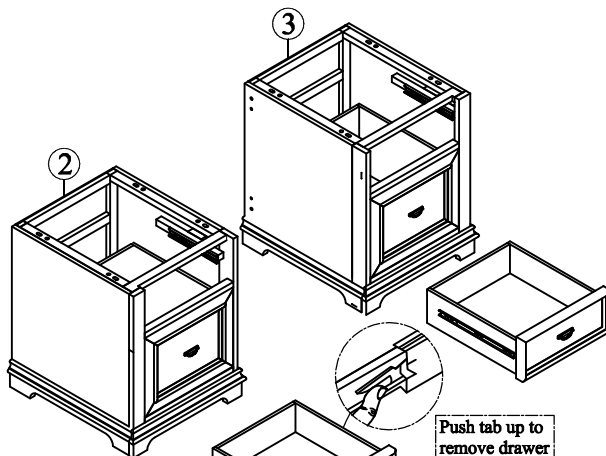

HOW TO REMOVE DRAWER

To remove drawer, simultaneously pull tab up on one side and push down on the other and remove drawer.

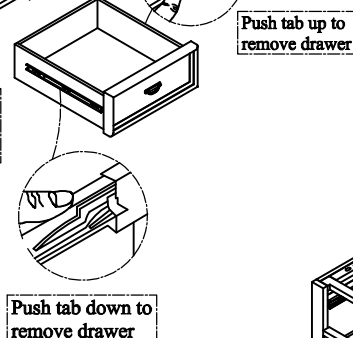

DO NOT FULLY TIGHTEN SCREW , BOLT UNTIL ALL PARTS COMPLETE ASSEMBLY

STEP 2

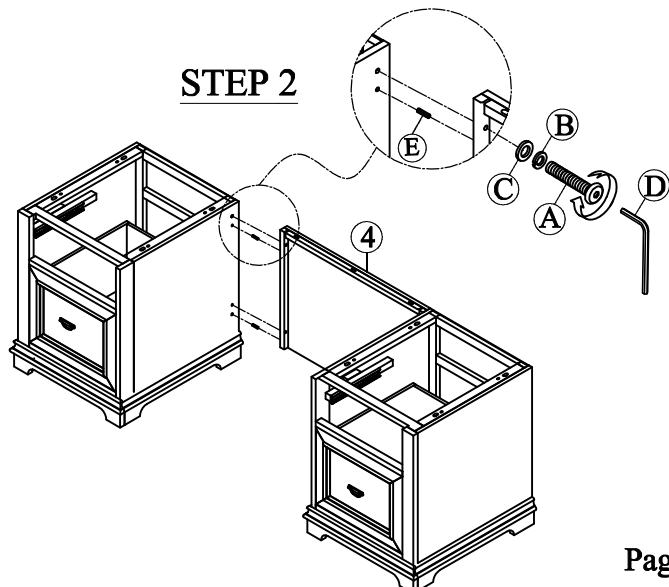

MADE IN VIETNAM

Page 1 / 2



Liberty Furniture
INDUSTRIES, INC

LIBERTY FURNITURE

ASSEMBLY INSTRUCTION

ITEM#: 417-HO120B/417-HO120T

DESCRIPTION: JR.EXECUTIVE CREDENZA BASE
JR.EXECUTIVE CREDENZA TOP

Thank you for purchasing this quality product. Be sure to check all packing material carefully for small parts, which may have come loose inside the carton during shipment. Identify and count all parts and compare with the parts list below.

STEP 3

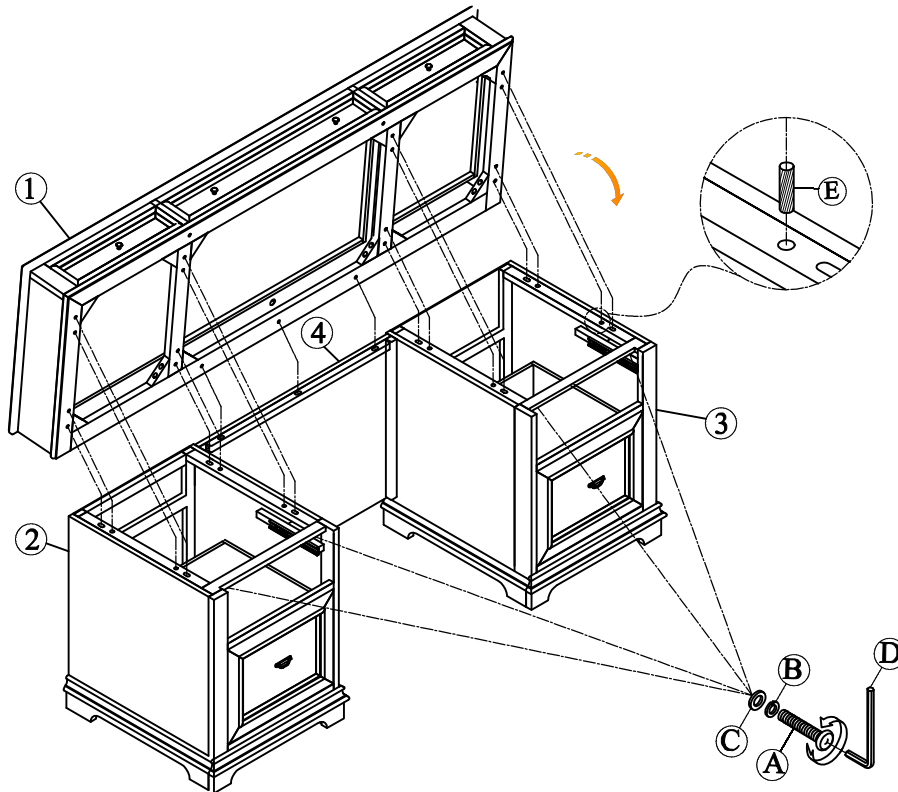

STEP 4

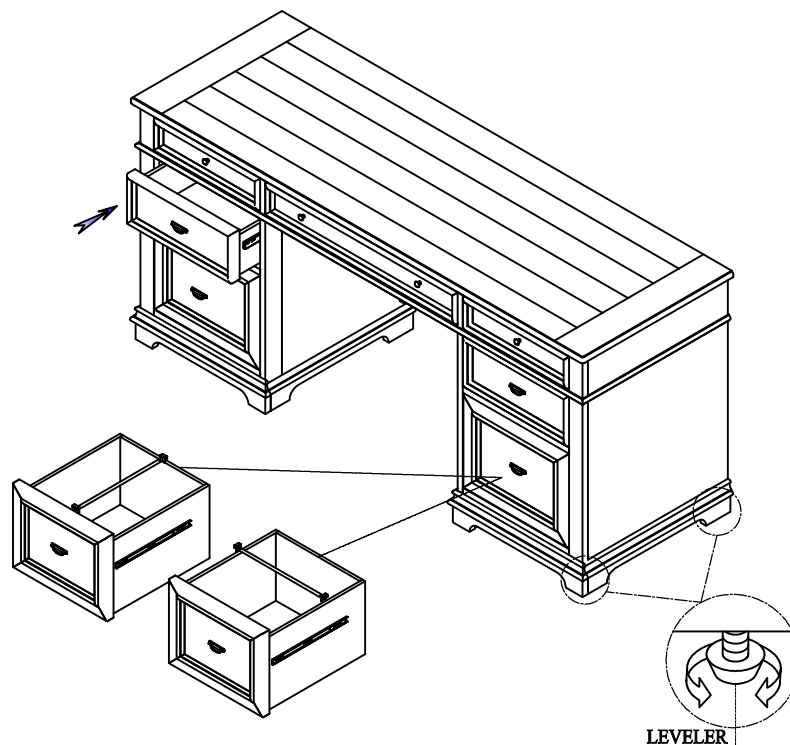

MADE IN VIETNAM

Page 2 / 2