

BRAVOS XL
steam

MCT Maytag Commercial Technology



Quick Start Guide

Using Your High Efficiency Dryer

Appearance may vary depending on model.

1 CLEAN THE LINT SCREEN

An illustration showing a hand pulling out the lint screen from the top of the dryer and another hand cleaning it with a brush.

2 LOAD THE DRYER

An illustration of the dryer door open with a large arrow pointing into the drum, which contains a load of colorful clothes.

3 TOUCH POWER TO TURN ON THE DRYER

An illustration of the power button, which is a circle with a vertical bar at the top and a curved line at the bottom, labeled 'power' below it.

4 SELECT THE DESIRED CYCLE FOR YOUR LOAD*

An illustration of the rotary dial with a hand pointing to the 'normal' setting. Other settings visible include heavy duty, bedding, sanitizes, steam refresh, wrinkle control, delicates, rapid dry, and timed dry.

5 ADJUST CYCLE SETTINGS, IF DESIRED*

An illustration of a hand adjusting the 'dry level' control, which has settings for less, normal, and more. Other controls visible include 'timed dry adjust' (minus/plus), 'temperature' (air only), and 'wrinkle prevent' (off, on).

6 SELECT ANY ADDITIONAL OPTIONS*

An illustration of a hand selecting an option from a menu. The menu includes: static reduce, damp dry signal, audio level, sensing, steam, done, and check lint screen.

7 TOUCH AND HOLD START/PAUSE TO BEGIN CYCLE

An illustration of the play/pause button, which is a circle containing a play symbol and a vertical bar, labeled 'hold to start' below it.

* **NOTE:** See "Cycle Guide" in the Use and Care Guide for more information about cycles, settings, and options. Not all cycles, settings, and options are available with all models. Read your Use and Care Guide before using your dryer.

W10743383A
W10743384A - SP

®/™ ©2014 Maytag. All rights reserved. Used under license in Canada.

10/14
Printed in U.S.A.

BRAVOS XL
steam

MCT Maytag Commercial Technology



Guide de démarrage rapide

Comment utiliser votre sècheuse haute efficacité.

L'aspect peut varier selon le modèle.

1 NETTOYER LE FILTRE À CHARPIE

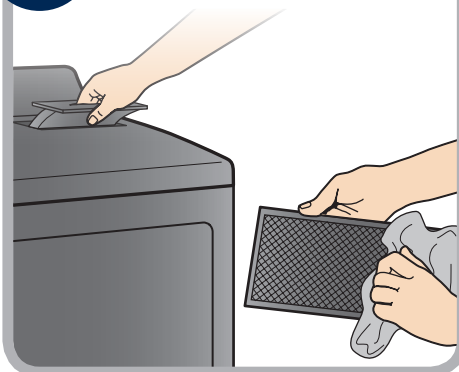

2 CHARGER LA SÈCHEUSE

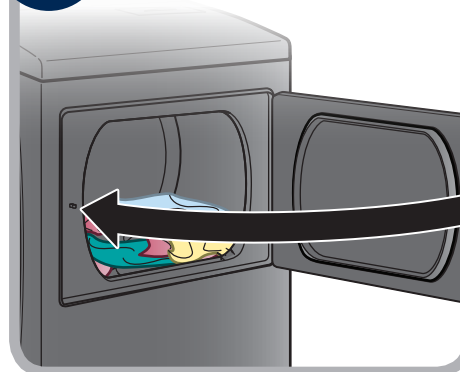

3 APPUYER SUR POWER (MISE SOUS TENSION) POUR METTRE LA SÈCHEUSE EN MARCHÉ



4 SÉLECTIONNER LE PROGRAMME SOUHAITÉ POUR LA CHARGE*



5 AJUSTER LES RÉGLAGES DE PROGRAMME SI DÉSIRÉ*

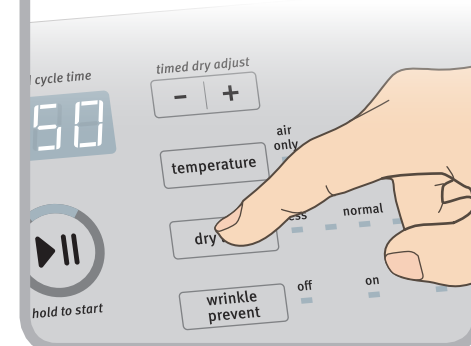

6 SÉLECTIONNER TOUTE OPTION SUPPLÉMENTAIRE*

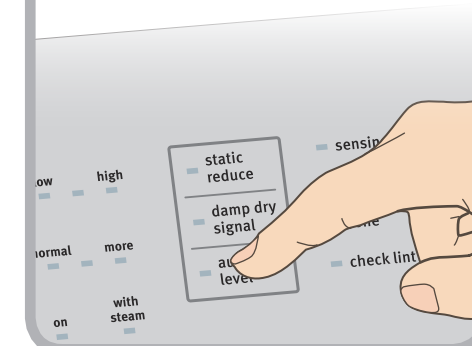

7 APPUYER SANS RELÂCHER SUR START/ PAUSE (DÉMARRER/ PAUSE) POUR DÉMARRER LE PROGRAMME



*REMARQUE : Voir le "Guide des programmes" du Guide d'utilisation et d'entretien pour plus d'informations sur les programmes, les réglages et les options. Certains programmes, réglages et options ne sont pas disponibles sur certains modèles. Lire le Guide d'utilisation et d'entretien avant d'utiliser la sècheuse.

W10743383A
W10743384A - SP

®/™ ©2014 Maytag. Tous droits réservés. Emploi sous licence au Canada.

10/14
Imprimé aux É.-U.