

INSTALLATION INSTRUCTIONS

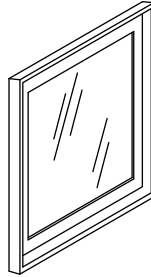

P74204

INSTALLATION INSTRUCTIONS

THANK YOU FOR CHOOSING KALLISTA

We appreciate your commitment to KALLISTA quality products. Please take a moment to review this manual before you install your KALLISTA product. If you encounter any installation or performance problems, please do not hesitate to contact us at the phone number listed at the bottom of the page.

BEFORE YOU BEGIN

- ☐ Prior to installation, unpack the new product and inspect it for damage. Return the product to its protective carton until you are ready to install it.
- ☐ Select the type and number of fasteners based on the wall material. Choose fasteners that will support the weight of the mirror.
- ☐ Install the fasteners to a stud to avoid possible property and product damage. If this is not possible, anchors must be inserted before installing the fasteners.
- ☐ KALLISTA reserves the right to make revisions in the design of products without notice, as specified in the Price Book.

TOOLS AND MATERIALS

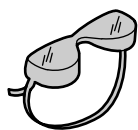

Safety
Glasses

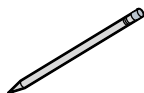

Pencil

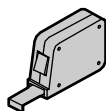

Tape
Measure

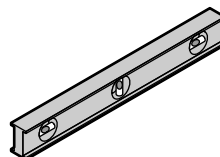

Level



Drill

Plus:

- Fasteners
- Anchors
- Assorted Drill Bits

INSTALLATION INSTRUCTIONS

INSTALL THE MIRROR

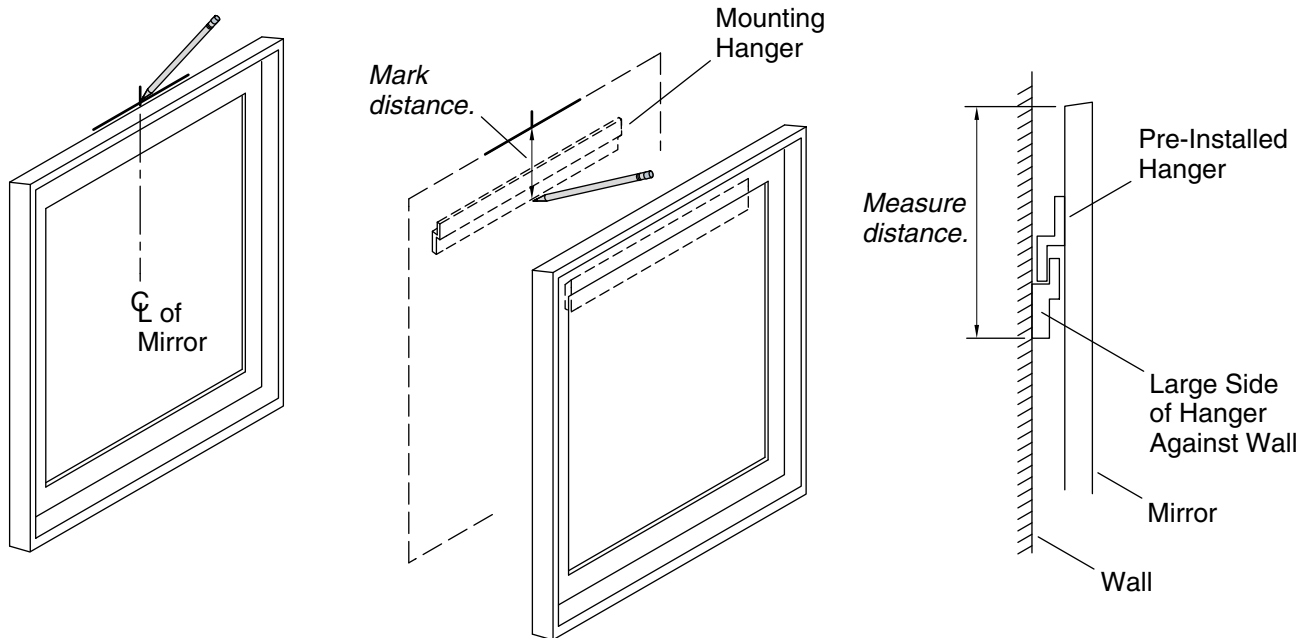

IMPORTANT! Get assistance when determining the placement of the mirror. One person should hold the mirror in place while the other measures and marks the placement.

- ☐ Hold the mirror flush against the wall in the desired position.
- ☐ Using a pencil, mark the top edge of the mirror on the wall.
- ☐ Mark the centerline of the mirror on the line.
- ☐ With the back of the mirror facing you, engage the mounting hanger with the pre-installed mirror hanger.
- ☐ Measure the distance from the top of the mirror to the bottom of the mounting hanger.
- ☐ Measure and mark the same distance down from the centerline mark on the wall. This is the center width mark for the hanger.
- ☐ Position the large side of the hanger against the wall, centered with the center width mark on the wall.

NOTE: If possible, plan the location of the hanger holes to align with wall studs. Determine the number of holes based on the number of fasteners needed to support the weight of the mirror.

- ☐ Mark hole positions on the large side of the hanger, aligning with studs where possible.
- ☐ Drill holes at the marked locations on the hanger.
- ☐ Reposition the hanger against the wall. Make sure the hanger is level.
- ☐ Using a drill bit to accommodate the size of the fasteners (not provided), drill through the holes in the hanger.
- ☐ If the holes were not drilled into studs, insert anchors into the holes.
- ☐ Secure the hanger to the wall with the fasteners.
- ☐ Carefully hang the mirror on the wall so the pre-installed mirror hanger is centered on the mounted hanger. The hangers must interlock.