

---

## INSTALLATION INSTRUCTIONS

P23105-LV, P24005-CL, P24005-CR,  
P24005-KL, P24005-RB, P24005-RL,  
P24105-CR, P24105-LV, P24106-CR,  
P24106-LV, P24406-CR, P24406-LV,  
P24505-LV

## INSTALLATION INSTRUCTIONS

### THANK YOU FOR CHOOSING KALLISTA

We appreciate your commitment to Kallista quality products. Please take a moment to review this manual before you install your Kallista product. If you encounter any installation or performance problems, please do not hesitate to contact us at the phone number listed at the bottom of the page.

### BEFORE YOU BEGIN

- The appearance of your product may differ from the illustrations shown in these instructions, however, the installation procedure is the same.
- Prior to installation, unpack the faucet and drain and inspect it for damage. If the product is damaged, please contact Kallista immediately at the phone number listed at the bottom of the page.
- Observe all local plumbing and building codes.
- Shut off the main water supply.
- Carefully inspect waste and supply tubing for any sign of damage.
- Replace waste or supply tubing if necessary.
- For new installations, install the faucet before installing the bidet.
- Kallista reserves the right to make revisions in the design of plumbing products without notice, as specified in the Price Book.

### TOOLS AND MATERIALS

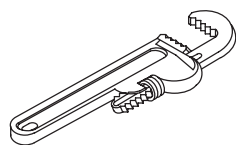

Pipe  
Wrench



Plumbers  
Putty



Adjustable  
Wrench



Thread  
Sealant

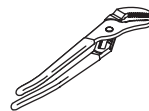

Channel  
Lock Pliers

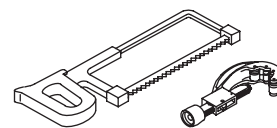

Hacksaw or  
Tubing Cutter

### 1. SPRAY ASSEMBLY INSTALLATION

- Remove the spray head and flange.
- Thread the nut, metal washer, and rubber washer to the bottom of the shank.
- Apply a ring of plumbers putty or other sealant according to the putty manufacturer's instructions.
- From the underside of the bidet, insert the shank through the spray hole.
- From the top of the bidet, thread the flange onto the shank.
- Securely thread the spray head as far as it will go on to the shank.
- Thread the flange until it is snug against the spray head.
- Securely tighten the nut onto the shank with a wrench. Do not overtighten.
- Remove any excess putty or sealant.

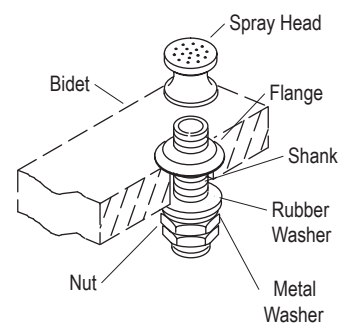

## INSTALLATION INSTRUCTIONS

### 2. LIFT ROD ESCUTCHEON INSTALLATION

- Apply a bead of plumbers putty or other sealant to the underside of the escutcheon according to the putty manufacturer's instructions.
- Insert the escutcheon through the mounting hole from above.
- From the underside of the bidet, slide the washer (tapered side up), brass washer, and nut onto the escutcheon shank.
- Securely tighten the nut with a wrench. Do not overtighten.
- Remove any excess putty or sealant.

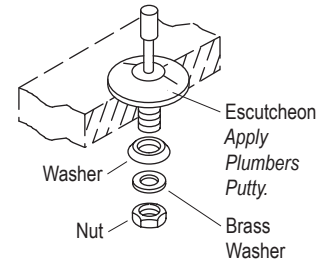

### 3. DRAIN INSTALLATION

- Remove the protective cover from the flange.
- Apply a ring of plumbers putty or other sealant to the underside of the flange according to the putty manufacturer's instructions.
- Assemble the nut, flat washer, and tapered gasket (tapered side up) fully onto the body.
- From the underside of the fixture, insert the drain body up into the drain hole.
- From the top of the fixture, securely hand tighten the flange onto the drain body.
- Make sure the drain body seal hole is facing the back of the fixture, and securely tighten the nut.
- Remove any excess putty or sealant.

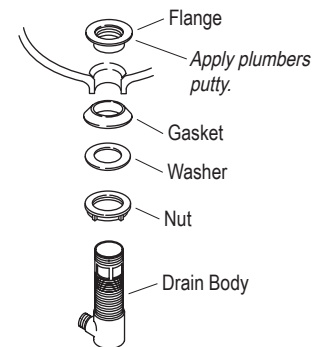

### 4. COMPLETE DRAIN INSTALLATION

- Insert the stopper into the flange.
- For regular installations, insert the short end of the rod into the body seal hole and under the stopper. For vandal-resistant installations, fit the rod through the hole in the stopper. Hand tighten the body nut.
- Remove and adjust the stopper as needed so it lifts about 3/8" (1 cm) when opened. To adjust, rotate the threaded stopper rod in or out as needed. Retighten the stopper nut.
- Apply thread sealant tape to the tail piece threads, and thread the tail piece to the body. Tighten the tail piece securely.
- Slide one end of the clip on to the rod. Slide the link onto the rod with the thumb screw facing the back of the fixture.

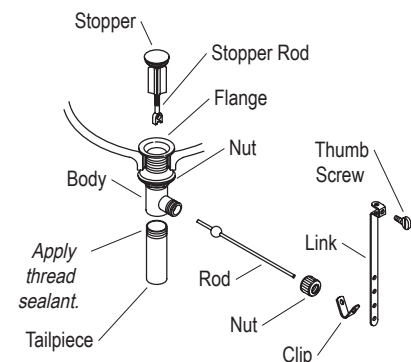

## INSTALLATION INSTRUCTIONS

### 5. HANDLE VALVE INSTALLATION

- ❑ Ensure that the O-ring is installed in the underside of the escutcheon.
- ❑ Remove the washers and nuts from the valve assemblies.
- ❑ Insert the valve assembly hoses through the mounting holes from the top of the bidet. Make sure the valve assembly marked "COLD" is installed in the right-hand hole (as viewed from the front of the bidet).
- ❑ Loosely install the spacers, washers, and nuts to the bottom of the valve assemblies.
- ❑ Rotate the valve assemblies so that the handles are oriented as desired in the off position.
- ❑ Firmly hold the valve assemblies in place and then securely tighten the nuts with a wrench. Do not overtighten.
- ❑ Connect the quick connect fittings to the quick connect tee inlets. Do not use thread sealant. Loop the hoses to avoid kinking them.

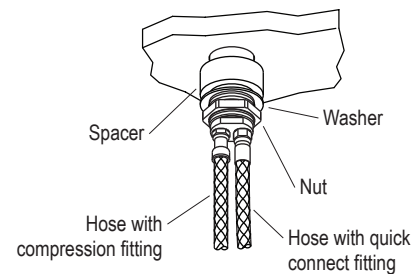
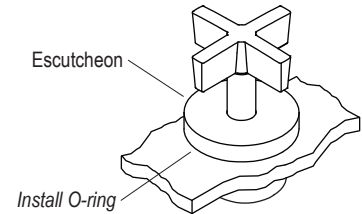

### 6. VALVE/BREAKER INSTALLATION

- ❑ Slide the nut and compression sleeve onto the adapter.
- ❑ Apply thread sealant onto the bottom threads of the adapter. Thread the adapter onto the bottom of the transfer valve shank. Securely tighten the nut.
- ❑ Apply thread sealant onto the short end threads of the pipe fitting. Thread the pipe fitting onto the side of the transfer valve shank.
- ❑ Apply thread sealant onto the long end threads of the pipe fitting. Thread the flexible hose onto the pipe fitting.
- ❑ Slide the sealing washer (tapered side up) onto the transfer valve.
- ❑ From the underside of the bidet, insert the transfer valve into the mounting hole.
- ❑ From the front of the bidet, rotate the transfer valve until the pipe fitting faces toward the right.
- ❑ From the top of the bidet, slide a sealing washer (tapered side down), flat washer, and plastic nut onto the transfer valve. Securely hand tighten the plastic nut.
- ❑ From the front of the bidet, rotate the valve stem counterclockwise. Slide the spline insert onto the valve stem.
- ❑ Thread the escutcheon onto the plastic nut.
- ❑ Rotate the handle until the pointer faces the front of the bidet. Press the handle onto the spline insert.

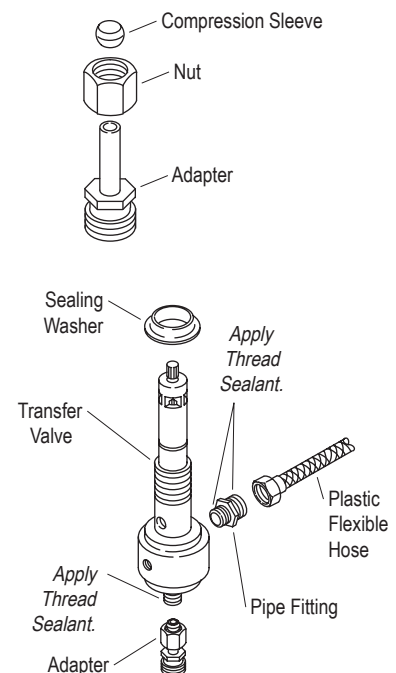

## INSTALLATION INSTRUCTIONS

### 7. FLEXIBLE HOSE INSTALLATION

- Apply thread sealant onto the threads of the spray shank. Connect the flexible hose from the transfer valve onto the spray shank.
- Connect the supply hoses to the supply tee via the quick-connect fittings.
- Insert a rubber gasket and nylon washer into the supply tee outlet.
- Thread a flexible hose into the supply tee outlet.
- Slide the gasket onto the transfer valve/vacuum breaker shank.
- Connect the flexible hose from the supply tee outlet onto the transfer valve/vacuum breaker shank.

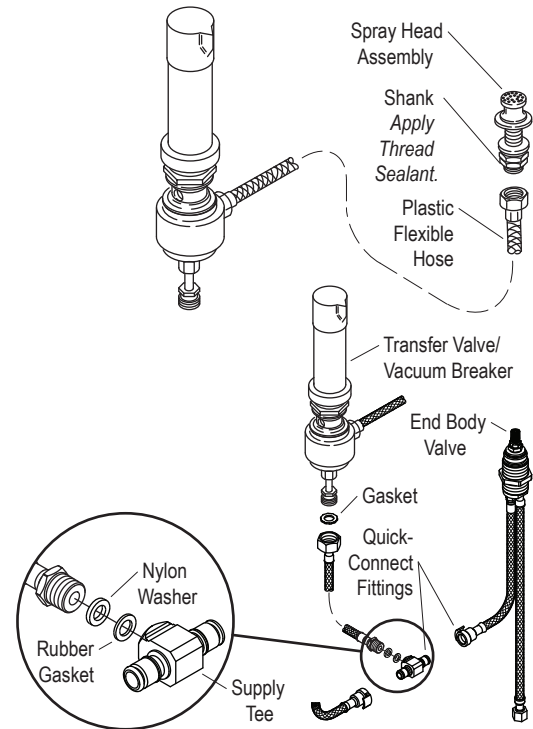

### 8. SUPPLY CONNECTIONS

- Connect the supply hoses from the valve assemblies to the supply stops. (Left is hot - right is cold).
- Tighten all connections.

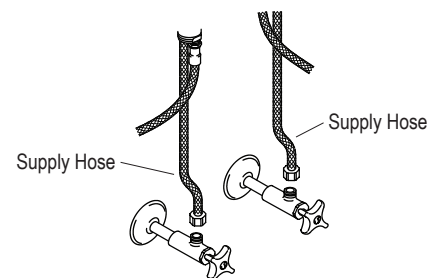

### 9. INSTALLATION CHECKOUT

- Connect the tailpiece to the P-trap (as needed).
- Ensure that all connections are tight.
- Open the drain.
- Turn on the main water supply and check for leaks. Repair as needed.
- Remove the spray head.
- Open both the hot and cold valves and run water through the transfer valve and spray assembly for about a minute to remove debris. Check for leaks.
- Turn off the water.
- Reinstall the spray head.

