



EMERSON COLLEGE

Office of the Arts

Technical Information

Cutler Majestic Theater

Version 2.4
October 2013

Table of Contents

Introduction	4
Contact	5
Staff List	6
Directions	7
Address:	7
Driving Directions for Trucks:.....	7
Facilities	9
Dimensions-at-a-Glance:	9
Loading Dock (Allen’s Alley):	10
Stage Door:	10
Stage:	10
Orchestra Pit:	11
Front of House:	11
Visiting Company Office:.....	11
Dressing Rooms and Green Room:.....	11
Wardrobe Room:.....	12
Stage Carpentry	13
Stage Floor:.....	13
Flammables and MSDS:	13
Equipment Inventory:	14
Stage Rigging	15
Counterweight System:.....	15
Pin Rail:	15
Gridiron:	16
Soft Goods:	16
Lighting	17
Console:	17
Dimmers:	17
Additional Power:	17
Front of House Positions:.....	18
Stage Positions:.....	18
Inventory:.....	19
Audio	21
Overview:	21
Mix Position:	22
Audio System Operation:.....	22
Audio Intercom System Description:.....	24
Audio Monitor System:	24
Assistive Listening System:	25
Specifications:.....	25
Inventory:.....	25
Video	28
Overview:	28
Video Recording:.....	28
Projectors:	28
Fall Protection	29
Fall Arrest System Locations:.....	29
Fire and Safety Regulations	30
Drapery Permits:.....	30

Special Effects Permits: 30
Firearms: 30
Appendices..... 31
Appendix A – Line Set Schedule..... 32
Appendix B – Majestic Ground Plan 34
Appendix C – Venue Photos..... 35

Introduction

The Cutler Majestic Theater was built in 1903 as one of the cornerstones of Boston's Theater District. Since its acquisition by Emerson college in 1983, the Majestic has undergone a series of renovations, completed in 2003, making it a 21st Century Theater inside a 19th Century Historic Landmark.

As a space originally built for Opera, the Majestic has outstanding acoustics and a large house, capable of seating 1,200 patrons in an Orchestra, Mezzanine and Balcony, all with unobstructed view of the stage. The theater is equipped with forty-seven single-purchase counterweight line sets, a removable orchestra pit and a trap room with five removable plugs. There are four galleries, two stage left and two stage right. As part of the renovation, there is a new Gridiron of I-Beams beneath the original grid capable of supporting increased loads.

Contact

Please direct all mail to the following address. No deliveries can be accepted at the Majestic without prior discussion and approval from the Office of the Arts.

Office of the Arts
Emerson College
120 Boylston Street
Boston, MA 02116

Administration: (617) 824 – 8030
Ticket Office: (617) 824 – 8000

Staff List

General Manager	Bonnie Baggesen (617) 824-8363 bonnie_baggesen@emerson.edu
Senior Production Manager	Scott Wallace (617) 824-8371 scott_wallace@emerson.edu
Director of Technical Operations	Warren West (617) 824-8185 warren_west@emerson.edu
Lighting and Projections Supervisor	Garrett Herzig (617) 824-8037 garrett_herzig@emerson.edu
Audio Supervisor	Stuart Beacham (617) 824-8728 stuart_beacham@emerson.edu
Production Operations Manager	Brittany Burke (617) 824-8038 brittany_burke@emerson.edu
Associate Technical Director	Ben Clark (617) 824-8729 benjamin_clark@emerson.edu
Assistant Lighting Supervisor	Dan Carr (617) 824-3073 daniel_carr2@emerson.edu

Directions

Address:

The Majestic is located at:

219 Tremont Street
Boston, MA 02116

Driving Directions for Trucks:

The following directions are for trucks to reach the Loading Dock. Driving Directions to the Theater for passenger vehicles can be found on the Office of the Arts Website.

From North of Boston via Interstate 93

- Take **I-93 South** to **Exit 24B-A** toward Rt-1A North / Airport / Government Center.
- Take **Exit 24-A** toward Government Center, 0.1 mile.
- Turn **Left** onto Surface Road, signs for North End, 0.1 mile.
- Turn **Right** onto State Street, 0.2 mile, which becomes Court Street.
- Turn **Left** onto Tremont Street. The Majestic will be on your **Right** in 0.6 mile.
- The **Loading Door** is in Allen's Alley, just before the theatre.

From the South via Interstate 93

- Take **I-93 North** to **Exit 20** toward I-90/Logan Airport/Worcester/S. Station.
- Stay **Right** toward I-90 West/Worcester/S. Station, 0.4 mile, following signs to **South Station/Chinatown**.
- Take the **Exit on the Left** toward South Station/Chinatown, 0.4 mile.
- Turn **Left** onto Kneeland Street at the end of the ramp, 0.2 mile.
- Follow the road as it **swings Right** and becomes Charles Street, 0.2 mile.
- Turn **Right** at the next light onto Boylston Street, 0.1 mile.
- Turn **Right at the next light** onto Tremont Street, 0.2 mile. The Majestic will be on your **Right**.
- The **Loading Door** is in Allen's Alley, just before the theatre.

From the West via Interstate 90 / Mass Turnpike

- Take **I-90 West** to **Exit 22** toward Copley Square and stay right at the fork in the tunnel.
- Exit the tunnel and turn **Left** at the first light, onto Dartmouth Street.
- At the 2nd light turn **Right** onto Boylston Street. Stay Right, go through 5 lights.
- At the 6th light turn **Right** onto Tremont Street. The Majestic will be on your **Right**.
- The **Loading Door** is in Allen's Alley, just before the theatre.

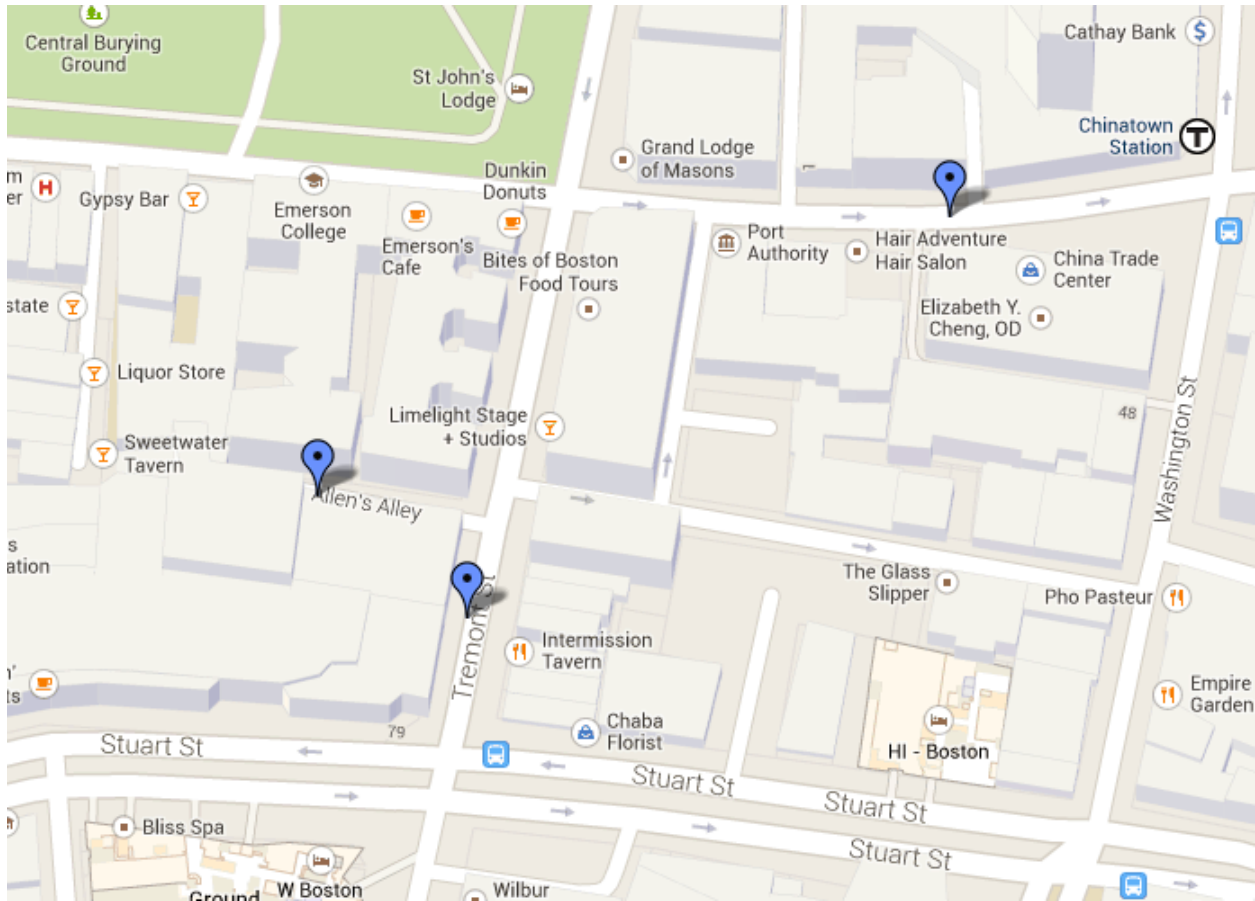

- Two of the locations above indicate the Front of House Entrance and the Loading Dock for the Theatre
- Additionally it indicates the nearest and most affordable parking garage.

Parking:

There is no adjacent parking available for any Office of the Arts venue. Trucks cannot stay in any loading zone beyond the time necessary for loading.

Street parking is extremely rare. There is a parking garage *for personal vehicles only* located at 47 Boylston Street between Tremont and Washington.

Facilities

Dimensions-at-a-Glance:

Description	Dimension	
	Imperial	Metric
Proscenium Opening Width	38' – 6"	11.73 m
Proscenium Opening Height to Top of Arch at Center Line	31' – 3"	9.53 m
Stage Floor to the bottom of the speaker cluster	23' – 6"	7.61 m
Stage Floor to Spring point of Arch	19' – 0"	5.79 m
Stage Right Locking Rail to Stage Left Stairs (unobstructed deck)	64' – 3"	19.58 m
Center Line to Stage Right 1st Gallery	24' – 11"	7.59 m
Center Line to Stage Left 1st Gallery	24' – 11"	7.59 m
Center Line to Stage Left 2nd Gallery	26' – 7"	8.10 m
Center Line to Locking Rail Stage Right	32' – 6"	9.91 m
Center Line to Stairs Stage Left	31' – 8"	9.65 m
SL Pin Rail to SR Pin Rail at 1st Gallery	50' – 0"	15.24 m
Plaster line to back wall on Center Line	35' – 5"	10.79 m
Plaster line to lip of stage on Center Line	3' – 10"	1.17 m
Plaster line to edge of pit infill on Center Line (kills 14 seats)	9' – 2"	2.79 m
Stage floor to bottom of Gallery duct (clearance)	21' – 11"	6.63 m
Stage Floor to 1st Gallery Floor	26' – 6"	8.08 m
Stage Floor to 2nd Gallery Floor	40' – 10"	12.44 m
Stage Floor to top of Grid, old Steel	74' – 1"	22.58 m
Stage Floor to top of New Steel	72' – 4"	22.05 m
Stage Floor to bottom of New Steel	70' – 11"	21.62 m
Highest batten trim	61' – 11"	18.87 m
Plaster Line to Center of 1st Row, Orchestra	8' – 0"	2.43 m
Plaster Line to Last Row, Orchestra	63' – 0"	19.20 m
Plaster Line to Front Edge of Mezzanine (lower balcony)	45' – 10"	13.97 m
Plaster Line to Back of Mezzanine (lower balcony)	94' – 6"	28.80 m
Plaster Line to Front Edge of (2nd) Balcony	58' – 3"	17.75 m
Plaster Line to Back of (2nd) Balcony	90' – 0"	27.43 m
Orchestra Pit Floor to Stage Floor	9' – 1"	2.77 m
Orchestra Pit Infill at House Level to Stage Floor	3' – 6"	1.07 m
Loading Door, Width	10' – 0"	3.05 m
Loading Door, Height	14' – 3"	4.34 m

Loading Dock (Allen's Alley):

Allen's Alley is 24'-6" drivable width on the north side of the Majestic. Loading dock has an overhang for weather protection and room for two trucks maximum. Alley may also be used for loading, and handles two trucks if loading dock is not used. Stage is at pavement level with a sidewalk between alley and stage. Majestic has one ramp 4' – 2" wide used to cross the 3" lip from stage to sidewalk. A ramp, lift gate or fork lift is needed to off load from a truck. Two trucks may be unloaded at the same time.

All deliveries to the loading dock must be coordinated with the Office of the Arts prior to arrival or they will be refused. All trucks must obtain a dock slot prior to arrival and can remain only as long as necessary for loading. Absolutely no parking or storage is allowed in Allen's Alley.

Stage Door:

Entrance on the north side of the theatre just past the Loading Door on Allen's Alley. The stage door is secured and staffed whenever the Majestic is open.

A complete list of performance and production personnel must be provided to the Office of the Arts Production Staff 30 days prior to the Company's arrival.

Stage:

The Majestic stage has multiple points of entrance/exit. There are three doorways along the back wall, one Stage Left, one Stage Right and a double door at Center. The Stage Left and Stage Right doors each have another set of doors to act as a light and sound lock. Up Stage Left is where the roll-up Loading Door is located. The galleries are accessed from stair cases on either side of the stage. The Stage Right stairs can also access the basement. Additionally, there is a pass-through door to the House Down Stage Right. Down Stage Left is an emergency exit to Allen's Alley as well as access to stairs that lead to the basement.

The forty-seven line sets are run from the locking Rail Stage Right. They can also be operated from the lower Stage Right gallery. All four galleries can serve as Pin Rails. There is a Loading Bridge above the Stage Right galleries.

The orchestra pit cover is a Wenger platform system that may be raised to stage level. House normal has the pit cover at house seating level with 14 fixed chairs installed, and must be restored at load-out. The infill may not be drilled into, screwed into, painted, or modified. Contact the Office of the Arts Director of Technical Operations for more information.

Orchestra Pit:

The Orchestra Pit has a curved front and a flat floor, 500 sq. ft. It accommodates as many as 50 players. Trap room doubles as musician waiting room. It is adjacent, through double doors. 4 toilets are adjacent. All spaces are wheelchair accessible. The Wenger Pit Infill adjusts from deck to house to basement; house normal is at house main seating level with 14 fixed chairs.

Front of House:

Access from the Stage to the House is available through the Pass Door Stage Right. There are also two sets of removable stairs that allow direct access from the house to the apron of the stage. These stairs bridge the Orchestra Pit.

The Majestic house consists of an Orchestra, Mezzanine and Balcony sections. Standard configuration without any seat kills is 408 in the Orchestra, 436 in the Mezzanine and 278 in the Balcony as well as 64 in the Boxes. There is a mix position at the rear of the Orchestra. There is no control booth in the Majestic.

There are eight lighting positions spread throughout the house. These are the Mezzanine Rail at the front of the Mezzanine, the Catwalks at the rear of the Balcony, two Truss Towers at the front of the Balcony, and four Box Boom positions mounted above the House Boxes.

Visiting Company Office:

Located Down Stage Left is the stair well for accessing the lower Stage Left gallery. This stairwell also provides access to the Visiting Company Office as well as the Amp Room. This office may be used by visiting companies and is outfitted with WiFi and a telephone line.

Visiting Company Office telephone number: 617-824-8731

Dressing Rooms and Green Room:

Located in the Basement adjacent to the trap room. All are wheelchair accessible with elevators to stage level and below stage. All are equipped with stage monitor speakers.

- 2 Chorus Rooms
 - o Each: 12'W x 29'L, holding 18 and 21 artists, equipped with Counters, Mirrors, Mirror Lights and Shelves
 - o Each: dedicated restrooms with showers
- 2 Star Dressing Rooms
 - o Each: 9'W x 9'L, holding 3 artists each, equipped with Counter, Mirror, Mirror Lights and Shelves
 - o Each: dedicated restroom with shower
- Green Room
 - o Lounge area with Video Program Feed
 - o Kitchenette with Sink, Microwave and Refrigerator, Coffeemaker, Hot Water Kettle

Wardrobe Room:

Located in close proximity to the Dressing Rooms and Green Room.

- (1) Washing Machine
- (1) Dryer
- (6) Z Racks

Stage Carpentry

Overview:

No construction is allowed on stage, in the loading dock, the loading zone, or anywhere on the premises. Any retrofit work necessary for the installation of a production must be approved by the Office of the Arts. **No aerosol paints, stains or dyes are allowed anywhere in the Majestic; this includes for painting props or spraying shoes.**

Stage Floor:

The Majestic stage floor is sprung. The surface is 3/4 HDO plywood painted flat black. It is suspended on a dynamic resilient system of 3/4" plywood over 2"x4" sleepers on 16-inch centers on 3/4" NeoShok resilient pads over a poured concrete base. There are five removable traps.

The stage floor can be drilled and screwed into (including lags), as well as painted as required. Upon load out the floor must be restored. This includes all holes plugged with dowels and glue, and cut flush to the stage deck. A uniform coat of flat black paint, as specified by the Office of the Arts, must be applied if the deck is painted. If glossy paint was used on the stage deck, it must be sanded before it is repainted. All damage from tape, scenery, or other work must be repaired and repainted.

Flammables and MSDS:

All flammable chemicals, including wardrobe and make-up supplies must be properly stored. Advanced notification must be made to the Office of the Arts before any flammable or otherwise hazardous material is brought into the Majestic. The Office of the Arts reserves the right to prohibit any hazardous material from being used or brought into the venue. All such materials must be removed or properly disposed of upon the load out of a production. Appropriate Material Safety Data Sheets must be provided.

Equipment Inventory:

The following equipment is available for use.

Confirm all Inventories with the OA Director of Technical Operations.

Lifts and Ladders:

<u>Quantity</u>	<u>Height</u>	<u>Type</u>	<u>Specification</u>
1	36'	Genie Lift	Fiberglass Bucket
1	27'	A-Frame Extension Ladder	Wooden, Type II
2	12'	Stepladder	Fiberglass, Type IA
1	10'	Stepladder	Fiberglass, Type 1A
1	6'	Stepladder	Fiberglass, Type 1A
2	24'	Extension Ladder	Fiberglass, Type 1A

All Office of the Arts equipment must be used in a safe and conscience manner. All OSHA regulations must be followed in use of Lifts and Ladders.

Furniture:

<u>Quantity</u>	<u>Type</u>
50	Music Stands
40	Folding Chairs
2	30" by 8' Folding Table
2	30" by 6' Folding Table
2	18" by 6' Folding Table

Stage Rigging

Overview:

There are 47 counterweight line sets in the Majestic, as well as Pin Rails at all four galleries. The new grid of Majestic, mounted beneath the old grid, can support spot rigging with Chain Motors. Additionally, there is permanently installed Tab Masking hung on track beneath both the Stage Left and the Stage Right lower galleries.

A full line set schedule for the Majestic is attached to this document as Appendix A.

Counterweight System:

The counterweight system is comprised of 1.5" Schedule 40 Pipe supported by five pick lines that run to Loft Blocks under-hung beneath the New Grid. The arbors are single-purchase and run between the Loading Bridge and Stage Level. Additional weight is stored on the Stage Right galleries as well as beneath the Tension Blocks on the stage deck. (Note: Fall Arrest Equipment required when loading weight. See the Fall Protection section for more information.)

Important Facts:

Batten Length	45' – 0"	13.72 m
Trim, Max In (Bottom of Batten)	4' – 6"	1.37 m
Trim, Max Out (Bottom of Batten)	61' – 11"	18.87 m
Maximum Capacity	1200 lb	540 kg
Batten Max Point Load	150 lb	65 kg

Pin Rail:

Hemp lines can be run from any of the Galleries, though typically only the lower Galleries are used. Head and loft blocks are mounted to the steel of the higher, Old Grid along Unistrut troughs. Head blocks are installed Stage Left.

Important Facts:

Maximum Capacity	500 lb	225 kg
Distance of Troughs from SL Head Block:		
1 st Trough	4' – 3"	1.30 m
2 nd Trough	11' – 9"	3.58 m
3 rd Trough	27' – 9"	8.46 m
4 th Trough	43' – 9"	13.34 m
5 th Trough	52' – 11"	16.13 m

Gridiron:

The Grid is divided into the Old Grid, original to the Majestic, and the New Grid, part of the 2003 renovation. The New Grid is accessed via traps in the Old Grid. Clearance between the two varies but averages around 2' – 0". Fall Arrest equipment is absolutely required when Up Rigging from the New Grid.

Important Facts:

Stage Floor to Lowest Point of New Grid	70' – 11"	21.62 m
Stage Floor to Highest Point of New Grid	72' – 4"	22.05 m
Stage Floor to Highest Point of Old Grid	74' – 1"	22.58 m
Maximum Point Load, New Grid	1500 lb	680 kg

Soft Goods:

The following inventory indicates the standard for the Majestic. All availability is subject to change. Current inventories must be confirmed with the Office of the Arts. Additionally, all draperies must undergo a certification process with the Boston Fire Department before installation. More details can be found in the Fire and Safety Regulations section.

Confirm all Inventories with the OA Director of Technical Operations.

Inventory:

<u>Quantity</u>	<u>Description</u>	<u>Height</u>	<u>Width</u>	<u>Weight</u> (in Full Bricks)
4	Black Out Panels	36'	25'	3
14	Legs	32'	12'	2.5 for a pair
2	Tall Legs	36'	12'	3 for a pair
5	Borders	12'	50'	3
1	Tall Border	15'	50'	3.5
14	Tabs	24' – 6"	4'	1.5 for a pair
1	Black Scrim	32'	45'	1.5
1	White Scrim	32'	45'	1.5
1	White Cyc (Leno Filled Scrim)	36'	50'	2.5
1	Bounce Cyc	36'	50'	2.5

The Majestic has a permanently hung Grand Drape on the first line set.

Lighting

Overview:

The Majestic lighting system provides over three hundred dimmers divided between the stage and eight front of house positions. Control is provided by an ETC Ion console. There are also provisions for two spot positions from the balcony. House lights are controlled by a separate ETC Unison system. Aisle lights are always-on.

The available inventory for the Majestic includes over three hundred instruments with a commensurate stock of cable and accessories. Provisions for DMX and Ethernet are also available.

Confirm all Inventories with the OA Lighting Supervisor. Any rental equipment must also be cleared with the Lighting Supervisor.

Console:

ETC Ion, version 2.0.1

- Fader Wing
- Remote Video Interface with Two Monitors
- Wireless Radio Focus Remote, version 2.0.8

Dimmers:

Front of House:

- ET/IPS Dimmer Sticks
- 156 @ 2.4kw per Dimmer
- Dimmers 1-48 are Reserved for House Architectural Lighting only
- Distributed over catwalk, two balcony truss positions, two box boom positions, and mezz rail
- All dimmers hardwired dimmer-per-circuit

Onstage:

- 2 x 96 ETC Tour Racks on Stage Left 1st Gallery
- 2.4 kW per dimmer, CEM+
- 16 @ Socapex inputs, 96 Stage Pin inputs
- 8 @ Stage Pin 20 amp Convenience Outlets
- 2 @ Edison 20 amp Convenience Outlets

Additional Power:

Stage Level:

- 1 Company Switch, Located on deck
- 200 amp, 3 phase, CAM-Lock connectors, Dedicated Ground

Lower Stage Left Gallery

- 1 Company Switch

- 400 amp, 3 phase, CAM-Lock connectors
- Requires 50' Cam Lock tails to reach the deck

Front of House Positions:

Catwalk

- The position mounted to the rear wall of the Balcony
- Single pipe for hanging
- Total of 24 Dimmers available
- Fall Arrest Equipment must be used while working at this positions

Follow Spots

- Two platforms, approximately halfway up the Balcony, House Left and Right

Truss Towers

- 16' Tall vertical triangular trusses located at the front of the Balcony, House Left and Right
- Six rungs for hanging up to 14 instruments
- 12 Dimmers available at each Tower
- Fall Arrest Equipment must be used while working at this positions

Mezzanine Rail

- 1.5" Schedule 40 Pipe mounted along front of Mezzanine
- Pipe is approximately 40' long
- Total of 24 Dimmers available
- Fall Arrest Equipment must be used while working at this positions

Box Booms

- Five-rung ladders mounted above and between the center two upper house boxes, House Left and Right
- Each holds 12 instruments
- 18 Dimmers at each Boom

Throw Distances:

(All measurements are taken from intersection of Plaster Line and Center Line.)

Catwalks	110' – 10"	33.78 m
Follow Spots	92' – 2"	28.09 m
Truss Towers	61' – 9"	18.82 m
Mezzanine Rail	45' – 10"	13.97 m
Box Booms	41' – 6"	12.65 m

Stage Positions:

Line sets:

- There are a total of 47 line sets in the Majestic, 46 of which are available for use; see Stage Rigging section for more information
- The dimmers are located on the Stage Left Lower Gallery

Inventory:

The following inventories are subject to change. **Confirm all inventories with the OA Lighting Supervisor.**

Instruments:

(All instruments come with Clamp, Safety Cable and Color Frame. All Source Four units are 575w unless noted)

<u>Type</u>	<u>Quantity</u>	<u>FOH Rep</u>
S4: 5 degrees 750w	24	24
S4: 10 degrees	20	20
S4: 19 degrees	50	16
S4: 26 degrees	58	4
S4: 36 degrees	58	4
S4: 50 degrees	26	
S4: Par with Lens Kit	90	
Colortran: 6" Fresnel, 1k	10	
Colortran: 8" Fresnel, 2k	10	
L&E: Broad Cyc, 3 cell, 1kw/cell	6	
L&E: 6' Ministrip, 3 circuit, 12v/75w	8	

Cable:

<u>Type</u>	<u>Length</u>	<u>Quantity</u>
Stage Pin (2P & G)	5'	20
	10'	28
	25'	25
	50'	20
Stage Pin Two-fers (2P & G)		25
Socapex 6x2k Multicable	10'	4
	25'	13
	50'	23
	100'	13
Socapex 6x2k Break-Outs	Staggered	38
Socapex 6x2k Break-Ins	6'	4

Accessories:

(Floor bases are shared between other spaces, please contact the Lighting Supervisor for availability)

<u>Type</u>	<u>Instrument</u>	<u>Quantity</u>
6.5" Tophat	S4 Leko	43
7.5" Barndoors	S4 Par	30
7.5" Barndoors	6" Fresnel	10
10" Barndoors	8" Fresnel	10
A-size Template Holder	S4 Leko	75
B-size Template Holder	S4 Leko	25
Donuts	S4 Leko	10
Drop-in Iris	S4 Leko	7
Cue Lights		8
Cue Light Control Console		1
Single T, 18" Side Arm		60
Floor Base		14

Audio

Overview:

The Majestic Theatre Sound System is comprised of a Center line array hung in the proscenium arch that provides coverage for the mezzanine and the rear orchestra section as well as the front of the balcony. The array is comprised of (10) EAW NTL 720 powered speakers. Two EAW SB 1001 subwoofers are also available. There are side fill loud speakers (2 @ EAW JF-290) mounted to the proscenium at the orchestra level to provide a stereo image. A front fill system (4 @ EAW JF-60) on the apron of the stage fills in the first few rows below the coverage pattern of the main cluster and helps to locate sound from the stage. Four delay speakers (4 @ EAW JF-80) are mounted in the ceiling of the Mezzanine and two loud speakers (4 @ EAW AS690e) per side on each side of the Balcony. Soundweb processors that are preconfigured for optimal equalization and time alignment digitally control all of these systems.

The system includes permanent wiring flexible enough to accommodate events ranging from a single microphone to productions using up to 48 (of 60 available) mic lines. Microphone lines are accessed through 12 channel stage boxes that plug into multi-pin connectors on panels located in the Orchestra Pit (panel #C121: two 12-channel connectors), Stage Left (C102) and Stage Right (C101). In addition the panels contain a 12-ch line level multi-pin connector that terminates at the patch bay. The 48 microphone lines in C101 (stage right), C102 (stage left), and C121 (Orchestra pit), normal through the patch bay in the main amplifier room to four 12-ch multi-pin connectors in a panel located in the plenum (C171) below the house rear mix position. Two of these multi-pin connectors can be connected to multi-pin-to-fan cables (the theater owns two 12-channel multi-pin-to-fan cables) and pulled up through access holes in the floor at the rear house mix position to provide 24 microphone lines for connection to a console. A 16-ch fan-to-multi-pin connects console outputs to the system inputs at the same plenum panel. Fan channels #1-8 (female XLR-3) normal through the patch panel to the 8 system digital signal processing (DSP) inputs, and #9-16 (1/4" TRS (balanced phone connector)) terminate at the patch bay for other uses.

The plenum panel (C171) also provides 12 combination XLR/TRS connectors, 10 of which normal through the patch bay to 10 channels of amplifiers whose outputs can be patched to 20 available loudspeaker receptacles located at panels C101 (stage right), C102 (stage left), C121 (Orchestra pit), and C171 (plenum), all with four each, and the on stage left and right first galleries (2 each). Intercom, Video, and TV connectors are also available on C101 (stage right), C102 (stage left), C121 (Orchestra pit), and C171 (plenum) panels. Available at plenum, panel C171 is a multi-pin connector for a portable communications station normally used during rehearsals at the center house tech position, which duplicates the function of the backstage left panel, including Intercom, Stage Announce, Priority page to Backstage monitor systems, Backstage Program Mute, and Audience Recall Start.

Confirm all Inventories with the OA Audio Supervisor.

Mix Position:

The standard mix position is in the rear of the house right orchestra seating section, rows P and Q seats 2-12. There are four floor pockets in this location to access the system panel in the plenum located directly below the mix position.

Control consoles such as sound and lighting may not be placed on stage in locations that restrict access to breaker panels and control racks. The house boxes should not be used as there is no permanent wiring of any kind to these locations.

Audio System Operation:

System operation can be as simple as a single microphone connected to a built-in automatic mixer or an outboard single output manual mixer routed as one mix to all 8 sub-systems, as complex as 40 microphones independently routed through an outboard mixer (Yamaha M7CL-48) as 8 separate mixes to 8 predefined sub-systems, or a number of variations in between.

Eleven presets have been provided to accommodate numerous possible requirements visiting road shows might have. These presets are selected by a pushbutton panel in the main amplifier rack. Presets 1 through 8 relate to the number of separate feeds into the system from the Console Output multi-pin fan; the more feeds, the more control the console operator has over the separate sub-systems. Preset 1 requires only 1 input to feed all 8 sub-systems (output fan connector #1); preset 2 requires 2 inputs (output fan connector #'s 1&2); etc. The configurations are as follows:

NOTE: SELECTING A PRESET DE-SELECTS THE PREVIOUSLY ACTIVE PRESET

Preset 1:

- Fan #1 = All 8 sub-systems.

Preset 2:

- Fan #1 = House Left Fill
- Fan #2 = House Right Fill
- Sum of Fan #1&2 = Stage Lip, Mezzanine Fill, Balcony Fill, Cluster & Subs

Preset 3:

- Fan #1 = House Left Fill
- Fan #2 = House Right Fill
- Fan #3 = Stage Lip, Mezzanine Fill, Balcony Fill, Cluster & Subs

Preset 4:

- Fan #1 = House Left Fill
- Fan #2 = House Right Fill
- Fan #3 = Stage Lip
- Fan #4 = Mezzanine Fill, Balcony Fill, Cluster & Subs

Preset 5:

- Fan #1 = House Left Fill
- Fan #2 = House Right Fill
- Fan #3 = Stage Lip
- Fan #4 = Mezzanine Fill & Balcony Fill

- Fan #5 = Cluster & Subs

Preset 6:

- Fan #1 = House Left Fill
- Fan #2 = House Right Fill
- Fan #3 = Stage Lip
- Fan #4 = Mezzanine Fill
- Fan #5 = Balcony Fill
- Fan #6 = Cluster & Subs

Preset 7:

- Fan #1 = House Left Fill
- Fan #2 = House Right Fill
- Fan #3 = Stage Lip
- Fan #4 = Mezzanine Fill
- Fan #5 = Balcony Fill
- Fan #6 = Mono Subs
- Fan #7 = Cluster

Preset 8:

- Fan #1 = House Left Fill
- Fan #2 = House Right Fill
- Fan #3 = Stage Lip
- Fan #4 = Mezzanine Fill
- Fan #5 = Balcony Fill
- Fan #6 = Left Sub
- Fan #7 = Right Sub
- Fan #8 = Cluster

Presets 9, 10, and 11 disable the Fan inputs and, instead, enable an 8 input automatic mixer whose inputs are located down stage right at panel C101, XLR Mic Inputs E1-E4, and down stage left at panel C102, XLR Mic Inputs E5-E8. The presets feed these microphones to the sub-systems as follows:

Preset 9:

- Mics E1-8 to HL, HR, Stage Lip, Full Cluster, Mezzanine, and Balcony

Preset 10:

- Mics E1-8 to HL, HR, Stage Lip, Full Cluster, and Mezzanine (NO Balcony)

Preset 11:

- Mics E1-8 to HL, HR, Stage Lip, and Full Cluster (NO Mezzanine or Balcony)

Button #12:

- This is NOT a preset. It is a MUTE Switch that interrupts the program feed to the Front of House and Back of House monitor systems, as well as the Hearing Assistance System (normally derived from whatever is fed to the Cluster) and replaces it with a feed from the Mezzanine Rail Monitor Microphone. In normal operation (un-muted, LED OFF), the

Monitor systems automatically switch to the Mezzanine Rail Microphone in the absence of signal to the Cluster (i.e. Console Outputs Muted.)

Audio Intercom System Description:

The Communication System consists of a 4-channel Clear-Com MS-440 Master Station located in the down stage left floor rack (PCP) wired to receptacles in the stage right (C101), stage left (C102), orchestra pit (C121), rear mix position (C171), and house center (C172) connector panels as well as individual 4-channel receptacle plates located throughout the theatre for use with Clear Com belt packs and headsets. Using the stage PCP rack also provides a front panel latching switch to "Mute" program audio to the backstage system when required, as well as a switch to start playback of a digitally recorded "Audience Recall" message in the front-of-house Lobby system, automatically overriding the Lobby program source, (VCR or Theatre Program, selectable in the Box Office, which also has an "Audience Recall Start" button. Note that House Management MUST initiate audience recall, as they are the only personnel able to assess crowd and safety situations in the house).

The "Announce" button on the MS-440 allows a microphone or headset connected to the station to page into the dressing room/backstage program monitor system by muting program and overriding volume controls in the "Trap" and "Ready" rooms and in the stage left offices during pages.

A Clear-Com RM-440 remote station (A) in a portable rack that also contains "Program Mute" and "Audience Recall Start" switches can be connected via a multi-pin cable to the plenum C171 panel to provide all of the functions of the PCP rack station at the Center House Mix location during rehearsals.

Intercom Channels Allocation:

Clear-Com 4 Channel intercom system w/MS-440 Base Station.

- Channel A is for general communication to run crew.
- Channel B is usually set aside for Lighting.
- Channel C is usually A/V.
- Channel D is reserved for house management communications.

Audio Monitor System:

The 70 volt monitor system is powered by a 4-channel QSC CX204 amplifier. This amplifier powers front of house, lounge, and upper lobby audio monitors and the back stage and dressing room monitors. Each back stage speaker location is equipped with a volume control for adjusting the local level. The front of house monitor volume levels can be adjusted in the House Manager's office (be aware that access to this panel is limited to times when the box office is open). A Soundweb processor that is preconfigured to send program information to all the locations controls the system. The program feed is variable and can be fed from one microphone on the mezzanine rail or independent feeds can be sent into each channel of the amplifier directly (Doing this bypasses the Soundweb). The monitor system is also equipped with a recall sampler that is used to play short audio files to alert the patrons to take their seats. If an independent feed is intended for each monitor

location it will be required that the recall sampler be fed into the outboard show console and assigned to the front of house monitor system.

Assistive Listening System:

The theatre is equipped with a Williams Sound personal PA deluxe system 300. This is an FM transmitter and receiver package that is fed from the microphone located on the mezzanine rail, or an independent feed can be routed directly into the system.

Specifications:

<u>Function</u>	<u>Equipment</u>	<u>Quantity</u>
Processing	BSS Soundweb 9088iis	4
Additional Amplifiers	QSC 702	3
	QSC 1102	2
Console	Yamaha M7CL-48	1
Console Add-Ons	Yamaha MY16-AT ADAT Card	1
	Sonic Core A16 Ultra 16 Ch. AD/DA Converter	1
Playback	Tascam CD-01U Pro CD Player	1
	Tascam CD-RW900 CD Recorder	1

Inventory:

The following inventories are subject to change. **Confirm all Inventories with the OA Audio Supervisor.**

Installed Speakers:

<u>Function</u>	<u>Quantity</u>	<u>Type</u>	<u>Amp</u>
Subs	2	EAW SB 1001	Duecanali 5204
Apron Fills	4	EAW JF60	QSC 502
Cluster Line Array	10	EAW NTL720	Powered
Side Fills, L&R Proscenium	2	EAW JF290Z	Bi-amped: QSC 702 HF/ 1102 LF
Balcony	4	EAW AS-690e	Bi-amped: QSC 702 HF/ 1102 LF
Mezzanine	4	EAW JF80	QSC 702
Stage Monitor	4	EAW JF80 w/ Yoke	Patchable QSC 702

Additional Speakers:

<u>Type</u>	<u>Quantity</u>
EAW JF80	10
EAW SM 129z	6
EAW 590z	2
ElectroVoice S40	4
Galaxy Hotspot	4

Microphones:

<u>Type</u>	<u>Quantity</u>
Shure SM57	2
Shure Beta 58	4
Shure Beta 57	6
Shure SM58	3
Shure SM58S	1
Shure MX 410	1
AKG SE3008 Mic Preamps	2
AKG CK 91 Capsule	2
AKG CK 98 Capsule	2
AKG D112	1
Audio Technnica Pro 45	2
Senheiser e604	3
Senheiser MZH3015	1
Crown-PCC-160	6

DI Boxes:

<u>Type</u>	<u>Quantity</u>
Countryman Type 85 Active DI	1
Radial J+4 Stereo Line Driver	1
Radial Pro DI	1
Radial Pro D2 Stereo DI	1
Whirlwind Medusa 12 Output Press Box	1

Intercom:

<u>Type</u>	<u>Quantity</u>
Clear Com 1 Channel Beltpacks	16
Clear Com 2 Channel Beltpacks	5
CC-95 Single Muff	23

HS-6 Handset	4
Clear Com 1 Channel Speaker Station	3
Clear Com 2 Channel Speaker Station	2
HME DX 210 Base Station	1
HME BP 210 Wireless Belt Packs	4
Clear Com RM-440 Remote Base Station	2

Video

Overview:

The Majestic has fixed monitor cameras, integrated video patching and projecting systems. There is a limited floating inventory of projectors and accessories, subject to availability. Contact the Office of the Arts Production Staff for details.

Video Recording:

The Majestic has empty cable passes installed between nine camera positions in the auditorium and the basement under the seats, with an additional cableway from there to the loading dock area. At the dock the show can either cable directly to a "B Truck" or into a patch bay that connects to the television production control room in Emerson College's Tufte Performance and Production Center. Shore power of two 200 amp, 3-phase disconnects is available in the loading dock. Camera locations are:

- Onstage (downstage left alcove)
- Orchestra pit, foot of each aisle
- Lower boxes, orchestra sides
- Orchestra section, last row, Right-Center-Center-Left
- Upper boxes, orchestra sides
- Balcony, front house right at truss tower (permanent wide shot camera installed)
- Balcony back center

Any additional camera locations that require running cable across traffic aisles or touching any ornamental plaster or historic finishes will be discouraged and will require specific approval of the Office of the Arts.

Projectors:

The Office of the Arts has limited access to projectors. Availability is extremely limited and use incurs additional costs. Contact the OA Director of Technical Operations for more information.

Fall Protection

Overview:

It is the policy of Emerson College that no worker shall be exposed to a fall hazard. There are several locations in the Majestic that require Fall Arrest Systems as part of the broader Fall Protection system. No work can be conducted at these locations until workers have been trained *by the Office of the Arts staff* and completed the required paperwork. All necessary equipment is provided by the Office of the Arts. Only Office of the Arts equipment may be used.

Fall Arrest System Locations:

Work in the following areas requires use of Fall Arrest equipment. This includes all hang and focus of lighting, video and audio gear. System specifics are part of the Harness training required for work in these areas.

Locations:

- Loading Bridge (Loader Only)
- New Grid
- Catwalk
- Truss Towers
- Mezzanine Rail
- Box Booms

Fire and Safety Regulations

Overview:

No smoking is allowed within Emerson College facilities or on Emerson College Property (see below for information on theatrical effects). The use of alcohol or other drugs is strictly prohibited.

The City of Boston and the Commonwealth of Massachusetts as well as the Federal Government have a number of regulations pertinent to theatrical productions. The following is a non-exhaustive list. All regulated standards of safety must always be maintained by productions in the Majestic Theater.

Drapery Permits:

The Boston Fire Department requires all draperies to be either Inherently Flame Retardant or Treated with a Flame Retardant. A permit to this effect must be issued by the Boston Fire Department for any drapery to be used in any theater in Boston. As part of the application process, a 12" by 12" sample of the drapery fabric *from actual yardage* must be submitted. A burn test will be conducted on this sample by the BFD chemist. There is also, of course, a fee charged by the BFD for the permit. The Office of the Arts can facilitate the application process; contact the Director of Technical Operations for more information.

Special Effects Permits:

Similar to the above Drapery Permits, the Boston Fire Department requires a permit for the use of any special effects. This includes—but is not limited to—all atmospheric effects such as Dry Ice, Smoke, Fog and Haze. Onstage smoking is also considered a Special Effect. Use of special effects can require, in addition to the permit, the presence of a Boston Fire Department detail at additional cost. For more information, contact the Office of the Arts Director of Technical Operations.

Firearms:

Use of firearms on stage at any Emerson venue requires the approval of Emerson's Department of Public Safety as well as the Office of the Arts. Additionally, a supervisor licensed to carry in the Commonwealth of Massachusetts must be present at all times. A Special Effects Permit from the Boston Fire Department may also be required. Contact the Office of the Arts Director of Technical Operations for more information.

Appendices

Contents:

- A. Line Set Schedule
- B. Majestic Ground Plan
- C. Venue Photos

Appendix A – Line Set Schedule

Show: _____ Date: _____

LOAD LIMIT: 1,200 lb per line set 75,000 lb total added weight

Line #	Distance From Plaster		Description	Notes <i>(include Opening on Legs)</i>	Load
N/A	0' – 6"	.15 m	Fire Curtain	Must be clear to come in	N/A
1	1' – 4"	.41m	Main Curtain	Manual Pull, Guillotine, two panels	
2	1' – 9"	.54 m			
3	2' – 4"	.71m			
4	3' – 7"	1.09 m			
5	5' – 1.5"	1.56 m			
6	5' – 9.5"	1.77 m			
7	6' – 6"	1.98 m			
8	7' – 2"	2.18 m			
9	7' – 10"	2.39 m			
10	8' – 5"	2.57 m			
11	9' – 1.5"	2.78 m			
12	9' – 10"	3.00 m			
13	10' – 6.5"	3.21 m			
14	11' – 2.5"	3.42 m			
15	11' – 10"	3.61 m			
16	12' – 5"	3.78 m			
17	13' – 1.5"	4.00 m			
18	13' – 8.5"	4.18 m			
19	14' – 6.5"	4.43 m			
20	15' – 3"	4.65 m			
21	15' – 9"	4.80 m			
22	16' – 5.5"	5.02 m			
23	17' – 1.5"	5.22 m			

24	17' – 9.5"	5.42 m			
25	18' – 5.5"	5.63 m			
26	19' – 2"	5.84 m			
27	19' – 8.5"	6.01 m			
28	20' – 5.5"	6.24 m			
29	21' – 1"	6.43 m			
30	21' – 10"	6.65 m			
31	22' – 5.5"	6.85 m			
32	23' – 3.5"	7.10 m			
33	23' – 7"	7.19 m			
34	24' – 5.5"	7.46 m			
35	25' – 2"	7.67 m			
36	25' – 9"	7.85 m			
37	26' – 5"	8.05 m			
38	27' – 2"	8.28 m			
39	27' – 9"	8.46 m			
40	28' – 5"	8.66 m			
41	29' – 1"	8.86 m			
42	29' – 9"	9.07 m			
43	30' – 5"	9.27 m			
44	31' – 3"	9.53 m			
45	31' – 8.5"	9.66 m			
46	32' – 6"	9.91 m			
47	33' – 1.5"	10.10 m			

Signed
(company representative)

Date

Print name

By signing, the production company and its representative certify that individual weights are no more than 5% heavier than listed and that the total of hung scenery and goods, including counterweights, does not exceed 75,000 pounds (34,020 kilograms.)

Appendix B – Majestic Ground Plan

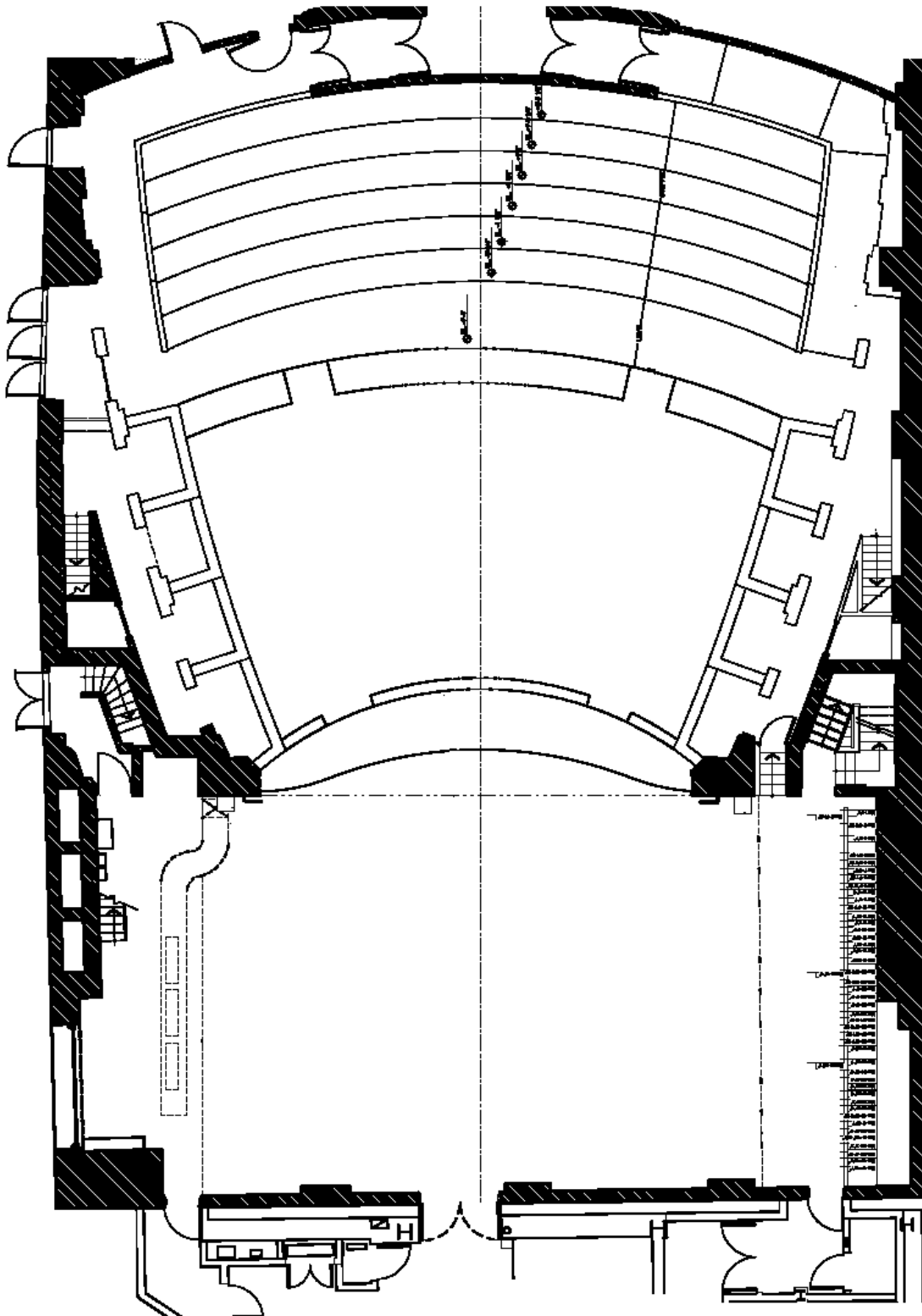

Appendix C – Venue Photos



USC facing SL wing



USC Facing SL Mid Gallery



SL Wing

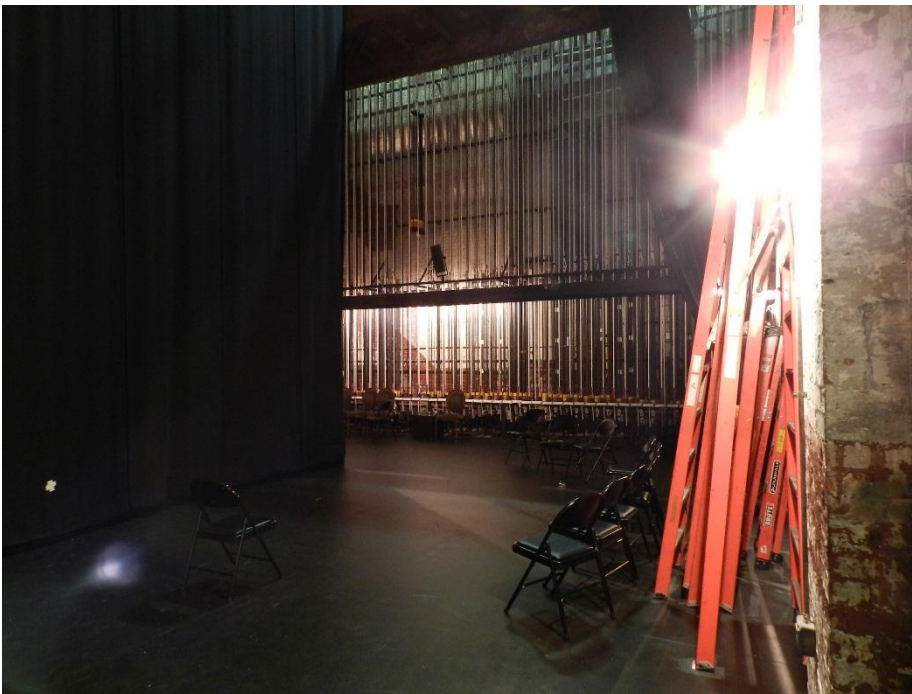

USC Facing SR

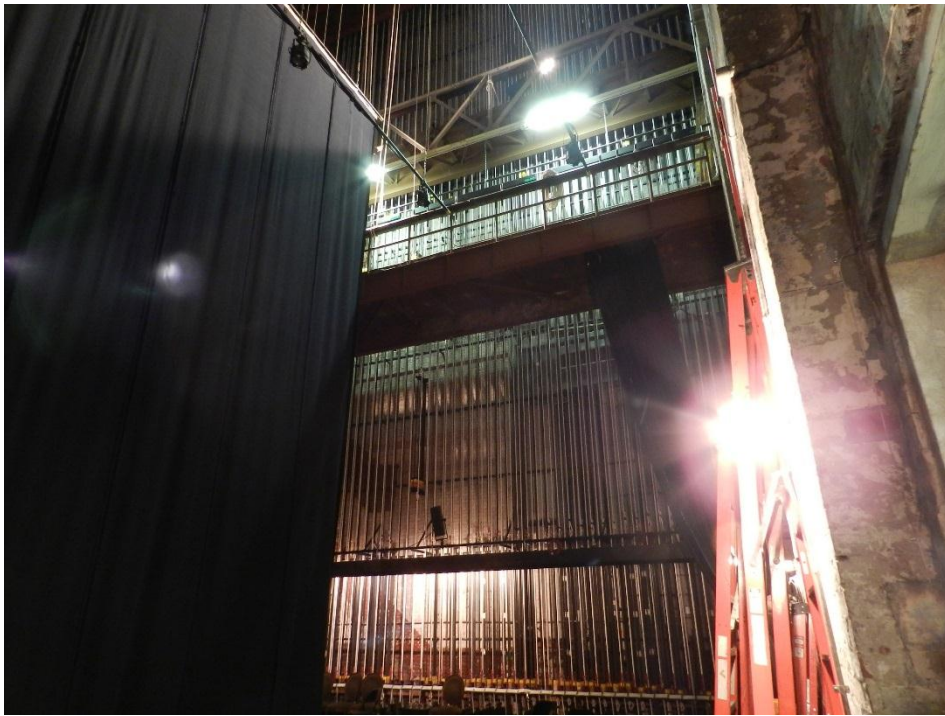

USC Facing SR Mid Gallery



SR Fly Rail



DSC Facing Audience



View from right in front of Mix position Rear Orchestra Right