



Space Overview:

Several residence halls on campus offer community spaces for residents as well as community members at large. Two of these community spaces are available to reserve – South Hall and Shenkman Hall Community Rooms.

How to Book Space:

- [View current availability and request a reservation through our online portal](#)

Residence Hall Community Room Policies:

In addition to all [CSE Reservations policies](#) which apply to these spaces, the residence hall community room spaces listed below also adhere to the following space specific policies:

- Only the two community rooms found in Shenkman Hall and South Hall are available for reservation, all other lounge spaces/community areas within the residence halls are not available for reservation and may be used by residents of each building on a first come first served manner.
- After a reservation is confirmed – the group will be instructed on how to pick up a key for the room. The key must be picked up within 24 hours of the reservation start time and must be returned within 24 hours of the reservation end time. Lost keys will result in the group being charged for the locks to be re-cored (Approximately \$150).
 - Access cards to residence hall buildings are also available – please request and pick up the access card when checking out the key

View specific space features and layouts for [Shenkman Community Room](#) and [South Hall Community Room](#) below.



Shenkman Community Room

The Shenkman Hall Community Room is a 703 square foot meeting room located on the first floor of Shenkman Hall just off the main lobby. The space is large and can easily accommodate 30 or more individuals within the room seated.

Space Features:

- Carpeted flooring
- 50" TV
- Tables
- Piano
- 30 chairs
- Two large refrigerators
- Sink in kitchen
- Access to courtyard

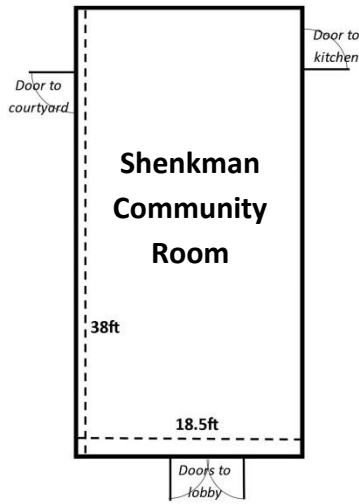

South Hall Community Room

The south hall community room is approximately 430 square feet and is located on the first floor of South Hall just off the main lobby. The room is ideal for medium sized meetings (15-20 people).

Space Features:

- Carpeted flooring
- 50" TV
- Pull down screen (no projector)
- Four square desks
- Two long tables
- 1 arm chair
- Connected private bathroom

