

# SEMI-CUSTOM PROGRAM

## Symbols Used in Semi-Custom Chart

- = Semi-Custom Option Available
- ▲ = Semi-Custom Option Standard with Cabinet

When ordering Semi-Custom options, please note that all paperwork from our factory will show an asterisk (\*) at the end of the nomenclature. This will help identify the cabinets with modifications. Please note this change when reviewing confirmations, invoices, shipping labels, etc.

For Example:  
**W3030\* FIMD P MD10½ B12\* R FH W1230\* L MH29¼**

Always face cabinet when determining left or right specifications

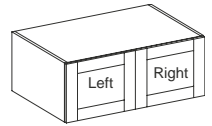

**Sequence of Mods:** All modifications to cabinet construction, size, valances or configuration will take precedence over changes to doors or installed options.

For Example: IC will occur before DDFINTOP

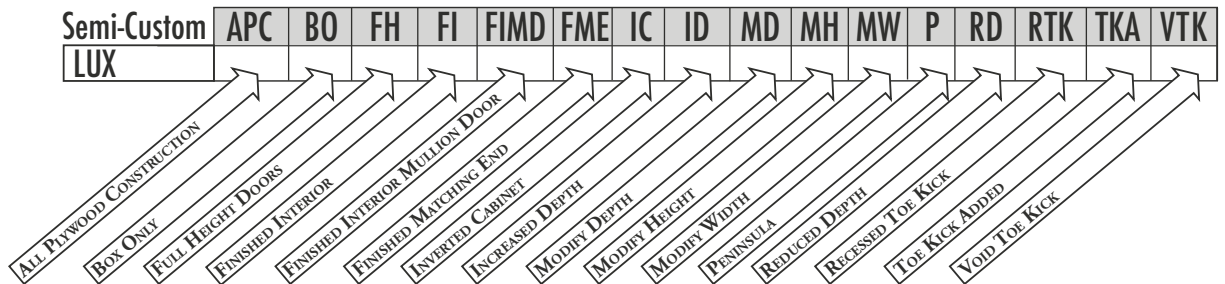

## Modifying Dimensions

Cabinets and end panels can be modified for depth, height and width. Doors, drawer fronts and cabinet openings will change to match the new overall dimensions. Exceptions or limitations are noted under each individual modification. To order and price, use the next larger or largest standard item available and add the specified percentage. Always reduce, if possible, from a larger cabinet. Modifying in multiple directions results in the following pricing:

### Pricing

- One direction — add 23% per cabinet
- Two directions — add 33% per cabinet
- Three directions — add 43% per cabinet

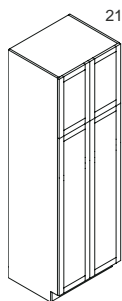

U248424 MD21

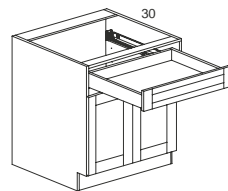

B30 MD30

### MD — Modify Depth

The depth of most cabinets can be modified in 1/16" increments. Drawer boxes and sliding shelves in over 24" deep cabinets will remain the standard base depth. All drawers will remain standard depths. Cabinets with Wood Sliding Shelves have a minimum 12" depth. Deluxe and Superior Metal Sliding Shelves are not available in cabinets less than 18" deep. Superior Metal Drawers in 9 3/8" height can not be reduced below 18" depth. See the Semi-Custom Chart for availability.

To order, use the following code with cabinet item code:

- MD — Modify Depth
- For Example: W3030 MD9

Cabinet Type	Depth	
	Minimum	Maximum
Walls without drawers	4½"	30"
Walls with drawers	12"	30"
Bases without drawers	6"	30"
Bases with drawers	12"	30"
Talls without drawers	6"	30"
Talls with drawers	12"	30"
Vanities without drawers	6"	30"
Vanities with drawers	12"	30"

### Pricing

Add 23% to List Price

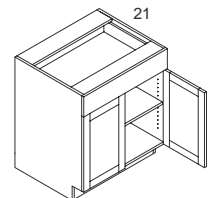

B24 MD21

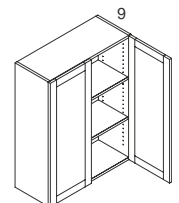

W3930 MD9

Semi-Custom	APC	BO	FH	FI	FIMD	FME	IC	ID	MD	MH	MW	P	RD	RTK	TKA	VTK
LUX									●							

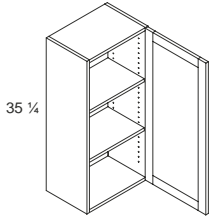

W1536 MH35¼

## MH — Modify Height

The height of most cabinets can be modified in 1/16" increments. For Wall, Base, Vanity and Tall cabinets with both doors and drawers, the height adjustment will occur in the door section and drawer heights will not change. For Tall cabinets and end panels, height adjustment will be made to top section. If Inverted Cabinet option is also chosen the height adjustment will be to the original top door section. Refer to individual door style pages for additional details. See the Semi-Custom Chart for availability.

To order, use the following code with cabinet item code:

MH — Modify Height

For Example: U219324 MH91

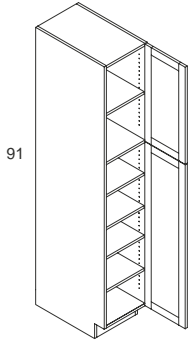

U219324 MH91

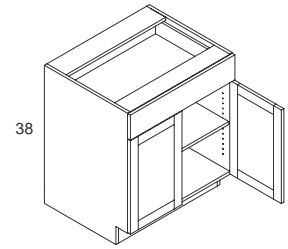

B30 MH38

Cabinet Type	Height	
	Minimum	Maximum
Wall cabinets	12"	60"
Base and Vanity cabinets without drawers	16½"	48"
Base and Vanity cabinets with drawers	22½"	48"
3 Drawer Stack Cabinets	22½"	46½"
4 Drawer Stack Cabinets	28½"	40½"
Tall cabinets	72"	96"

### Pricing

Add 23% to List Price

Semi-Custom	APC	BO	FH	FI	FMD	FME	IC	ID	MD	MH	MW	P	RD	RTK	TKA	VTK
LUX										•						

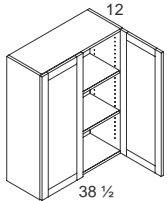

W3942 MW38½

## MW — Modify Width

The width of most cabinets can be modified in 1/16" increments. Changes in width will follow the standard cabinet configurations. Any cabinet less than 24" wide will be a single door cabinet by using existing 24" wide single door cabinets. 9" Wide cabinets will be square for all cathedral overlay door styles. Refer to individual door style pages for additional details. Modify width allows an easy way to get half size cabinets: i.e. 13½", 16½", 20½", 22½" widths, etc. See the Semi-Custom Chart for availability.

To order, use the following code with cabinet item code:

MW — Modify Width

For Example: B27 MW25 1/2

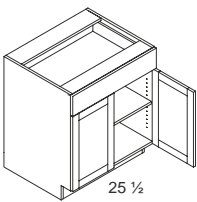

B27 MW25½

Cabinet Type	Width	
	Minimum	Maximum
Wall cabinets without drawers	9"	48"
Wall cabinets with drawers	9"	48"
Base and Vanity cabinets without drawers	9"	48"
Base and Vanity cabinets with drawers	9"	48"
Base and Vanity cabinets with sliding shelves	15"	48"
Vanity Sink Drawer Base cabinets	24"	60"
Tall cabinets without drawers	9"	36"
Tall cabinets with drawers	9"	36"

### Pricing

Add 23% to List Price

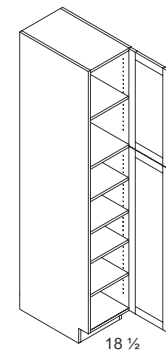

U218424 MW18½

Semi-Custom	APC	BO	FH	FI	FMD	FME	IC	ID	MD	MH	MW	P	RD	RTK	TKA	VTK
LUX											•					

## BB — Bead Board Back

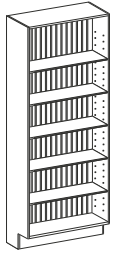

BKC2196 BB

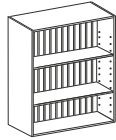

ODW2436 BB

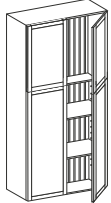

WSC2454 BB

This option replaces the back of the cabinet with a 3/4" bead board panel for wood and MDF door program only. It is available for most Wall, Base, Bookcase and Furniture Bookcase cabinets. All cabinets that are standard with a finished interior can be ordered with the bead board back in the matching finish. Any cabinets with a standard interior will require ordering one of the many available finished interior options before this option will be allowed: Finished Interior (FI), Finished Interior Finished Door (FIFD), Finished Interior Mullion Door (FIMD) or Finished Interior Decorative Door Frame (FIDDF). See the individual options for details and availability.

**Note:** When choosing this option specialty techniques will **NOT** be applied to the Bead Board Back.

To order, use the following code with cabinet item code:

BB — Bead Board Back  
 For Example: ODW2436 BB  
 WSC2454 FIFD BB

**Pricing**

Add 30% to List Price

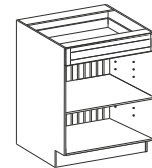

ODDB30 BB

## BO — Box Only



W2730 BO

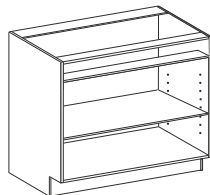

B39 BO

Many cabinets can be ordered as Box Only. Box Only option eliminates all the doors, drawer fronts, drawers and cabinet hardware from the cabinet. Cabinet will contain all standard boring for shelves and hinges. **This option is not available with Finished Interior option.** See the Semi-Custom Chart for option availability.

To order, use the following code with cabinet item code:

BO — Box Only  
 For Example: B39 BO

**Pricing**

85% of List Price

Semi-Custom	APC	BO	FH	FI	FIMD	FME	IC	ID	MD	MH	MW	P	RD	RTK	TKA	VTK
LUX		●														

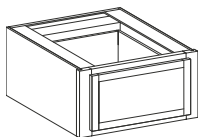

ICSDU18 CB

## CB — Cabinet Back

This option is available for the wood and MDF door program on the Island Component Single Drawer Units, Island Component Door Units, and Island Component Basket Units only. The option creates a standard back on the peninsula side of the island component. Island Component and Island Cabinet construction will be framed with full access overlay doors.

To order, use the following code with cabinet item code:

CB — Cabinet Back  
 For Example: ICSDU18 CB

**Pricing**

No charge

## CUSTDOOR/CUSTBF — Custom Size Door and Drawer Fronts

### Panel Configurations

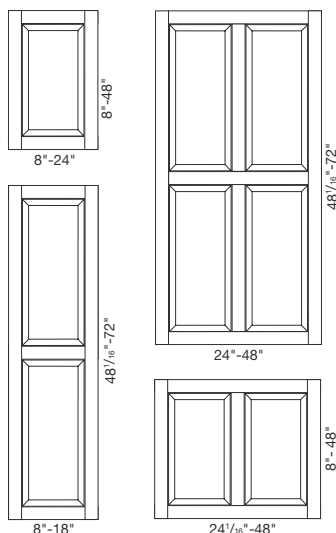

This option gives you the ability to order custom panel sizes based on specific parameters for each door style. You must specify the following information when ordering. Does not include installation hardware. When installing custom doors, special drilling may be required for installing the hinge mounting plates on the cabinet box. Wellborn has the right to substitute MDF for center panels with paints and paints with glazes to insure better quality on larger panels.

- Drill or No Drill (ND)
  - If Drill is selected, then you must specify Left (L) or Right (R) hinge.
- Door Edge Profile (DE) or Square Edge Profile (SE)
  - Note: All edges will receive the specified edge treatment.
- Height and Width
  - Sizes are allowed in 1/8" increments
  - There are minimum and maximum widths allowed in order to retain the door profile. Minimum and maximum widths will vary based on individual door construction.
- Door Type
  - FD Finished Door
  - DDF Decorative Door Frame
  - MD Mullion Door

If DDF or MD is chosen, specify Glass Type:

Codes	Description	Price is in addition to sq. ft. door pricing	Glass Max. Sizes
NG	No Glass	No Charge	---
CG	Clear Glass	\$100 List	48" x 60"
RG	Reeded Glass	\$150 List	32" x 42"
SG	Satin Glass	\$150 List	63" x 44"
CSG	Clear Seedy Glass	\$150 List	24" x 72"
SSG	Super Seedy Glass	\$150 List	32" x 42"
CAG	Clear Antique Glass	\$150 List	24" x 72"
CWG	Clear Water Glass	\$150 List	24" x 72"
CBG	Clear Baroque Glass	\$150 List	30" x 72"

### Custom Door Parameters:

For Custom Door orders, specify:

- Door Hinge – L/R/ND
- Edge Profile – DE/SE
- Door Type – FD/DDF/MD
- Height measurement
- Width measurement

### Door Styles (Cope & Tenon)

- Width:**
- Minimum = 8"
  - Doors less than 11 1/2" are not available in Cathedral.
  - Doors less than 8 3/4" are not available in Arch.
  - Bishop, Trestle, Cortland, Chelsea, Charleston, Messina, Wellington, Winslow, Richmond, Vienna & Bristol doors less than 10 1/2" will have reduced width stiles.
  - Maximum = 24" (single panel), 48" (horizontal double panel)
  - Doors greater than 24" wide are not available in Arch or Cathedral.
  - Doors greater than 24" wide are not available over 48" high.

- Height:**
- Minimum = 11"
  - Doors less than 11" high are not available in Arch or Cathedral.
  - Maximum = 48" (single panel); 72" (vertical double panel)
  - Doors greater than 24" wide are not available over 48" high.

### Mitered/Slab Door Styles (all are single panel)

- Width:**
- Minimum = 8"
  - Maximum = 24"
- Height:**
- Minimum = 8"
  - Maximum = 72"

**Note:** All cope and tenon and MDF door styles over 48" high will have a mid-rail, and if over 24" wide will have a center stile. Mitered and slab doors will remain a one-piece panel.

Brilliant Door Collection door styles in horizontal grain patterns are not available over 48" high.

### Custom Drawer Front Parameters:

For Custom Drawer Front orders, specify:

- Edge Profile – DE/SE
- Height measurement
- Width measurement

- Any drawer fronts *not listed* are SLAB.
- Minimum Size, Slab, H x L = 4 1/2" x 7"
- Minimum Size, 5-piece, H x L = Will vary by door size
- Maximum Size, H x L = 22" x 48" (except Harbour & Bridgeport)

Refer to individual Door Style pages for size limitations

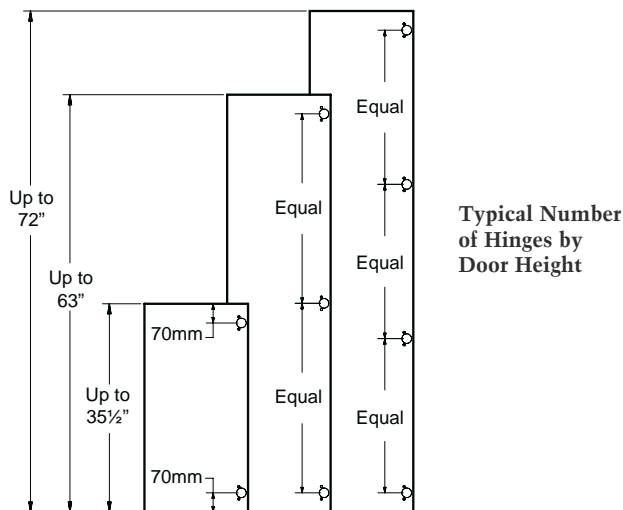

### To Calculate the Price of Your Panel:

The custom panels are priced per square foot. There is a minimum charge of 1 sq. ft. for drawer fronts and 1 1/2 sq. ft. for doors.

Pricing Per Sq. Feet					A	B	C	D
ITEM CODE	WOOD	MDF	EBM	HTM	DESIGNER LAMINATE COLORS			
CUSTDOOR/CUSTBF	120	120	86	96	120	132	---	195

### EXAMPLE:

Panel Size  
 $36" \times 30" = 1,080 \div 144 = 7.5 \text{ sq. ft.}$   
 For Custom Door (or Drawer Fronts):  
 $7.5 \text{ sq. ft.} \times \$120 \text{ List} = \$900$

## Custom Refrigerator Door Panels

Custom Appliance Panels to match your cabinetry are available for appliances designed to accept them. These panels will be custom made to the appliance manufacturer specifications. It is important to research your appliances thoroughly before ordering. A few minutes spent acquiring the correct documents eliminates expensive replacements and order delays. Check the manufacturers specifications and model number carefully to verify your particular application. A complete model number and the appropriate manufacturer's specifications must accompany all custom panel orders.

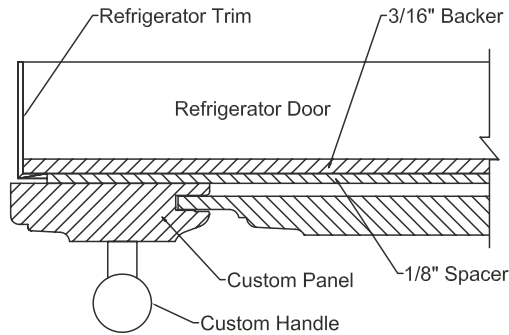

### Typical "Overlay" Application

Custom panels for an "Overlay" application typically include  $\frac{3}{16}$ " backers,  $\frac{1}{8}$ " spacers and  $\frac{3}{4}$ " custom panels which match the specified door style. The panels cover the entire front of the refrigerator and the installation usually requires a custom handle, but in some applications the standard handle can be extended to allow finger clearance between the custom panel and the handle.

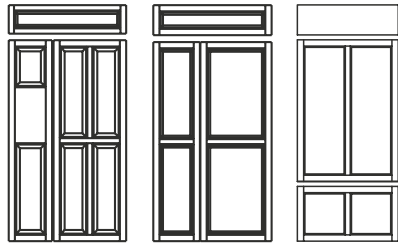

Typical Overlay Configurations

### Notes:

- Any cut outs required for dispensers must be done in the field.
- Custom routing for finger clearance is not available.
- Panels greater than 24" in width will have two vertical panels. Mitered door styles have two separate panels designed to be mounted side-by-side.
- Panels greater than 48" in height will have two panels separated by a center rail. Mitered door styles will always have one tall panel with no center rail.
- Grill panels and doors less than 8" will have a flat center panel even in raised panel door styles.
- Add percentage (%) upcharge for specialty finishes.

Item Code	Description
CUSTRP30OL	30" REF PNL, OVERLAY
CUSTRP30OLWTG	30" REF PNL, OVERLAY, W/GRILL PNL
CUSTRP36OL	36" REF PNL, OVERLAY
CUSTRP36OLWTG	36" REF PNL, OVERLAY, W/GRILL PNL
CUSTRP42OL	42" REF PNL, OVERLAY
CUSTRP42OLWTG	42" REF PNL, OVERLAY, W/GRILL PNL
CUSTRP48OL	48" REF PNL, OVERLAY
CUSTRP48OLWTG	48" REF PNL, OVERLAY, W/GRILL PNL
CUSTRP30OLF2S	30" REF PNL, OVERLAY, Finished Both Sides
CUSTRP30OLWTGF2S	30" REF PNL, OVERLAY, W/GRILL PNL, Finished Both Sides
CUSTRP36OLF2S	36" REF PNL, OVERLAY, Finished Both Sides
CUSTRP36OLWTGF2S	36" REF PNL, OVERLAY, W/GRILL PNL, Finished Both Sides
CUSTRP42OLF2S	42" REF PNL, OVERLAY, Finished Both Sides
CUSTRP42OLWTGF2S	42" REF PNL, OVERLAY, W/GRILL PNL, Finished Both Sides
CUSTRP48OLF2S	48" REF PNL, OVERLAY, Finished Both Sides
CUSTRP48OLWTGF2S	48" REF PNL, OVERLAY, W/GRILL PNL, Finished Both Sides

Item	RUSH	Launch	CF	AW	1	2	3	4	5	6	7	8	9	10	11	12
CUSTRP30OL	NR		---	---	1094	1094	1233	1341	1495	1526	1541	1541	1788	1911	2157	2289
CUSTRP30OLWTG	NR		---	---	1229	1229	1385	1506	1679	1714	1731	1731	2008	2146	2423	2570
CUSTRP36OL	NR		---	---	1094	1094	1233	1341	1495	1526	1541	1541	1788	1911	2157	2289
CUSTRP36OLWTG	NR		---	---	1229	1229	1385	1506	1679	1714	1731	1731	2008	2146	2423	2570
CUSTRP42OL	NR		---	---	1306	1306	1471	1600	1784	1821	1839	1839	2133	2280	2575	2730
CUSTRP42OLWTG	NR		---	---	1459	1459	1644	1788	1993	2034	2055	2055	2384	2548	2877	3052
CUSTRP48OL	NR		---	---	1478	1478	1666	1811	2020	2061	2082	2082	2415	2582	2915	3091
CUSTRP48OLWTG	NR		---	---	1651	1651	1860	2023	2255	2302	2325	2325	2697	2883	3255	3452
CUSTRP30OLF2S	NR		---	---	1313	1313	1479	1609	1794	1831	1849	1849	2145	2293	2589	2746
CUSTRP30OLWTGF2S	NR		---	---	1475	1475	1662	1807	2015	2056	2077	2077	2409	2575	2908	3084
CUSTRP36OLF2S	NR		---	---	1313	1313	1479	1609	1794	1831	1849	1849	2145	2293	2589	2746
CUSTRP36OLWTGF2S	NR		---	---	1475	1475	1662	1807	2015	2056	2077	2077	2409	2575	2908	3084
CUSTRP42OLF2S	NR		---	---	1567	1567	1766	1920	2141	2185	2207	2207	2560	2737	3090	3277
CUSTRP42OLWTGF2S	NR		---	---	1751	1751	1973	2145	2392	2441	2466	2466	2861	3058	3452	3662
CUSTRP48OLF2S	NR		---	---	1774	1774	1998	2173	2423	2473	2498	2498	2898	3098	3497	3709
CUSTRP48OLWTGF2S	NR		---	---	1981	1981	2232	2427	2706	2762	2790	2790	3236	3460	3906	4142

## Custom Appliance Door Panel Enhancements

### Dishwasher Configurations

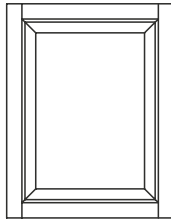

CUSTDWPINTG  
Integrated Design - Door Only

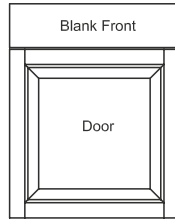

CUSTDWPINTGWBFB  
Integrated Design - Door w/BF  
(For use on Bosch™ dishwashers)

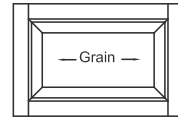

CUSTDDP1PNL  
Dish Drawer - Single Drawer

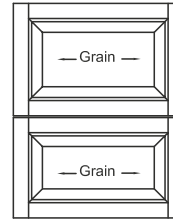

CUSTDDP2PNL  
Dish Drawer - Double Drawer

### Ice Maker Configurations

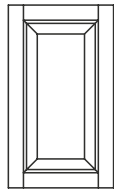

CUSTIMPINTG  
Integrated Design - Door Only

### Trash Compactor Configurations

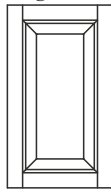

CUSTTCPINTG  
Integrated Design - Door Only

### Under Counter Refrigerator Configurations

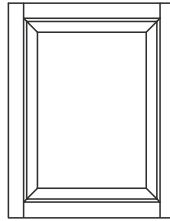

CUSTURPINTG  
Integrated Design - Door Only

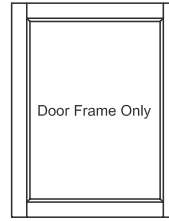

CUSTURPGDF  
Integrated Design - Glass Door Frame Only  
CUSTURPGDF2S  
Integrated Design - Glass Door Frame Only  
Finished Both Sides

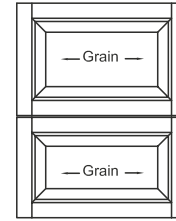

CUSTURPDD  
Double Drawer

### Warming Drawer Panel



CUSTWDP  
Matches Cabinetry Drawer Front Style

Item	RUSH	Launch	CF	AW	1	2	3	4	5	6	7	8	9	10	11	12
CUSTDWPINTG	NR		---	---	296	296	334	363	404	413	417	417	484	517	584	620
CUSTDWPINTGWBFB	NR		---	---	373	373	420	457	509	520	525	525	609	651	735	780
CUSTDDP1PNL	NR		---	---	220	220	248	270	301	307	310	310	360	384	434	461
CUSTDDP2PNL	NR		---	---	373	373	420	457	509	520	525	525	609	651	735	780
CUSTIMPINTG	NR		---	---	213	213	240	261	291	297	300	300	348	372	420	445
CUSTTCPINTG	NR		---	---	213	213	240	261	291	297	300	300	348	372	420	445
CUSTURPINTG	NR		---	---	430	430	485	527	588	600	606	606	703	751	848	900
CUSTURPGDF	NR		---	---	360	360	406	441	492	502	507	507	588	629	710	753
CUSTURPGDF2S	NR		---	---	432	432	486	529	590	602	608	608	705	754	851	902
CUSTURPDD	NR		---	---	373	373	420	457	509	520	525	525	609	651	735	780
CUSTWDP	NR		---	---	192	192	216	235	262	267	270	270	313	335	378	401

### APPLIANCE DIMENSION SYSTEM

Standard Wellborn doors are available to mount on appliance doors. "Dimension Express" service provides trim sizes for appliance dimensions.

#### DIMENSION EXPRESS

- Easy to use • 24 hours a day • Updated daily •

A FREE service to obtain specification sheets instantly either online or by fax. From a fax machine, just call (925) 284-3558. When instructed, press "2" and you will have instructions faxed to you. Manufacturers support the system making it FREE to you.

For questions and comments call Dimension Express at  
PHONE (800) 940-2059 • FAX (925) 403-0707

EMAIL [info@dexpress.com](mailto:info@dexpress.com) • [www.dexpress.com](http://www.dexpress.com)

**WELLBORN CABINET, INC., IS NOT RESPONSIBLE FOR SIZES SPECIFIED BY DIMENSION EXPRESS**

### Appliance Manufacturer Contact Information

Manufacturer	Phone Number	Internet Address
Amana	800-843-0304	<a href="http://www.amana.com">www.amana.com</a>
Asko	800-898-1879	<a href="http://www.askousa.com">www.askousa.com</a>
Bosch	800-921-9622	<a href="http://www.boschappliances.com">www.boschappliances.com</a>
Fisher Paykel	888-936-7872	<a href="http://www.usa.fisherpaykel.com">www.usa.fisherpaykel.com</a>
Frigidaire	800-374-4432	<a href="http://www.frigidaire.com">www.frigidaire.com</a>
GE	800-626-2005	<a href="http://www.geappliances.com">www.geappliances.com</a>
GE Monogram	800-626-2005	<a href="http://www.monogram.com">www.monogram.com</a>
KitchenAid	800-422-1230	<a href="http://www.kitchenaid.com">www.kitchenaid.com</a>
Marvel	800-428-6644	<a href="http://www.lifeluxurymarvel.com">www.lifeluxurymarvel.com</a>
Maytag	800-688-9900	<a href="http://www.maytag.com">www.maytag.com</a>
Miele	800-843-7231	<a href="http://www.meile.com">www.meile.com</a>
Scotsman	800-726-8762	<a href="http://www.scotsman-ice.com">www.scotsman-ice.com</a>
Sub-Zero	800-222-7820	<a href="http://www.subzero.com">www.subzero.com</a>
Summit	718-893-3900	<a href="http://www.summitappliance.com">www.summitappliance.com</a>
Jenn-Air	800-688-1100	<a href="http://www.jenn-air.com">www.jenn-air.com</a>
Thermador	800-656-9226	<a href="http://www.thermador.com">www.thermador.com</a>
U-Line	414-354-0300	<a href="http://www.u-line.com">www.u-line.com</a>
Viking	888-845-4641	<a href="http://www.vikingrange.com">www.vikingrange.com</a>
Whirlpool	866-698-2538	<a href="http://www.whirlpool.com">www.whirlpool.com</a>
Dimension Express is a Service supported by most manufacturers.		
Dimension Express	925-284-3558	<a href="http://www.dexpress.com">www.dexpress.com</a>

## EXDRDN — Extend Door Down

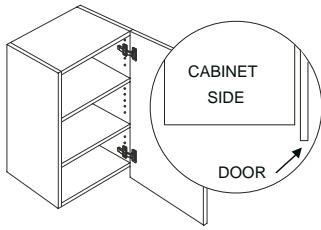

This option is available on individual wall cabinets. It will extend the door by 1¼" down past the floor of the cabinet. This increases the overall height by 1¼" without increasing the cabinet interior. This option is not available on wall stack cabinets, cabinets with door mounted kits, or with Peninsula option.

To order, use the following code with cabinet item code:  
 EXDRDN1 — Extend One Door Down  
 EXDRDN2 — Extend Two Doors Down  
 For Example: W2430SD EXDRDN

W2430SD EXDRDN

Pricing					A	B	C	D
ITEM CODE	WOOD	MDF	EBM	HTM	DESIGNER LAMINATE COLORS			
EXDRDN1	87	87	63	70	87	96	---	141
EXDRDN2	174	174	125	139	174	191	---	283

## FH — Full Height Doors

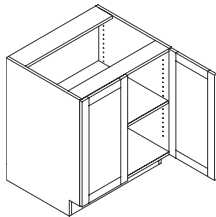

B36 FH

Many base cabinets are available with Full Height Doors. See the Semi-Custom Chart for option availability.

To order, use the following code with cabinet item code:  
 FH — Full Height door  
 For Example: B36 FH

**Pricing**  
 90% of List Price

Semi-Custom	APC	BO	FH	FI	FIMD	FME	IC	ID	MD	MH	MW	P	RD	RTK	TKA	VTK
LUX			•													

## FINBOT — Finished Bottom

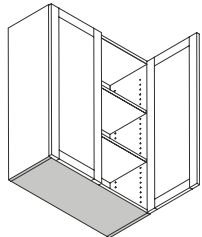

W2736 FINBOT

This option is available on individual Wall cabinets only. It will create a finished bottom on the wall cabinet. Cabinets will receive ¾" thick matching cherry, maple, oak or hickory finished wood veneer or matching melamine or laminate. For painted maple, the finished panel will be painted MDF. Seams will still be present when joining multiple cabinets in a run. This option does not change the height of the cabinet or finished the interior.

To order, use the following code with cabinet item code:  
 FINBOT — Finished Bottom  
 For Example: W2736 FINBOT

**Pricing**  
 Add 15% List Price

## FINTOP — Finished Top

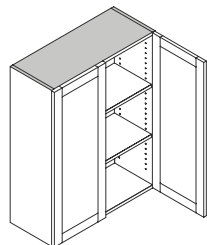

W2736 FINTOP

This option is available on individual Wall and Tall cabinets only. It will create a finished top on the wall or tall cabinet. Cabinets will receive ¾" thick matching cherry, maple, oak or hickory finished wood veneer or matching melamine or laminate. For painted maple, the finished panel will be painted MDF. Seams will still be present when joining multiple cabinets in a run. This option does not change the height of the cabinet or finished the interior.

To order, use the following code with cabinet item code:  
 FINTOP — Finished Top  
 For Example: W2736 FINTOP

**Pricing**  
 Add 15% List Price



## FI — Finished Interior

### FIFD — Finished Interior Finished Door

Available on most wall, base, vanity/office and tall cabinets. When this option is chosen, end panels are finished on the exterior and interior **as well as** the tops and bottoms of wall cabinets. This does not change the metal drawer back and bottom color; these will remain the same as the cabinet interior color that was chosen. For wood or MDF door styles, in both stained and painted finishes, the front edges of the Finished Interior cabinets will be finished wood veneer edge banding. Cabinets will receive 3/4" thick matching cherry, maple, oak or hickory finished wood veneer or matching melamine or laminate. For painted maple, the finished panel will be painted MDF. Not available with Box Only option. For the Brilliant Door Collection, refer to the Program Summary for the finishes with a coordinated matte melamine back. These finishes will require one of the matching end panel options to achieve a true matching end. See Semi-Custom Chart for availability.

FI option does not include doors. To order replacements, use the Easy Parts Search Program on WAY. FIFD option does include doors.

To order, use the following codes with cabinet item code:

FI — Finished Interior

For Example: B24 FI

FIFD — Finished Interior Finished Door

For Example: B24 FIFD

**Note:** On the Semi-Custom Chart, the FI option refers to the availability of either the FI or FIFD options.

Identical Program

$$\boxed{FI} = \frac{\boxed{FI}}{\boxed{FIFD}}$$

#### FI Pricing

Add 20% to List Price

#### FIFD Pricing

Add 50% to List Price

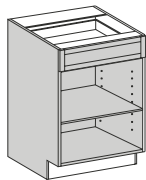

B24 FI

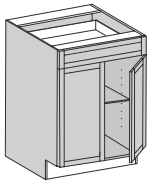

B24 FIFD

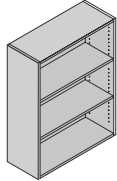

W3942 FI

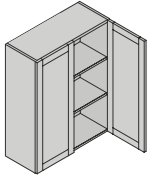

W3942 FIFD

Semi-Custom	APC	BO	FH	FI	FIMD	FME	IC	ID	MD	MH	MW	P	RD	RTK	TKA	VTK
LUX				•												

## FTK — Flush Toe Kick

This option is available on base, office, tall and vanity standard cabinets and wall cabinets with toe kick added option. The toe kick will line up with the front of the cabinet, not the doors. It will be 4 1/2" and unfinished.

To order, use the following code with cabinet item code:

FTK — Flush Toe Kick

For Example: B30 FTK

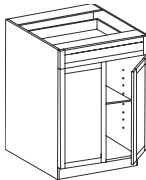

B30 FTK

#### Pricing

Add \$251 List per Cabinet



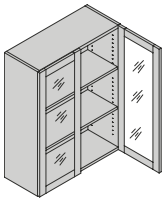

W3930 FIDDF CG

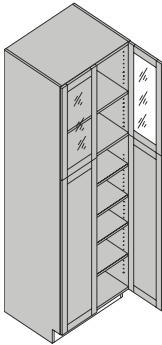

U308424 FI2DDFTOP CG

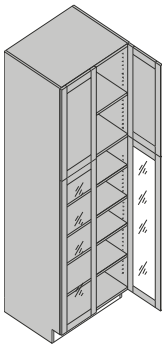

U308424 FI2DDFBTM CG

**FIDDF — Finished Interior Decorative Door Frames**

**FIDDFTOP — Finished Interior Decorative Door Frames Top**

**FIDDFBTM — Finished Interior Decorative Door Frames Bottom**

See each door style page for door style availability. Most wall, base, vanity, office and tall cabinets can be ordered with Finished Interior Decorative Door Frames on the cabinet. When this option is chosen, end panels are finished on the exterior and interior **as well as** the tops and bottoms of wall cabinets.. This does not change the metal drawer back and bottom color; these will remain the same as the cabinet interior color that was chosen. All cope and tenon and MDF doors greater than 48" high will have a center rail and two panel openings. Cabinets will receive 3/4" thick matching cherry, maple, oak or hickory finished wood veneer or matching melamine or laminate. For painted maple, the finished panel will be painted MDF. For wood or MDF door styles, in both stained and painted finishes, the front edges of the Finished Interior cabinets will be finished wood veneer edge banding. When ordering FIDDF, FIDDFTOP, FIDDFBTM the entire cabinet interior will be finished.

When ordering FIDDF, ALL standard doors will be replace with decorative door frames.  
 When ordering FIDDFTOP, TOP standard doors will be replaced with decorative door frames.  
 When ordering FIDDFBTM, BOTTOM standard doors will be replaced with decorative door frames.

To order, use the following codes with cabinet item code:

FIDDF — Finished Interior Decorative Door Frame  
 For Example: W3930 FIDDF CG

FIDDFTOP — Finished Interior Decorative Door Frame Top section  
 For Example: U308424 FI2DDFTOP CG

FIDDFBTM —Decorative Door Frame Installed Bottom section  
 For Example: U308424 FI2DDFBTM CG

Then choose your Glass Type:

- NG No Glass
- CG Clear Glass
- RG Reeded Glass
- SG Satin Glass
- CSG Clear Seedy Glass
- SSG Super Seedy Glass
- CAG Clear Antique Glass
- CWG Clear Water Glass
- CBG Clear Baroque Glass

For Example: WSC3048 FIDDFBTM SG

**Note: To order replacement doors, use the Easy Parts Search Program on WAY. See page 1-133 for Glass Type options.**

**Note:** Milan and Urban are a solid wood cope and tenon door frame with shaped edges. Morristown Decorative Door Frames will be rabbeted for glass and have a complementary stain covering the furniture board. Not available with Box Only option. Not available for entertainment cabinets, open cabinets that do not come standard with doors, or any cabinets with a kit installed. See each Door Style page for availability. **Glass options are non-tempered and therefore not recommended for base applications or near interior and exterior doors. Glass patterns run vertically with the height of the door.**

**Note: On the Semi-Custom Chart, the FI option refers to the availability of either the FI or FIDDF options.**

<b>FI</b>	=	FIDDF
		FIDDFTOP
		FIDDFBTM

**FIDDF, FIDDFTOP,**  
**FIDDFBTM No Glass Pricing**  
 Add 30% to List Price

**FIDDF, FIDDFTOP,**  
**FIDDFBTM Glass Pricing**  
 Add 55% to List Price

Semi-Custom	APC	BO	FH	FI	FIMD	FME	IC	ID	MD	MH	MW	P	RD	RTK	TKA	VTK
LUX				•												

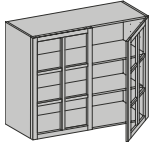

**W3930 FIMD TR NG**  
(glass not included)

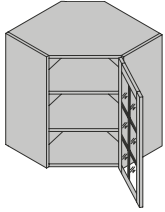

**DC2730 FIMD TR CG**  
(clear glass included)

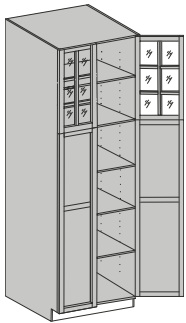

**U308424 FIMDTOP TR CSG**  
(clear seedy glass included)

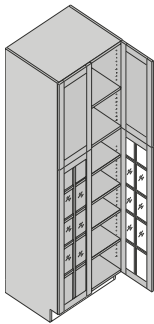

**U308424 FIMDBTM TR CG**  
(clear glass included)

**FIMD — Finished Interior Mullion Door**

**FIMDTOP — Finished Interior Mullion Door Top**

**FIMDBTM — Finished Interior Mullion Door Bottom**

See each door style page for door style availability. Available on many wall and tall cabinets. When this option is chosen, end panels are finished on the exterior and interior **as well as** the tops and bottoms of wall cabinets. This does not change the metal drawer back and bottom color; these will remain the same as the cabinet interior color that was chosen. When ordering FIMD, the whole cabinet interior will be finished, not just the sections that have mullion doors. Cabinets will receive 3/4" thick matching cherry, maple, oak or hickory finished wood veneer or matching melamine or laminate. For painted maple, the finished panel will be painted MDF. For wood or MDF door styles, in both stained and painted finishes, the front edges of the Finished Interior cabinets will be finished wood veneer edge banding. Reference the following chart for door style availability.

When ordering FIMD, ALL standard doors will be replaced with mullion doors.

When ordering FIMDTOP, TOP standard doors will be replaced with mullion doors.

When ordering FIMDBTM, BOTTOM standard doors will be replaced with mullion doors.

To order, use the following codes with cabinet item code:

FIMD—Finished Interior Mullion Door

For Example: W3930 FIMD TR NG

To order, use the following codes with cabinet item code:

FIMDTOP—Finished Interior Mullion Door Top

For Example: U308424 FIMDTOP TR CSG

To order, use the following codes with cabinet item code:

FIMDBTM—Finished Interior Mullion Door Bottom

For Example: U308424 FIMDBTM TR CG

These bullets apply to all Mullion Door Options:

- Not available with Box Only or Void Door Options.
- Mullions in character maple and character cherry door styles will not have character features.
- Sandia will have the step profile on the top and bottom rails for Horizon Mullion Style.
- For Bishop, Trestle, Chelsea, Wellington and Winslow door styles, the inside edge of the mullion door will match Messina.
- Glass options are non-tempered and therefore not recommended for use near interior and exterior doors. Glass patterns run vertically with the height of the door.
- Not available on the following cabinets: 9" Wide cabinets, entertainment cabinets, or any open cabinets that do not come standard with doors.
- Wide stile and rail door styles are not available with FIMD options for 9" wide, 12" wide single door or 24" wide double door cabinets. Cabinets must also be 15" high or higher.

**Note: To order replacement doors, use the Easy Parts Search Program on WAY.**

See page 1-133 for Mullion Styles and Glass Type options.

**FIMD, FIMDTOP, FIMDBTM No Glass Pricing**

Add 110% to List Price

**FIMD, FIMDTOP, FIMDBTM Glass Pricing**

Add 134% to List Price

Semi-Custom	APC	BO	FF	FI	FIMD	FME	IC	ID	MD	MH	MW	P	RD	RTK	TKA	VTK
LUX					•											

**FIMD — Finished Interior Mullion Door (continued)**  
**FIMDTOP — Finished Interior Mullion Door Top**  
**FIMDBTM — Finished Interior Mullion Door Bottom**

Then choose your Mullion Style:

- |    |             |    |         |
|----|-------------|----|---------|
| CF | Craftsman   | MS | Mission |
| PT | Portico     | CL | Chalet  |
| TR | Traditional | CT | Cottage |
| SK | Shaker      | VL | Villa   |
| HZ | Horizon     |    |         |

**Mullion Styles:**

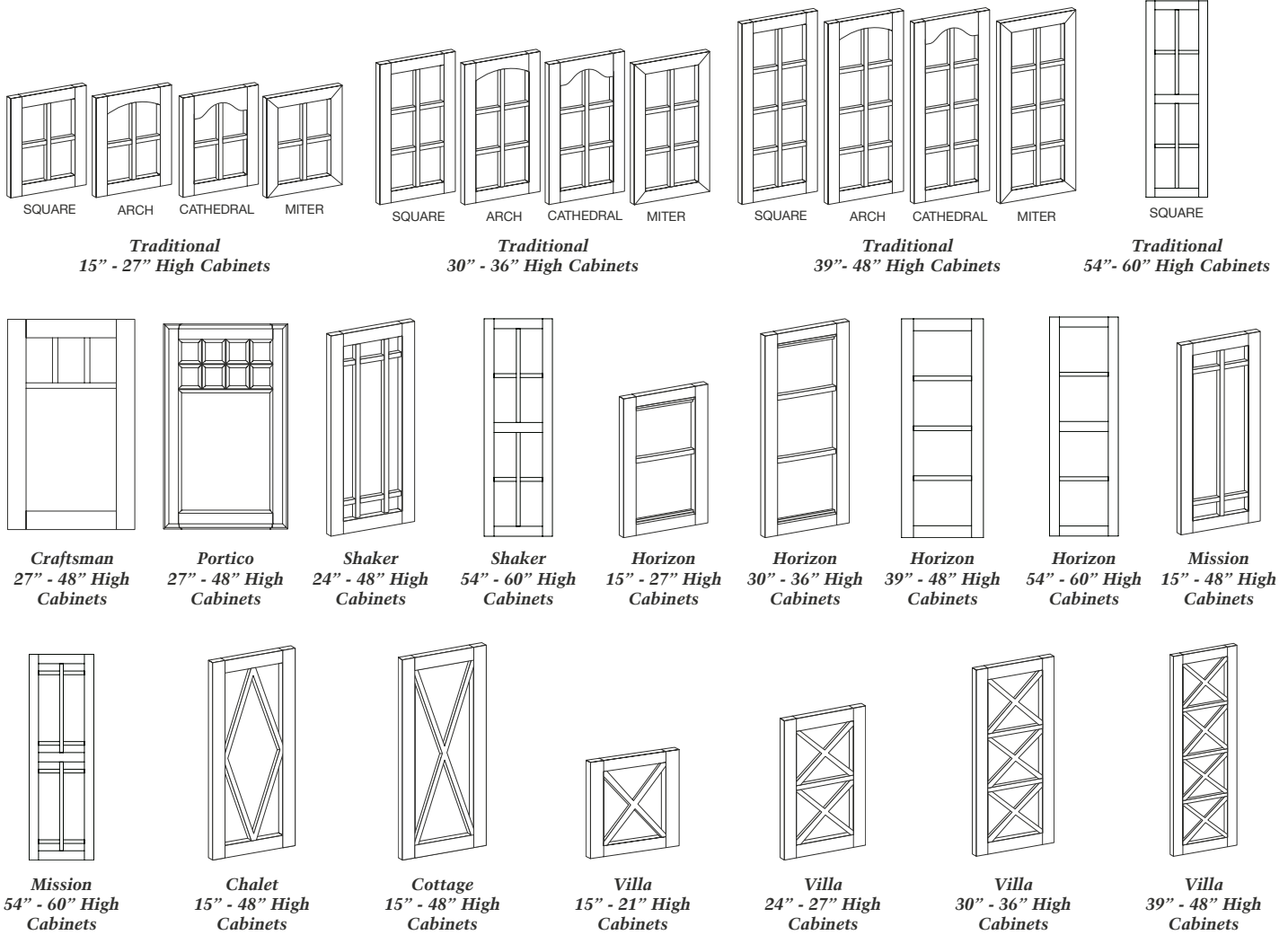

Then choose your Glass Type:

- |     |                   |     |                     |
|-----|-------------------|-----|---------------------|
| NG  | No Glass          | SSG | Super Seedy Glass   |
| CG  | Clear Glass       | CAG | Clear Antique Glass |
| RG  | Reeded Glass      | CWG | Clear Water Glass   |
| SG  | Satin Glass       | CBG | Clear Baroque Glass |
| CSG | Clear Seedy Glass |     |                     |

**Glass Types:**

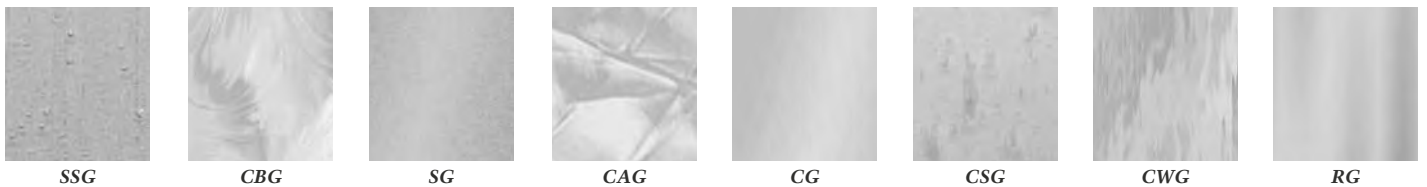

# SEMI-CUSTOM PROGRAM (CONTINUED)

## MULLION STYLES

Min. Door Width		14 <sup>7</sup> / <sub>8</sub> "	14 <sup>7</sup> / <sub>8</sub> "	13 <sup>3</sup> / <sub>8</sub> "	13 <sup>3</sup> / <sub>8</sub> "	11 <sup>7</sup> / <sub>8</sub> "	13 <sup>3</sup> / <sub>8</sub> "	11 <sup>7</sup> / <sub>8</sub> "	11 <sup>7</sup> / <sub>8</sub> "	14 <sup>7</sup> / <sub>8</sub> "
Min. Cabinet Width		15	15	15	12*	12*	15	12*	12*	15*
Door Styles	Mullion & Decorative Door Inside Profile	Chalet	Cottage	Craftsman	Horizon	Mission	Portico	Shaker	Traditional	Villa
Alto	n/a									
Antigua	Hanover									
Arcadia	n/a									
Bali	Hanover									
Barcelona	n/a									
Bedford Arch	Bedford Arch								✓	
Bedford Square	Bedford Square								✓	
Bel-Air	n/a									
Belmont	Belmont	✓	✓	✓			✓		✓	✓
Bishop	Messina	✓	✓	✓			✓		✓*	✓*
Bridgeport	Bridgeport	✓	✓	✓			✓		✓	✓
Bristol	Bristol			✓	✓*	✓*	✓	✓*	✓*	
Camden Arch	Camden Arch								✓	
Camden Square	Camden Square								✓	
Charleston	Charleston	✓	✓	✓			✓		✓*	✓*
Chelsea	Messina	✓	✓	✓			✓		✓*	✓*
Cortland	Cortland			✓	✓*	✓*	✓	✓*	✓*	
Davenport Arch	Davenport Arch								✓	
Davenport Square	Davenport Square	✓	✓	✓			✓		✓	✓
Geneva	Geneva									
Hancock	Hancock							✓	✓	
Hanover	Hanover			✓	✓	✓	✓	✓	✓	
Harbour	Harbour			✓	✓	✓	✓	✓	✓	
Hartford	Hartford	✓	✓	✓		✓			✓	✓
Hawthorne	Hawthorne			✓		✓			✓	
Henlow Arch	Henlow Arch								✓	
Henlow Square	Henlow Square	✓	✓	✓		✓			✓	✓
Lido	n/a									
Madison Arch	Madison Arch								✓	
Madison Cathedral	Madison Cathedral								✓	
Madison Square	Madison Square	✓	✓	✓			✓		✓	✓
Melrose	Melrose	✓	✓	✓			✓		✓	✓
Messina	Messina	✓	✓	✓			✓		✓*	✓*
Midtown	n/a									
Milan	Hanover									
Millbrook Arch	Millbrook Arch								✓	
Millbrook Square	Millbrook Square								✓	
Modesto	Modesto									
Monterey	Monterey			✓			✓		✓	
Morristown	Morristown									
Napa	Napa								✓	
New Haven	New Haven			✓	✓	✓	✓	✓	✓	
Prairie	Prairie							✓	✓	
Richmond	Richmond	✓	✓	✓			✓		✓*	✓*
Sandia	Sandia			✓	✓		✓	✓	✓	✓
Savannah	Savannah	✓	✓	✓			✓		✓	✓
Seville Arch	Seville Arch								✓	
Seville Square	Seville Square	✓	✓	✓			✓		✓	✓
Soho	n/a									
Sonoma	Sonoma			✓			✓		✓	
Sydney	Sydney	✓	✓	✓			✓		✓	✓
Trestle	Messina	✓	✓	✓			✓		✓*	✓*
Urban	Hanover									
Venice	Venice									
Vienna	Vienna	✓	✓	✓			✓		✓*	✓*
Wellington	Messina	✓	✓	✓			✓		✓*	✓*
Winslow	Messina	✓	✓	✓			✓		✓*	✓*

\* Wide stile and rail door styles have a minimum cabinet width of 15" for these mullion styles.

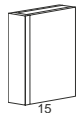

PP18W ID15

## ID — Increased Depth

Many wall, base, tall and vanity/office accessories can be increased in depth up to 30", mantle shelves to 27" and tall and base end panels to 32". When ID is chosen, the item's depth is increased to the specified dimension. See the Semi-Custom Chart for option availability.

To order, use the following codes with item code:

- ID5 — Increase depth to 5"
  - ID6 — Increase depth to 6"
  - ID7 — Increase depth to 7"
  - ID8 — Increase depth to 8"
  - ID9 — Increase depth to 9"
  - ID10 — Increase depth to 10"
  - ID11 — Increase depth to 11"
  - ID12 — Increase depth to 12"
  - ID13 — Increase depth to 13"
  - ID14 — Increase depth to 14"
  - ID15 — Increase depth to 15"
  - ID16 — Increase depth to 16"
  - ID17 — Increase depth to 17"
  - ID18 — Increase depth to 18"
  - ID19 — Increase depth to 19"
  - ID20 — Increase depth to 20"
  - ID21 — Increase depth to 21"
  - ID22 — Increase depth to 22"
  - ID23 — Increase depth to 23"
  - ID24 — Increase depth to 24"
  - ID25 — Increase depth to 25"
  - ID26 — Increase depth to 26"
  - ID27 — Increase depth to 27"
  - ID28 — Increase depth to 28"
  - ID29 — Increase depth to 29"
  - ID30 — Increase depth to 30"
  - ID32 — Increase depth to 32"
- For Example: MWEP ID14

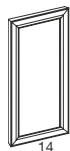

MWEP ID14

### Matching Wall End Panel

1. The maximum increase for Matching Wall End Panel is 30"
2. Matching Wall End Panels can be increased to the inch only (½", ¾", etc. are not available)
3. Over ID21 will have a double end panel except for mitered door styles.

To order, use the following codes with item code:

- ID13 — Increase wall end panel to 13"
- ID14 — Increase wall end panel to 14"
- ID15 — Increase wall end panel to 15"
- ID16 — Increase wall end panel to 16"
- ID17 — Increase wall end panel to 17"
- ID18 — Increase wall end panel to 18"
- ID19 — Increase wall end panel to 19"
- ID20 — Increase wall end panel to 20"
- ID21 — Increase wall end panel to 21"
- ID22 — Increase wall end panel to 22"
- ID23 — Increase wall end panel to 23"
- ID24 — Increase wall end panel to 24"
- ID25 — Increase wall end panel to 25"
- ID26 — Increase wall end panel to 26"
- ID27 — Increase wall end panel to 27"
- ID28 — Increase wall end panel to 28"
- ID29 — Increase wall end panel to 29"
- ID30 — Increase wall end panel to 30"

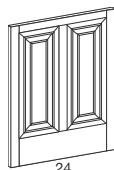

MDEP ID24  
MVEP ID24

### Matching Vanity End Panel & Matching Desk End Panel

1. The maximum increase for Matching Vanity and Matching Desk End Panels is 30"
2. Matching Vanity and Matching Desk End Panels can be increased in 3" increments only.
3. End panels will be double panel except on mitered door styles.

To order, use the following codes with item code:

- ID21 — Increase vanity end panel to 21"
- ID24 — Increase vanity end panel and desk end panel to 24"
- ID25 — Increase vanity end panel and desk end panel to 25"
- ID26 — Increase vanity end panel and desk end panel to 26"
- ID27 — Increase vanity end panel and desk end panel to 27"
- ID28 — Increase vanity end panel and desk end panel to 28"
- ID29 — Increase vanity end panel and desk end panel to 29"
- ID30 — Increase vanity end panel and desk end panel to 30"

## ID — Increased Depth (continued)

### Matching Tall End Panel & Matching Base End Panel

1. The maximum increase for Matching Tall and Matching Base End Panels is 32"
2. End panels will be double panel except slab door styles.

To order, use the following codes with item code:

- ID25 — Increase tall end panel and base end panel to 25"
- ID26 — Increase tall end panel and base end panel to 26"
- ID27 — Increase tall end panel and base end panel to 27"
- ID28 — Increase tall end panel and base end panel to 28"
- ID29 — Increase tall end panel and base end panel to 29"
- ID30 — Increase tall end panel and base end panel to 30"
- ID32 — Increase tall end panel and base end panel to 32"

### Pricing

Add 23% to List Price

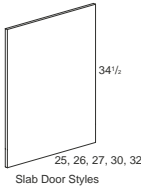
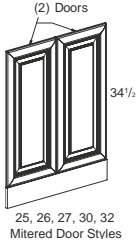
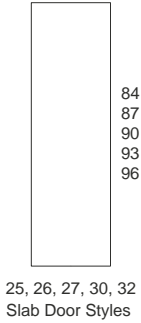
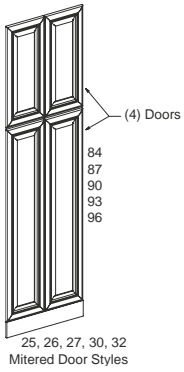

Semi-Custom	APC	BO	FH	FI	FIMD	FME	IC	ID	MD	MH	MW	P	RD	RTK	TKA	VTK
LUX							•									

## IC — Inverted Cabinet

Many base, tall and vanity/office cabinets can be ordered as an Inverted Cabinet. Cabinet will have a subfloor located above the drawer. See the Semi-Custom Chart for option availability.

To order, add the following code with cabinet item code:

- IC — Inverted Cabinet
- For Example: B24 IC

**Note:** When ordering IC option for utility cabinets, the larger doors (which will now be on top) for arch and cathedral door styles will become arch and cathedral. The smaller doors will be square.

### Pricing

Add 30% to List Price

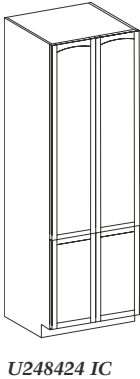
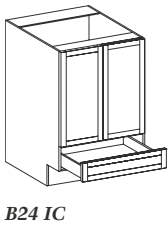

Semi-Custom	APC	BO	FH	FI	FIMD	FME	IC	ID	MD	MH	MW	P	RD	RTK	TKA	VTK
LUX							•									

## P — Peninsula

Many wall and base cabinets are available as a peninsula cabinet. See the Semi-Custom Chart for option availability.

To order, use the following code with cabinet item code:

- P — Peninsula
- For Example: W3942 P
- B21 R P

**Note:** For single door peninsula cabinets, kitchen side and peninsula side will be hinged the same.

For Example: If you specify right hinge, the kitchen side will be right hinged and the peninsula side will be right hinged.

### Pricing

Add 60% to List Price

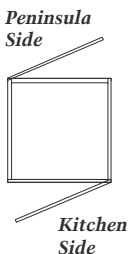
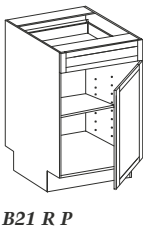
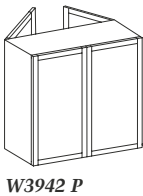

Semi-Custom	APC	BO	FH	FI	FIMD	FME	IC	ID	MD	MH	MW	P	RD	RTK	TKA	VTK
LUX												•				

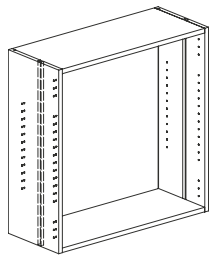

**Prep for Lighting Strip**  
Doors were removed for better visibility

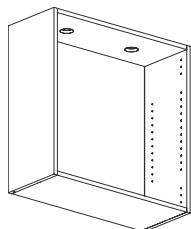

**Prep for Lighting Puck**  
Doors were removed for better visibility

### **PFLDR — Prep for Lighting Door**

This option is available for most cabinets with doors. Choose between Prep for Lighting Strip to have a rout factory machined into both end panels of the cabinet, Prep for Lighting Puck Large to have factory routed large puck holes in the top of the cabinet or Prep for Lighting Puck Small to have factory routed small puck holes in the top of the cabinet. Routing for pucks will be 1/2" deep and will not go all the way through the top of the cabinet and will be centered with each door for most cabinets. Prep for Lighting Strip cabinets will have a 3/4" wide by 1/2" deep rout running the full height of the end panel 4 1/2" from the front edge. Edge banding will be applied after the routing is completed so the rout is not visible from the exterior of the cabinet. If a cabinet has a fixed shelf/floor, the extrusion and cover will need to be fitted to each section. See Lighting Section for extrusions, covers, lights, leads, drivers and switches. Prep for Lighting Door and Prep for Lighting Drawer options can be combined where applicable.

To order, use the following code with cabinet item code:

- PFLS — Prep for Lighting Strip
- PFLPL — Prep for Lighting Puck Large
- PFLPS — Prep for Lighting Puck Small
- For Example: W3030 PFLS

**Pricing**  
\$100 List per cabinet

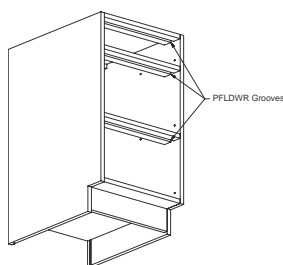

**Prep for Lighting Drawer**  
Drawers were removed for better visibility

### **PFLDWR — Prep for Lighting Drawer**

This option is available for most cabinets with drawers. This option will add a front rail between each drawer that is routed to receive strip lighting. This option will not apply to cabinets with only drawer blanks. See Lighting Section for extrusions, covers, lights, leads, drivers and switches. Prep for Lighting Door and Prep for Lighting Drawer options can be combined where applicable.

To order, use the following code with cabinet item code:

- PFLDWR — Prep for Lighting Drawer
- For Example: 3DB21 PFLDWR

**Pricing**  
\$100 List per cabinet

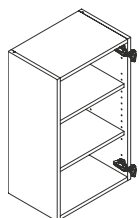

**W1830 PFMDR**

### **PFMDR — Prep For Metal Door ◆**

This option is available on many cabinets and only removes the doors. If ordered for cabinets with drawers, the drawers will not be affected. Cabinet(s) with Prep For Metal Door (PFMDR), Prep For Metal Door Top (PFMDRTOP) or Prep For Metal Door Bottom (PFMDRBTM) will include the necessary hinges but will not include the metal door. Doors will need to be ordered separately and field installed on the appropriate cabinets. You must choose Finished Interior Finished Door (FIFD) option before choosing the Prep for Metal Doors option, if Finished Interior (FI) is desired. This option is not available with any other options that remove the doors, install kits to doors, or create pocket doors. It is not available on coplanar cabinets.

To order, use the following code with cabinet item code:

- PFMDR – Prep For Metal Door to change all doors
- PFMDRTOP – Prep For Metal Door Top to only change top doors
- PFMDRBTM – Prep For Metal Door Bottom to only change bottom doors
- For Example: W1830 PFMDR

**Pricing**  
90% of List Price

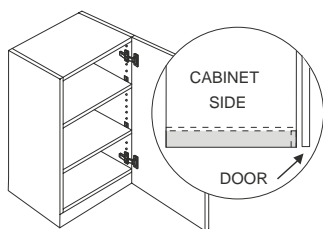

**W1530 RCF**

### **RCF — Recessed Floor**

This option is available on individual Wall cabinets only. It creates 1 1/4" recessed floor for lighting applications under the wall cabinet. The door(s), cabinet sides and back remain full height. This option does not change the height of the cabinet or finish the interior. To finish the recessed bottom, order any of the Finished Interior options. This option is not available on any wall cabinets with drawers, microwave cabinets or any cabinets meant to sit upon the countertop.

To order, use the following code with cabinet item code:

- RCF — Recessed Floor
- For Example: W1530 RCF

Pricing					A	B	C	D
ITEM CODE	WOOD	MDF	EBM	HTM	DESIGNER LAMINATE COLORS			
RCF	205	205	113	126	158	174	---	256



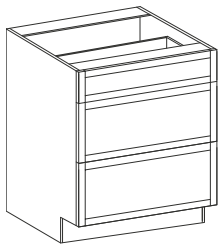

DRB33 RDDWR15

**RDDWR — Reduced Depth Drawer**

This option is available on most 24" deep base cabinets with a drawer(s). It shortens the depth of the drawers to the chosen dimension while not changing the overall cabinet depth. This option applies to all drawers in the cabinet. Superior Metal Drawers in 9 $\frac{1}{2}$ " height can not be reduced below 18" depth.

To order, use the following codes with cabinet item code:

RDDWR18 — Reduce drawer depth to 18"

RDDWR15 — Reduce drawer depth to 15"

RDDWR12 — Reduce drawer depth to 12"

RDDWR9 — Reduce drawer depth to 9"

For Example: DRB33 RDDWR15

**Pricing**

Add 25% to List Price

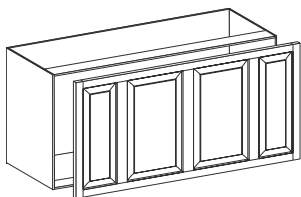

SOF481824 RF

**RF — Removable Front Option**

The Removable Front option is only available for Soffit Cabinets in the wood and MDF door program. This option creates a removable front by adding clips to keep the front in place. This allows the front to be removed for inspection.

To order, use the following code with cabinet item code:

RF — Removable Front

For Example: SOF481824 RF

**Pricing**

No Charge

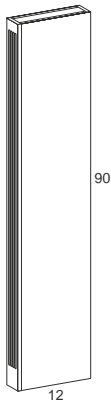

FP90T RD12

**RD — Reduced Depth**

Many wall, base, tall and vanity/office accessories can be reduced in depth. When RD is chosen, the item's depth is reduced to the specified dimension. Reduced Depth is noted in the Semi-Custom Chart for option availability.

To order, use the following codes with item code:

RD24 — Reduce depth to 24"

RD23 — Reduce depth to 23"

RD22 — Reduce depth to 22"

RD21 — Reduce depth to 21"

RD20 — Reduce depth to 20"

RD19 — Reduce depth to 19"

RD18 — Reduce depth to 18"

RD17 — Reduce depth to 17"

RD16 — Reduce depth to 16"

RD15 — Reduce depth to 15"

RD14 — Reduce depth to 14"

RD13 — Reduce depth to 13"

RD12 — Reduce depth to 12"

RD11 — Reduce depth to 11"

RD10 — Reduce depth to 10"

RD9 — Reduce depth to 9"

RD8 — Reduce depth to 8"

RD7 — Reduce depth to 7"

RD6 — Reduce depth to 6"

RD5 — Reduce depth to 5"

For Example: FP90T RD12

**Matching Wall End Panel**

1. The minimum reduction for Matching Wall End Panel is 9".
2. Matching Wall End Panels can be reduced to the inch only. ( $\frac{1}{2}$ ",  $\frac{3}{4}$ ", etc. are not available)

To order, use the following codes with item code:

RD11 — Reduce wall end panel to 11"

RD10 — Reduce wall end panel to 10"

RD9 — Reduce wall end panel to 9"

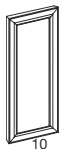

**MWEP12 RD10**

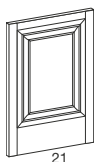

**MBEP RD21**

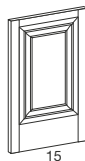

**MVEP18 RD15**

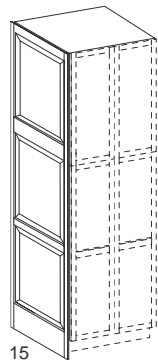

**MTEP1884 RD15**

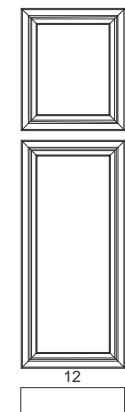

**MVCLEP1884 RD12**

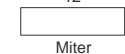

**MTEP1884 RD12**

Miter

### Matching Base or Vanity End Panel

1. The minimum reduction for Matching Base End Panel, Matching Vanity End Panel and Matching Desk End Panel is 9".
2. Matching Base End Panel and Matching Vanity End Panel can be reduced in 1" increments only.
3. 21" Deep or less will have a single panel.

To order, use the following codes with item code:

- RD23 — Reduce base end panel to 23"
- RD22 — Reduce base end panel to 22"
- RD21 — Reduce base end panel to 21"
- RD20 — Reduce base end panel to 20"
- RD19 — Reduce base end panel and vanity end panel to 19"
- RD18 — Reduce base end panel and vanity end panel to 18"
- RD17 — Reduce base end panel and vanity end panel to 17"
- RD16 — Reduce base end panel and vanity end panel to 16"
- RD15 — Reduce base end panel and vanity end panel to 15"
- RD14 — Reduce base end panel and vanity end panel to 14"
- RD13 — Reduce base end panel and vanity end panel to 13"
- RD12 — Reduce base end panel and vanity end panel to 12"
- RD11 — Reduce base end panel and vanity end panel to 11"
- RD10 — Reduce base end panel and vanity end panel to 10"
- RD9 — Reduce base end panel and vanity end panel to 9"

### Matching Tall End Panel

1. The minimum reduction for Matching Tall End Panel is 9".
2. Matching Tall End Panel can be reduced in 1" increments only.
3. For 21", 18", 15" and 12" deep, includes 3 panel only.

To order, use the following codes with item code:

- RD23 — Reduce tall end panel to 23"
- RD22 — Reduce tall end panel to 22"
- RD21 — Reduce tall end panel to 21"
- RD20 — Reduce tall end panel to 20"
- RD19 — Reduce tall end panel to 19"
- RD18 — Reduce tall end panel to 18"
- RD17 — Reduce tall end panel to 17"
- RD16 — Reduce tall end panel to 16"
- RD15 — Reduce tall end panel to 15"

### Matching Vanity Linen End Panel

1. The minimum reduction for Matching Vanity Linen End Panel is 9".
2. Matching Vanity End Panel can be reduced in 1" increments only.

To order, use the following codes with item code:

- RD20 — Reduce vanity linen end panel to 20"
- RD19 — Reduce vanity linen end panel to 19"
- RD18 — Reduce vanity linen end panel to 18"
- RD17 — Reduce vanity linen end panel to 17"
- RD16 — Reduce vanity linen end panel to 16"
- RD15 — Reduce vanity linen end panel to 15"
- RD14 — Reduce vanity linen end panel to 14"
- RD13 — Reduce vanity linen end panel to 13"
- RD12 — Reduce vanity linen end panel to 12"
- RD11 — Reduce vanity linen end panel to 11"
- RD10 — Reduce vanity linen end panel to 10"
- RD9 — Reduce vanity linen end panel to 9"

- RD14 — Reduce tall end panel to 14"
- RD13 — Reduce tall end panel to 13"
- RD12 — Reduce tall end panel to 12"
- RD11 — Reduce tall end panel to 11"
- RD10 — Reduce tall end panel to 10"
- RD9 — Reduce tall end panel to 9"

### Pricing

Add 23% to List Price

Semi-Custom	APC	BO	FH	FI	FIMD	FME	IC	ID	MD	MH	MW	P	RD	RTK	TKA	VTK
LUX													•			

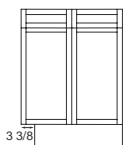

**B39 RTKL**  
(Recessed Toe Kick Left)

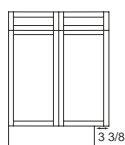

**B39 RTKR**  
(Recessed Toe Kick Right)

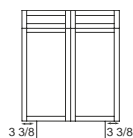

**B39 RTKL RTKR**  
(Recessed Toe Kick Left and Right)

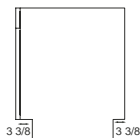

**B39 RTKB**  
(Recessed Toe Kick Front and Back)

### RTK — Recessed Toe Kick

Recessed Toe Kick is available on many base, vanity/office and tall cabinets. See the Semi-Custom Chart for option availability.

To order, use the following codes with cabinet item code:

- RTKL — Recessed Toe Kick Left
  - RTKR — Recessed Toe Kick Right
  - RTKB — Recessed Toe Kick Back
- For Example: B39 RTKL (Left)  
B39 RTKR (Right)  
B39 RTKB (Back)

Toe kick will be recessed 3 3/8" on specified side or sides.

**Note: Recessed Toe Kick Back only modifies the toe kick.**

### Pricing

Add \$96 List each side

Semi-Custom	APC	BO	FH	FI	FIMD	FME	IC	ID	MD	MH	MW	P	RD	RTK	TKA	VTK
LUX														•		

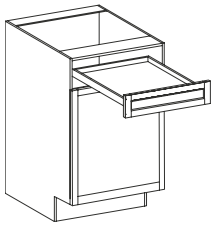

**B21 SDBT**

### **SDBT — Scoop Top Drawer Box**

Most base, vanity, and desk cabinets with wood drawers only may be ordered with a Scoop Top Drawer Box. The SDBT option replaces the top drawer box with a scooped drawer (2 3/8") with a 2 3/8" clearance from the top of the cabinet includes 3/4" rail. Remaining drawers will be standard.

To order, use the following code with cabinet item code:

SDBT — Scoop Top Drawer Box  
For Example: B21 SDBT

**Pricing**

Add 5% to List Price

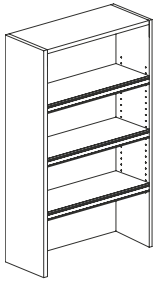

**BKC3054 SHVEP-LRM**

### **SHVEP — Shelf Edge Profile**

This option is available on Bookcases. It adds a 1 1/2" thick profiled moulding to the outside edge of the shelf. Moulding will run the full width of the shelf. This option is not available on Textured Melamine, Embossed Melamine or Designer Laminate cabinets. Bookcases without a floor standard will have a fixed shelf 18" above the bottom edge. Bookcases 84" and higher will have a fixed shelf 30" above the floor. See available profiles below.

To order, use the following codes with the cabinet item code:

For Example: BKC3054 SHVEP-LRM

**Pricing**

Add 20% to List Price

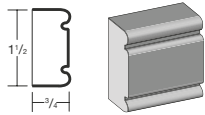

**SHVEP — LRM**

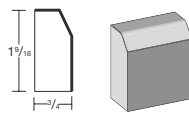

**SHVEP — CEMB**

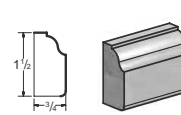

**SHVEP — CEMO**

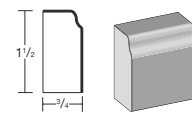

**SHVEP — CWE**

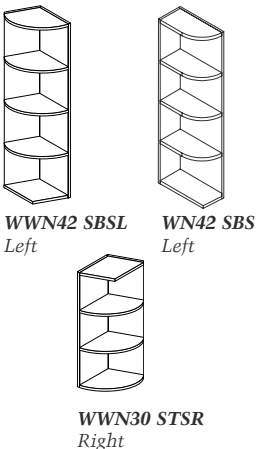

**WWN42 SBSL**  
Left

**WN42 SBS**  
Left

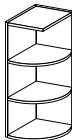

**WWN30 STSR**  
Right

### **STS — Square Top Shelf for All Whatnot Shelves**

### **SBS — Square Bottom Shelf for All Whatnot Shelves**

For use on whatnots that come standard with curved top and bottom shelves. To order Square Top and/or Bottom Shelves, specify left or right because cabinet will not be reversible. Peninsula whatnots do not have to be specified L or R. See codes below.

To order, use the following codes with cabinet item code:

- STSR — Square Top Shelf Right
- SBSR — Square Bottom Shelf Right
- STSL — Square Top Shelf Left
- SBSL — Square Bottom Shelf Left

For peninsula whatnot shelves, use the following codes

- STS — Square Top Shelf
- SBS — Square Bottom Shelf

For Example: WWN30 STSR  
WWN42 SBSL

**Pricing**

No Charge

## SI — Standard Interior

Standard interior options are options where the interior does not change. These options are Decorative Doors Installed, Decorative Doors Installed on Top, Decorative Doors Installed on Bottom, Mullion Doors Installed, Mullion Doors Installed on Top and Mullion Doors Installed on Bottom. See the individual options for all their details.

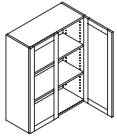

W3930 2DDFIN NG

### **DDFIN — Decorative Door Frames Installed**

#### **DDFINTOP — Decorative Door Frames Installed on Top**

#### **DDFINBTM — Decorative Door Frames Installed on Bottom**

See each door style page for door style availability. Most wall, base, vanity, office and tall cabinets can be ordered with Decorative Door Frames Installed on the cabinet. All MDF and cope and tenon doors greater than 48" high will have a center rail and two panel openings. **Matching interior is not standard with this option; therefore, we recommend ordering the cabinet with Finished Interior (FI) option.**

When ordering DDFIN, ALL standard doors will be replaced with decorative door frames.

When ordering DDFINTOP, TOP standard doors will be replaced with decorative door frames.

When ordering DDFINBTM, BOTTOM standard doors will be replaced with decorative door frames.

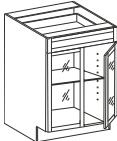

B24 2DDFIN CG

To order, use the following codes with cabinet item code:

- 1DDFIN — One Decorative Door Frame Installed
  - 2DDFIN — Two Decorative Door Frames Installed
  - 3DDFIN — Three Decorative Door Frames Installed
  - 4DDFIN — Four Decorative Door Frames Installed
  - 6DDFIN — Six Decorative Door Frames Installed
  - 8DDFIN — Eight Decorative Door Frames Installed
- For Example: W3930 2DDFIN NG

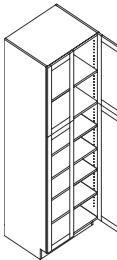

U242424 4DDFIN NG

To order, use the following codes with cabinet item code:

- 1DDFINTOP — One Decorative Door Frame Installed on top section
  - 2DDFINTOP — Two Decorative Door Frames Installed on top section
  - 3DDFINTOP — Three Decorative Door Frames Installed on top section
  - 4DDFINTOP — Four Decorative Door Frames Installed on top section
- For Example: U308424 2DDFINTOP CBG

To order, use the following codes with cabinet item code:

- 1DDFINBTM — One Decorative Door Frame Installed on bottom section
  - 2DDFINBTM — Two Decorative Door Frames Installed on bottom section
  - 3DDFINBTM — Three Decorative Door Frames Installed on bottom section
  - 4DDFINBTM — Four Decorative Door Frames Installed on bottom section
- For Example: U308424 2DDFINBTM CAG

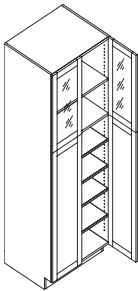

U308424 2DDFINTOP CBG

**Note:** Not available with Box Only or Void Door options. Milan and Urban is a solid wood cope and tenon door frame with shaped edges. Morristown Decorative Door Frames will be rabbeted for glass and have a complementary stain covering the furniture board. Not available for entertainment cabinets, any open cabinets that do not come standard with doors, or all cabinets with a kit installed. See each Door Style page for availability. **Glass options are non-tempered and therefore not recommended for base applications or near interior and exterior doors. Glass patterns run vertically with the height of the door.**

**Note:** To order replacement doors, use the Easy Parts Search Program on WAY.

Then choose your Glass Type:

- NG No Glass
- CG Clear Glass
- RG Reeded Glass
- SG Satin Glass
- CSG Clear Seedy Glass
- SSG Super Seedy Glass
- CAG Clear Antique Glass
- CWG Clear Water Glass
- CBG Clear Baroque Glass

For Example: WSC3048 2DDFINBTM SG

See page 1-133 for Glass Type options.

### **DDFIN, DDFINTOP, DDFINBTM**

#### **No Glass Pricing**

DDF List Price: \$225 per door  
Installation Charge: \$100 List per cabinet

Cabinet List Price +  
DDF List Price +  
Installation Charge per cabinet

For Example: B45 3DDFIN

Cabinet List Price	\$ 500
DDF List Price (3)	\$ 675
Installation Charge	\$ 100
<b>Total List Price</b>	<b>\$1275</b>

### **DDFIN, DDFINTOP, DDFINBTM Glass Pricing**

DDF – Clear Glass Included (CG)  
**Priced at \$325 per door**

DDF – Reeded Glass Included (RG)  
Satin Glass Included (SG)  
Clear Seedy Glass Included (CSG)  
Super Seedy Glass Included (SSG)  
Clear Antique Glass Included (CAG)  
Clear Water Glass Included (CWG)  
Clear Baroque Glass Included (CBG)  
**Priced at \$375 per door**

Installation Charge: \$100 List per cabinet

Cabinet List Price +  
DDF List Price +  
Installation Charge per cabinet

For Example: B45 3DDFIN SSG

Cabinet List Price	\$ 500
DDF List Price (3)	\$ 1125
Installation Charge	\$ 100
<b>Total List Price</b>	<b>\$ 1725</b>

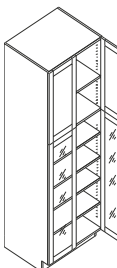

U308424 2DDFINBTM CAG

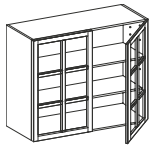

W3930 2MDIN NG

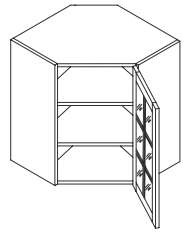

DC2730 1MDIN CG

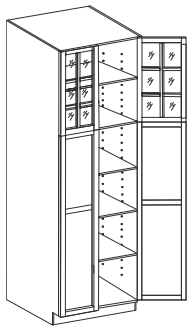

U308424 2MDINTOP SSG

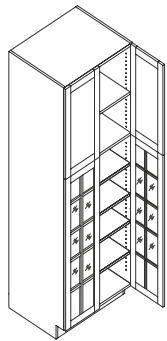

U308424 2MDINBTM SSG

## MDIN — Mullion Doors Installed

### MDINTOP — Mullion Doors Installed Top

### MDINBTM — Mullion Doors Installed Bottom

See each door style page for door style availability. Available on many wall and tall cabinets. All MDF and cope and tenon doors greater than 48" high will have a center rail and two panel openings. **Matching Interior is not standard with this option; therefore, we recommend ordering cabinets with Finished Interior (FI).** Reference the previous chart on page 117 for door style availability.

When ordering MDIN, ALL standard doors will be replaced with mullion doors.  
When ordering MDINTOP, TOP standard doors will be replaced with mullion doors.  
When ordering MDINBTM, BOTTOM standard doors will be replaced with mullion doors.

To order, use the following codes with cabinet item code:

- 1MDIN — One Mullion Door Installed
  - 2MDIN — Two Mullion Doors Installed
  - 3MDIN — Three Mullion Doors Installed
  - 4MDIN — Four Mullion Doors Installed
- For Example: W3930 2MDIN NG

To order, use the following codes with cabinet item code:

- 1MDINTOP — One Mullion Door Installed on top
  - 2MDINTOP — Two Mullion Doors Installed on top
  - 3MDINTOP — Three Mullion Doors Installed on top
  - 4MDINTOP — Four Mullion Doors Installed on top
- For Example: U308424 2MDINTOP SSG

To order, use the following codes with cabinet item code:

- 1MDINBTM — One Mullion Door Installed on bottom
  - 2MDINBTM — Two Mullion Doors Installed on bottom
  - 3MDINBTM — Three Mullion Doors Installed on bottom
  - 4MDINBTM — Four Mullion Doors Installed on bottom
- For Example: U308424 2MDINBTM SSG

These bullets apply to all Mullion Door Options:

- Not available with Box Only or Void Door Options.
- Mullions in character maple and character cherry door styles will not have character features.
- Sandia will have the step profile on the top and bottom rails for Horizon Mullion Style.
- For Bishop, Trestle, Chelsea, Wellington and Winslow door styles, the inside edge of the mullion door will match Messina.
- Glass options are non-tempered and therefore not recommended for use near interior and exterior doors. Glass patterns run vertically with the height of the door.
- Not available on the following cabinets: 9" Wide cabinets, entertainment cabinet or any open cabinets that do not come standard with doors.
- Wide stile and rail door styles are not available with MDIN options for 9" wide, 12" wide single door or 24" wide double door cabinets. Cabinets must also be 15" high or higher.

**Note: To order replacement doors, use the Easy Parts Search Program on WAY.**  
See page 1-133 for Mullion Style and Glass Type options.

#### MDIN, MDINTOP, MDINBTM No Glass Pricing

MDIN – No Glass Included (NG)  
List Price: \$250 per door  
Installation Charge: \$100 List per cabinet

Cabinet List Price +  
MD List Price +  
Installation Charge per cabinet

For Example: W3030 2MDIN MS NG  
Cabinet List Price \$ 400  
MD List Price (2) \$ 500  
Installation Charge \$ 100  
Total List Price \$ 1000

#### MDIN, MDINTOP, MDINBTM Glass Pricing

MDIN – Clear Glass Included (CG)  
List Price: \$350 per door  
Installation Charge: \$100 List per cabinet

MDIN – Other Glass Types

- Reeded Glass Included (RG)
- Satin Glass Included (SG)
- Clear Seedy Glass Included (CSG)
- Super Seedy Glass Included (SSG)
- Clear Antique Glass Included (CAG)
- Clear Water Glass Included (CWG)
- Clear Baroque Glass Included (CBG)

List Price: \$400 per door  
Installation Charge: \$100 List per cabinet

Cabinet List Price +  
DDF List Price +  
Installation Charge per cabinet

For Example: W3030 2MDIN CG CWG  
Cabinet List Price \$ 400  
MD List Price (2) \$ 800  
Installation Charge \$ 100  
Total List Price \$ 1300

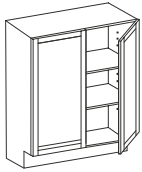

W3930 TKA

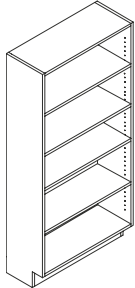

BKC2760 TKA

### TKA — Toe Kick Added

Available on most wall and bookcase cabinets unless noted on the Semi-Custom chart. This option adds a 4½" tall by 3⅜" deep toe kick notch to the bottom of a wall cabinet which increases the overall height of the cabinet by 4½". The end panels will extend to the total cabinet height. When adding a toe kick to a cabinet with a fixed shelf, such as a book case, the notated fixed shelf remains fixed. See Semi-Custom Chart for availability.

To order, use the following code with cabinet item code:

TKA — Toe Kick Added  
 For Example: W3930 TKA  
 (Overall height is 30" + 4½" = 34½")

**Note:** When choosing this option the following options are excluded: Inverted Cabinet, Void Toe Kick and Cathedral or Arch door styles. Mullion Doors, Decorative Door Frames, and Metal Doors (installed) are available. Modified Depth is available in ¼" increments up to 24". Recessed Toe Kick can be ordered with Toe Kick Added.

Pricing					A	B	C	D
ITEM CODE	WOOD	MDF	EBM	HTM	DESIGNER LAMINATE COLORS			
TKA	150	150	108	120	150	165	---	244

Semi-Custom	APC	BO	FH	FI	FIMD	FME	IC	ID	MD	MH	MW	P	RD	RTK	TKA	VTK
LUX															•	

### TKU — Toe Kick Unattached

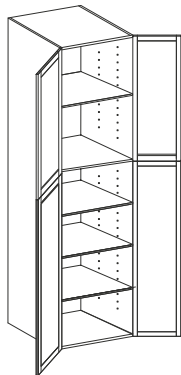

U249024 TKU

Toe Kick Unattached is available on 84", 87", 90", 93" and 96" high cabinets. When ordering this option, the toe kick will be shipped as a separate sub base for field installation.

To order, use the following code with cabinet item code:

TKU — Toe Kick Unattached  
 For Example: U249024 TKU

- ★ 20% - For 24" deep cabinets
- ★ 8% - For 12" deep cabinets

**Pricing**  
 No Charge

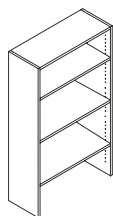

BKC1848

## VA — Valance Added Option

Bookcases, Furniture Bookcases and open display cabinets are available with optional straight, standard furniture, cove and arch valance. Valances will be applied to the front of the cabinet to line up with doors. Valances not available in Embossed Melamine, Heavy Textured Melamine or Designer Laminates. Option availability is noted throughout catalog.

To order, use the following codes with cabinet item code:

- AV — Arch Valance
- CV — Cove Valance
- S — Straight Valance
- SFV — Standard Furniture Valance

For Example: BKC2448 AV  
 BKC3648 CV  
 BKC1848 S  
 BKC3648 SFV

**Note:** Arch not available for 12" wide cabinets.

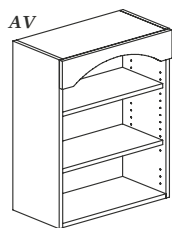

Arch Valance

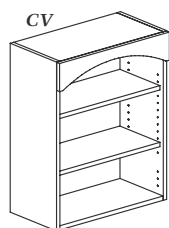

Cove Valance

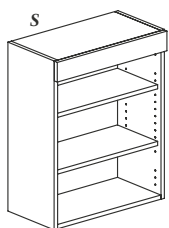

Straight Valance

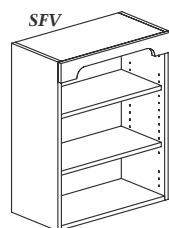

Standard Furniture Valance

### Pricing

Add \$70 List

## Void Fronts and Boxes

These options are available on most base, wall, vanity, office and tall cabinets. They offer the flexibility of removing door, drawers, blank fronts and/or guides in various combinations.

### VAF — Void All Fronts

Most cabinets can be ordered as Void All Fronts. VAF option eliminates all the doors, wood drawer fronts, and blank fronts from the cabinet. Wood drawer boxes, drawer guides, tambour units, panels and center stiles will remain. Hinges and mounting plates will not be included for voided doors. For cabinets with Deluxe or Superior drawers, the complete drawer box and slides will be removed.

To order, use the following code with cabinet item code:

- VAF — Void All Fronts
- For Example: B39 VAF

**Note:** When choosing this option the following options are excluded: FI, BO, cabinets that have kits attached to the door fronts or any cabinets with lift doors.

### Pricing

85% of List

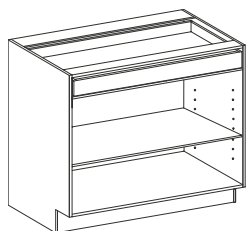

B39 VAF



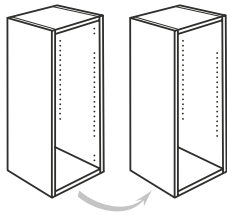

W1539 BO VBD

## VBD — Void Hinge Boring

Available on most cabinets with doors. Doors have to be removed first using Void or Box Only options. This option leaves adjustable shelving boring.

To order, use the following code with cabinet item code:

VBD — Void Hinge Boring

For Example: W1539 BO VBD

### Pricing

Add \$467 List per Cabinet

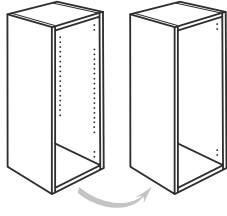

W1539 VBS

## VBS — Void Shelf Boring

Available on most cabinets. Shelving will still ship with the cabinet.

To order, use the following code with cabinet item code:

VBS — Void Shelf Boring

For Example: W1539 VBS

### Pricing

Add \$467 List per Cabinet

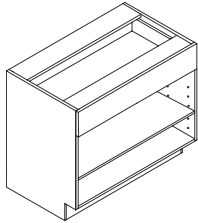

B30 VDO

## VDO — Void Doors Only

### VDRTOP — Void Doors Top

### VDRBTM — Void Doors Bottom

Most cabinets are available with the Void Door options. Cabinets with top doors, such as Wall Stack Cabinets, Utilities, etc. may be ordered as Void Doors Top. Hinges will not be included for the voided doors.

### VDO — Void Doors Only

Most cabinets with doors or door/drawer combinations may be ordered as Void Doors Only. VDO eliminates all doors on the cabinet. Drawer boxes, drawer fronts and blank fronts will remain intact. Hinges will not be included for the voided doors.

### VDRTOP — Void Doors Top

Cabinets with top doors, such as Wall Stack Cabinets, Utilities, etc. may be ordered as Void Doors Top. VDRTOP eliminates the top doors on the cabinet, leaving the bottom doors intact. Hinges will not be included for the voided doors.

### VDRBTM — Void Doors Bottom

Cabinets with bottom doors, such as Wall Stack Cabinets, Utilities, etc. may be ordered as Void Doors Bottom. VDRBTM eliminates the bottom doors on the cabinet, leaving the top doors intact. Hinges will not be included for the voided doors.

To order, use the following code with cabinet item code:

VDO — Void Doors Only

For Example: B30 VDO

VDRTOP — Void Doors Top

For Example: U248424 VDRTOP

VDRBTM — Void Doors Bottom

For Example: U248424 VDRBTM

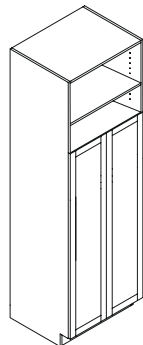

U248424 VDRTOP

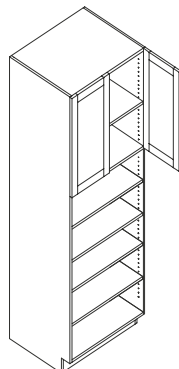

U309624 VDRBTM

**Note: When choosing this option the following options are excluded: IC, FI, BO or cabinets that have kits attached to the door fronts or any cabinets with lift doors.**

### Pricing

VDO 95% of List

VDRTOP No Charge

VDRBTM No Charge

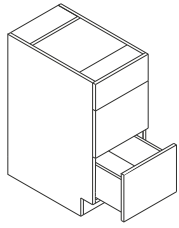

3DB18 VTDB

### VTDB – Void Top Drawer Box

Many base, vanity and desk cabinets may be ordered as Void Top Drawer Box. This option only eliminates the top drawer box(es) and guides. Blank Fronts will be attached as a false front. Doors and additional drawers will remain.

To order, use the following code with cabinet item code:  
 VTDB — Void Top Drawer Box  
 For Example: 3DB18 VTDB

**Note: When choosing this option the following options are excluded: Function Ready drawer inserts, BO, FI, IC and FH.**

**Pricing**  
 No Charge

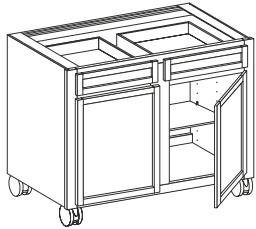

FBBI30 VT

### VT – Void Top

FBBI24, FBBI30, FBBI36, BBI24SFL, BBI30SFL, BBI36SFL, BBI24RFL, BBI30RFL, BBI36RFL, BBI24CFL, BBI30CFL, BBI36CFL, BBI24FFL, BBI30FFL and BBI36FFL butcher block islands are available without the butcher block top included. Island cabinet construction will be framed with full access overlay doors. This option allows for field installation of decorative tops.

To order, use the following code with cabinet item code:  
 VT — Void Top  
 For Example: FBBI30 VT  
 BBI36RFL VT

**Pricing**  
 90% of List

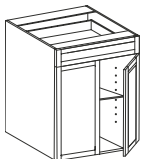

B30 VTK

### VTK — Void Toe Kick

Void Toe Kick is available on many base, vanity/office and tall cabinets. This option eliminates the toe kick and lessens the overall height of the cabinet by 4½". See the Semi-Custom Chart for option availability.

To order, use the following code with cabinet item code:  
 VTK — Void Toe Kick  
 For Example: B30 VTK  
 (Overall height is 34½" - 4½" = 30")

**Pricing**  
 Add 10% to List Price

Semi-Custom	APC	BO	FH	FI	FMD	FME	IC	ID	MD	MH	MW	P	RD	RTK	TKA	VTK
LUX																•