

Roof with Upper Skin and Folding Roof Base added

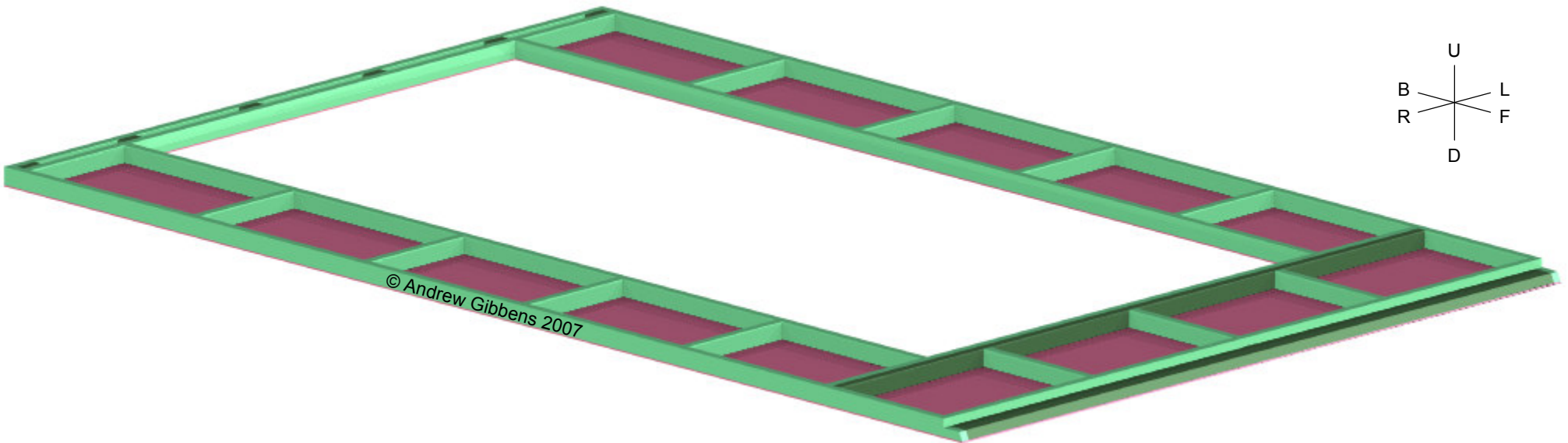

Inner Roof Framing

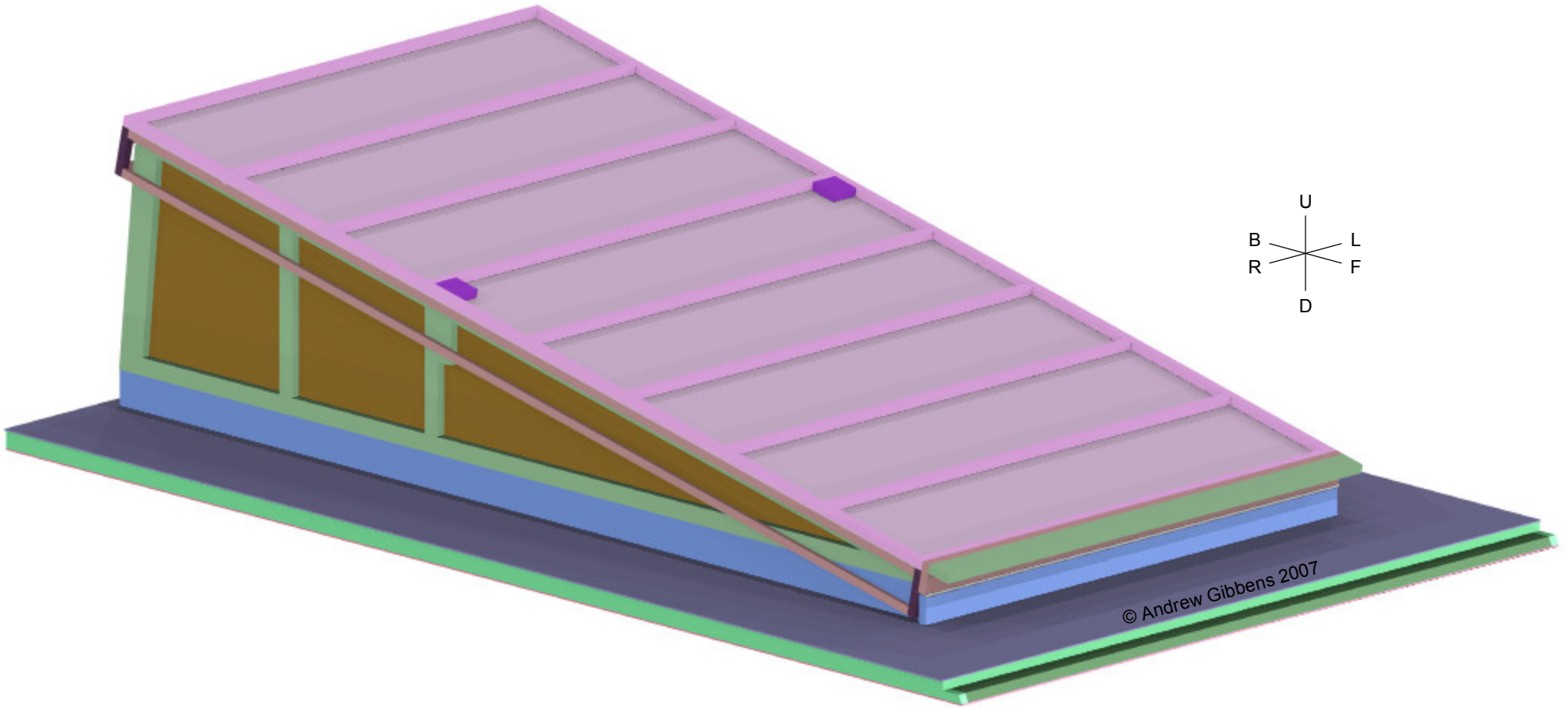

Front 3/4 View - Roof Raised
All outer skins removed to show construction

ROOF 2

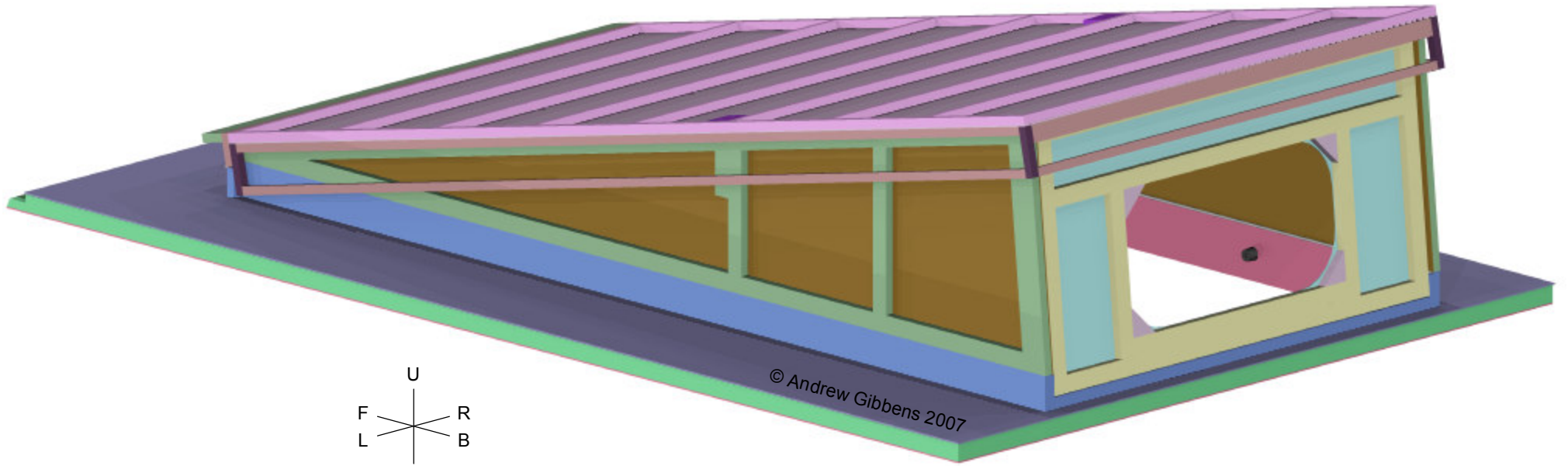

Rear 3/4 View - Roof Raised
All outer skins removed to show construction

ROOF 3

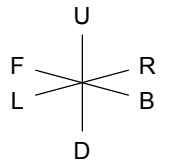
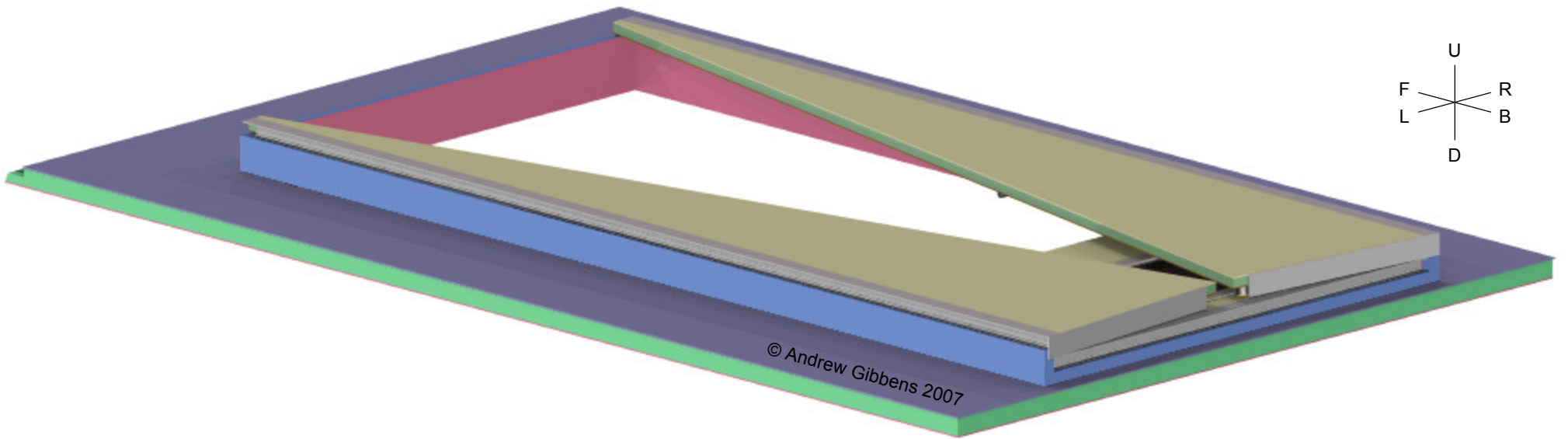
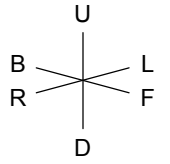
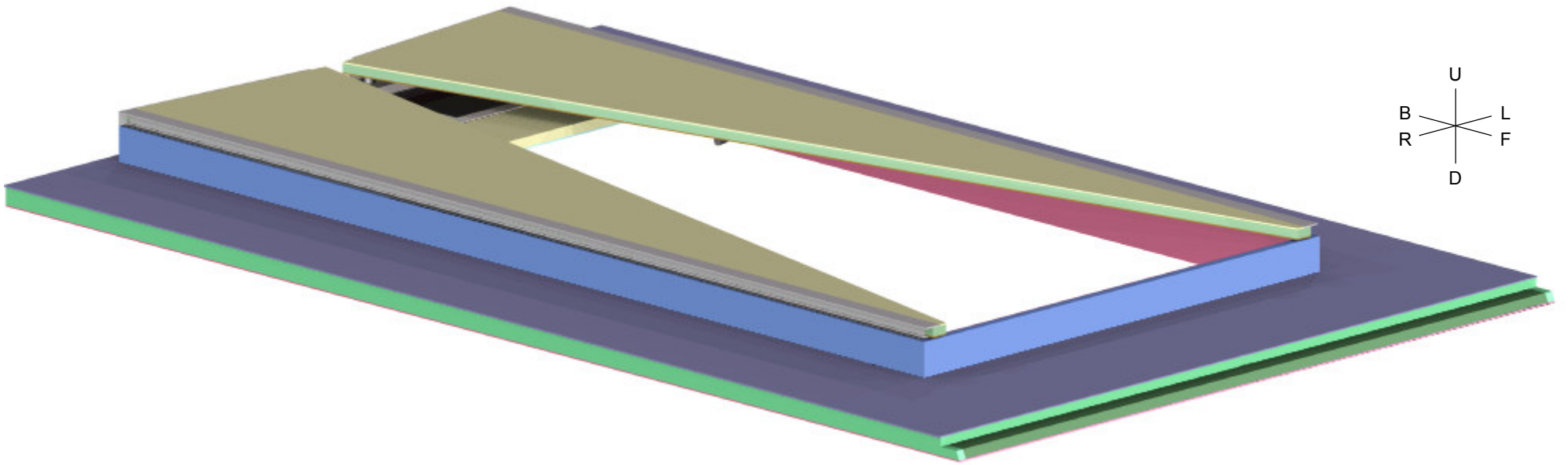

© Andrew Gibbens 2007

Front and Rear 3/4 Views - Roof Folded Down
Lifting top section omitted to show folding method for sides and rear

ROOF 4

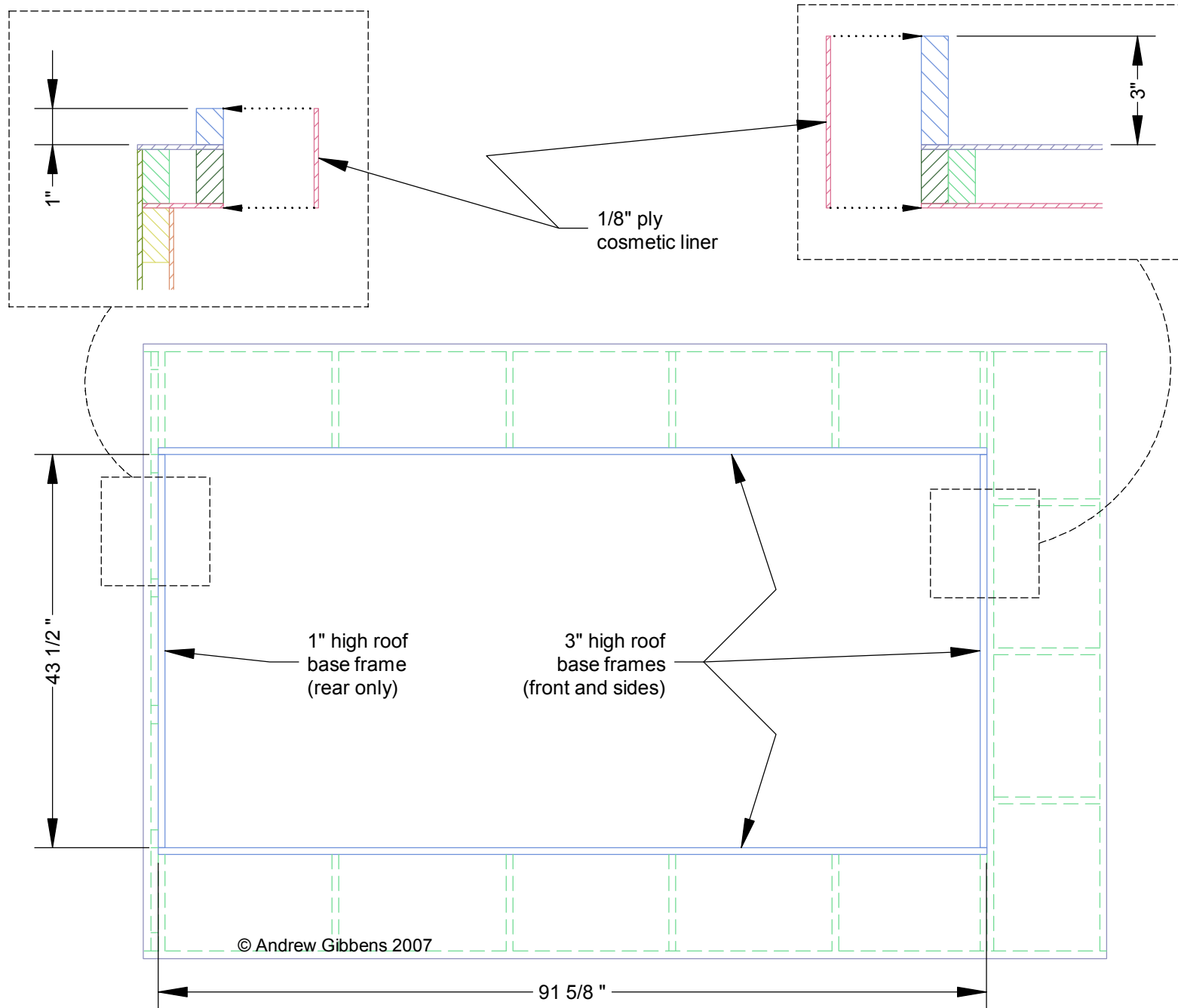

NOTES:

1. Roof base frames made from 1" (nominal) thick wood fastened on top of roof outer skin.

ROOF 5
1:16
(Details 1:4)

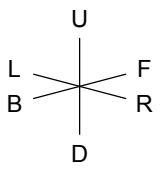
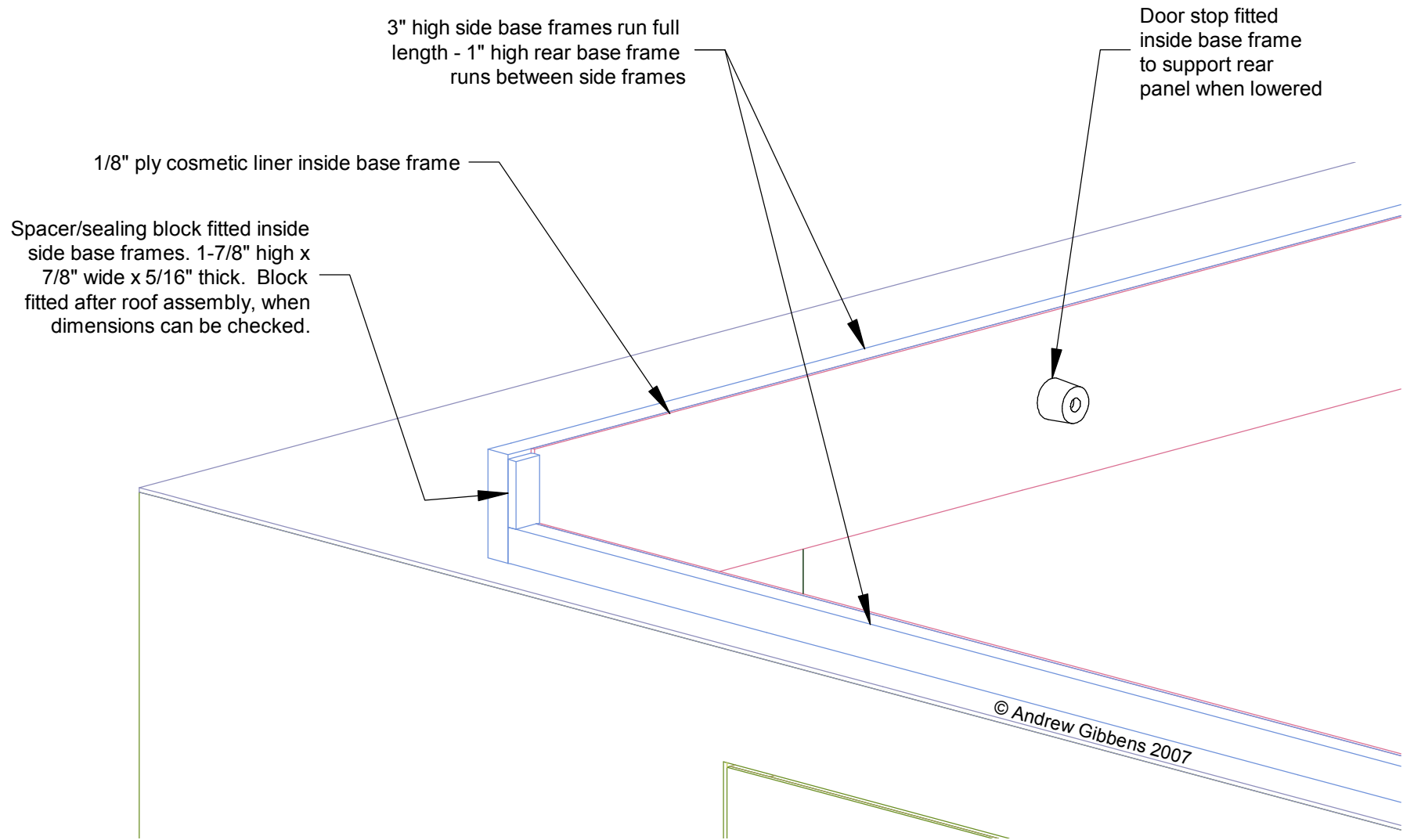

Detail of Rear Corner of Roof Base Frame (lifting sides, top and rear omitted for clarity)

Step 1

Step 2

Step 3

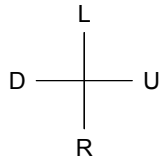

1-1/2"x1/8" aluminium weather bar, projecting 3/4".
Outer ply skin cut back 3/4" to suit

Ply cutout (and positions of framing) to suit window size

Triangular corner blocks

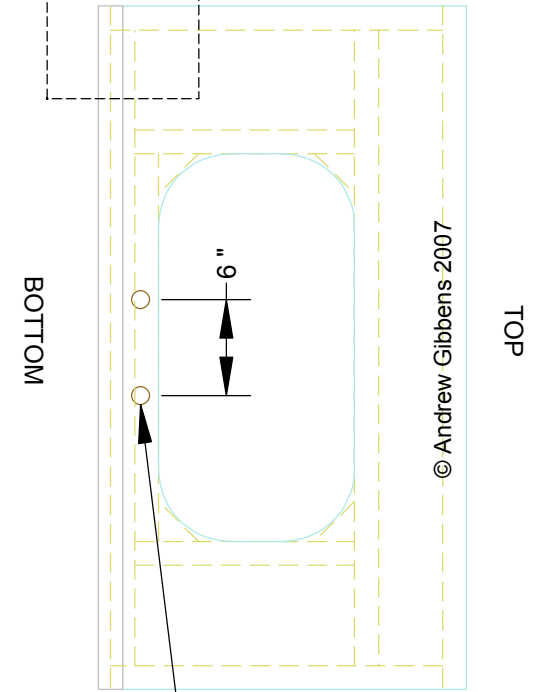
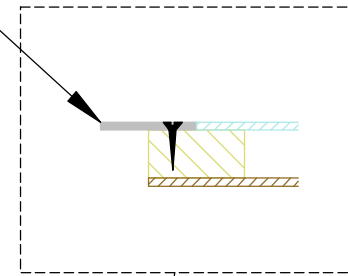
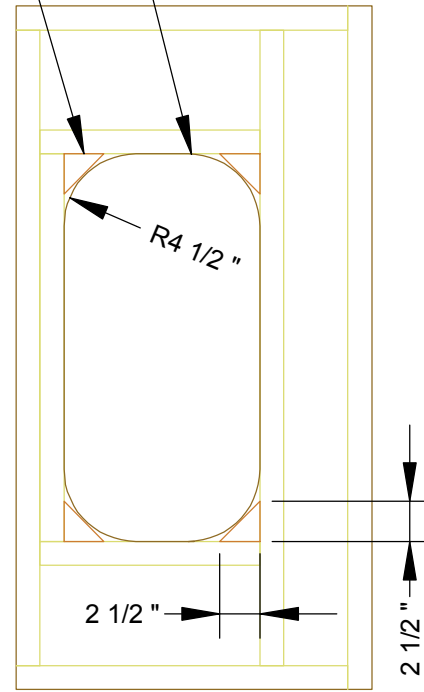
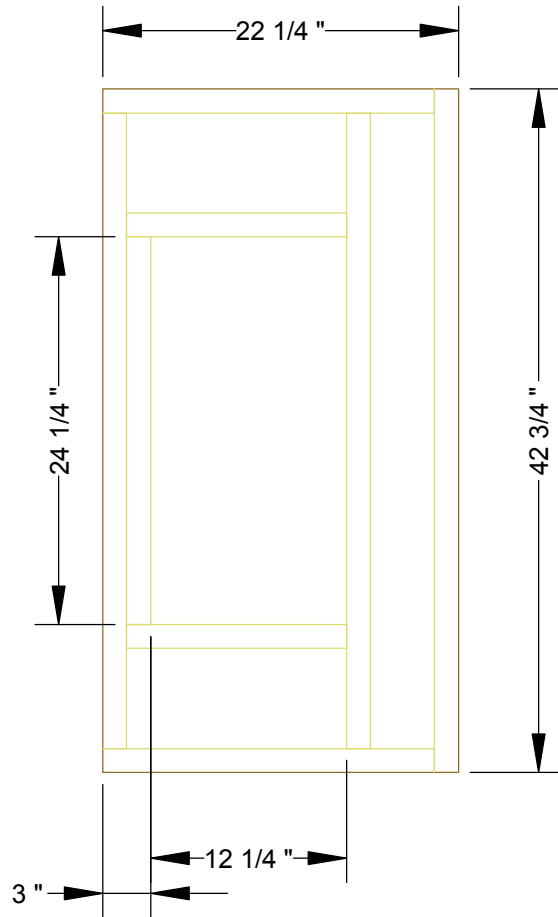

Rubber door stops fitted on outer face of rear panel to support side panels when lowered

NOTES:

1. Drawn with outer/rear skin upwards
2. Inner and outer skins 1/8" ply, all framing 1"x2" (nominal)

ROOF 7
Rear Folding Panel
1:12

Step 2

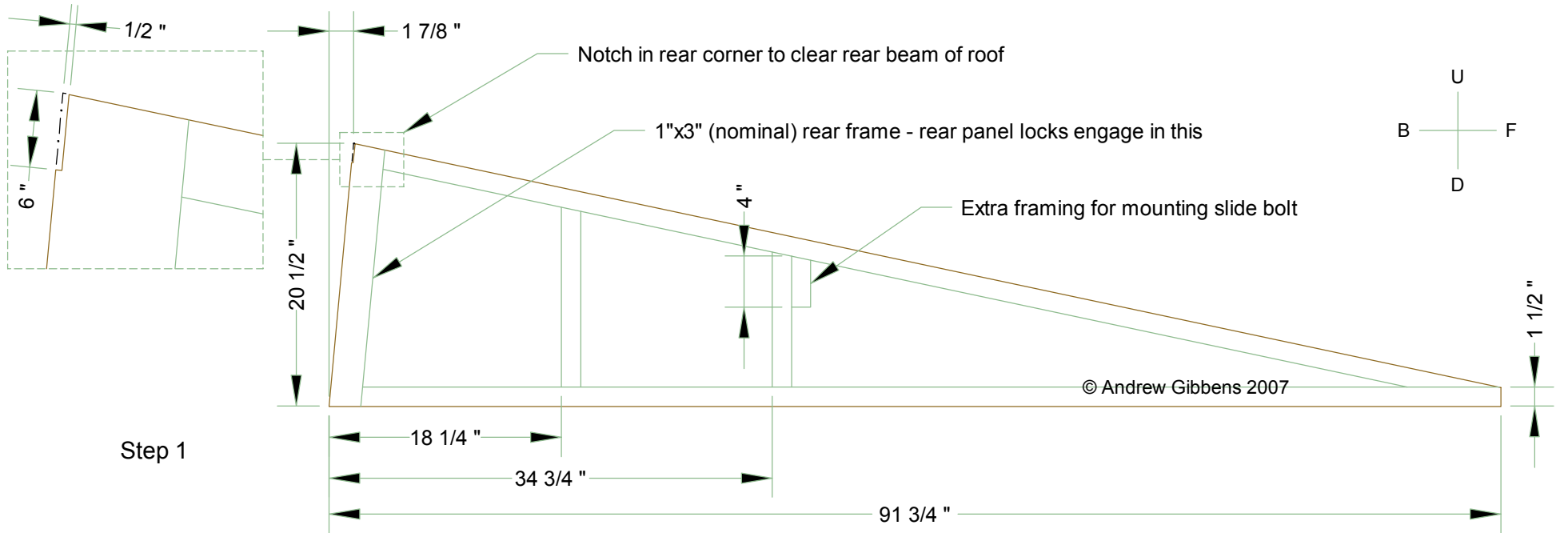
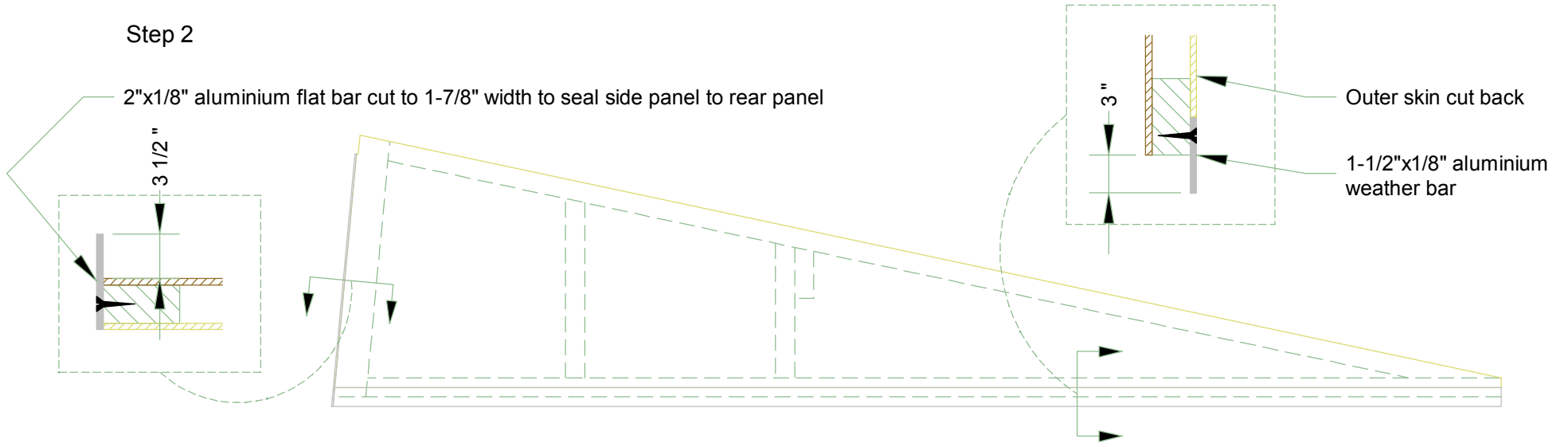

Step 1

NOTES:

1. Right side panel drawn. Left side similar, but reversed.
2. Inner and outer skins 1/8" ply, all framing 1"x2" (nominal), except as shown

ROOF 8
Side Folding Panels
1:12



Side View

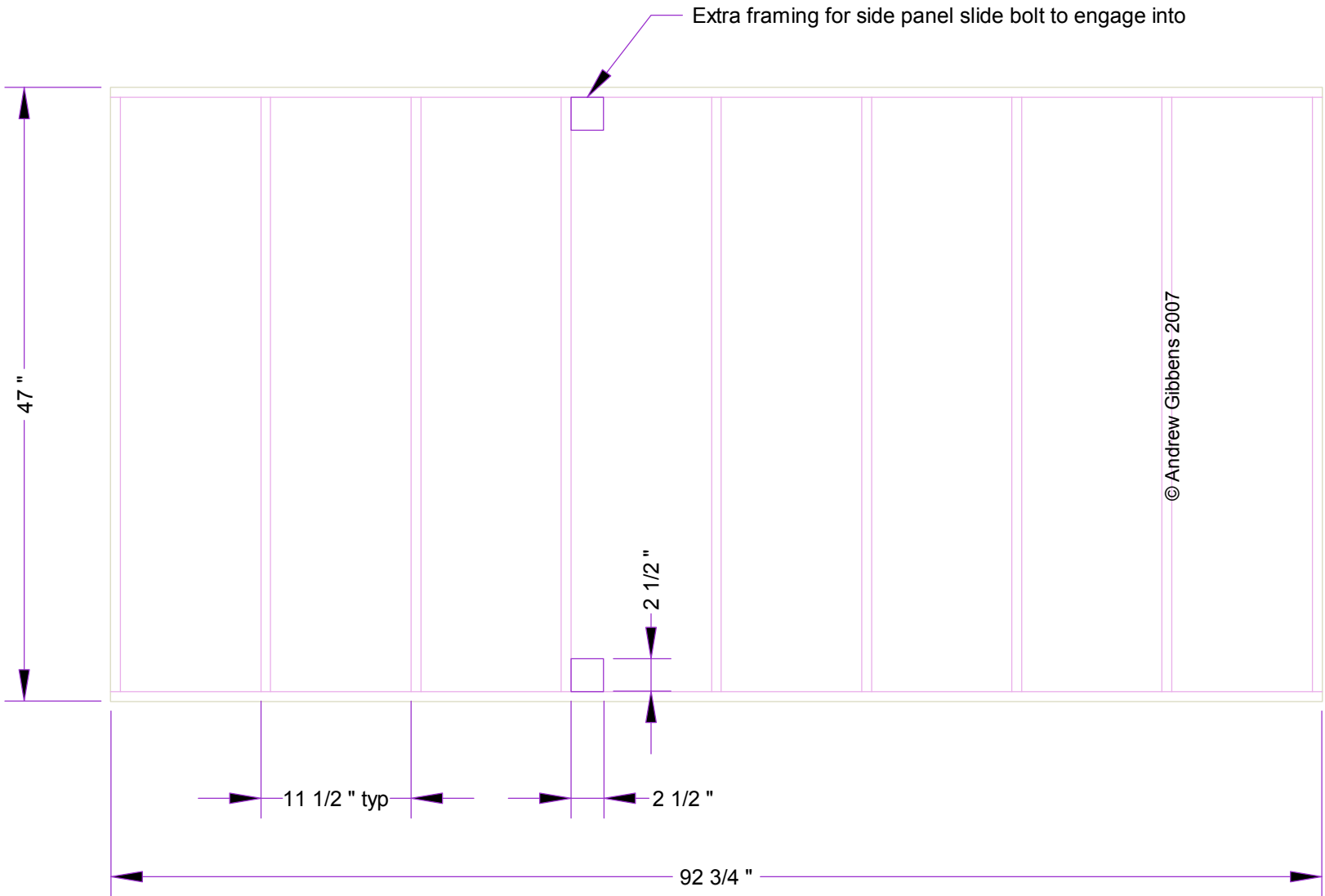

Plan View

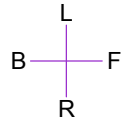

- NOTES:
1. Top drawn with outer skin missing to show framing.
 2. Inner and outer skins 1/8" ply, all framing 1"x1" (nominal)

ROOF 9
Top Panel 1/2
1:12

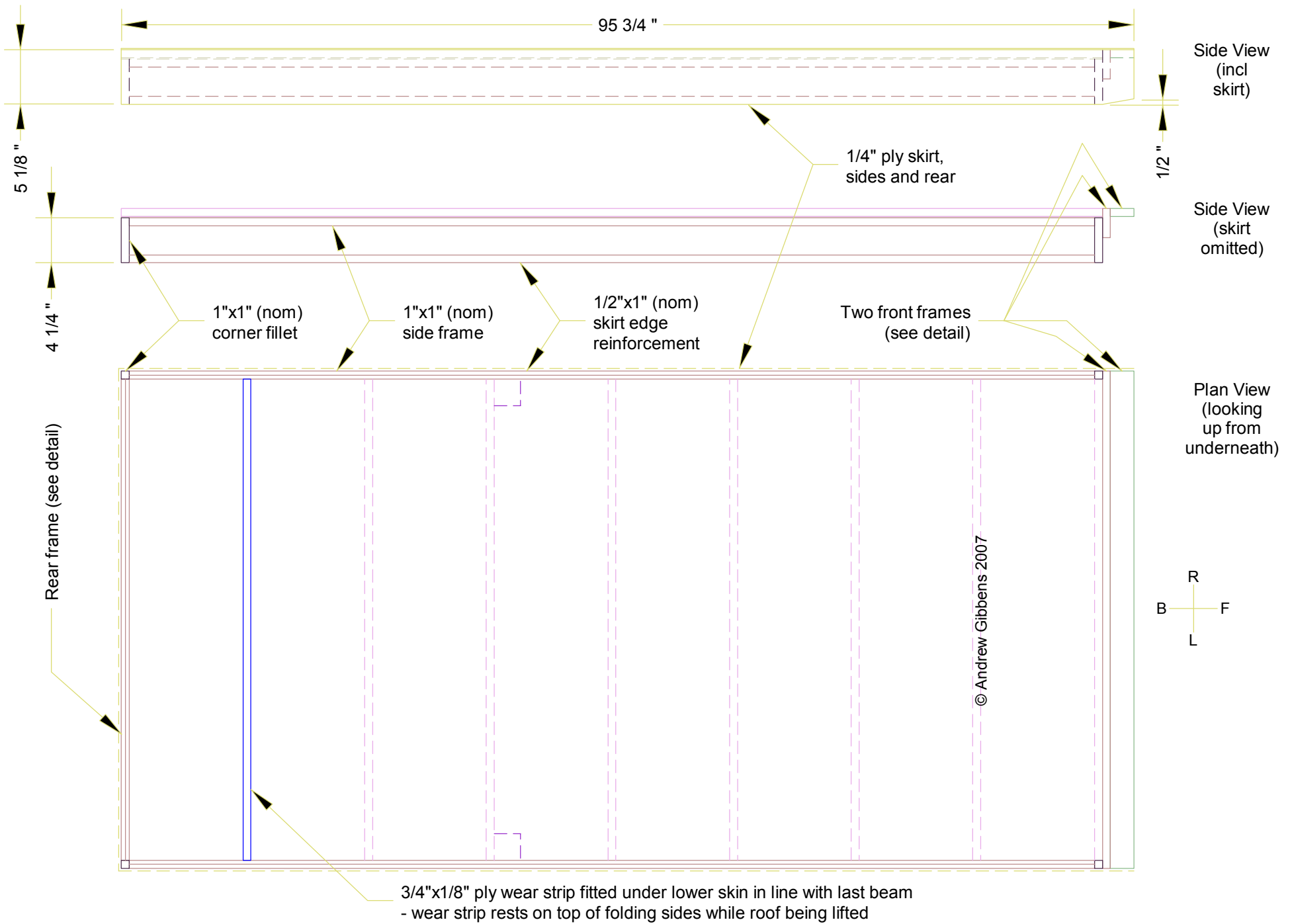

NOTES:
1. See next sheet for frame details

ROOF 10
Top Panel 2/2
1:12

Top Panel to Rear Panel Joint
(roof up)

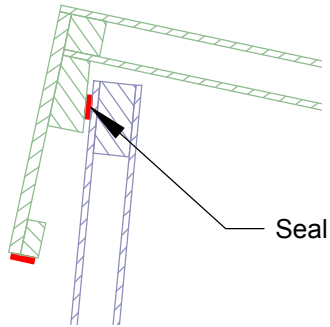
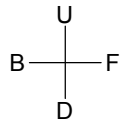

Seal

Top Panel to Roof Base Joint
(roof up)

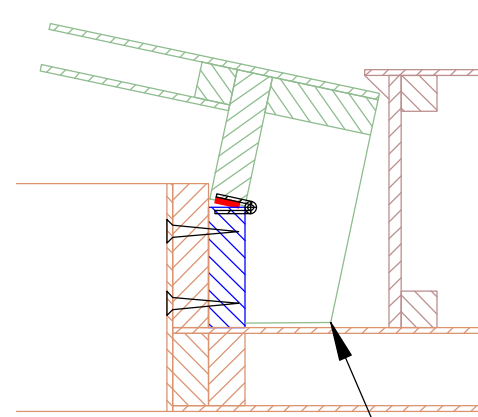
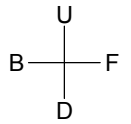

Roof fairing

Bottom of side panel cut away for clearance

Rear Panel to Roof Base Joint
(roof up)

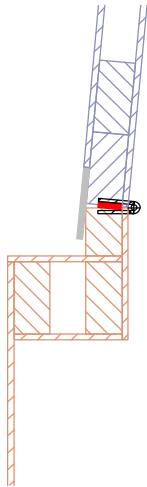
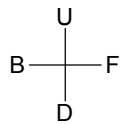

Rear Panel to Roof Base Joint
(roof down)

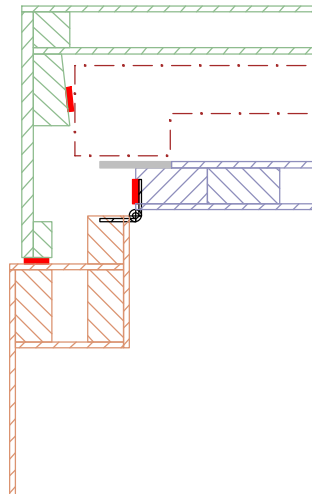

Outline of lowered side panel

Top Panel to Roof Base Joint
(roof down)

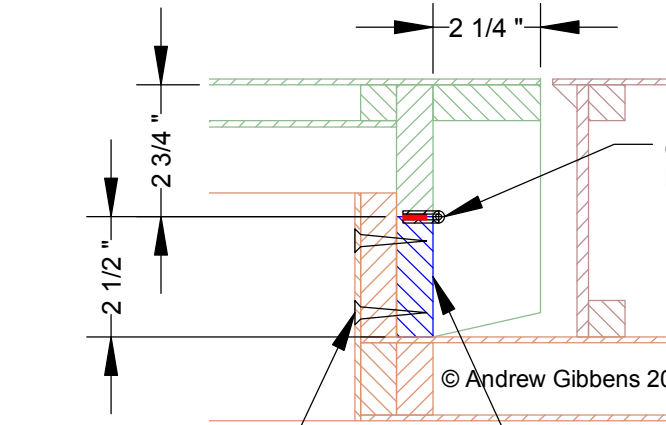

1-1/2" continuous hinge

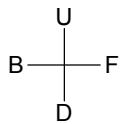

© Andrew Gibbens 2007

Screws or lag bolts hold hinge seat in place (and allow roof to be removed for maintenance)

1"x3" (nom) hinge seat

NOTES:

1. All seals are 1/2"x1/8" section (compressed).

Side Panel to Rear Panel Joint
(roof up)

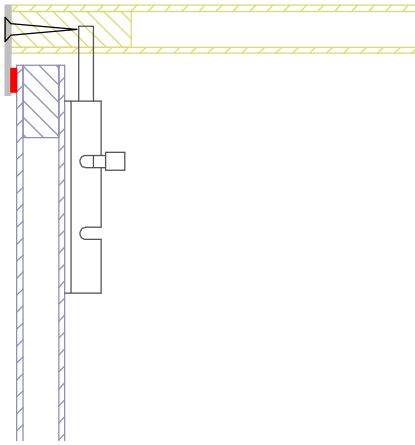
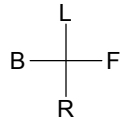

Top Panel to Side Panel Joint
(roof up)

Wear strip under top panel
sits on top of side panel

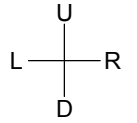
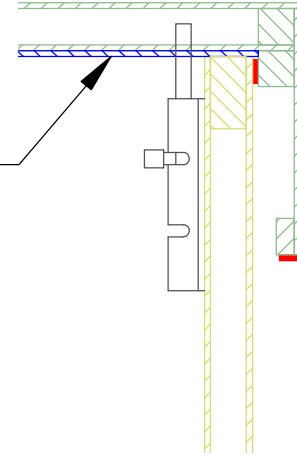

Side Panel to Roof Base Joint
(roof down)

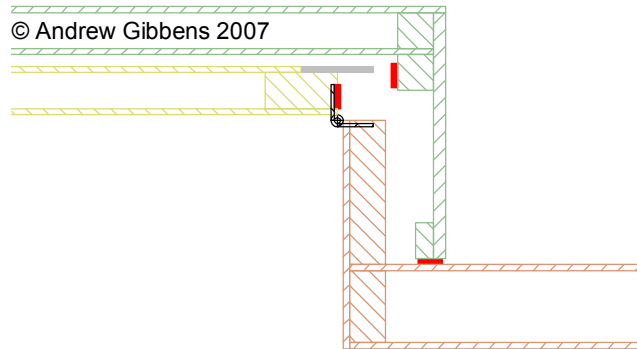
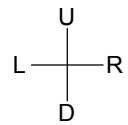

Side Panel to Roof Base Joint
(roof up)

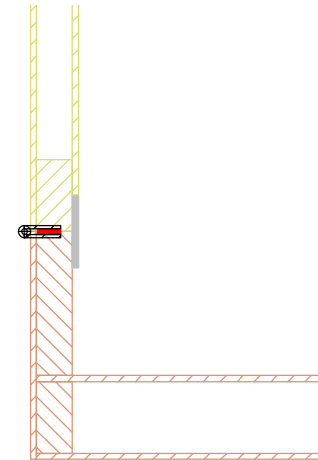
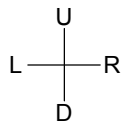

NOTES:
1. All seals are 1/2"x1/8" section (compressed).

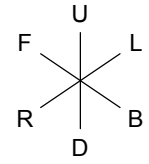

© Andrew Gibbens 2007

Barrel bolt on side panel
engages in top panel to
keep pressure on the seal
between the two panels

Wear strip under top panel carries
weight of top panel onto side panel

Barrel bolt on rear panel engages in side
panel to lock rear panel in raised position

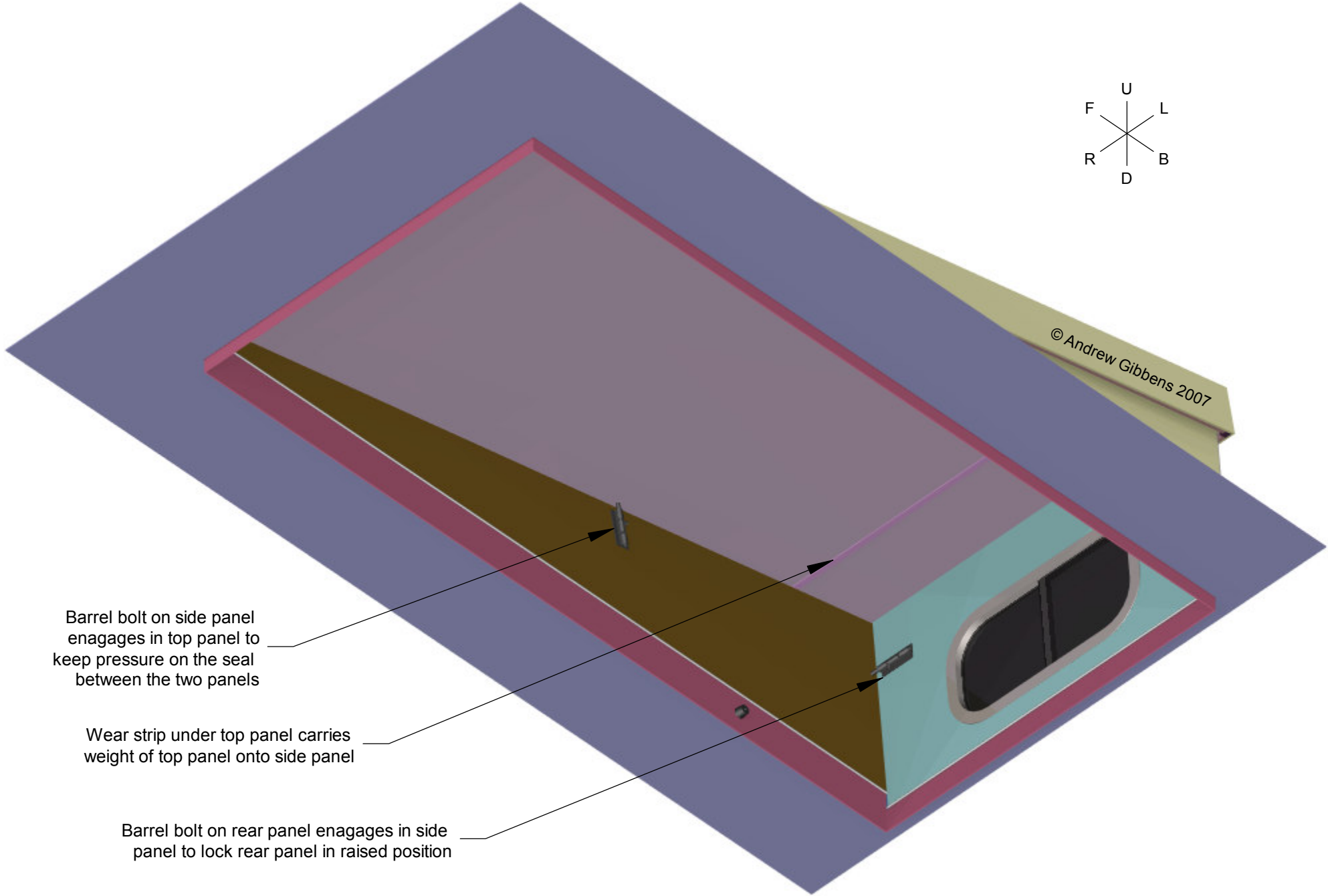

'Standard'
Side Panel to Rear Panel Joint
(roof up)

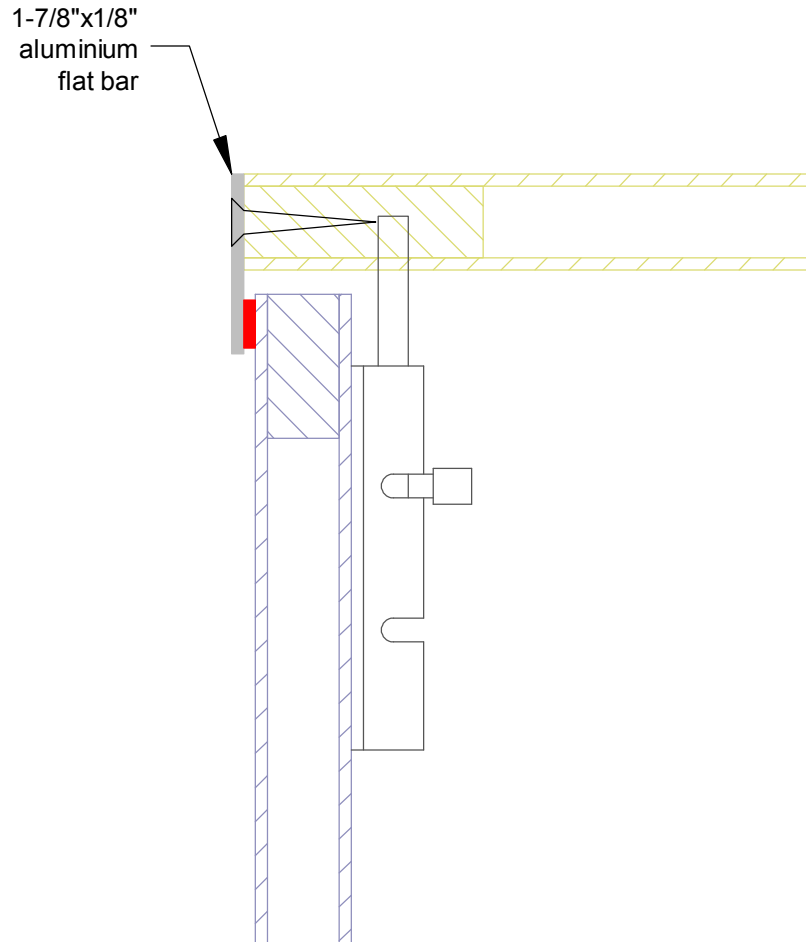

'Deluxe'
Side Panel to Rear Panel Joint
(roof up)

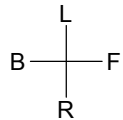
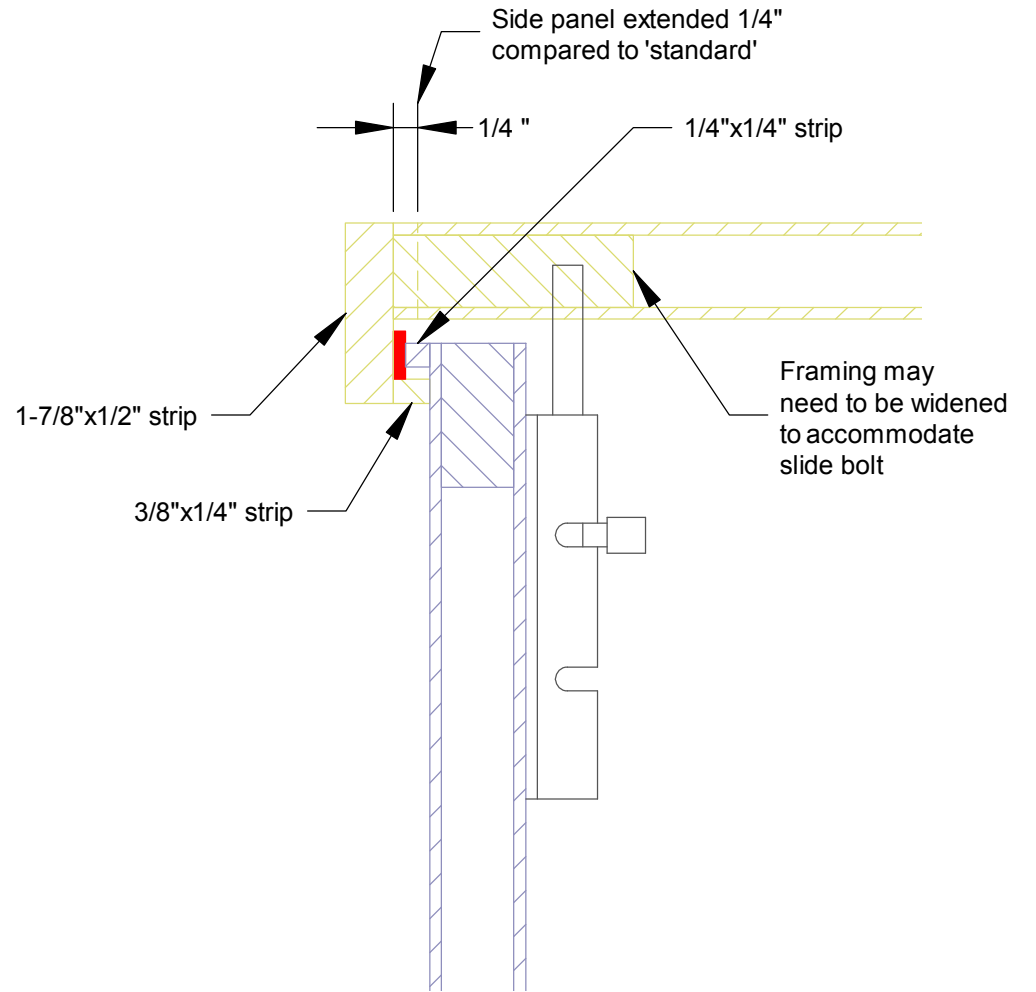

NOTES:
1. All seals are 1/2"x1/8" section (compressed).

ROOF 14
Alternative Side/Rear Joint Detail
1:2