

# BAYSIDE Cemetery

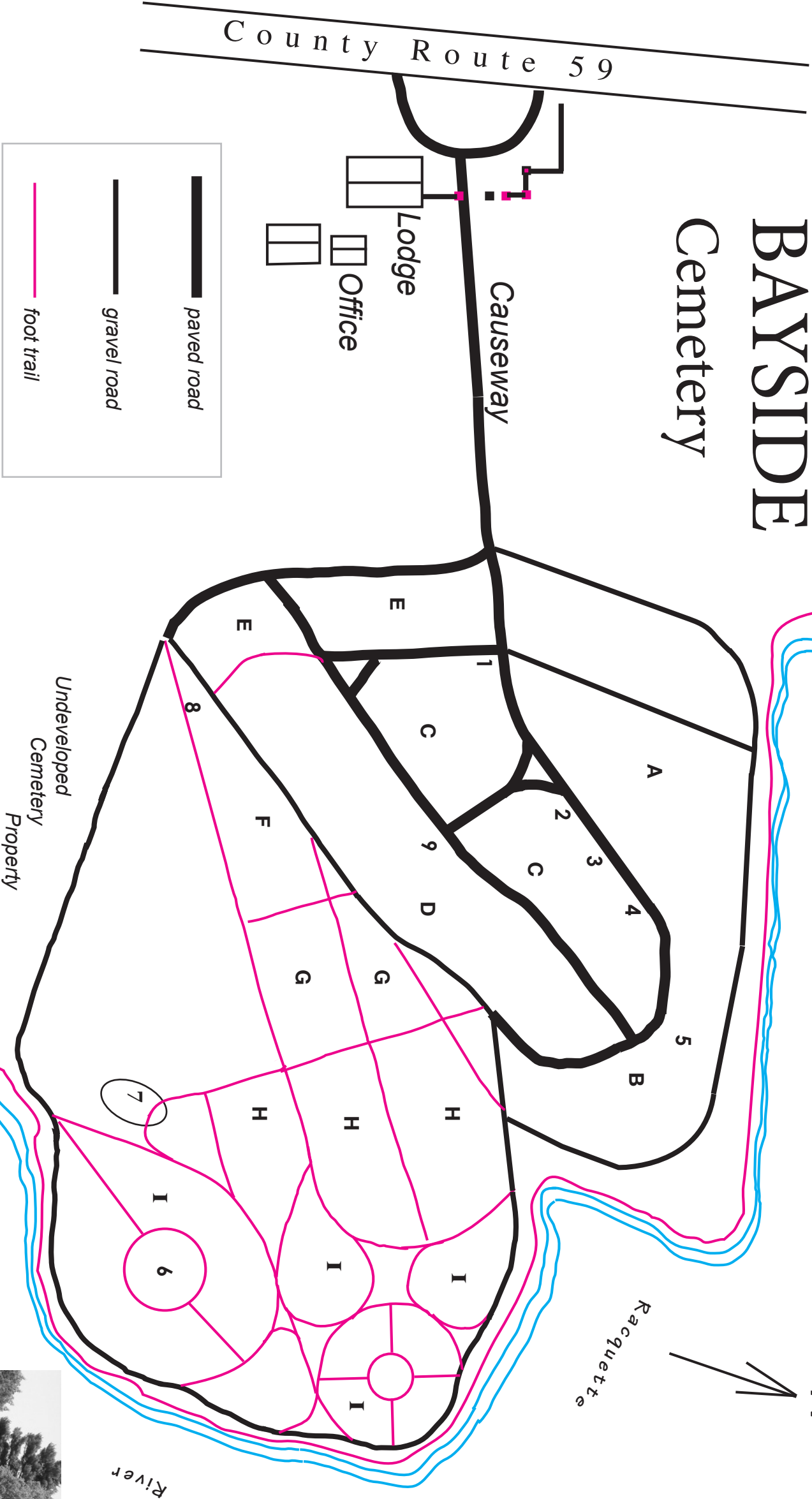

## Some Features of Interest

- 1 1891 Receiving Vault
- 2 Sanford Mausoleum
- 3 Crane Memorial
- 4 Snell Mausoleum
- 5 New Clarkson Mausoleum
- 6 Original Clarkson Mausoleum
- 7 The Pines Urn Garden
- 8 Early Headstones
- 9 Civil War Monument

A,B,C = lot sections

## Nature, Life, and Family

Bayside's founders carefully incorporated natural features such as hills, water, and trees with the cultural features of winding roads, tombstones, and memorials. The resulting landscape of restful beauty said to visitors and the bereaved that death was natural, and invited them to leave the bustle of the village street and return to this place often to reconnect with past family and friends, to contemplate nature, and to reflect on spiritual matters.

## Bayside Cemetery Association

Bayside Cemetery Association is a not-for-profit organization authorized to own and maintain the property and to sell rights to burial on it. It is managed by a board of 15 volunteer trustees, who serve rotating 3-year terms. The trustees manage an endowment, the income of which is combined with donations and service income to maintain the grounds and structures.







Lodge and entry to Bayside Cemetery

From Burial Ground to Rural Cemetery  
Bayside was established in 1865 under the direction of the Clarkson family and other influential members of Trinity Episcopal Church. It superseded earlier, simpler cemeteries in the Village of Potsdam, which were closed and their remains moved to Bayside.  
Bayside is a rural cemetery, meaning that it is outside of town, in a landscaped, park-like setting. It was modeled on Boston's Mount Auburn Cemetery, the first and most famous rural or garden cemetery, and designed by a Boston landscape architect, L. R. Briggs.

Bayside Lodge and Gateway  
In 1900, the Clarkson family initiated a major building program at Bayside. They hired Edgar Josselyn, a well-known New York architect, to design the gatehouse, or lodge. Josselyn had previously designed Old Main, Clarkson University's first and foremost building.  
The lodge, built in the fashionable chateau style of sandstone from Clarkson quarries, provided a residence for the sexton as well as facilities for funeral services.  
The features at Bayside's entryway are meant to establish a strong boundary between the bustling outside world and the quiet, contemplative world within.

Facilities  
The landscaped section of Bayside is about 40 acres, with several hundred feet of shoreline along the Racquette River. There have been about 6,000 interments in Bayside since its founding. In 1947 an additional 44 acres on the south side were acquired by gift and are currently retained as undeveloped woods.  
The sandstone office building is set unobtrusively behind the entryway. It is the site for conducting cemetery business.

*A Place to Connect with Friends, Family, and the Past*

**Visiting**  
Bayside is privately owned by a not-for-profit corporation, but its grounds are open to the public. Visitors are welcome every day of the year during daylight hours.

**Directions**  
The entrance to Bayside is near the village boundary on County Route 59, also known as "Back Hannawa Road," 0.2 miles from the intersection with U. S. Route 11.

**Entry Kiosk**  
Inside the sandstone gateway near the office you will find a kiosk displaying a map of the grounds, notices of current events, and copies of this brochure for self-guided tours.

**Etiquette**  
As an active burial ground, Bayside is a sacred and ceremonial site. Visitors are asked to show respect by their actions.



*An oasis—open to all—for serenity, solace, and inspiration*

**Community Support**  
As a 501 (c) 13 tax-exempt charitable organization, Bayside Cemetery Association depends upon donations from appreciative citizens to restore and maintain the structures and landscaping that make it a distinctive community amenity. Donations of any amount are always welcome and are tax-deductible.

To make a donation, go to [baysidepotsdam.org/donate](https://baysidepotsdam.org/donate) or mail your donation to PO Box 491, Potsdam NY 13676.

Similarly, volunteers are invited to help in improvement projects, landscaping, and repairs.

To volunteer or discuss a donation, contact our president, Mark Lee, at [info@baysidepotsdam.org](mailto:info@baysidepotsdam.org)

**Inquiries**  
For information about persons interred in Bayside or about purchasing interment sites, contact the sexton, whose office is just inside the front gate:

Lorelei Murdie, Sexton  
315/265-3790  
[info@baysidepotsdam.org](mailto:info@baysidepotsdam.org)

**BAYSIDE**  
(established 1865)

*A Fine Example of a Rural Cemetery in Northern New York*

*A Community Resource Blending Architecture and Landscape*



*Placed on the National Register of Historic Places in 2002 for its architectural and historical significance*

**VISITORS WELCOME**

Bayside Cemetery Association  
730 County Route 59  
P. O. Box 491, Potsdam, NY 13676  
[baysidepotsdam.org](https://baysidepotsdam.org)  
[Facebook.com/BaysideCemeteryPotsdam](https://Facebook.com/BaysideCemeteryPotsdam)