

Christmas card Gift Box Craft

Materials Needed

1. Christmas card – any size but not too long. The picture should be in center.
2. Scissors
3. Pencil or marker
4. Ruler or straight edge (maybe another Christmas card.
5. Tape.

Preparations

Your table should be covered with paper or plastic to prevent damage or marking

Have 4 small (inch or 3 centimeters long) pieces of tape ready to use

Instructions

1. Cut the card in half down the fold center.
 - a. The side with the picture on it will be the top
 - b. The other side will be the bottom.
2. Cut from the bottom 1/4 inch off along the length and the width
3. Find the center of the top. Not the side with the picture.
 - a. Using ruler or straight edge make an X in the center by going from corner to opposite corner.
The center of the X is the center of the card.
4. Find the center of the bottom. The mark should be on the side you want for the inside.
 - a. Using ruler or straight edge make an X in the center by going from corner to opposite corner.
The center of the X is the center of the card.
5. On both top and Bottom; Fold the 2 end to the middle of the card so they are touching.
6. Unfold and do the same on the other sides
7. From the ends cut down the crease to where the crease join. There should be four cuts.
 - a. For ease of folding, cut small (¼ inch) V shape from both ends of the center cutting towards the point where the two creases join. There should be four cuts.
8. Form the Box by
 - a. Folding the edge along the with and then folding inward again the two narrow strips so that they are joined together while the center part is still lying flat.
 - b. Fold the center part up and fold over the two lengths forming a box.
 - c. Tape edge to secure.
9. Repeat with both sides.
10. Place the top over the bottom completing the gift box.

Christmas Card Gift Box Instructions by Pictures page1



1
Used Christmas card



2
#1 in printed instructions



3
#2 in printed instructions

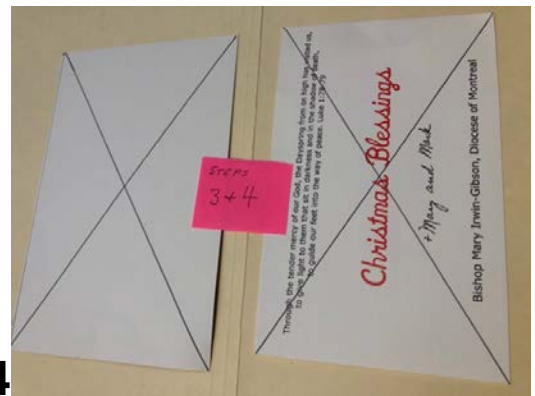

4
#3 & 4 in printed instructions

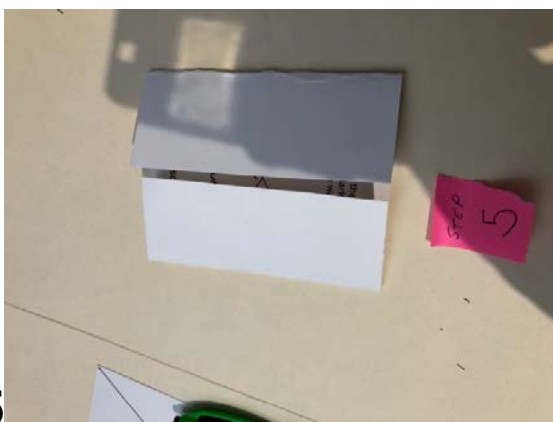

5
5 in printed instructions

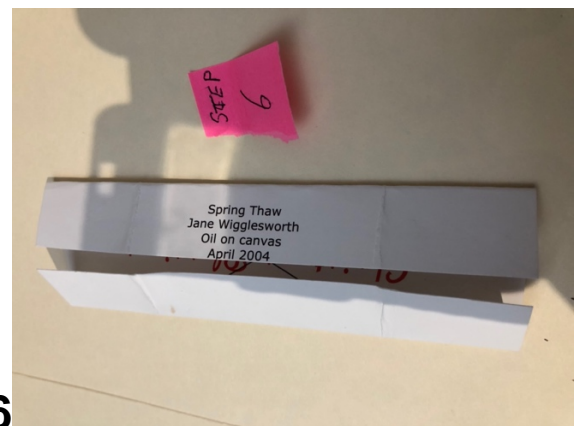

6
6 in printed instructions

Christmas Card Gift Box

Instructions by Pictures page 2

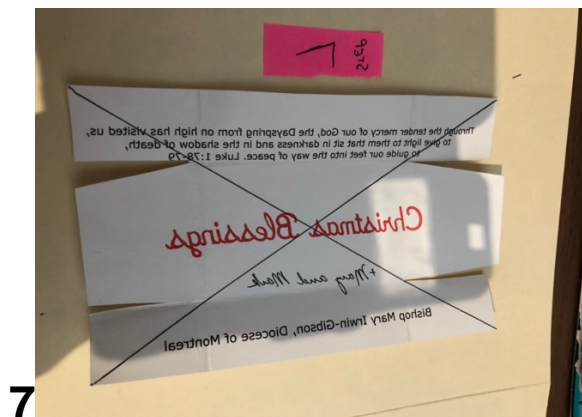

7
7 in printed instructions

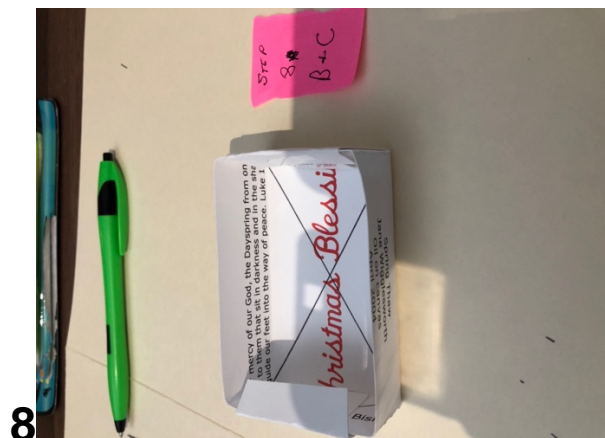

8
8 in printed instructions



9
10 in printed instructions