



# IMMANUEL BATAVIA EAGLE INVITATIONAL

## BASKETBALL TOURNAMENT

FEBRUARY 8-10, 2019

WELCOME PACKET





## WELCOME FRIENDS!

Thank you for your participation in the inaugural Immanuel Batavia Eagle Invitational Tournament! We hope your players, coaches, family members, and students will enjoy the tournament, as well as the awesome [dance name] event on Saturday evening.

Please take the time to thoroughly read all of the tournament information, and share [this link](#) with your team, families, and students to ensure all are fully informed of tournament policies and general information.

We pray your school will have a safe and enjoyable tournament experience at Immanuel Lutheran Church and School. If you have any questions after going through this online packet, please contact the school office at 630 406 0157 or [school@immanuelbatavia.org](mailto:school@immanuelbatavia.org).

In His Service,

Donna Laughlin  
Principal

# TOURNAMENT CONTACT INFORMATION

## TOURNAMENT VENUE

Immanuel Lutheran Church and School, 950 Hart Road, Batavia, Illinois 60510

Church Office                      630 879 7163                      [church@immanuelbatavia.org](mailto:church@immanuelbatavia.org)

School Office                      630 406 0157                      [school@immanuelbatavia.org](mailto:school@immanuelbatavia.org)

## SCHOOL PRINCIPAL

Donna Laughlin                      630 406 0157                      [dlaughlin@immanuelbatavia.org](mailto:dlaughlin@immanuelbatavia.org)

## TOURNAMENT DIRECTOR

John Lejeck                      630 649 1681                      [johnlejeck@yahoo.com](mailto:johnlejeck@yahoo.com)

## IMMANUEL ATHLETIC DIRECTOR

Sharon Dalpini                      630 406 0157                      [sdalpini@immanuelbatavia.org](mailto:sdalpini@immanuelbatavia.org)

## COMMUNICATIONS DIRECTOR

Lori Ward St. Vincent                      630 879 7163                      [lstvincent@immanuelbatavia.org](mailto:lstvincent@immanuelbatavia.org)



# TOURNAMENT SCHEDULE

## FRI., FEB. 8

- 6 PM St. Paul-Rochelle v Bethany-Naperville
- 7:15 PM Immanuel-Batavia v Immanuel-Elmhurst
- 8:30 PM St. Irene-Warrenville v Immanuel-Freeport

## SAT., Feb 9

- 9:30 AM Central Lutheran-New Haven v St. Andrew-Park Ridge
- 10:45 AM Consolation Semi-Final Game
- 12 PM Semi-Final Game
- 1:15 PM Free Throw and Three Point Competition
- 2:30 PM Consolation Semi-Final Game
- 3:45 PM Semi-Final Game
- 5:30 PM Traditional worship service • Please join us!
- 6:30 PM Neon Night dance

## SUN., Feb 10

- 8 AM Traditional worship service • Please join us!
- 9:30 AM Traditional worship service • Please join us!
- 11 AM Contemporary worship service • Please join us!
- 12 PM Seventh Place Game
- 1:15 PM Consolation Championship
- 2:30 PM Third Place Game
- 3:45 PM Championship Game

## ADMISSION

Weekend Passes: \$25 Family, \$12 Adults, \$7 Students, Age five and under free

Daily Passes: \$5 Adults, \$3 Students, Age five and under free

## AWARDS

First Place, Second Place, Third Place, Consolation, and Sportsmanship trophies will be awarded.

## CONCESSIONS

Immanuel's Eagles Boosters offer a variety of food and beverage options for your convenience. The Concession Stand is located in the gymnasium near the east side bleacher exit and is a great place to grab food and refreshments including soft drinks, sandwiches, candy, and other snacks.

# FIRST AID

A First Aid responder will be on-site at all times during the tournament. All full-time staff are First Aid, AED, and CPR certified. It is important to remember that First Aid responders are not medical doctors. They provide basic first aid, determine the severity of injuries, and make recommendations as to whether or not a player should see a doctor or go to an emergency room.

# HANDICAP ACCESSIBILITY

Immanuel is completely handicap accessible. To inquire about special arrangements or to learn more, please contact the school office at [school@immanuelbatavia.org](mailto:school@immanuelbatavia.org).

# LIVE STREAM

Games will be live streamed on hallway and lobby screens throughout the building.

# SPORTSMANSHIP

It is expected that players, coaches, fans, and officials will be respectful and Christ-like all interactions during the tournament. To that end, the Sportsmanship Policy of Immanuel Lutheran Church and School is as follows

“Immanuel athletes and fans, and those who choose to participate in athletic contests at our facility, consider all opponents as friends and guests. They treat them with courtesy and respect. Players and fans accept the decisions of the officials and refrain from abusive remarks from the sidelines. Immanuel fans applaud our team and our opponents and reflect Christian conduct and sportsmanship.”

# TEAM HOSPITALITY ROOMS

Hospitality rooms are provided for each team where players can change, if necessary, and leave their outerwear and sports bags. It is recommended, however, that players come dressed for play. Immanuel is not responsible for valuables left in these hospitality rooms. Please take all valuables with you, give them to a family member, or leave them at home. We ask all participants to be respectful of our facility, including the hospitality room, which function as Immanuel Lutheran Church and School's day school and Sunday School classrooms the rest of the year.

# RESTAURANTS / SHOPPING

**Arby's**, 144 S. Randall Rd., Batavia (2.9 miles)  
**Chili's**, 491 N. Randall Rd., Batavia (3.6 miles)  
**Country House**, 2095 S. Kirk Rd., Geneva (3.4 miles)  
**Culver's**, 111 S. Randall Rd., St. Charles (3.9 miles)  
**TGI Friday's**, 490 N. Randall Rd., Batavia (3.4 miles)  
**IHOP**, 125 Smith Rd., St. Charles (7.8 miles)  
**McDonald's**, 125 W. Wilson St., Batavia (1.3 miles)  
**Pal Joey's**, 2030 Main St., Batavia (3.1 miles)  
**Portillo's**, 531 N. Randall Rd., Batavia (4.3 miles)  
**Starbucks**, 2948 Kirk Rd., Aurora (3.4 miles)  
**Starbucks**, 115 N. Randall Rd., Batavia (4.3 miles, located in Target)  
**Subway**, 324 E. Wilson St., Batavia (3 miles)  
**Taco Bell**, 134 S. Randall Rd., Batavia (4.3 miles)  
**Wendy's**, 1905 W. Wilson St., Batavia (4.3 miles)

**CVS**, 765 E. State St., Geneva (0.9 miles)  
**Jewel/Osco**, 119 S. Randall Rd., Batavia (4.5 miles)  
**Target**, 115 N. Randall Rd., Batavia (4.3 miles)  
**Walgreen's**, 122 W. Wilson St., Batavia (3.2 miles)

# TICKETS

Weekend Passes: \$25 Family, \$12 Adults, \$7 Students, Age five and under free  
Daily Passes: \$5 Adults, \$3 Students, Age five and under free

# TOURNAMENT T-SHIRTS

Follow this link to purchase tournament shirts: <https://stores.inksoft.com/tourney2/shop/home>

# WEBSITE INFORMATION

Immanuel Lutheran School homepage: [ilsbatavia.org](http://ilsbatavia.org)  
Immanuel Lutheran Church homepage: [immanuelbatavia.org](http://immanuelbatavia.org)

# NEON NIGHT DANCE

Neon Night will be held in the gymnasium on Sat., Feb. 9, 6:30-8:30 PM. Tickets are \$10 each, which includes one slice pizza, soft drink, and dessert. Additional soft drinks and snacks will be available for purchase at \$1 each; additional slices of pizza for \$3 each. The dance will feature music provided by A+DJ. Participants are asked to wear white or neon colors and bring glow sticks. Additional glow sticks will be available for purchase at the dance. Please download and print the ticket/permission slip on the next page and follow the instructions provided.

# TOURNAMENT BRACKET

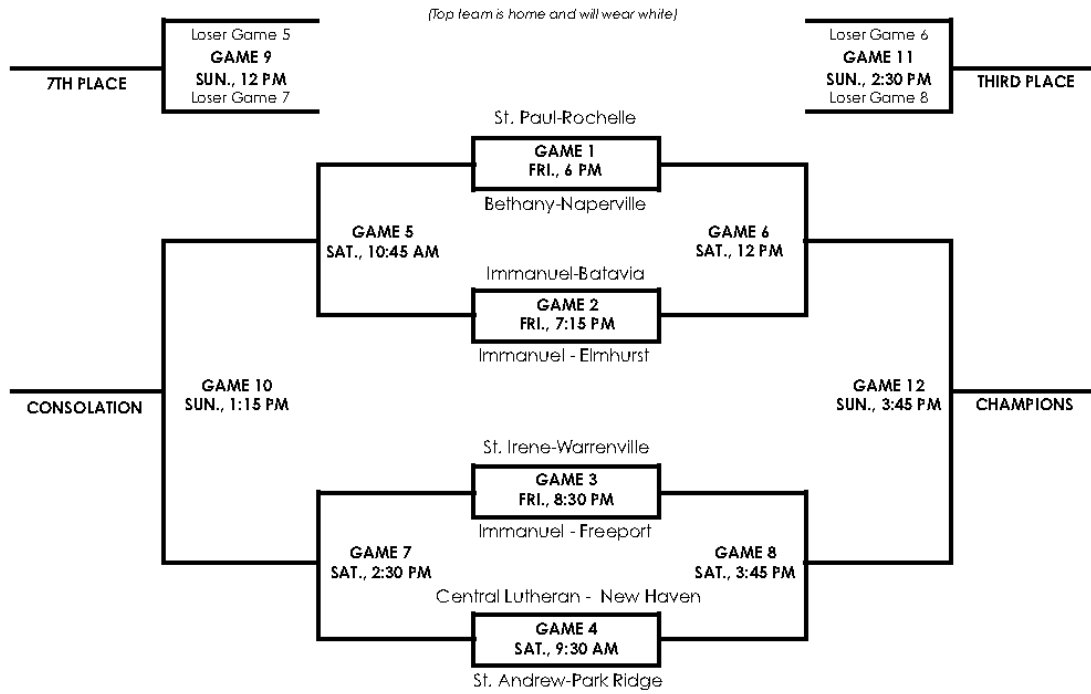

# IMMANUEL CAMPUS MAP

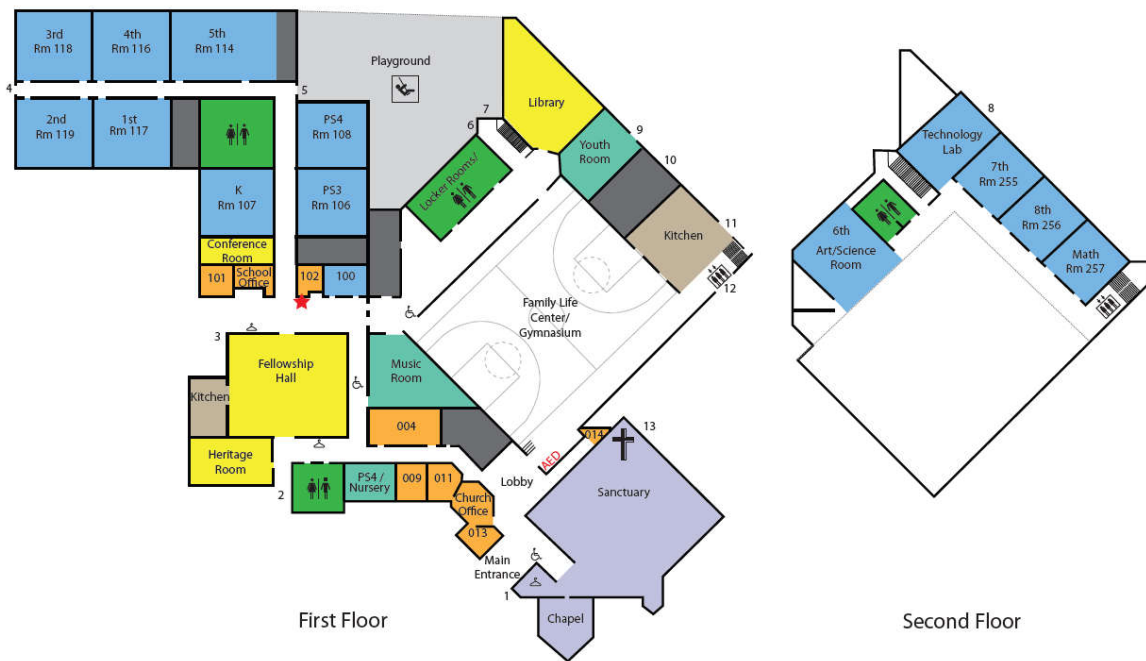

# LOCAL AREA MAP

A local map is available [here](#).



IMMANUEL LUTHERAN CHURCH AND SCHOOL

BATAVIA, ILLINOIS