

**Women's Walk #180  
First United Methodist Church Downtown Tulsa  
1115 S. Boulder Ave.  
Tulsa, Oklahoma**

**Please Note the Following Important Changes**

- 1.** It is **extremely** important that we wear our name tags at all times, doing so will identify us to all church staff that we are supposed to be in the building!
- 2. Volunteers:** The only entrance to the building will be off 11th and Main. This is under the covered drive-through. There will be a buzzer just left of the covered drive-through entrance. Using the buzzer will alert staff to open the entrance for you.

All volunteers **must** report to **Thomas Hall**. Turn left upon entering the building then proceed to Thomas Hall. There will be signs. See the building map following the facilities parking map.

**Wednesday evening on November 7th at 7:30PM we will begin preparations for the Emmaus Walk.**

**Do not arrive before 7:30PM as the church will be having activities in the rooms we will need to have access to.**

Emmaus facilities will have our equipment pod in place and will need additional assistance to unpack the pod, inflate air mattresses, assemble curtains and unpack groceries.

Many Emmaus community members volunteering will ensure we will complete these tasks before 10:00PM. See the following map for parking areas when volunteering.

Plan ahead to make a difference! Facilities (Adam Province) will be onsite to

FACILITIES

# MAPS

**1115 South Boulder Avenue  
Tulsa, OK 74119**

**918.592.3862**

**fumctulsa.org**

-  Church Facilities
-  Available Parking
-  Sunday Parking



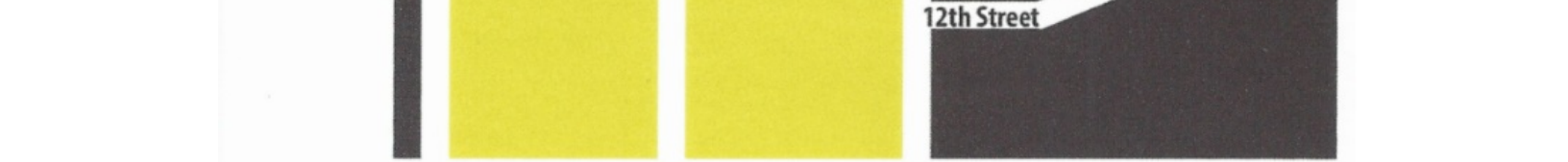

Continue reading for the many opportunities to serve behind the scenes during the Emmaus weekend.

Help is always needed in the Kitchen for meal preparation, washing of dishes and placing the meal on a serving dish. Volunteering in the Dining Room? You will help set and decorate tables, serve the meal (if you are not a sponsor) and of course dining room clean-up. As you can imagine this is repeated throughout the day until the last meal is served, the dining room is cleaned up and pre-prepared items for the next day are stored and ready. Keep in mind the kitchen manager can best use you if you tell them ahead of time when you will be available. [[Contact Chris Bunn at crsbunn@icloud.com](mailto:crsbunn@icloud.com)]

The kitchen is open at 6:00 am to insure coffee is prepared and breakfast items are in place and ready for preparation.

At 6:30AM Communion is served each morning in the Kitchen. All are welcome!

**Please remember we need agape to bless the pilgrims during their meals. Each agape project you provide for the Walk must have at least 65 pieces.**

## **WEDNESDAY, November 7th**

### **Setup begins at 7:30PM at FUMC of Tulsa.**

The Storage Pod will be unloaded, supplies moved into the church building, mattresses will be aired up and there will be great fellowship in the preparations!

## **THURSDAY, November 8th**

### **Preparation for send-off will begin at 4:00PM.**

Help will be needed prepping food for Friday, preparing snacks and setting up for send-off. We need many hands in the kitchen and dining area Thursday night!

### **Send-off will begin at 7:00PM in Thomas Hall.**



Registration for the pilgrims will be located in the entrance under the main street covered parking area. See the map below.

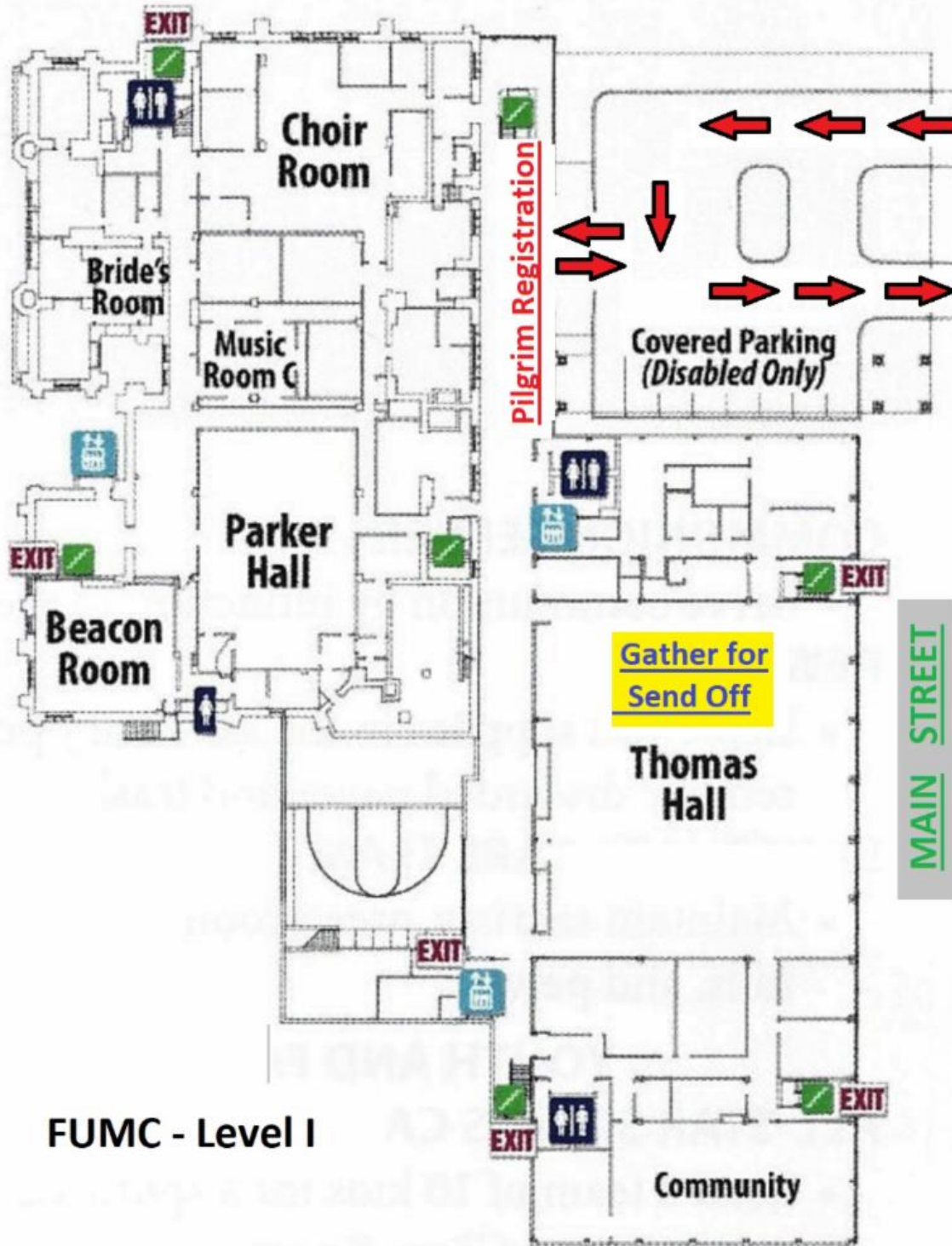

FUMC - Level I

**Registration Table: Needs help at 6:45 taking luggage to the sleeping area.**

**Sponsors' Hour will immediately follow send-off. Be sure you are there to pray over your pilgrim's cross.**

**Sponsor's** -- after Sponsor's Hour... remember to make your pilgrim's beds!

## FRIDAY, November 9th

**Friday can be a challenge as you may know. As it is a weekday and volunteers are at a premium. Our kitchen managers are stretched very thin today. If you are planning to volunteer, your help can change our Friday challenge into a smooth routine!**

**Arrive at least an hour before meals are served (times in table below) this gives the kitchen manager time to assign tasks and provide assistance to volunteers.**

**This is true for the dining room, and snack managers.**

**After meals many hands make light work to clear tables and wash dishes.**

Breakfast	Lunch	Dinner
8:00 am	12:25 pm	5:25 pm

Lay and clergy speakers value our prayers. Talk times are below and the **Prayer Room is always open!** Speakers are brought to the Prayer Room approx. 20 minutes before the Talk.

9:15 am	Priority	Gail Stunkard
11:15 am	Prevenient Grace	Jessica Moffatt
1:45 pm	Priesthood of All Believers	Cari Fryman
3:00 pm	Justifying Grace	Sara Pugh-Montgomery
6:30 pm	Life of Piety	Gail Mangan

## SATURDAY, November 10th

Breakfast	Lunch	Dinner
7:45 am	12:00 pm	5:40 pm

8:45 am	Grow Through Study	Stacy Reaves
10:30 am	Means of Grace	Katie Hill
3:00 pm	Christian Action	Janet Meshek
4:30 pm	Obstacles to Grace	James Graham
7:00 pm	Discipleship	Christine Leeviraphan

**7:30 pm - Community Gathering & Candlelight. Bring a snack to share!** Bring your children to the Gathering & Candlelight.

A sanctuary filled with candlelight is a torch for Christ on Saturday night . If you aren't able to attend the entire gathering, please arrive by **9:30 pm for candlelight.**

## **SUNDAY, November 11th**

Sunday morning we return the church to its original configuration. This is a well organized operation and volunteers make it a snap.

We start with sleeping rooms, deflating and packing up the air mattresses (often pilgrims have the mattresses deflated), clean and vacuum the rooms, and return furniture to its original location.

Morning assistance in the kitchen is needed to pack up remaining inventory to be stored until the women's walk. Other Emmaus property and equipment will be packed for return to the storage pod as well.

Volunteers will be directed by Facilities board member Adam Province.

Have questions? Adam may be reached via phone at 918.264.5151.

Breakfast	Lunch
7:25 am	12:25 pm

8:40 am	Changing Our World	Nancy Rowland
9:40 am	Sanctifying Grace	Darrell Cates
10:40 am	Body of Christ	Winter Alcorn
11:40 am	Perseverance	Anna Ribordy
1:50 pm	Fourth Day	Janice Heard

### **3:45 pm - Closing in the Sanctuary**

*While they were talking and discussing, Jesus himself came near and walked with them. - Luke 24:15*

Green Country Walk To Emmaus  
<http://www.greencountryemmaus.com>

Click the icon below for facebook.

