

**LUTHERAN CHURCH OF OUR REDEEMER / REDEEMER LUTHERAN SCHOOL
DIRECTORY OF SERVICES AND MINISTRIES**



Lutheran Church of Our Redeemer / Redeemer Lutheran School

705 Southway Boulevard East, Kokomo, Indiana 46902

Rev. Barry A. Akers, Associate Pastor

Mr. Eric Frisco, RLS Principal

Church Phone: (765) 453-0969

Church E-Mail: LCOR@Redeemerkokomo.org

Church Website: <http://www.lcorkokomo.org/>

School Phone: [765] 864-6466

School E-Mail: RLS@Redeemerkokomo.org

School Website: <http://www.redeemerlutheranschoolkokomo.org/>

WELCOME

Greetings! We extend a hearty welcome to you today. It is our desire to encourage everyone to grow in love and faith as they follow Jesus.

Now there are varieties of gifts, but the same Spirit; and there are varieties of services, but the same Lord; and there are varieties of activities, but it is the same God who activates all of them in everyone. To each is given the manifestation of the Spirit for the common good. To one is given through the Spirit the utterance of wisdom, and to another the utterance of knowledge according to the same Spirit, to another faith by the same Spirit, to another gifts of healing by the one Spirit, to another the working of miracles, to another prophecy, to another the discernment of spirits, to another various kinds of tongues, to another the interpretation of tongues. All these are activated by one and the same Spirit, who allots to each one individually just as the Spirit chooses. I Corinthians 12:4-11

Our Father created each of us with our own unique gifts. Often we look at these differences as weaknesses. Wouldn't the world be so much easier if everyone thought like me? In the verse above, Paul reminds us that these differences are God's design for His universe. Even though we are all sinners and fall short of God's plan for us alone, when we put all our gifts together, we can do His will. So this diversity that may first appear chaotic, is shown to be the most beautiful part of God's creation! And so it is with Lutheran Church of Our Redeemer, and Redeemer Lutheran School. For God's calling of Lutheran Church of Our Redeemer to be fully realized, each of us must apply our varying gifts. Our Saturday and Sunday worship is made beautiful to God when we all participate; each of our voices raised in praise. Our committees achieve all they can when many members with different ideas work together. Hard work is made easy when we all share the load. This booklet attempts to explain the different activities, groups, and boards that exist at Lutheran Church of Our Redeemer. We are certain that all our members will find areas to use their gifts here. These activities are not just for those with special interests or spare time. It takes ALL of us together to make the church's ministry all that God wants it to be. Please read the items and announcements in this folder to discover how God has planned a place for you and yours in this exciting and growing church of Jesus Christ. May God bless you and love you abundantly.

Your Servants,

Rev. Barry A. Akers, Associate Pastor

Mr. Eric Frisco, RLS Principal

TABLE OF CONTENTS

<u>WELCOME</u>	pg. 1
<u>SPIRITUAL GROWTH OPPORTUNITIES</u>	pgs. 2-3
Do you want to learn more about God's Word and how to live it? See our worship schedule, educational programs and the many Bible Studies we offer.	
<u>SERVICE OPPORTUNITIES</u>	pgs. 4-5
Do you want to use your talents and skills in helping other people? There are many ways to put your gifts and abilities to use.	
<u>SUPPORT OPPORTUNITIES</u>	pgs. 6-8
Do you need help physically, emotionally, or spiritually? Here are some ways we may be able to meet your needs.	
<u>FELLOWSHIP OPPORTUNITIES</u>	pg. 8
Do you want to enjoy the company of your brothers and sisters in Christ? We have programs for all ages.	
<u>HOLY COMMUNION</u>	pgs. 8-9
Do you want to learn more about the Holy Sacraments? Here is an explanation of Holy Communion in the Lutheran Church.	
<u>CONTACTS</u>	pg. 9
<u>MISSION STATEMENTS, OUR PASTOR, RLS PRINCIPAL, CHURCH AND SCHOOL STAFF</u>	pg. 10
<u>MAPS OF LUTHERAN CHURCH OF OUR REDEEMER / REDEEMER LUTHERAN SCHOOL</u>	pg. 11
<u>ROOM ASSIGNMENT LIST</u>	pg. 12

A. SPIRITUAL GROWTH OPPORTUNITIES [101 - 103]

COMMUNION WORSHIP SERVICE OPTIONS

INSIDE WORSHIP SERVICES

Inside worship services are held each weekend, **Saturday's at 5:30 pm** and **Sundays at 9:30 am**. Our capacity is **100** in the **sanctuary**, **15** in the **balcony** and an overflow of **60** in the **Fellowship Hall** if necessary. That limits worship to **175** at each service.

LIVE STREAMED OR ON DEMAND

For those who are not ready to return to the sanctuary at this time, the **9:30 am** service will be **live-streamed** on our **Facebook page**, <https://www.facebook.com/LCORKokomo/>. After the service it can be watched on demand on www.LCORKokomo.org/.

DRIVE-IN SERVICE

Want to come to church, but hesitant to come inside. Join us in the parking lot at **9:30 AM** on **Sunday mornings**. Drive through to the narthex doors to receive your bulletin and communion set from an usher. Park in the lot and **tune your radio to 89.1 FM** and worship along with your brothers and sisters in Christ who are in the sanctuary.

Please note at this time, the **first** and **third weekends** of the month will be **blended** with both **traditional hymns** and **contemporary praise music**. The **second** and **fourth** weekends of the month, we will have **traditional** services. Thank you.

104 REDEEMER LUTHERAN SCHOOL - [PRESCHOOL - 8TH GRADE]

Redeemer Lutheran School has been established by this congregation to assist parents in bringing up their children in the "nurture and admonition of the Lord." All instruction is to be motivated by the love of God in Jesus Christ, our Lord, for the purpose of bringing to faith all the children whom we instruct and to prepare them for the future. CONTACT: RLS

105 SUNDAY SCHOOL - BIBLE CLASS

Preschool to adults meet Sunday mornings at 9:30 AM for Sunday School and Bible Class. CONTACT: Church Office

106 ADULT INFORMATION CLASS

Participants will examine the basic teachings of the Bible and the Lutheran Church, in an informal setting. The class will consider what it means to be a disciple of Jesus Christ. Those who complete the course will be eligible for membership. However, there is no obligation to join. The class also provides an excellent review of Christian doctrine for current members. Free child-care will be provided. Classes are held regularly. CONTACT: Church Office

107 LADIES' KOINONIA & LADIES BIBLE CLASS

Ladies' Koinonia is a Bible class for women that meets each Thursday during the school year in Mission Hall. Pastor Akers leads our study, which begins at 9:30 AM with fellowship (snacks & praying). We're finished by 11:00 AM. Babysitting is provided. Ladies Bible Class meets the second and fourth Tuesdays at 10:00 AM, September to May with lay leaders. Both classes meet in Mission Hall. Bring a friend and join us! CONTACT: Church Office

108 MEN'S BIBLE STUDY

Men have a weekly Bible study / discussion group opportunity, Tuesdays at 7:30 AM in Mission Hall. This Bible study meets year round. Men of all ages are invited to attend for a weekly quenching of spiritual and friendship thirst. Bring your Bible. CONTACT: Church Office

109 CONFIRMATION CLASSES

This Bible study opportunity is for 8th grade students. We explore the wonders of God's love and the joy of growing as a disciple of Jesus. Class schedules are announced in the fall. CONTACT: Church Office

110 VACATION BIBLE SCHOOL

VBS is held each summer for children of our church, friends and neighbors. A week of Bible study, crafts and lots of fun for children, ages 3 through Grade 6. CONTACT: Church Office

111 CRADLE ROLL

This ministry provides resources for the spiritual growth of children from baptism to age 3. CONTACT: Church Office

112 CD MINISTRY

Worship Services are recorded weekly for the benefit of shut-ins, and those hospitalized or convalescing at home. CDs are delivered to them so they can continue their worship of our Lord Jesus Christ. CDs can also be requested for your personal listening and enjoyment, or to pass on to a friend. CONTACT: Church Office

113 CHRISTIAN RADIO STATIONS

Christian broadcasting can be heard twenty-four hours each day on area radio stations. WFRN - 93.7 FM: Moody Radio - 91.7 FM: K-LOVE - 106.7 FM: WFRN - 93.7 FM.

114 THE LUTHERAN HOUR

The Lutheran Hour is a weekly inspirational radio broadcast sponsored by Lutheran Laymen's League. Practical preaching and majestic music are the hallmarks of the Lutheran tradition. The Lutheran Hour can be heard over radio station WIOU 1350 [AM] at 8:00 AM.

115 WORSHIP ANEW

Lutheran Ministries Media, Inc. produces a weekly, 30-minute Lutheran broadcast worship service called *Worship Anew*. Each service includes music, scripture readings, prayers, and a pastor delivering a message that is designed to feel one-on-one to the viewer. *Worship Anew* is broadcast Sundays at 10:00 AM - WHMB-TV 40.

SERVICE OPPORTUNITIES

B. WORSHIP ENRICHMENT

201 WELCOME CENTER & GREETERS

The people of Our Redeemer serve at the Welcome Center to insure that everyone who worships with us receives a generous dose of Christian hospitality. We also provide printed resources that inform worshipers of the many ministries available for those who desire to follow Jesus at Lutheran Church of Our Redeemer. CONTACT: Church Office

202 USHERS

The men and women who serve as ushers help maintain an atmosphere of reverence and look after the needs and comfort of the worshipers. CONTACT: Church Office

203 NURSERY

Nursery helpers are always needed for Sunday morning 10:45 AM worship service to care for children, ages infant to 3. CONTACT: Church Office

204 ACOLYTES

Open to children, age 10 and over, adults and families. CONTACT: Church Office

205 INSTRUMENTALISTS & VOCALISTS

Instrumentalists and vocalists are encouraged to share their musical talent by participating in special worship services. Included are singing (solo/group), Keyboard accompanist, percussion accompanist, organist, and sound technician. CONTACT: Church Office

206 ADULT CHOIR

The Adult Choir glorifies the Lord in song and adds variety to the worship services. If God has blessed you with a talent for singing, come Tuesday evenings at 7:00 PM for rehearsal (September - May). CONTACT: Church Office

207 THE BELL CHOIR

The Bell Choir is open to anyone interested. Rehearsals are held on Tuesday evenings at 5:45 PM. This choir is active from September thru May. CONTACT: Church Office

208 SANCTUARY STEWARDS

As their name implies, the Sanctuary Stewards prepare and care for the altar paraments, embroider baptismal napkins, decorating of the church during festivities and holidays, delivery of altar flowers, etc. All women are invited to serve. CONTACT: Church Office

209 PRAISE TEAM

The primary purpose of a praise team is to give glory to God and facilitate the worship of the congregation. Our praise team consists of singers and band members. The singers are responsible for leading the congregational singing. Their first job, therefore, is to make sure the melody is well heard. They are encouraged to add harmony when possible. The band is made up of a few guitars, one bass, one drummer, and one or two keyboards. Their objective is to support the singers and add variety to the service. The team usually rehearses on a weekly basis in preparation for the Contemporary Services which occur on the first and third Sundays of each month. CONTACT: Church Office

210 IN HIS SERVICE

This choir sings contemporary Christian music with an occasional traditional selection. We perform 1 - 2 times per month. Our rehearsal schedule varies, but averages 2 - 3 rehearsals per month. CONTACT: Church Office

211 WORSHIP ASSISTANTS

Members of who feel comfortable reading scriptures, conveying Christian messages by putting on skits or short dramas are welcome to express their interest. CONTACT: Church Office

212 SUNDAY SCHOOL MUSICIANS

Use your love of music and children to assist in the Sunday School opening. Pianists and song leaders are needed. CONTACT: Church Office

213 MISSION POSSIBLE SERVANT EVENT

Every two years, our congregation hosts the Mission Possible Servant Event. Lutheran Youth have the opportunity to minister to the community by helping needy families repair their homes.

C. CHRISTIAN EDUCATION

214 REDEEMER LUTHERAN SCHOOL

You can serve children through the school library, working with the Parent Teacher League, in school teacher aide, mentoring, school lunch program assistant, substitute teacher, extracurricular activities helper or volunteering in the school office. CONTACT: Redeemer Lutheran School

215 SUNDAY SCHOOL TEACHERS & AIDES

If you have a desire to share the Word of God as a teacher or assistant in our Sunday School, there is a place for you in this ministry. You can serve our children or young adults by volunteering to be a teacher, aide, assistant, substitute, music assistant, opening leader, department leader, or superintendent/ assistant. What ever your interests may be we can find an opportunity for you to serve our young people. CONTACT: Church Office

216 VACATION BIBLE SCHOOL VOLUNTEERS

Do you love children? If so, this may be a wonderful evening ministry for you in the summer. Those who like to organize, lead, teach, aide, assist, help with snacks, do arts & crafts and sing or help with the music, are all needed. CONTACT: Church Office

217 RIGHT NOW MEDIA

An online resource like Netflix with Christian Bible studies, videos, children's activities, on a variety of subjects with instant access to thousands of great videos for kids, students, young adults, parents, married couples, singles, teenagers, and more. Membership is free. CONTACT: Church Office

D. PARISH MINISTRY

218 PRAYER CHAIN

It is appropriate for Christians to come to God with requests on behalf of those in need. The Prayer Chain at Our Redeemer serves members with burdens, as well as members who have been blessed and wish to thank the Lord. CONTACT: Church Office

219 NEW MEMBER SPONSORS

This ministry is designed to help new members become well integrated into the worship and activity life of the congregation. It will give new members an opportunity to meet and come to know their fellow members on a personal basis and if needed, help them become familiar with the community. CONTACT: Church Office

220 FIRST TIME VISITORS MINISTRY

Have you ever attended a new church's worship service and wondered if anyone noticed? We have a ministry activity aimed at follow-up for those people. We work with our pastor in identifying those families, and visiting them briefly and take them information about our church. This is a very rewarding ministry. CONTACT: Church Office

221 CHURCH LIBRARY

Is reading your passion? The church library offers many opportunities for volunteering ... shelving books, cataloging books, promoting new arrivals, etc. CONTACT: Church Office

222 SMALL GROUP BIBLE STUDY

Small group Bible studies are a perfect setting for enhancing Christian fellowship and further study of God's Word. Several groups are already in existence and more groups continue to form. Come join a group that is right for you, look at the church bulletin and the newsletter for their schedules. CONTACT: Church Office

SUPPORT OPPORTUNITIES

E. PARISH SUPPORT

223 PASTORAL CARE

Our Pastor[s] want to help you experience the healing power of the Gospel of Jesus Christ. Please let them know how they can serve you and help meet your needs - spiritual, emotional or physical. CONTACT: Pastor Akers or Church Office.

224 LIBRARY / RESOURCE CENTER

Videos and resources are available for personal or family assistance and reading. The Church Library is located in Room 16 of the east wing. CONTACT: Church Office

225 DEACON MINISTRY

Each member has a deacon who desires to serve in time of need. This is another reason "love grows" at Our Redeemer. Please feel free to call your deacon. If you need the name of your deacon, the Church Office can help you. CONTACT: Church Office

F. FOOD SERVICE, QUILTING, KNITTING, ARTS & CRAFTS

226 LUTHERAN WOMEN IN SERVICE

This group is a vehicle for Christian growth as well as service. Every female member of Redeemer Lutheran that is 18 years or older is automatically a member of this guild. Is cooking and sharing your talents in the kitchen something you enjoy? Then perhaps you would be interested in occasionally helping with a dinner or making a dish to share. There are many opportunities throughout the year where your services can be utilized; for example, Lenten dinners, funeral dinners, senior citizen luncheon, etc. Service projects are many. Watch the weekly bulletin for activities, times and dates. CONTACT: Church Office

227 HANDS OF LOVE KNITTERS & CROCHETERS

This ministry is open to those who already know how to knit or crochet, or anyone would like to learn. We provide love, encouragement, fellowship and humor while we work to serve our Lord. CONTACT: Church Office

228 ARTS & CRAFTS

At various times there is a need for those having special creative talents for making special posters or banners, arranging or assembling narthex bulletin boards, photography or video for special events, decorating for special activities. If you are one of these Artsy/Crafty persons, let us know. CONTACT: Church Office

229 QUILTING GROUP

Each year approximately 100 quilts are made and donated to Lutheran World Relief for distribution around the world. This group meets on Tuesday and Thursday mornings at 9:30 AM. CONTACT: Church Office

230 CARING MEALS MINISTRY

Meals are arranged and delivered to help with short-term circumstances [surgery, illness, birth of a child, etc.] CONTACT: Church Office

G. CHURCH OFFICE

231 CHURCH OFFICE VOLUNTEERS

Volunteers are often needed to assemble worship bulletins, congregational mailings, computer data entry, and a variety of other administrative projects throughout the year. CONTACT: Church Secretary

232 TELLERS

Tellers meet on Monday morning at 9:00 AM to count the financial blessings received during worship services. CONTACT: Church Secretary

H. CHURCH CARE & TECHNOLOGY

233 GROUNDS KEEPING

Adopt a section of shrubbery around the church and give it your tender loving care. CONTACT: Church Office

234 COMPUTERS & TECHNOLOGY

Your interest in computers can serve Christ. Graphic design, web site maintenance/development, document creation/editing, data entry and technical support for software and hardware are welcomed. CONTACT: Church Office

235 BUILDING & EQUIPMENT CARE

Our buildings and facilities, like your home, are always in need of some tender loving care. The very skills you use around your own home are useful to maintain our facilities. These needs include: general repair, painting, caulking, electrical, plumbing, carpentry, and cleaning. CONTACT: Church Office

I. CHURCH BOARDS & VOTERS ASSEMBLY

236 VOTERS' ASSEMBLY

The church needs your input to help make decisions affecting our body of believers. Voters' Assembly meets on the third Wednesday of January, May, September and November at 7:00 PM. Voters' Assembly meets on the third Monday during Lent. All communicant members, 18 years of age are eligible for membership. CONTACT: Church Office

237 BOARD OF REDEEMER LUTHERAN SCHOOL

Encourages and provides for Christian training and spiritual growth of all members of Redeemer Lutheran School. CONTACT: Board of Redeemer Lutheran School

238 BOARD OF DEACONS

Assists the Pastors in providing spiritual care of the congregation and overseeing public worship. CONTACT: Church Office

239 BOARD OF STEWARDSHIP

Provides for orderly handling of funds, talents and abilities of the congregation in accordance with Biblical principles. Encourages members to be joyful, worshipful, and proportional in first-fruits giving in response to blessings received. CONTACT: Church Office

240 BOARD OF PROPERTY

Charged with supervision of all church properties, providing timely maintenance, maintaining an inventory of all capital equipment. CONTACT: Church Office

241 BOARD OF PARISH LIFE

This board is responsible for the Youth Ministry, Family Ministry and Parish Ministry programs of the congregation. They provide opportunities for Christian growth, fellowship and service while helping to meet the human care needs of the members of each group. CONTACT: Church Office

242 BOARD OF CHRISTIAN OUTREACH

This board is responsible for equipping and motivating the members of the congregation to share the Gospel of Jesus Christ through evangelism, missions, community social services and public relations. CONTACT: Church Office

J. WIDER MINISTRY SUPPORT

243 KOKOMO RESCUE MISSION

The Kokomo Rescue Mission is a social service agency that assists local churches in serving those in need. Volunteers are always welcome. CONTACT: Church Office

244 SALVATION ARMY

The Salvation Army is a non-profit, social service agency that assists local churches in serving those in need. Volunteers are always welcome. CONTACT: Church Office

J. WIDER MINISTRY SUPPORT cont.

245 CAM [COORDINATED ASSISTANCE MINISTRIES, INC.]

The mission of CAM is to unify the assistance ministries of the religious community of Howard County by showing God's love in meeting the needs not being met by other agencies. CONTACT: Church Office

246 MOST MINISTRIES

Mission Opportunities Short Term (MOST Ministries) is an independent short term Christian mission agency that facilitates interested and committed Christians who are looking for opportunities to live out their faith by serving Lutheran Church Missouri Synod missionaries, partner churches and related charitable organizations throughout the world. CONTACT: Church Office

247 VOLUNTEER MISSION SERVICE

The Board of Christian Outreach encourages our members to participate in local and extended missionary services such as, Kokomo Urban Outreach, Samaritan Caregivers, food pantries, homeless, reading tutor, short-term mission trips, domestic, and foreign mission trips. CONTACT: Church Office

248 HELPING HEARTS MENTORING

Do YOU have 30 minutes a week to share Christ's love with an RLS student? Contact: Church Office

FELLOWSHIP OPPORTUNITIES

K. FELLOWSHIP

249 DUO CLUB

A Euchre Club for the young at heart. Meets the third Friday of the month at 7:00 PM in the Mission Hall at church. CONTACT: Church Office

250 "THE GROUNDS" [SENIOR HIGH YOUTH GROUP]

"The Grounds" is an informal time for high school aged youth and their friends to gather together every Sunday evenings (6:30-8:30 PM) in the Youth Room above the fellowship hall kitchen. We take time for fellowship, fun, prayer, service, and devotions. Watch the church bulletin and newsletter for special activities! CONTACT: Church Office

251 "PATHWAYS" [REDEEMER JUNIOR HIGH YOUTH GROUP]

Junior High Youth is open to young people, Grades 6-8. Information on the activities of these groups will be printed in weekly bulletins and newsletter. CONTACT: Church Office

252 ELEMENTARY YOUTH GROUPS

Open to all students in grades 3 -5 and their families. Watch for Funtastic Family Nights and other activities in the weekly bulletin and monthly newsletter. CONTACT: Church Office

253 BOY SCOUTS - CUB SCOUTS

This group is recommended for boys in grades 2 - high school. Scouting helps to develop character and leadership in a fun, Christian atmosphere. CONTACT: Church Office

GUIDELINES relating to the BLESSED SACRAMENT

WHO SHOULD COMMUNE?:

Because the Lutheran Church believes the Risen Lord is present in the consecrated bread and wine of the Sacrament, we practice "close communion" only those who have been instructed in the Lutheran Faith commune at its altars. This is done out of loving concern that those who receive the Sacrament know and believe -- and thus benefit from -- what they here received: the very body and blood of Christ, once given and shed for the forgiveness of sin. If you are not a confirmed Lutheran, one of our pastors would be happy to speak with you about your desire to commune.

HOW OFTEN IS HOLY COMMUNION CELEBRATED BY OUR CONGREGATION?

We commune at all weekend worship services, and the following special days: Ash Wednesday, Maundy Thursday, Easter, Pentecost, Christmas Day and New Year's Eve.

HOW OFTEN SHALL I COMMUNE?

In I Corinthians 11: 25, 26, the Apostle Paul reminds us of the command of Christ to come often, and then adds that *as often as we eat this bread and drink this cup*, we publicly proclaim that Christ died for us. We are encouraged to commune often because of our continual need for communion with God and forgiveness of sins. Jesus Christ promises to be present and to bestow His forgiveness upon us personally in this Sacrament, "This is My blood...poured out...for the forgiveness of sins." [Matthew 26:28]

HOW ARE CHILDREN INCLUDED?

Families are encouraged to commune together. Children are invited to kneel at the altar and receive a blessing.

WHY DO I BOW MY HEAD BEFORE AND AFTER RECEIVING THE SACRAMENT?

The bowed head is a sign of humility and need as I approach the Lord's Table in all of my sinfulness. Before returning to the pew, I bow my head in gratitude for the gift of His presence and my forgiveness.

HOW CAN I PREPARE MYSELF AT HOME FOR COMMUNION?

Prior to the time of Communion, take your Bible or other helpful written resources and spend some time alone with your Lord.

1. Begin with a prayer for the Holy Spirit, for it is He alone Who can work true repentance.
2. Read one of the following penitential Psalms: 32, 51, 130; or 84, 85, or 86.
3. Use the Ten Commandments as a measure of your life to find where you have failed to keep God's Holy law in doing wrong and omitting to do good.
4. In your self-examination ask three questions:
 - a] Do I truly repent of my sins?
 - B] Do I believe in Jesus Christ as my Savior?
 - C] Do I have sincere purpose with the aid of the Holy Spirit henceforth to amend my sinful life?
5. Ask yourself the "Christian Questions with their answers," [Luther's Small Catechism, pages 40-44; also in Lutheran Service Book hymnal, pages 329-330.]
6. Close with a prayer, for example: Prayer for faith, for true repentance, for the blessings of Holy Communion.

WHAT CAN I DO TO MAKE THE RECEPTION OF THE SACRAMENT MORE MEANINGFUL TO ME WHILE I AM IN CHURCH?

- 1] Before the service of Communion, come early to have time for meditation.
- 2] Psalms 84, 85, 86 or 130 are contained in the front pages of the Hymnal for your devotion time.
- 3] Also a "Prayer Before Communing" found inside the front cover of the Lutheran Service Book hymnal.
- 4] While standing at the altar, you may find it helpful to keep a mental picture of the crucifixion, or of Christ as He most appeals to you.
- 5] When receiving the Sacrament, say a silent prayer like, "Lord, I am not worthy to receive this Heavenly Meal -- strengthen my faith."
- 6] When you return to the pew, offer up a prayer - a suggestion; A Prayer of Thanksgiving after receiving the Sacrament found inside the front cover of the Lutheran Service Book hymnal. May you have an appointment often with the Savior at the Heavenly Meal to which He so urgently invites you.

CONTACTS		<u>Phone Number</u>
Pastor Akers, Church Office, Financial Secretary, Business Manager		765-453-0969
Board of RLS, Mr. Frisco, School Staff & Faculty		765-864-6466

MISSION STATEMENTS

LUTHERAN CHURCH OF OUR REDEEMER EXISTS TO:

Welcome people to faith in Jesus Christ;
Equip His followers with a maturing faith through Word and Sacrament;
Serve in the world as Jesus served us.

REDEEMER LUTHERAN SCHOOL, TOGETHER WITH OUR CONGREGATION, EXISTS TO:

Welcome children and their families to a Christ-centered environment,
Equip them with foundations for academic excellence, and
Send them forth in lifelong service for the Lord.

OUR PASTOR & SCHOOL PRINCIPAL



Associate Pastor Barry Akers



Principal Mr. Eric Frisco

CHURCH STAFF

Pastor Barry Akers, Associate Pastor
April Meyer, Business Manager
Bev Beahrs, Church Secretary
Rick Ponder, Head Custodian
Florence Moeller, Organist
David Britton, Choir Director
Juanita Martin-Davis, Bell Choir Director

REDEEMER LUTHERAN SCHOOL FACULTY & STAFF

Mr. Eric Frisco	Principal
Miss Michelle Werich	School Secretary
Mrs. Melanie Waggoner	Pre-School
Mrs. Tina Wagner	Pre-Kindergarten/Early Childhood Director
Mrs. Angie Plutat	Kindergarten
Miss Stephanie Gross	First Grade
Mrs. Kaila Akers	Second Grade
Miss Alicia Wilkie	Third Grade
Mrs. Debbie Grecu	Fourth Grade
Mrs. Erin Jorgensen	Fifth Grade
Mrs. Suzanne Dunkin	Sixth Grade
Mrs. Sallie Miller	Seventh/Eighth grade
Mrs. Anna Gaunt	Computer
Mrs. Kathy Tucker	Admissions

Updated 8-20-2020

MAPS OF LUTHERAN CHURCH OF OUR REDEEMER / REDEEMER LUTHERAN SCHOOL

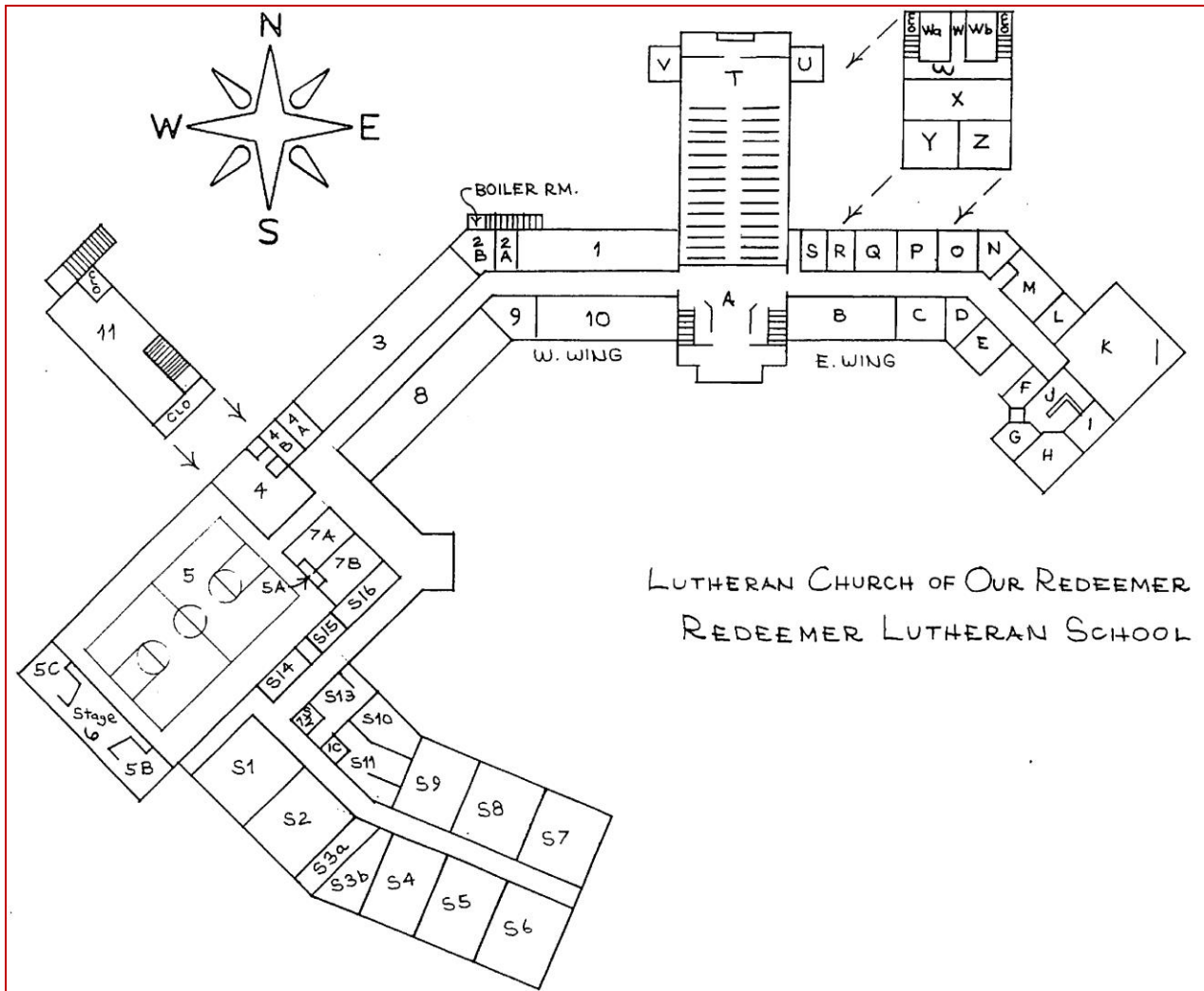

LUTHERAN CHURCH OF OUR REDEEMER
705 Southway Boulevard East
Kokomo, Indiana 46902

SOUTHWAY	BOULEVARD EAST
US. 931	 Lutheran Church of Our Redeem 705 Southway Boulevard East (BEHIND SHOPPING CENTER)
ALTO ROAD	
CENTER ROAD	
STATE ROAD 26	

↑
N

WORSHIP SCHEDULE

SATURDAY EVENING WORSHIP - 5:30 PM

SUNDAY MORNING WORSHIP - 8:15 & 10:45 AM

BIBLE CLASS - SUNDAY SCHOOL - 9:30 AM

CHURCH / SCHOOL MAP & ROOM ASSIGNMENTS

CHURCH MAP & ROOM ASSIGNMENTS

A	Narthex
B	Adult Ed Room
C	Church Library
D	Visual Aid / Storage
E	Choir Director
F	Church Office Workroom
G	Vacant Pastor's Office
H	Vacant Pastor's Office
I	Mission Hall Kitchen
J	Church Secretary Office
K	Mission Hall
L	Volunteer's Office
M	Associate Pastor's Office
N	Janitor's Closet
O	Women's Restroom
P	Men's Restroom
Q	Business Manager
R	LWIS Storage Closet
S	Sitting Room
T	Sanctuary
U	Pastor's Sacristy
V	Working Sacristy
W	Choir Room
Wa	Quilting Room
Wb	Bell Choir Room
X - Z	Balcony

RLS MAP & ROOM ASSIGNMENTS

1	Pre-School
2a	Boy's Restroom
2b	Girl's Restroom
3	RLS Pre-Kindergarten
4a	Admissions Office
4b	Cook's Office
5	Fellowship Hall / Gym
5a	Storage Closet
5b	RLS Athletic Office
5c	Fellowship Hall Storage
6	Stage
7a	Boy's Restroom
7b	Girl's Restroom
8	RLS Kindergarten Room
9	Nursery
10	RLS Extended Care Room
S1	RLS Library
S2	RLS Grade 1
S3a	Boy's Restroom
S3b	Girl's Restroom
S4	Computer Lab
S5	RLS Grade 4
S6	RLS Grade 6
S7	RLS Grade 5
S8	RLS Grade 3
S9	RLS Grade 2
S10-13	Administrative Offices
11	RLS Grades 7 & 8
S14	Mechanical Room
S15	Janitor's Closet
S16	RLS Conference Room