

MSC



Penn

3425 WALNUT STREET

AT THE UNIVERSITY OF PENNSYLVANIA | PHILADELPHIA, PA

 Onboard@Penn

3425 Walnut Street

 Onboard@Penn

1,915 SF RETAIL AVAILABLE AT UNIVERSITY OF PENNSYLVANIA



3425 WALNUT STREET

JOIN THESE AREA TENANTS



PROPERTY DETAILS

- ▶ 1,915 SF retail in the heart of The University of Pennsylvania
- ▶ Steps from high-foot traffic corner of 34th and Walnut St.
- ▶ A+ co-tenants Starbucks, CVS, Citizens Bank, Franklin's Table
- ▶ Located in the epicenter of Penn's campus in high energy location driven by students, faculty, restaurants and retail
- ▶ Available January 2026

EMPLOYMENT

Faculty and Staff: 18,000
UPenn Health System: 28,443
Total: 46,443

STUDENTS

Full-time undergraduate: 10,106
Full-time graduate: 12,924
Total: 23,030

UNIVERSITY CITY AT A GLANCE

Population: 48,589

Households: 17,169

Number of Housing Units: 19,027

Employees: 64,893

Students: 46,247

FLOOR PLAN

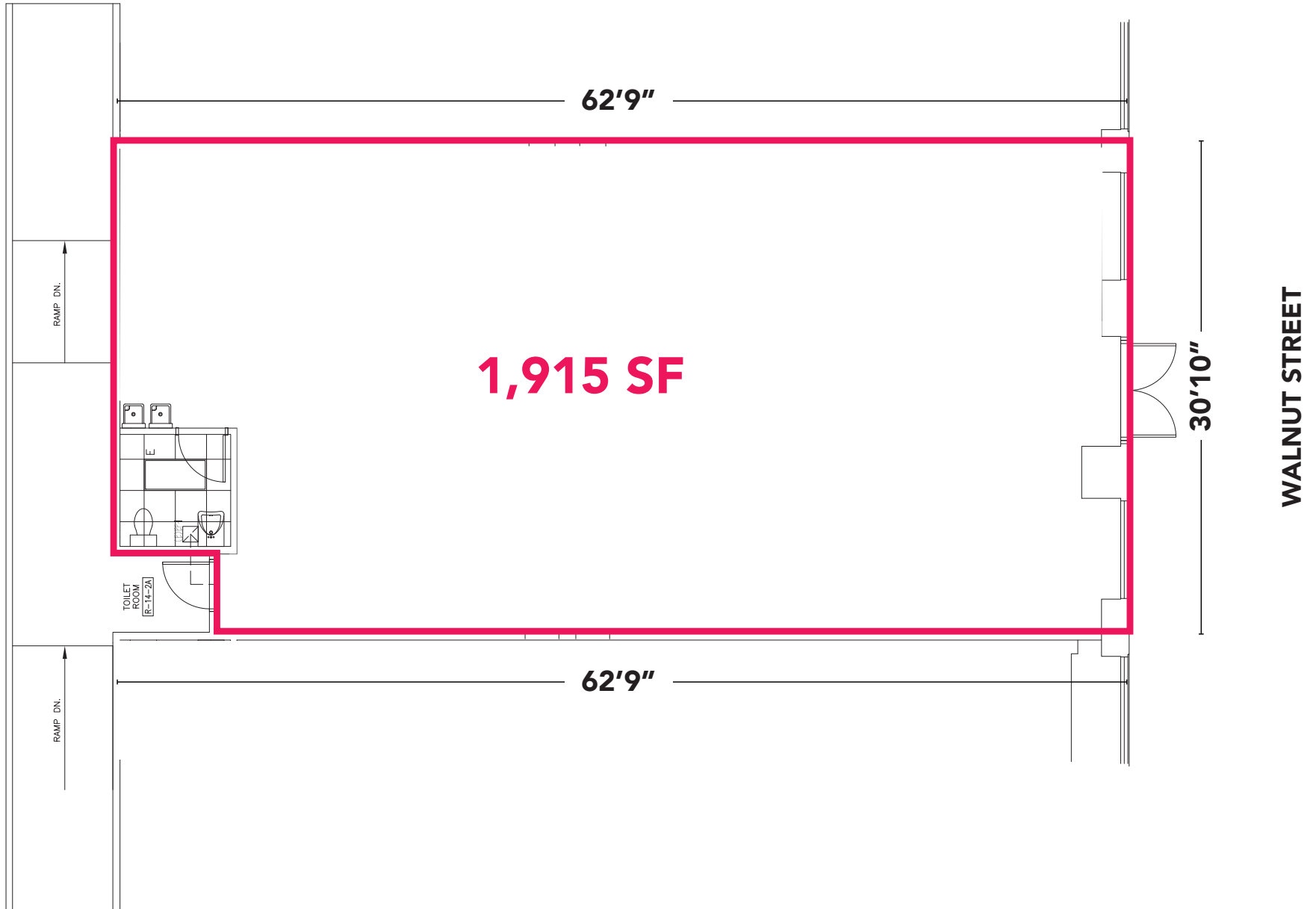

AERIAL



AERIAL

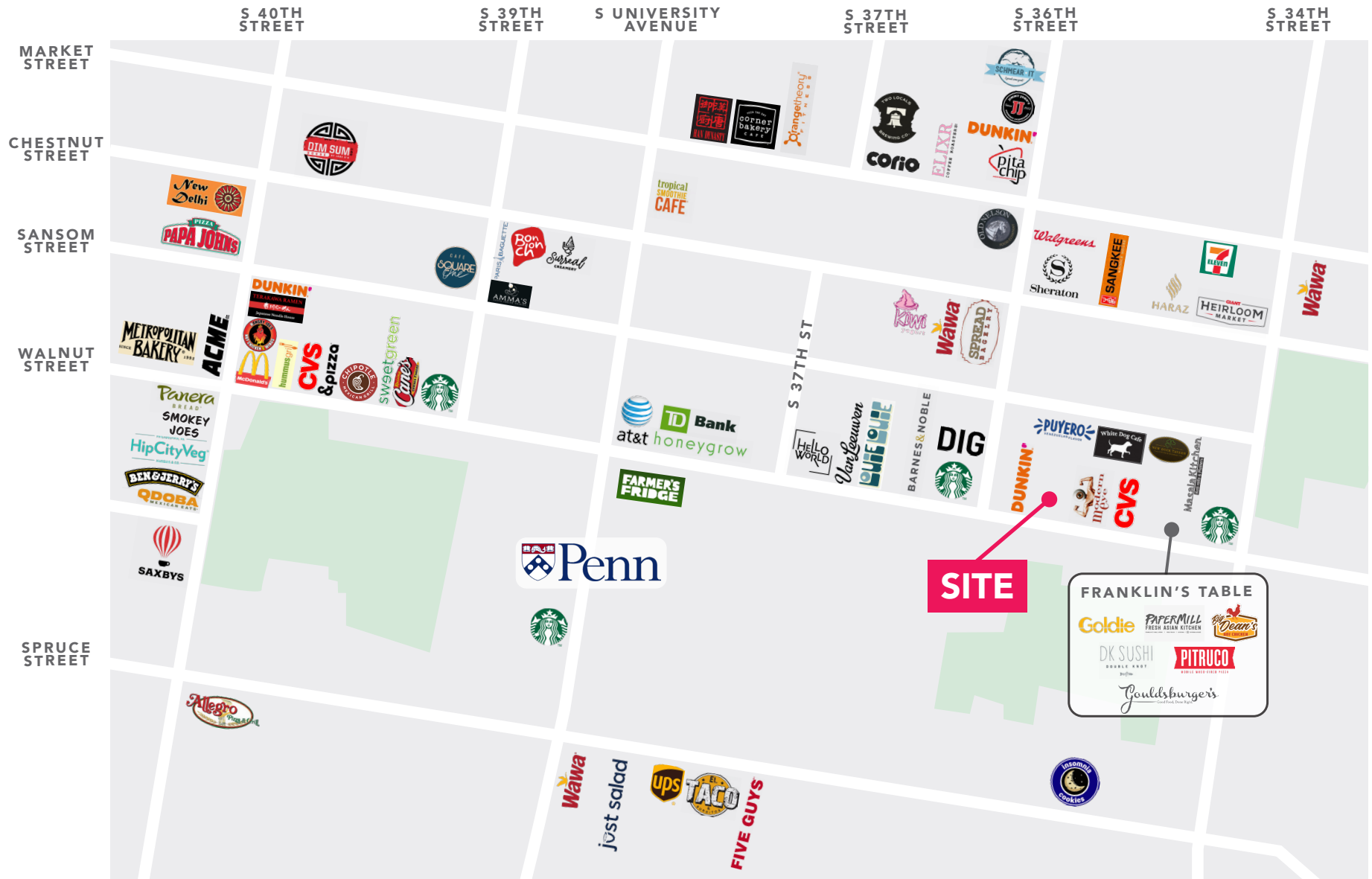

The information contained herein has been obtained from sources deemed reliable. MSC cannot verify it and makes no guarantee, warranty or representation about its accuracy. Any projections, opinions, assumptions or estimates provided by MSC are for discussion purposes only and do not represent the current or future performance of a property, location or market.

MARKET AERIAL



The information contained herein has been obtained from sources deemed reliable. MSC cannot verify it and makes no guarantee, warranty or representation about its accuracy. Any projections, opinions, assumptions or estimates provided by MSC are for discussion purposes only and do not represent the current or future performance of a property, location or market.



MSC

JACOB COOPER

jcooper@hellomsc.com

215.813.3784

ANNELLYSE CHAN

achan@hellomsc.com

732.533.3363

