

MSC

828

N. 2ND STREET

NORTHERN LIBERTIES | PHILADELPHIA, PA

5,150 SF (DIVISIBLE) NEW CONSTRUCTION
RETAIL FOR LEASE



828 N. 2ND STREET

DEMOGRAPHICS

Northern Liberties Trade Area
From the River to 6th Street between Girard Ave & Callowhill Street

EST. POPULATION

8,397

EST. HOUSEHOLDS

7,392

EST. AVG HH INCOME

\$186,022

EST. MEDIAN AGE

32.4

PROPERTY DETAILS

- ▶ Prominent retail opportunity in the heart of Philadelphia's hottest neighborhood
- ▶ Best-in-class co-tenancy, including CorePower Yoga & Madis Coffee Roasters
- ▶ Flexible floor plan options
- ▶ 1,334 SF dedicated outdoor patio
- ▶ Valuable positioning within new, corner mixed-use development
- ▶ Seeking medical, retail, creative, or restaurant user

JOIN THESE AREA TENANTS



The information contained herein has been obtained from sources deemed reliable. MSC cannot verify it and makes no guarantee, warranty or representation about its accuracy. Any projections, opinions, assumptions or estimates provided by MSC are for discussion purposes only and do not represent the current or future performance of a property, location or market.

MSC

SITE PLAN

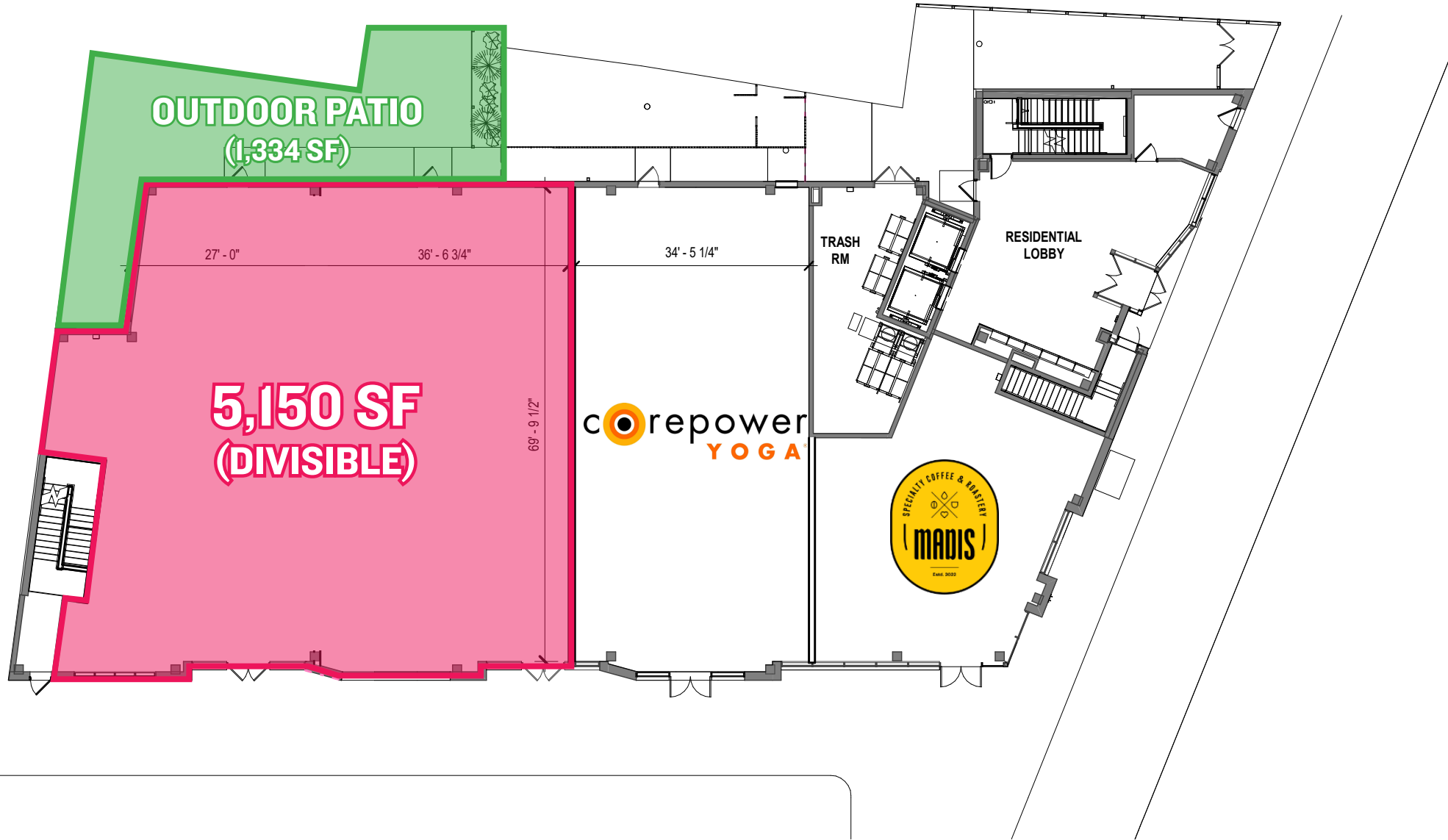

POTENTIAL DEMISING SCENARIOS

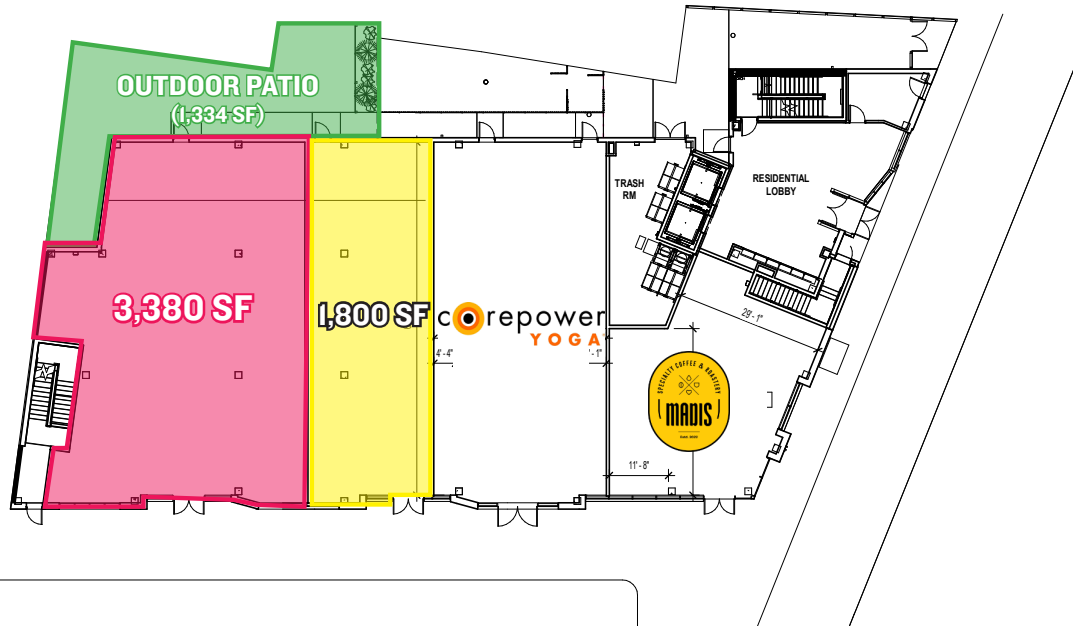
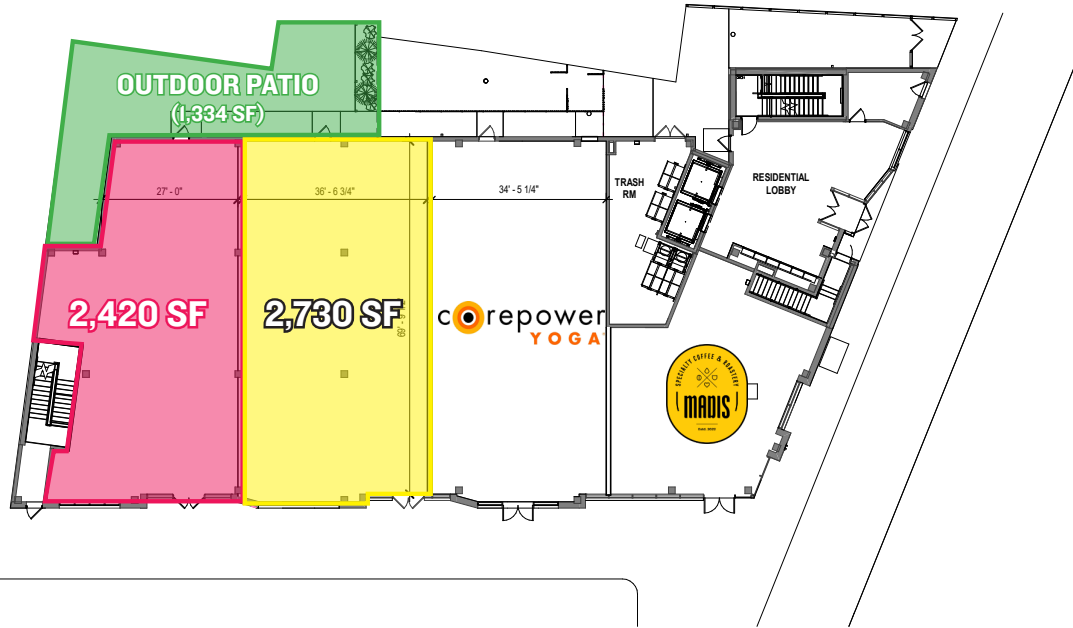

The information contained herein has been obtained from sources deemed reliable. MSC cannot verify it and makes no guarantee, warranty or representation about its accuracy. Any projections, opinions, assumptions or estimates provided by MSC are for discussion purposes only and do not represent the current or future performance of a property, location or market.

MSC



STEFANIE GABEL
sgabel@hellomsc.com
215.570.5486

JACOB COOPER
jcooper@hellomsc.com
215.813.3784

