

MSC

WOLFF COURT

501 EAST GIRARD AVENUE

FISHTOWN | PHILADELPHIA, PA

12,660 SF (DIVISIBLE) NEW CONSTRUCTION RETAIL FOR LEASE



WOLFF COURT

JOIN NEIGHBORING TENANTS

La COLOMBE
COFFEE ROASTERS

honeygrow

LLOYD
WHISKEY • BEER • COCKTAILS

★ JOHNNY BRENDA'S ★

CVS

WELLS
FARGO



PROPERTY DETAILS

- ▶ Unmatched visibility with 172' of frontage along East Girard Avenue, one of Philadelphia's major arteries with 19,000 AADT
- ▶ Strategically positioned in the booming Fishtown neighborhood between Frankford Avenue's vibrant F&B scene, national retail at shopping centers along Aramingo Avenue, and I-95
- ▶ Excellent parking options with loading zone along Girard Avenue, four to six dedicated surface parking spaces, and possibility of additional dedicated underground parking
- ▶ Immediately adjacent to public playground, ideal for childcare and fitness uses

DEMOGRAPHICS

Center City Trade Area
From the River to River between Girard Avenue & Tasker Avenue

EST. POPULATION

206,964

EST. MEDIAN HH INCOME

\$95,215

EST. MEDIAN AGE

35.5

EST. EMPLOYEES

227,743

The information contained herein has been obtained from sources deemed reliable. MSC cannot verify it and makes no guarantee, warranty or representation about its accuracy. Any projections, opinions, assumptions or estimates provided by MSC are for discussion purposes only and do not represent the current or future performance of a property, location or market.

MSC

FLOOR PLAN

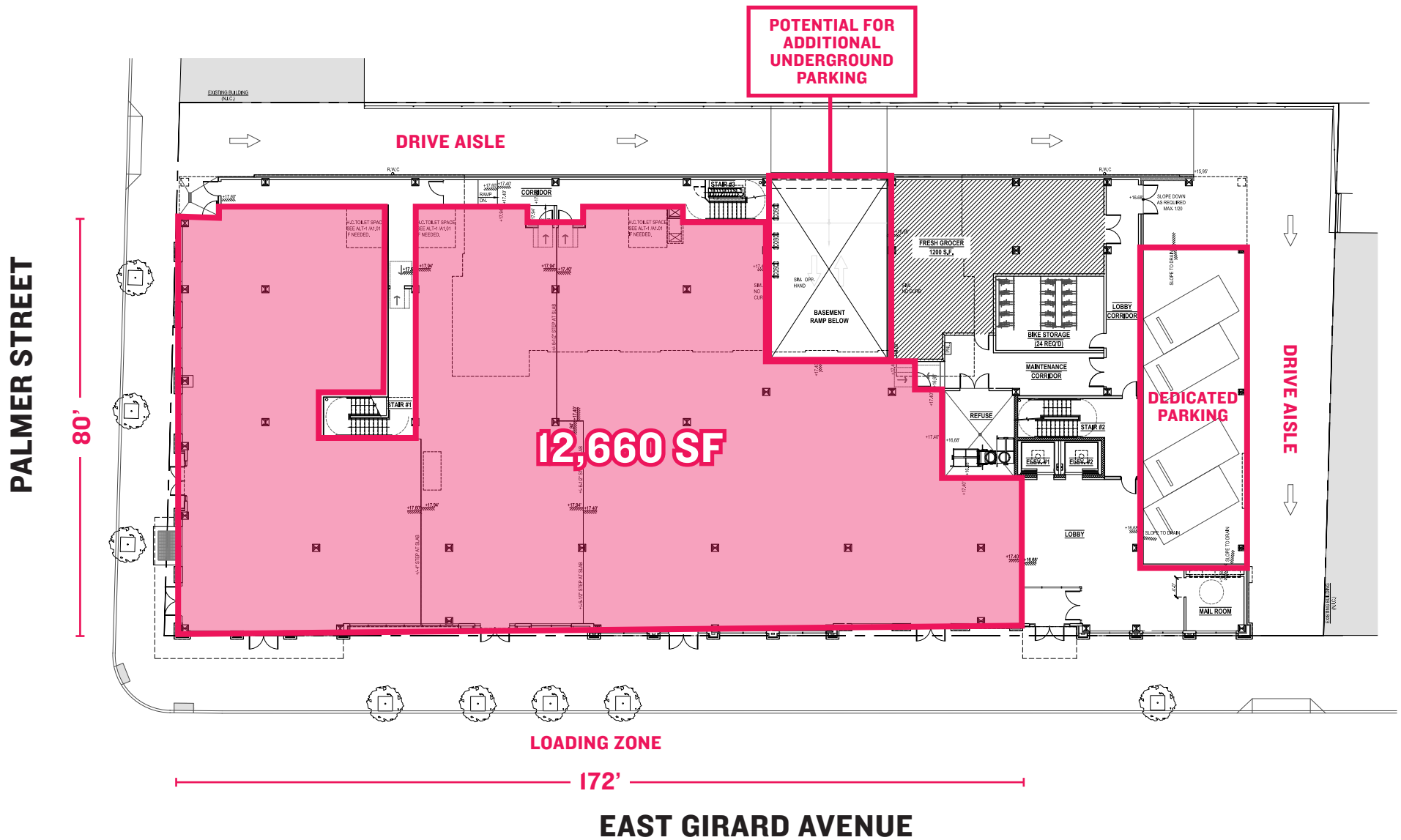

INTERIOR PHOTO



BIRDS EYE AERIAL



AERIAL



MSC

STEFANIE GABEL

sgabel@hellomsc.com

215.570.5486

