

MSC



WILKES-BARRE, PENNSYLVANIA

**441 WILKES BARRE TOWNSHIP BLVD.**

SAM'S CLUB OUT-PARCEL FOR SALE





# 441 WILKES BARRE TOWNSHIP BLVD.

**DOUGLAS GREEN**  
dgreen@hellomsc.com  
215.883.7400

**STEFANIE GABEL**  
sgabel@hellomsc.com  
215.883.7409



- Situated in the heart of the main retail node of the Wilkes-Barre market, right off of Route 81
- Positioned in front of Sam's Club and directly across the street from the only Wegmans in the market
- Opportunity at fully signalized traffic light offering easy access from all directions
- Prominently situated at heavily trafficked intersection with billboard-type visibility

## DEMOGRAPHICS

 **EST. POPULATION**  
3 mi | 68,779   5 mi | 115,496   7 mi | 151,904

 **EST. EMPLOYEES**  
3 mi | 44,347   5 mi | 61,597   7 mi | 70,668

 **EST. AVG HH INCOME**  
3 mi | \$56,051   5 mi | \$61,599   7 mi | \$67,670

 **EST. MEDIAN AGE**  
3 mi | 37.8   5 mi | 39.9   7 mi | 41.0

## JOIN THESE AREA TENANTS

sam's club 

Wegmans

Walmart   
Supercenter

KOHL'S



# 441 WILKES BARRE TOWNSHIP BLVD.

DOUGLAS GREEN  
dgreen@hellomsc.com  
215.883.7400

STEFANIE GABEL  
sgabel@hellomsc.com  
215.883.7409

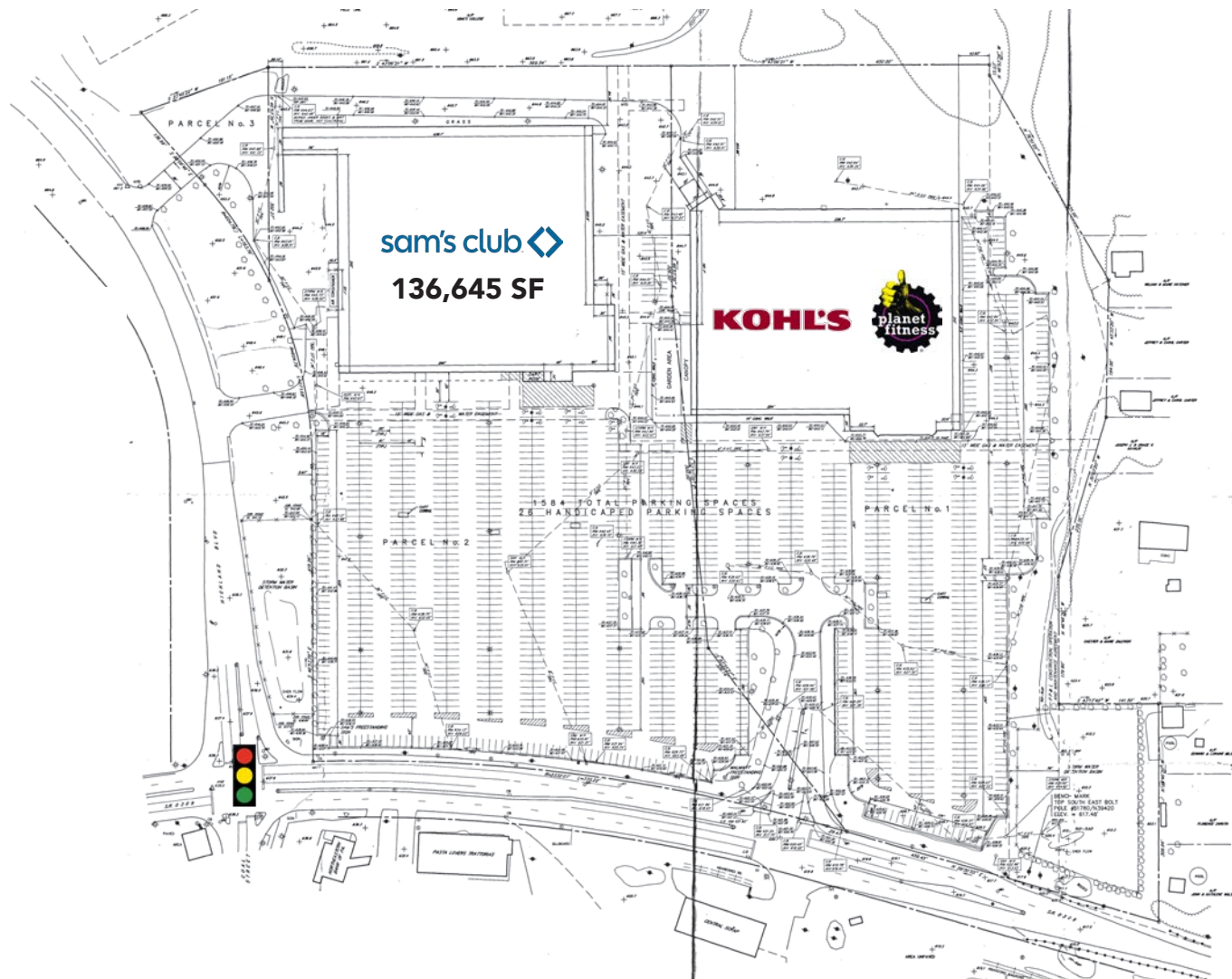



# 441 WILKES BARRE TOWNSHIP BLVD.

DOUGLAS GREEN  
dgreen@hellomsc.com  
215.883.7400

STEFANIE GABEL  
sgabel@hellomsc.com  
215.883.7409

