



MSC

1210 CHESTNUT STREET

MIDTOWN VILLAGE,
PHILADELPHIA, PA



10,000 SF (DIVISIBLE) RETAIL
FOR LEASE



1210 CHESTNUT STREET

JOSH WEISS
jweiss@hellomsc.com
215.883.7389

STEFANIE GABEL
sgabel@hellomsc.com
215.883.7409



- Large retail floorplate for lease with 47' of frontage on Chestnut Street
- Potential to subdivide space and create two distinct retail opportunities with traditional retail use fronting Chestnut Street and F&B use fronting Sansom Street
- Additional storage space in basement
- Explosive growth in immediate office, retail, residential and healthcare populations driving 7-day-a-week traffic

DEMOGRAPHICS

Center City Trade Area

From the River to River between Girard Avenue & Washington Avenue

 **EST. POPULATION**
142,078

 **EST. MEDIAN AGE**
33.8 yrs

 **EST. AVG HH INCOME**
\$103,852

 **EST. TOTAL EMPLOYEES**
271,523

JOIN THESE AREA TENANTS

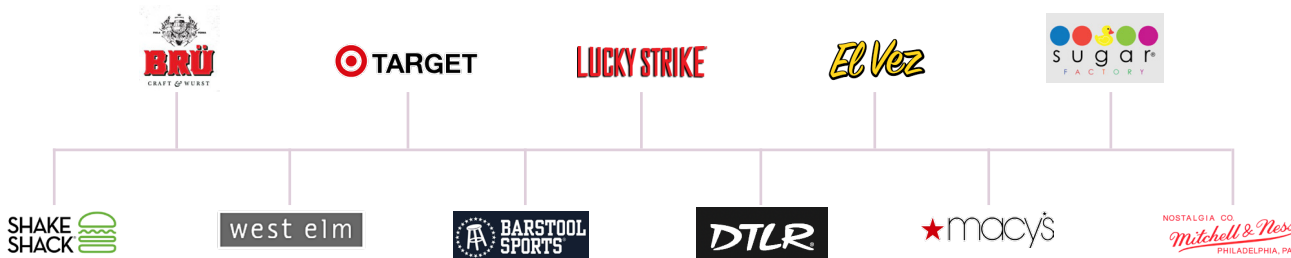

MIDTOWN VILLAGE,
PHILADELPHIA, PA

10,000 SF (DIVISIBLE) RETAIL FOR LEASE



1210 CHESTNUT STREET

JOSH WEISS
jweiss@hellomsc.com
215.883.7389

STEFANIE GABEL
sgabel@hellomsc.com
215.883.7409

Broad Street

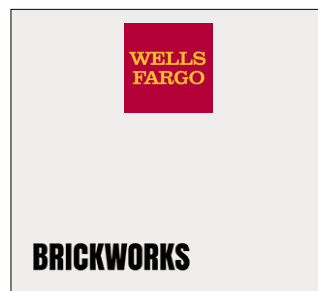
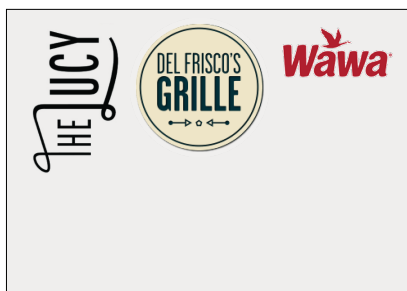

Juniper Street

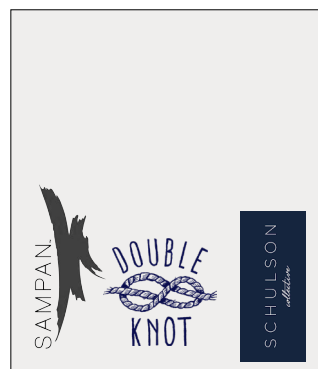
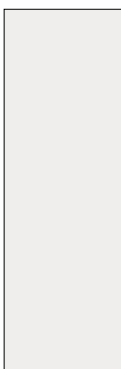

Locust Street

Walnut Street

Sansom Street

Chestnut Street

13th Street

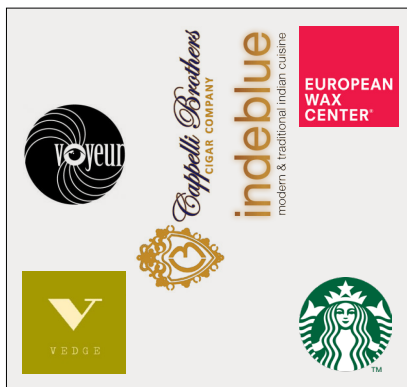

SITE



JOSH WEISS
jweiss@hellomsc.com
215.883.7389

STEFANIE GABEL
sgabel@hellomsc.com
215.883.7409

Scenario 1: Single Tenant

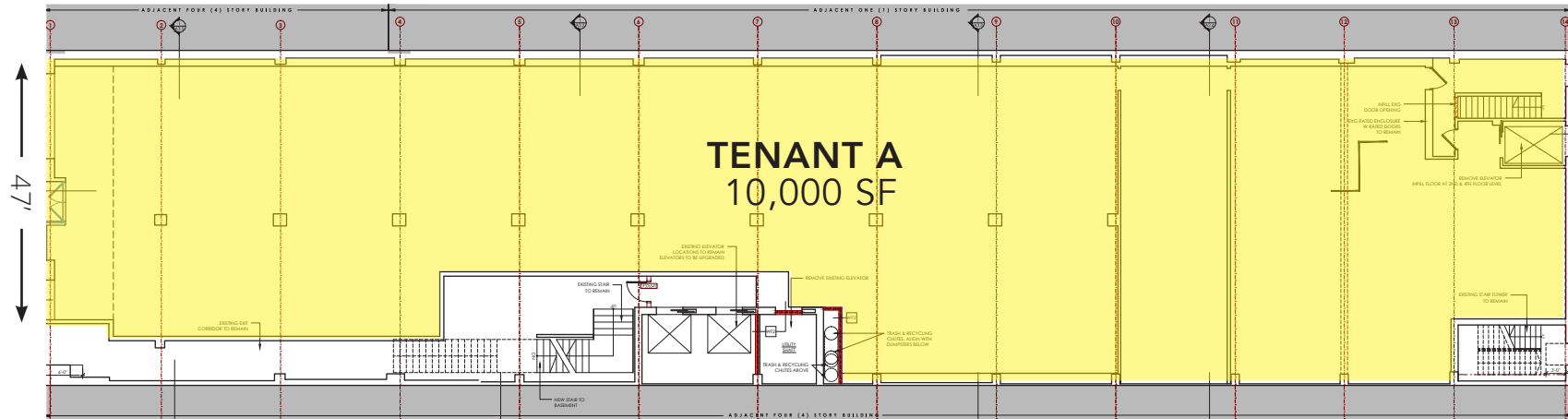

Scenario 2: Two Tenants

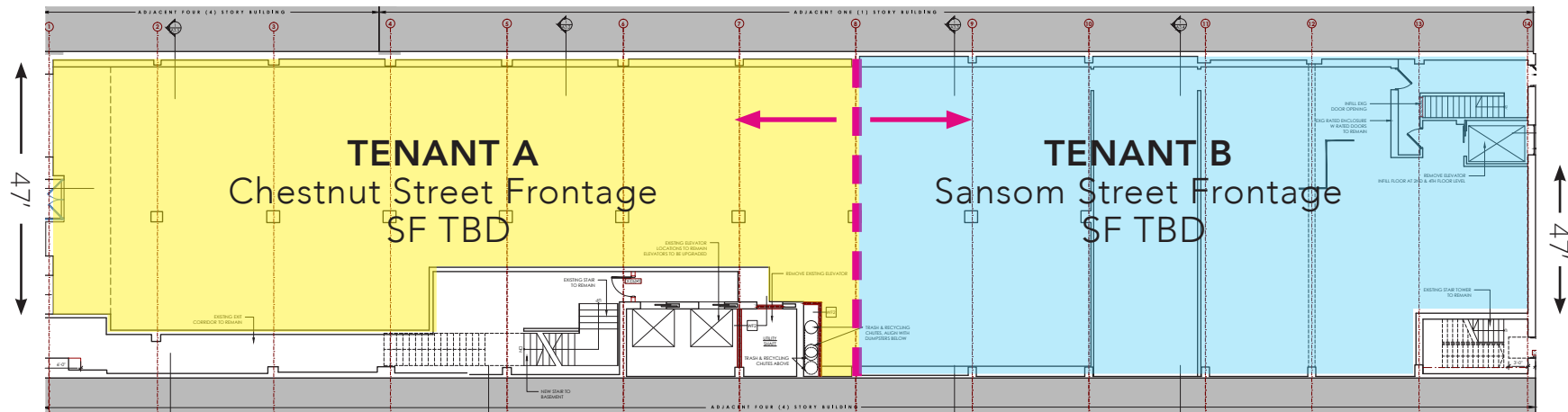

— — — Demising line may vary



1210 CHESTNUT STREET

STEFANIE GABEL
sgabel@hellomsc.com
215.883.7409

