

**1 SPACE  
REMAINING!**

**MSC**



1500 VENERA AVE | CORAL GABLES, FL

# THE STANDARD CORAL GABLES

±4,488 SF RETAIL OPPORTUNITIES





# THE STANDARD CORAL GABLES

**MATTHEW STEIN**  
mstein@hellomsc.com  
833.FOR.MSCU

**DOUGLAS GREEN**  
dgreen@hellomsc.com  
215.883.7400

**MATTHEW COOPER**  
mcooper@hellomsc.com  
833.FOR.MSCU



- Retail available in new construction, mixed-use student housing project at the doorstep of University of Miami
- Join newly signed Title Boxing, Salon Lofts, R&A Cycles
- 376 beds / 147 residential units
- 27,159 SF ground floor retail / restaurant opportunities  
Convenient vehicular access right off of Route 1
- Great visibility with heavy foot traffic (adjacent Whole Foods and William Jerdyk Park)
- Easy accessibility via metro rail line to downtown Miami
- 6.8 miles to Miami International Airport
- Immediate availability

## JOIN THESE AREA TENANTS



## DEMOGRAPHICS

- EST. POPULATION**  
1 mi 18,037 | 3 mi 109,598
- AVG. HH INCOME**  
1 mi \$184,509 | 3 mi \$187,310
- MEDIAN HH INCOME**  
1 mi \$103,034 | 3 mi \$113,559
- DAYTIME EMPLOYEES**  
1 mi 21,479 | 3 mi 89,117

- WHITE COLLAR EMPLOYEES**  
1 mi 69.4% | 3 mi 72.9%
- COLLEGE DEGREE**  
1 mi 49.8% | 3 mi 57.7%
- MEDIAN AGE**  
1 mi 35.6 | 3 mi 41.1

## UNIVERSITY OF MIAMI

- UNDERGRADUATE STUDENTS** 11,117
- GRADUATE** 6,214
- TOTAL STUDENT POPULATION** 17,331
- FACULTY/STAFF** 16,174



# THE STANDARD CORAL GABLES

**MATTHEW STEIN**  
mstein@hellomsc.com  
833.FOR.MSCU

**DOUGLAS GREEN**  
dgreen@hellomsc.com  
215.883.7400

**MATTHEW COOPER**  
mcooper@hellomsc.com  
833.FOR.MSCU

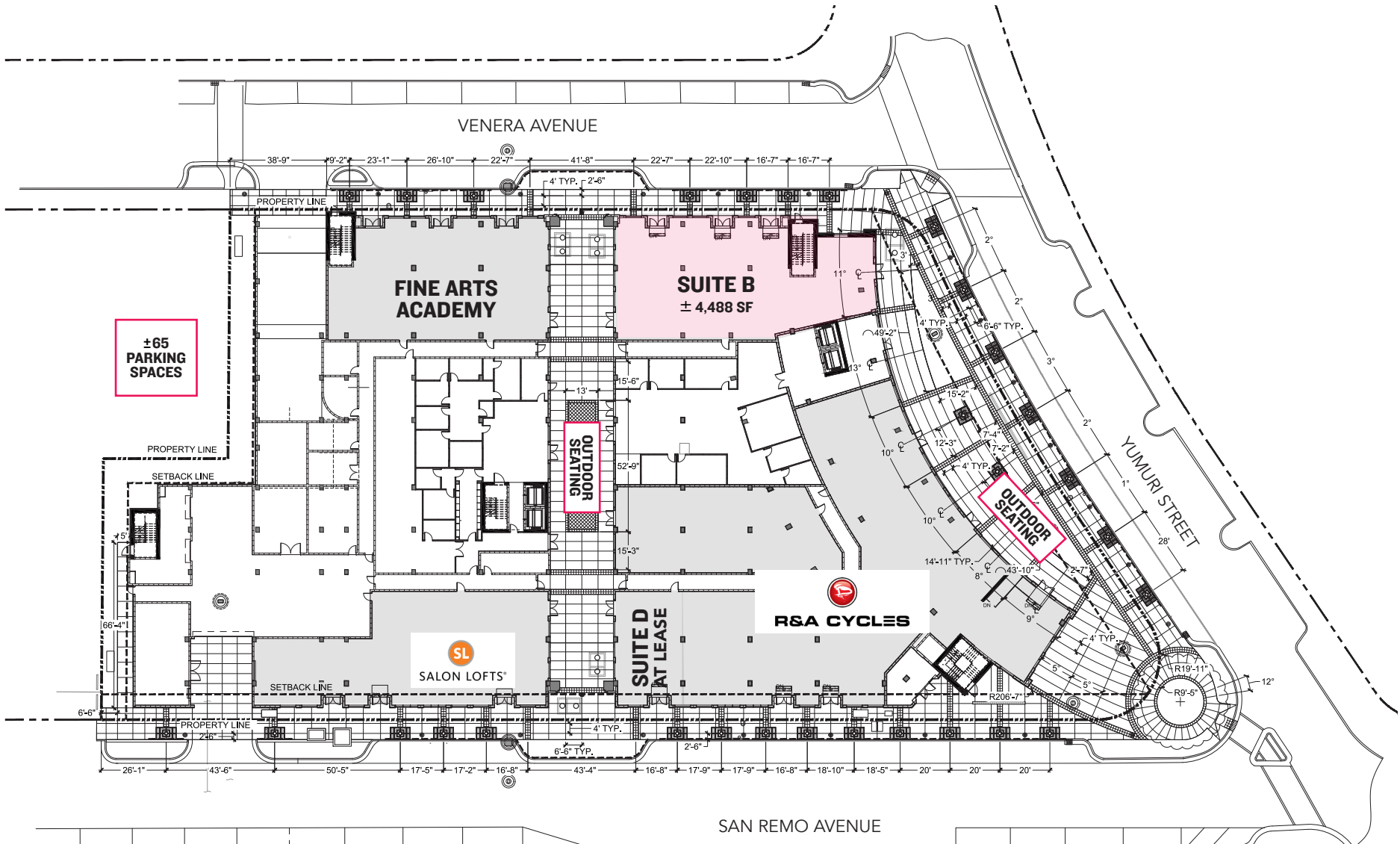



# THE STANDARD CORAL GABLES

**MATTHEW STEIN**  
mstein@hellomsc.com  
833.FOR.MSCU

**DOUGLAS GREEN**  
dgreen@hellomsc.com  
215.883.7400

**MATTHEW COOPER**  
mcooper@hellomsc.com  
833.FOR.MSCU





# THE STANDARD CORAL GABLES

**MATTHEW STEIN**  
mstein@hellomsc.com  
833.FOR.MSCU

**DOUGLAS GREEN**  
dgreen@hellomsc.com  
215.883.7400

**MATTHEW COOPER**  
mcooper@hellomsc.com  
833.FOR.MSCU

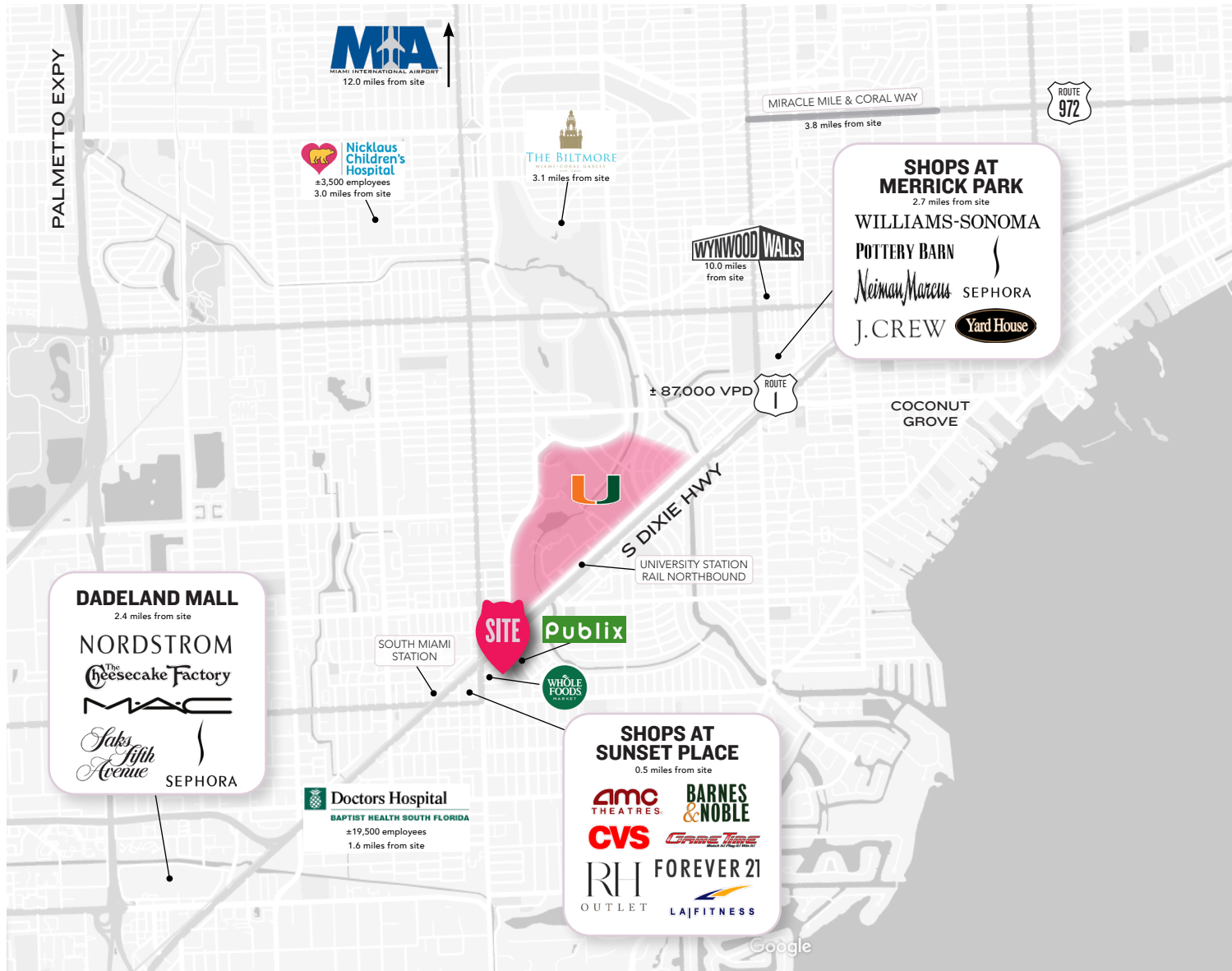

The information contained herein has been obtained from sources deemed reliable. MSC cannot verify it and makes no guarantee, warranty or representation about its accuracy. Any projections, opinions, assumptions or estimates provided by MSC are for discussion purposes only and do not represent the current or future performance of a property, location or market.



1500 VENERA AVE  
CORAL GABLES, FL

## PHOTOS



# THE STANDARD CORAL GABLES

**MATTHEW STEIN**  
mstein@hellomsc.com  
833.FOR.MSCU

**DOUGLAS GREEN**  
dgreen@hellomsc.com  
215.883.7400

**MATTHEW COOPER**  
mcooper@hellomsc.com  
833.FOR.MSCU

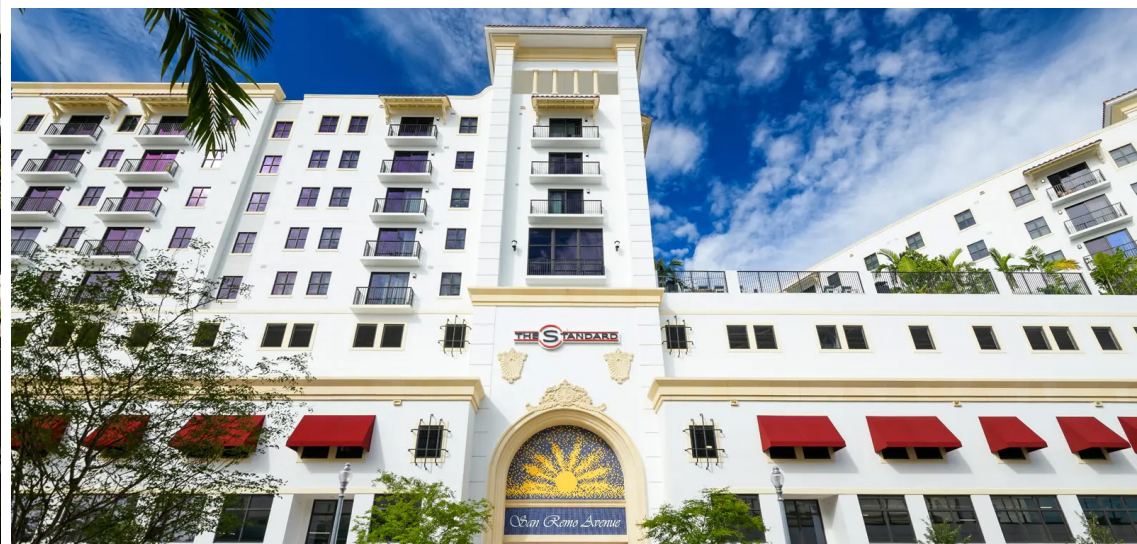

The information contained herein has been obtained from sources deemed reliable. MSC cannot verify it and makes no guarantee, warranty or representation about its accuracy. Any projections, opinions, assumptions or estimates provided by MSC are for discussion purposes only and do not represent the current or future performance of a property, location or market.

**MSC**