

# MSC

Midwood



RITTENHOUSE SQUARE | PHILADELPHIA, PA

# 1715-21 WALNUT STREET

PREMIER 2ND FLOOR WALNUT STREET OPPORTUNITY FOR LEASE - 9,770 SF





# 1715-21 WALNUT STREET

**BRITTANY GOLDBERG**  
bgoldberg@hellomsc.com  
215.883.7405

**DOUGLAS GREEN**  
dgreen@hellomsc.com  
215.883.7400

**JACOB COOPER**  
jcooper@hellomsc.com  
215.883.7402



## JOIN THESE TENANTS ON THE 1700 BLOCK OF WALNUT

lululemon  VINCE.

TIFFANY & CO.  ATHLETA

Madewell 

bluemercury®   
makeup • skincare • spa

## DEMOGRAPHICS

### Center City Trade Area

From the River to River between Girard Avenue & Tasker Avenue



**EST. POPULATION**  
188,131



**EST. MEDIAN AGE**  
35 yrs



**EST. AVG HH INCOME**  
\$99,150



**EST. TOTAL EMPLOYEES**  
258,822

- Prominent 2nd floor leasing opportunity on the best retail block in Philadelphia, the 1700 block of Walnut Street, above newly opened Tiffany & Co.
- A rare large footprint opportunity with a dedicated Walnut Street level entrance/signage (ideal for large format retailer, furniture, or office)
- +/- 80' of 2nd floor frontage overlooking Walnut Street
- Positioned in immediate proximity to Rittenhouse Square, the core of affluent residential, national retail, and dense daytime office population
- The asset is being redeveloped by one of Philadelphia's largest Landlords, Midwood Investment & Development

RITTENHOUSE SQUARE,  
PHILADELPHIA, PA

OFFICE RENDERING



# 1715-21 WALNUT STREET

**BRITTANY GOLDBERG**  
bgoldberg@hellomsc.com  
215.883.7405

**DOUGLAS GREEN**  
dgreen@hellomsc.com  
215.883.7400

**JACOB COOPER**  
jcooper@hellomsc.com  
215.883.7402



The information contained herein has been obtained from sources deemed reliable. MSC cannot verify it and makes no guarantee, warranty or representation about its accuracy. Any projections, opinions, assumptions or estimates provided by MSC are for discussion purposes only and do not represent the current or future performance of a property, location or market.

**MSC**





# 1715-21 WALNUT STREET

**BRITTANY GOLDBERG**  
bgoldberg@hellomsc.com  
215.883.7405

**DOUGLAS GREEN**  
dgreen@hellomsc.com  
215.883.7400

**JACOB COOPER**  
jcooper@hellomsc.com  
215.883.7402

## ±9,770 SF

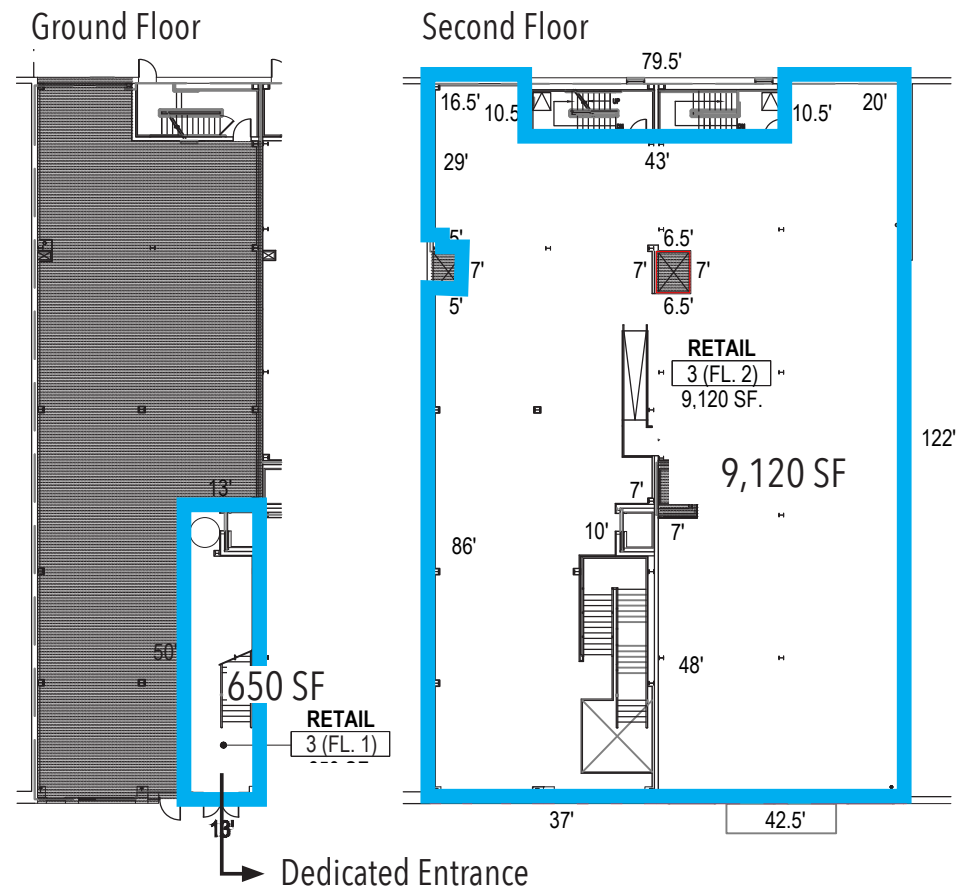

## WALNUT STREET



# 1715-21 WALNUT STREET

**BRITTANY GOLDBERG**  
bgoldberg@hellomsc.com  
215.883.7405

**DOUGLAS GREEN**  
dgreen@hellomsc.com  
215.883.7400

**JACOB COOPER**  
jcooper@hellomsc.com  
215.883.7402

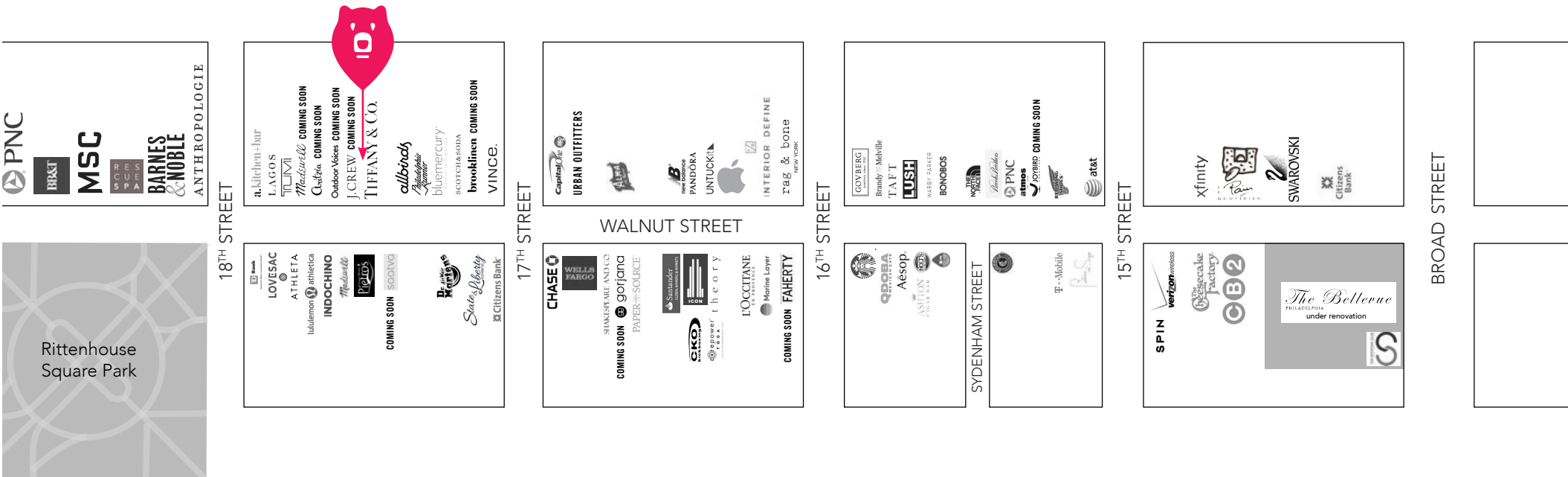



# 1715-21 WALNUT STREET

BRITTANY GOLDBERG  
bgoldberg@hellomsc.com  
215.883.7405

DOUGLAS GREEN  
dgreen@hellomsc.com  
215.883.7400

JACOB COOPER  
jcooper@hellomsc.com  
215.883.7402

