

# 53 - 15 Forest Park Way

Port Moody, BC

**LOWER LEVEL**  
86 SQ.FT  
Ceiling Height - 9'-0"

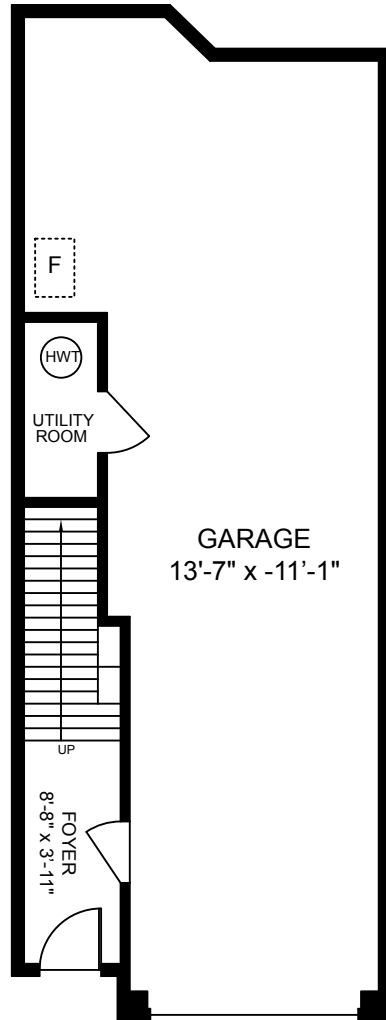

**MAIN LEVEL**  
595 SQ.FT  
Ceiling Height - 9'-0"

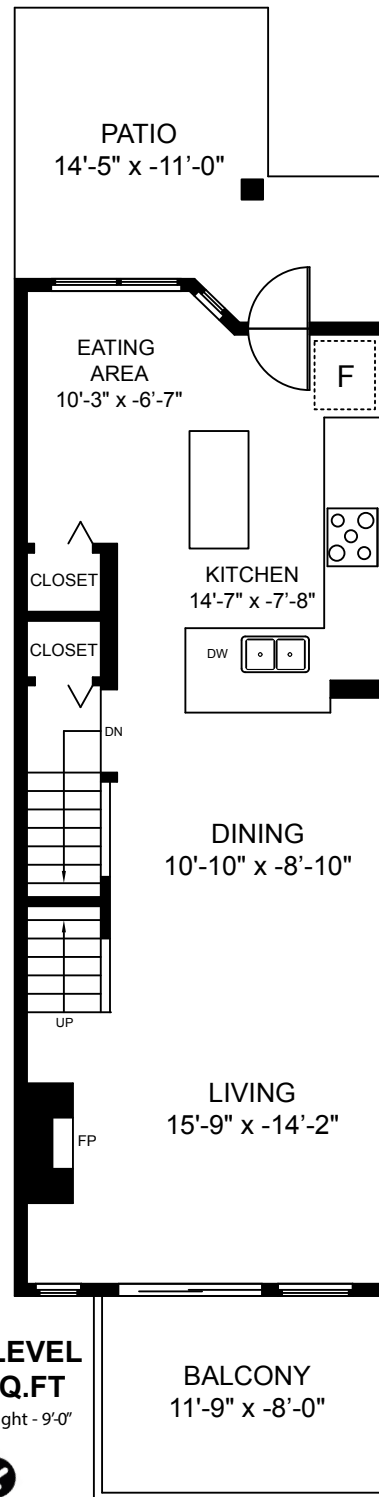

Main :	595 SQ.FT.
Upper:	611 SQ.FT.
Lower:	86 SQ.FT.
<b>Total :</b>	<b>1292 SQ.FT.</b>
Balcony:	94 SQ.FT.
Patio:	148 SQ.FT.
Garage:	515 SQ.FT.
<b>Total Extras:</b>	<b>757 SQ.FT.</b>

**UPPER LEVEL**  
611 SQ.FT  
Ceiling Height - 8'-0"

