

5519 TAPPIN ST.

1769 SQ. FT.

8' CEILINGS



NORTH

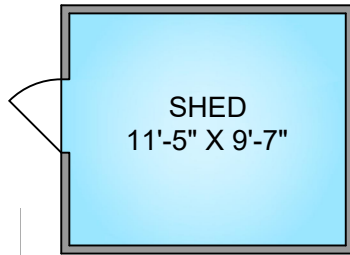
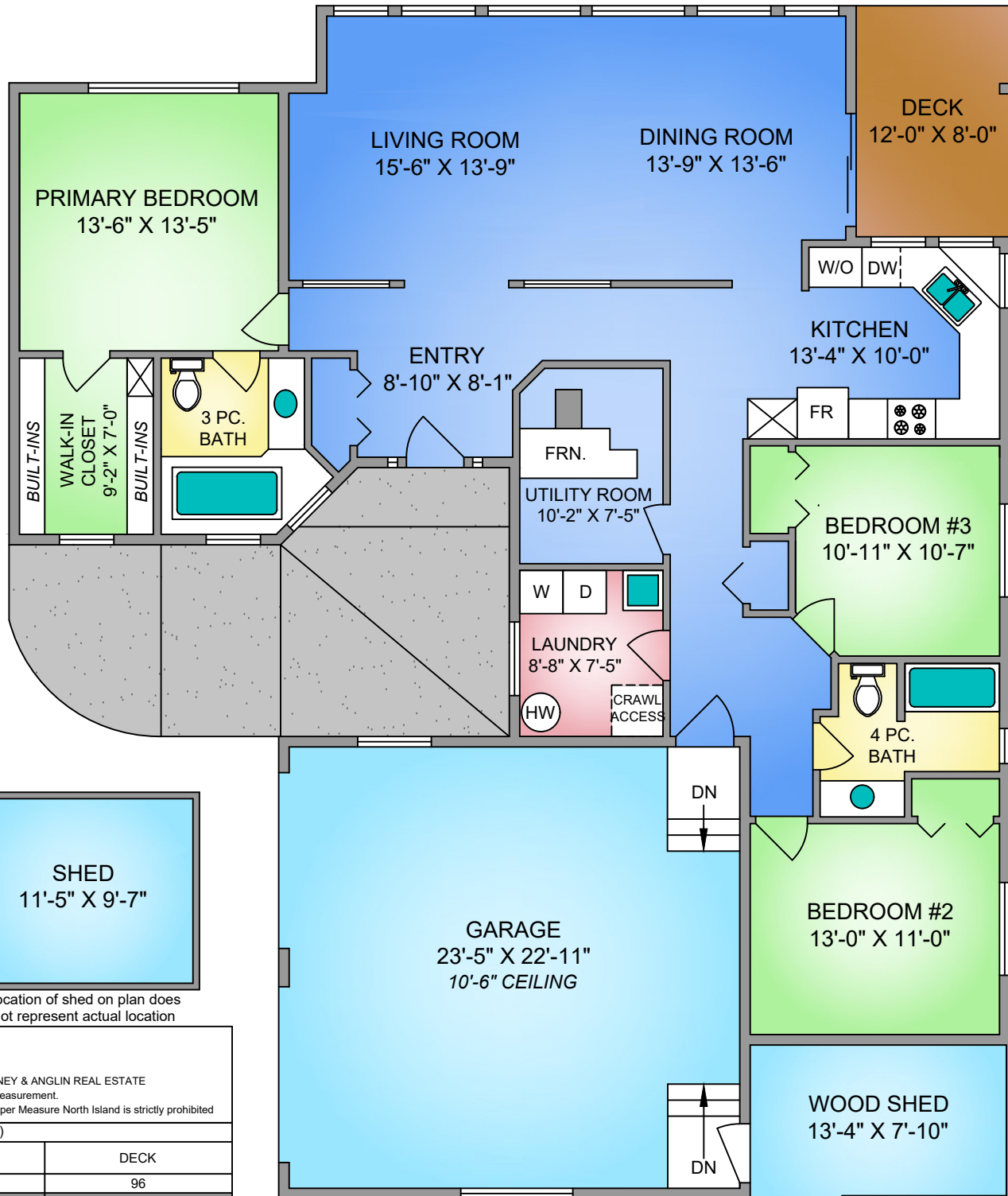
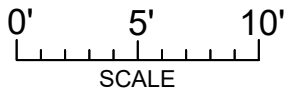

Location of shed on plan does not represent actual location

PROPER MEASURE 250-465-1487
 FROM PRECISION TO PERFECTION
 Proper Measure North Island
 NorthIsland@Propermeasure.com

5519 TAPPIN ST.
 MARCH 25, 2021

Prepared by PROPER MEASURE NORTH ISLAND for the exclusive use of COURTNEY & ANGLIN REAL ESTATE
 Plans may not be 100% accurate. Buyer must verify any critical measurement.
 Private resale or modification of floor plans to a third party by any individual or entity other than Proper Measure North Island is strictly prohibited

FLOOR	AREA (SQ. FT.)		
	FINISHED	GARAGE	DECK
MAIN	1769	574	96
TOTAL	1769	574	96