

# Property Boundary and Topography

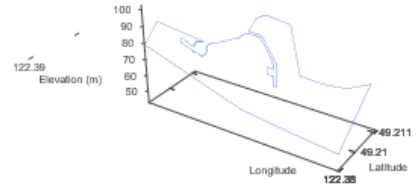

Max Elevation: 92.67 m | Min Elevation: 52.57 m | Difference: 40.10 m

### Parcel Outlines

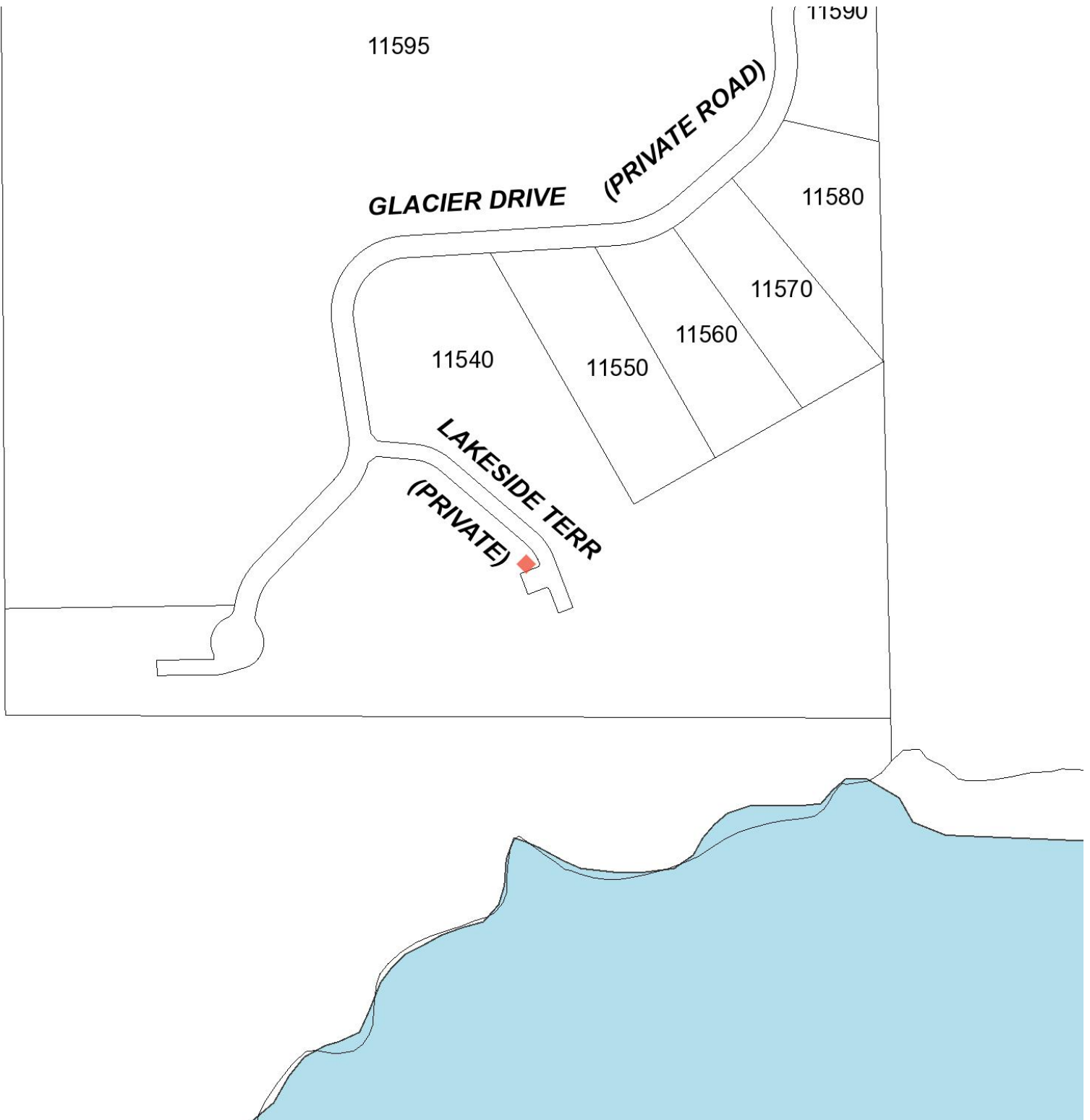

### Legend

- |                            |                    |                  |               |
|----------------------------|--------------------|------------------|---------------|
| Water - Fill               | Municipal Boundary | Property Parcels | Area Boundary |
| HIGHWAY - PROVINCIAL ROADS | ARTERIAL ROADS     | COLLECTOR ROADS  | URBAN ROADS   |
| RURAL ROADS                | PRIVATE ROADS      |                  |               |

# CD-7

S.L. 7

GLACIER DRIVE (PRIVATE ROAD)

S.L. 1

S.L. 2

S.L. 3

S.L. 4

S.L. 5

LAKESIDE TERR (PRIVATE)

S.L. 6

# F

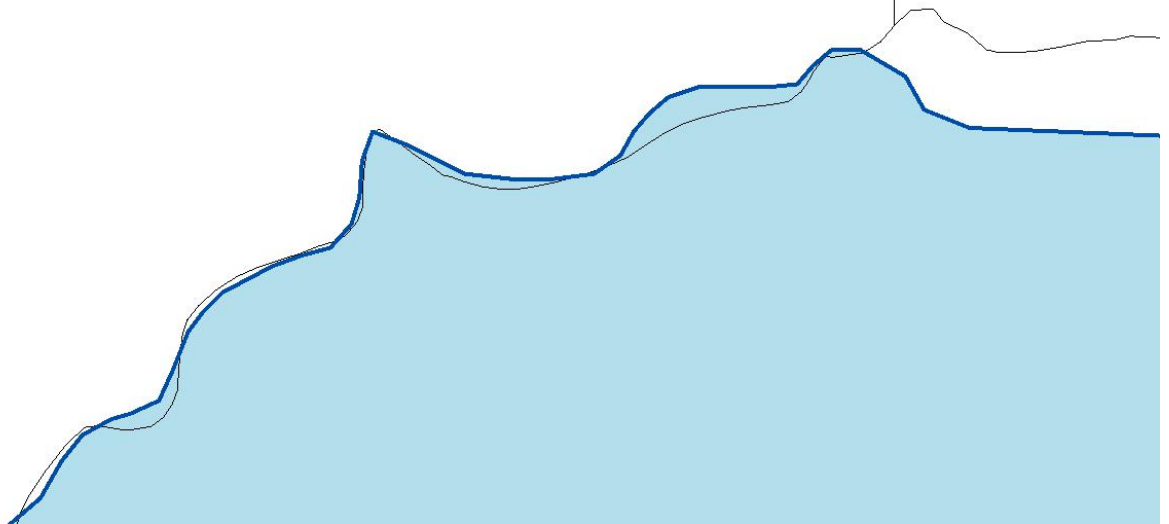

## Legend

- Water - Fill
- Zoning Boundary Designations
- ARTERIAL ROADS
- PRIVATE ROADS

- Municipal Boundary
- Zoning Leader Lines
- COLLECTOR ROADS

- Rights of Ways
- Land Use Contracts
- URBAN ROADS

- Property Parcels
- HIGHWAY - PROVINCIAL ROADS
- RURAL ROADS

## Nearest Schools with Ranking

### Nearby Elementary Schools



**Legend:** Subject Property Catchment School Other Schools

Elementary School Catchment: **Silverdale Elementary** -

School's Name	Grades Covered	2017-2018 Rating	5-year Average Rating	2017-2018 Rank	5-year Average Rank	City	Special Notes/Programs	Walking Time	Distance	Driving Time	Transit Time
A Silverdale	K - 6	6.5	n/a	353/955	n/a	Mission	StrongStart	2 hours 31 mins	12.0 km	14 mins	n/a
B Whonnock	K - 7	n/a	n/a	n/a	n/a	Maple Ridge		1 hour 48 mins	8.4 km	11 mins	n/a
C Valley Christian	K - 6	5.4	n/a	617/955	n/a	Mission	Independent Christian School	3 hours 13 mins	15.3 km	18 mins	n/a
D Albert McMahon	K - 6	4.3	4.8	802/955	659/805	Mission		3 hours 28 mins	16.5 km	19 mins	n/a
E Cherry Hill	K - 6	3.4	4.3	883/955	726/805	Mission	StrongStart	3 hours 37 mins	17.2 km	20 mins	n/a
F West Heights	K - 6	3.2	3.8	895/955	771/805	Mission	StrongStart	3 hours 45 mins	18.1 km	21 mins	n/a

## Nearby Secondary Schools



**Legend:** Subject Property Catchment School Other Schools

Secondary School Catchment: **Mission Senior Secondary** -

School's Name	Grades Covered	2017-2018 Rating	5-year Average Rating	2017-2018 Rank	5-year Average Rank	City	Special Notes/Programs	Walking Time	Distance	Driving Time	Transit Time
A Mission	10 - 12	4.4	n/a	210/253	n/a	Mission	Secondary French Immersion; AP Program	3 hours 49 mins	18.3 km	22 mins	n/a
B Valley Christian	7 - 12	5.4	n/a	617/955	n/a	Mission	Independent Christian School	3 hours 13 mins	15.3 km	18 mins	n/a
C Heritage Park Middle	7 - 9	n/a	n/a	n/a	n/a	Mission	Middle French Immersion	4 hours 2 mins	19.4 km	24 mins	n/a
D Hatzic Middle	7 - 9	n/a	n/a	n/a	n/a	Mission		4 hours 20 mins	21.0 km	24 mins	n/a
E Garibaldi	8 - 12	4.4	3.6	210/253	235/246	Maple Ridge	IB Program (DP); Interdisciplinary Arts Academy	2 hours 40 mins	12.7 km	14 mins	n/a
F Samuel Robertson Tech	8 - 12	5.3	4.3	169/253	217/246	Maple Ridge	Trades Apprenticeship Programs; Hairstyling/Cosmetology Academy	3 hours 27 mins	16.4 km	19 mins	n/a