

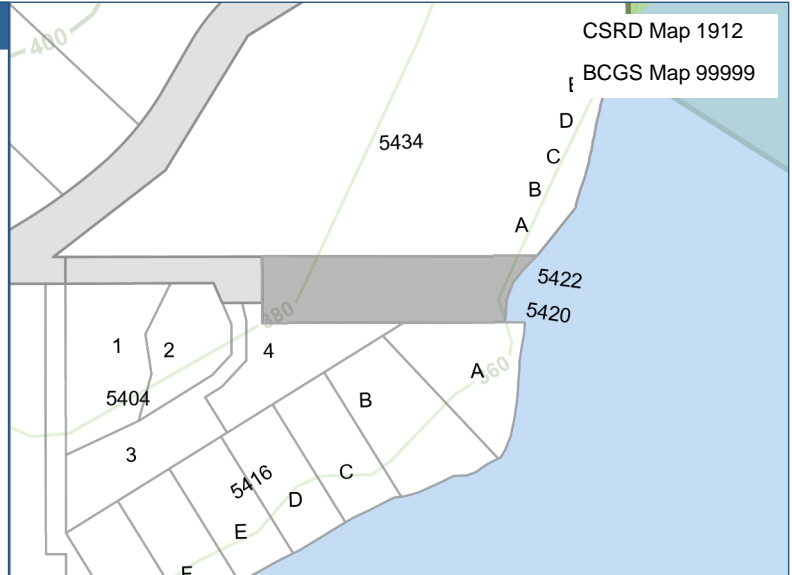

Property Details

Address: 5420 Sunnybrae-Canoe Pt Rd
 Name/PID: 003-784-916
 Roll: 78903883000
 Electoral Area: C
 Local Area: Tappen
 Ownership: Private
 GIS Lot Size: 0.42 HA | 1.04 Acres *
 Percent in ALR: 0
 Legal Description: L 1 SEC 22 TP 21 R 9 W OF THE 6TH MERIDIAN KAMLOOPS DIVISION YALE DISTRICT PL 1460

* Lot size is approximate. Refer to the legal plan to obtain the official size. Contact the CSR D if there is a discrepancy between the CSR D lot size data and another authority.



Planning and Development

Building: Bylaw 660: Building Regulation and Inspection
 Zoning: Bylaw 900: FG1 - Foreshore General 1
 Bylaw N/A: No Zoning
 OCP: Bylaw 725: RR2 - Rural Residential 2

Related Planning Files and Permits:

Application Type - Status	File Number	Entered

Property potentially in one or more of the following CSR D permit application areas:

- Floodplain
- Foreshore and Water (Dock and Buoy)
- Hazardous Lands (Steep Slope)
- Lakes 100m
- Riparian Areas Regulation (RAR)

* This information is generated automatically from various sources. Contact the CSR D to verify requirements for this property.

BCAA - Property Details

Roll Number: 78903883000
 Assess Area: 20 - North Okanagan
 Jurisdiction: 789 - Salmon Arm Rural
 Neighbourhood: 511 - Waterfront Tappen to Bastion Bay
 School District: 83 - North Okanagan-Shuswap
 Hospital District: 03 - North Okanagan/Columbia Shuswap
 Class: 01 - Residential
 Subclass: 0102 - Residential Single Family
 Actual Use: 000 - Single Family Dwelling
 Manual Class: 0141 - 1.5 STY SFD - After 1960 - Standard

Minor Taxing:

EA C FIRE SERVICE SRVA 56
 Fireworks Area C SRVA#57
 S Shuswap Liq Waste SRVA#39
 Okanagan Reg Library LSA#28
 Shuswap Watershed Council SRVA#69

Assessment:

Land	\$637,000
Improvements	\$230,000
Gross Value	\$867,000
Exempt:	\$0
Net Value	\$867,000

Sale History:

2012/09/11	\$800,000
1986/04/10	\$0
1972/12/15	\$0

* This information is generated and provided by the BC Assessment Authority. Please contact BCAA if you have any questions.